

PLAN	PROJECT NO.	DATE
NO. 1	60L77	7/17/2012
NO.	DESIGNED BY	
	DRAWN BY	
	CHECKED BY	
	DATE	

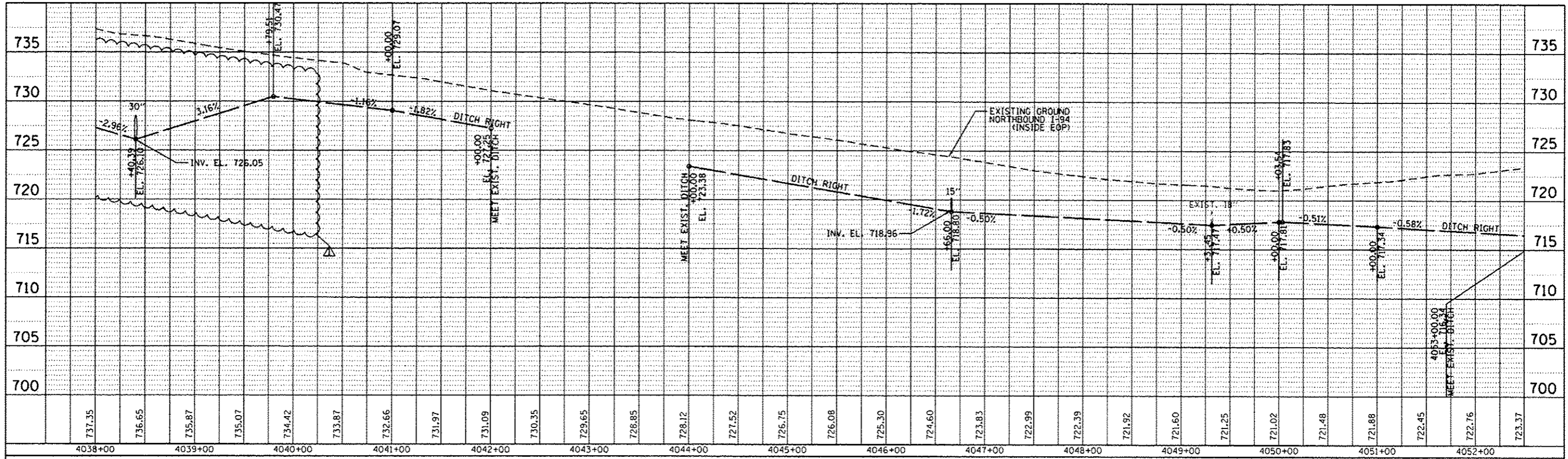

PROFILE	PROJECT NO.	DATE
NO. 1	60L77	7/17/2012
NO.	DESIGNED BY	
	DRAWN BY	
	CHECKED BY	
	DATE	

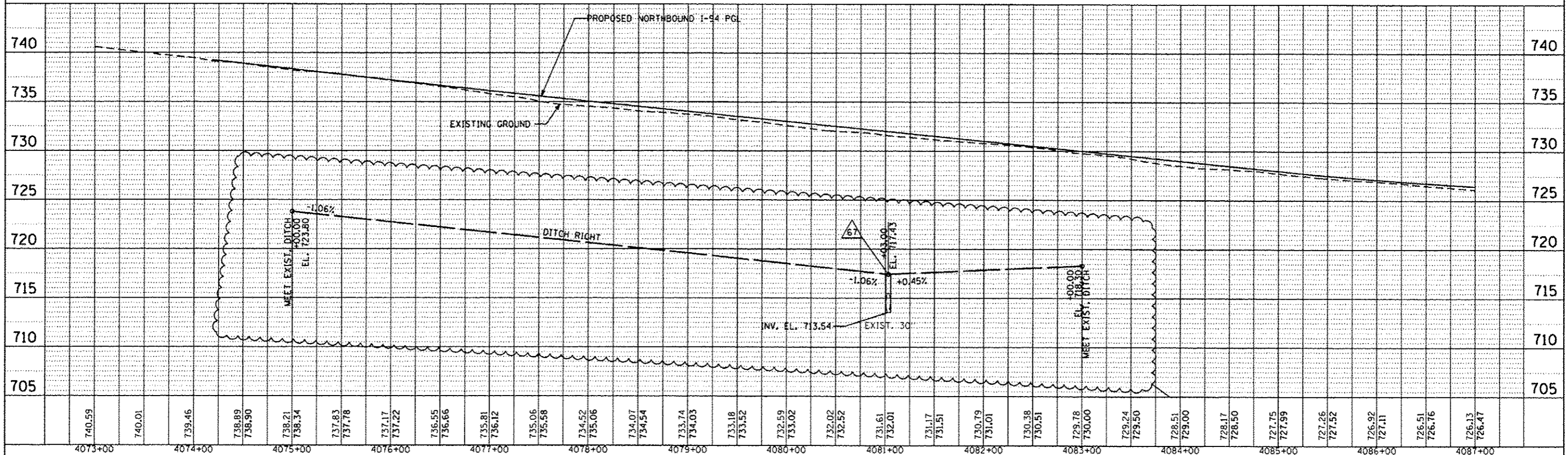

FILE NAME : D:\60L77\shd\drainage\profile.dgn	USER NAME : default	DESIGNED - JAM	REVISED - 07/17/2012	<b>STATE OF ILLINOIS</b> <b>DEPARTMENT OF TRANSPORTATION</b>	<b>PROPOSED DRAINAGE PROFILE</b> <b>NORTHBOUND I-94</b>			F.A. RTE. 94	SECTION 49-1-R-1	COUNTY LAKE	TOTAL SHEETS 677	SHEET NO. 203
	PLOT SCALE : 1/4"=1'-0"	DRAWN - JAM	REVISED -		SCALE: 1"=50'	SHEET NO. 3 OF 14 SHEETS	STA. 4038+00.00 TO STA. 4087+00.00	CONTRACT NO. 60L77				
	PLOT DATE : 7/17/2012	CHECKED - RGR	REVISED -		ILLINOIS FED. AID PROJECT							
		DATE - 6/19/2012	REVISED -									