

PLAN	SUBMITTED	DATE
	PLOTTED	
	NOTED	
	BY	
	NO.	

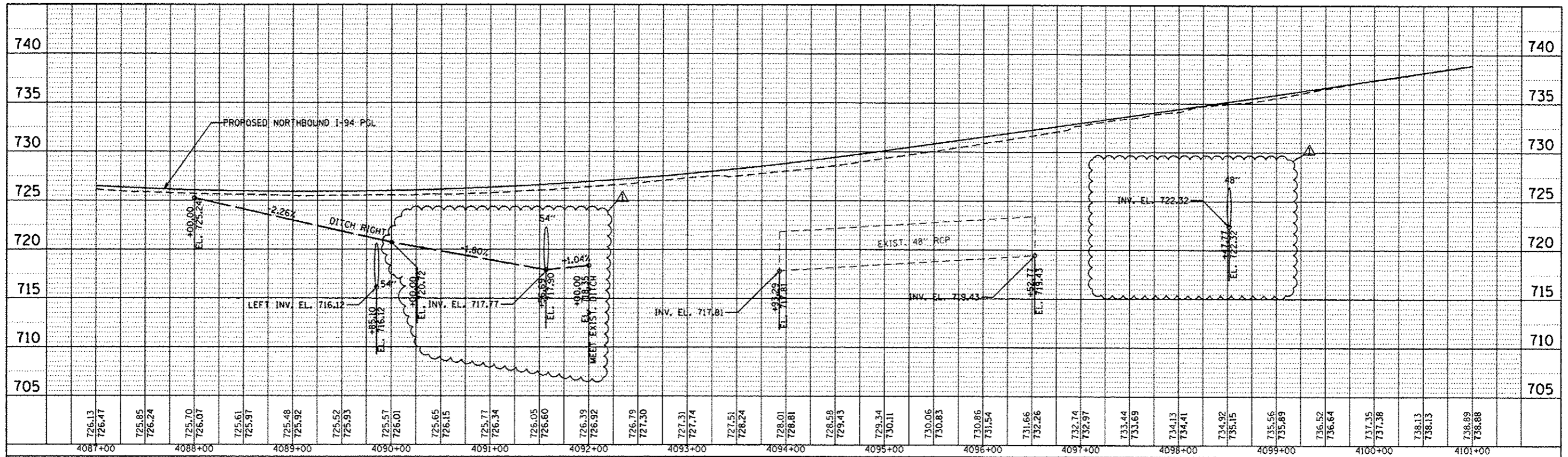

PROFILE	SUBMITTED	DATE
	PLOTTED	
	NOTED	
	BY	
	NO.	

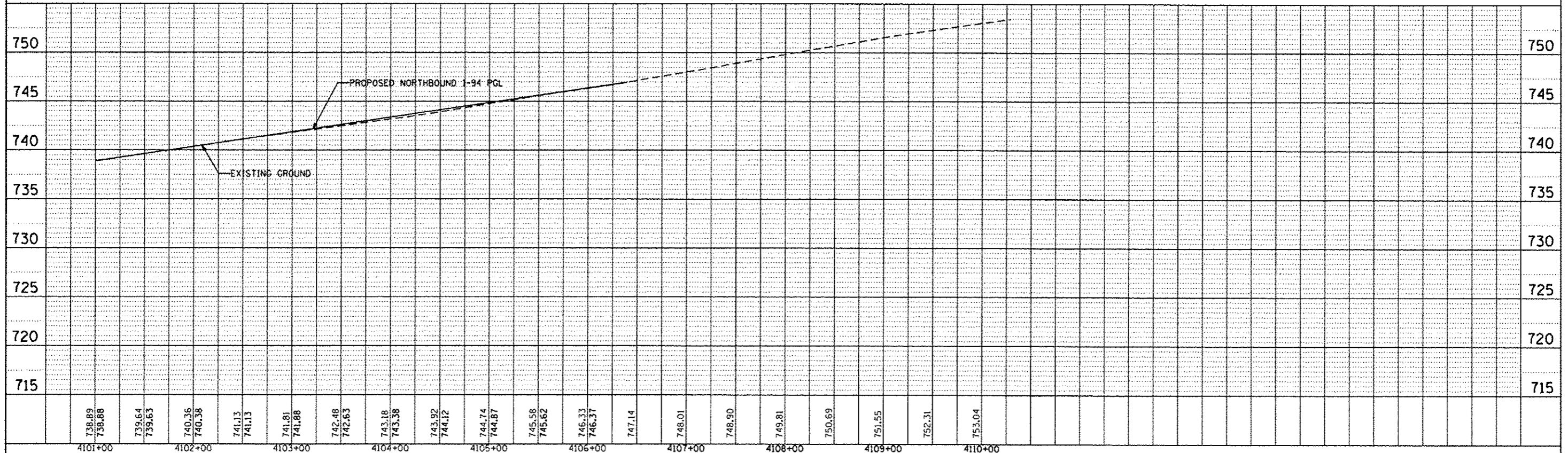

FILE NAME : D:\60L77-shd-drainage-profile.dgn	USER NAME = default	DESIGNED - JAM	REVISED 07/17/2012	STATE OF ILLINOIS DEPARTMENT OF TRANSPORTATION	PROPOSED DRAINAGE PROFILE NORTHBOUND I-94		F.A. RTE. 94	SECTION 49-1-R-1	COUNTY LAKE	TOTAL SHEETS 677	SHEET NO. 204	
	PLOT SCALE = 1/8"=1' 1/2"=5'	DRAWN - JAM	REVISED -		SCALE: 1"=50'	SHEET NO. 4 OF 14 SHEETS	STA. 4087+00.00 TO STA. 4110+00.00	CONTRACT NO. 60L77				
	PLOT DATE = 7/17/2012	CHECKED - RGR	REVISED -		ILLINOIS FED. AID PROJECT							
		DATE - 6/19/2012	REVISED -									