

MAINTENANCE OF TRAFFIC SIGNING LEGEND

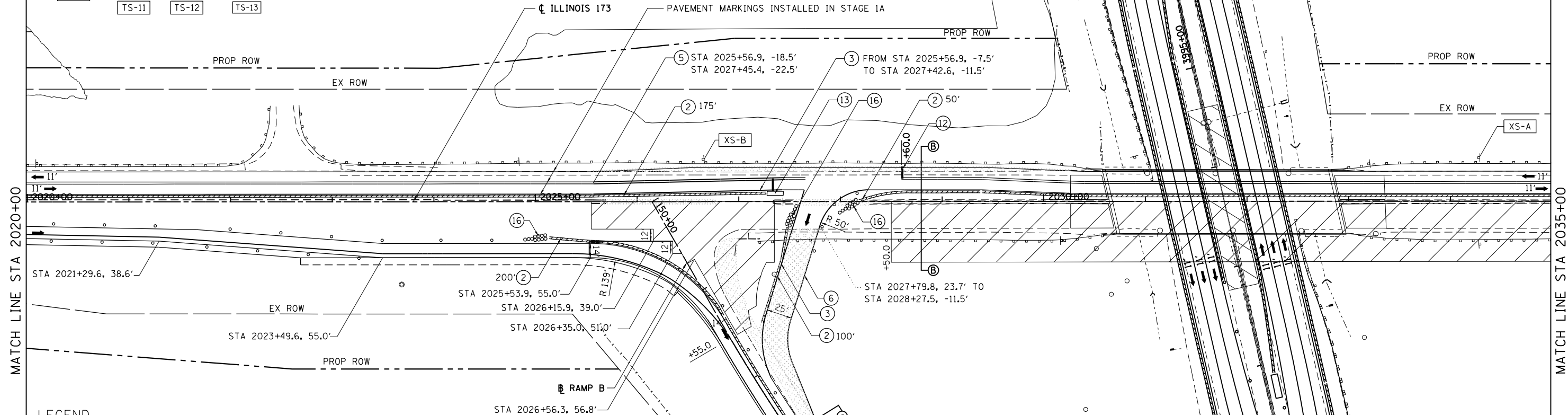
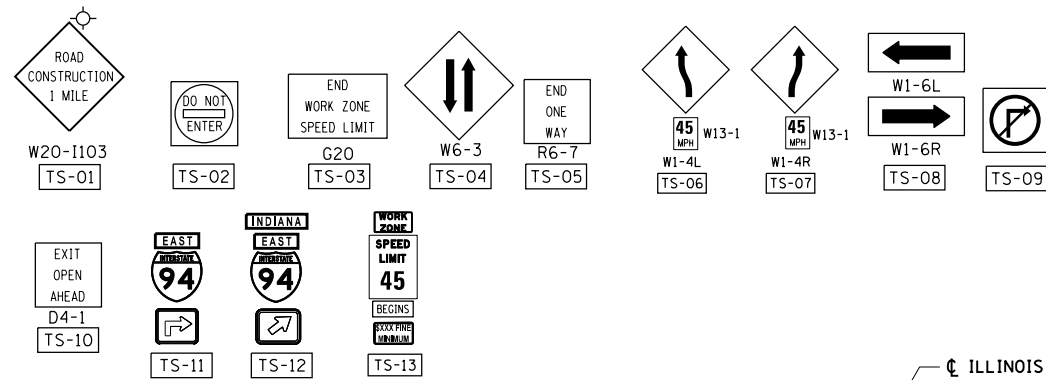

LEGEND

- ← L1 LANE NUMBER AND DIRECTION OF TRAFFIC
- ⊥ TYPE III BARRICADE
- • DRUMS AT 50'C-C WITH BIDIRECTIONAL BURNING LIGHT
- ▨ TEMPORARY PAVEMENT
- ▨ WORKZONE
- ① TEMPORARY CONCRETE BARRIER WITH BARRIER WALL MARKERS, TYPE C
- ② RELOCATE TEMPORARY CONCRETE BARRIER
- ③ PAVEMENT MARKING TAPE, TYPE III 4" WHITE
- ④ PAVEMENT MARKING TAPE, TYPE III 4" WHITE, 2' DASH 6' SKIP
- ⑤ PAVEMENT MARKING TAPE, TYPE III 4" YELLOW, DOUBLE LINE
- ⑥ PAVEMENT MARKING TAPE, TYPE III 4" YELLOW
- ⑦ PAVEMENT MARKING TAPE, TYPE III 5" WHITE, 10' DASH 30' SKIP
- ⑧ PAVEMENT MARKING TAPE, TYPE III 4" WHITE, 25' DASH 25' SKIP
- ⑨ PAVEMENT MARKING TAPE, TYPE III 8" WHITE
- ⑪ PAVEMENT MARKING TAPE, TYPE III 12" WHITE
- ⑫ PAVEMENT MARKING TAPE, TYPE III 24" WHITE
- ⑬ IMPACT ATTENUATORS, TEMPORARY (FULLY REDIRECTIVE, NARROW), TEST LEVEL 3
- ⑭ IMPACT ATTENUATORS, RELOCATE (FULLY REDIRECTIVE, NARROW), TEST LEVEL 3
- ⑮ IMPACT ATTENUATORS, TEMPORARY (NON-REDIRECTIVE), TEST LEVEL 3
- ⑯ IMPACT ATTENUATORS, RELOCATE (NON-REDIRECTIVE), TEST LEVEL 3
- ⑰ IMPACT ATTENUATORS, TEMPORARY (FULLY REDIRECTIVE, WIDE), TEST LEVEL 3
- ⑱ IMPACT ATTENUATORS, RELOCATE (FULLY REDIRECTIVE, WIDE), TEST LEVEL 3

EXISTING SIGNS

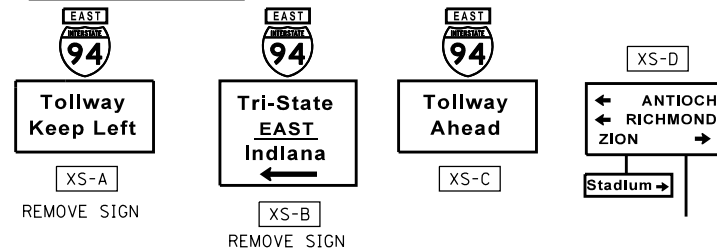

BOWMAN, BARRETT & ASSOCIATES INC.
CONSULTING ENGINEERS
Chicago, Illinois
312.228.0100
www.bbandainc.com

| | | | |
|-----------------------|-------------------------------|------------------|-----------|
| FILE NAME = \$FILES\$ | USER NAME = default | DESIGNED - | REVISED - |
| | | DRAWN - RA | REVISED - |
| | PLOT SCALE = H=1"=10' V=1"=5' | CHECKED - RGR | REVISED - |
| | PLOT DATE = 6/20/2012 | DATE - 6/19/2012 | REVISED - |

STATE OF ILLINOIS
DEPARTMENT OF TRANSPORTATION

MOT PLAN IL RTE 173 - STAGE 1B

SCALE: 1"=50' SHEET NO. 6 OF 14 SHEETS STA. 2020+00 TO STA. 2035+00

| F.A. RTE. | SECTION | COUNTY | TOTAL SHEETS | SHEET NO. |
|---------------------------|----------|--------|--------------|-----------|
| 94 | 49-1-R-1 | LAKE | 677 | 147 |
| CONTRACT NO. 60L77 | | | | |
| ILLINOIS FED. AID PROJECT | | | | |

S:\1101\95-CADD\60L77_IL_173\60L77_Sheets\0160L77-plt-staging\95_1B.dgn