

**LEGEND:**

LONGITUDINAL KEYED CONSTRUCTION JOINT PER STD. 420001 (SHALL BE INCLUDED IN THE COST OF THE PORTLAND CEMENT CONCRETE PAVEMENT, (JOINTED) PAY ITEM OF THE SPECIFIED THICKNESS)

LONGITUDINAL SAWED OR CONSTRUCTION JOINT PER STD. 420001 (SHALL BE INCLUDED IN THE COST OF THE PORTLAND CEMENT CONCRETE PAVEMENT, (JOINTED) PAY ITEM OF THE SPECIFIED THICKNESS)

SAWED TRANSVERSE CONTRACTION JOINT PER STANDARD 420001 WITH HOT POUR SEAL

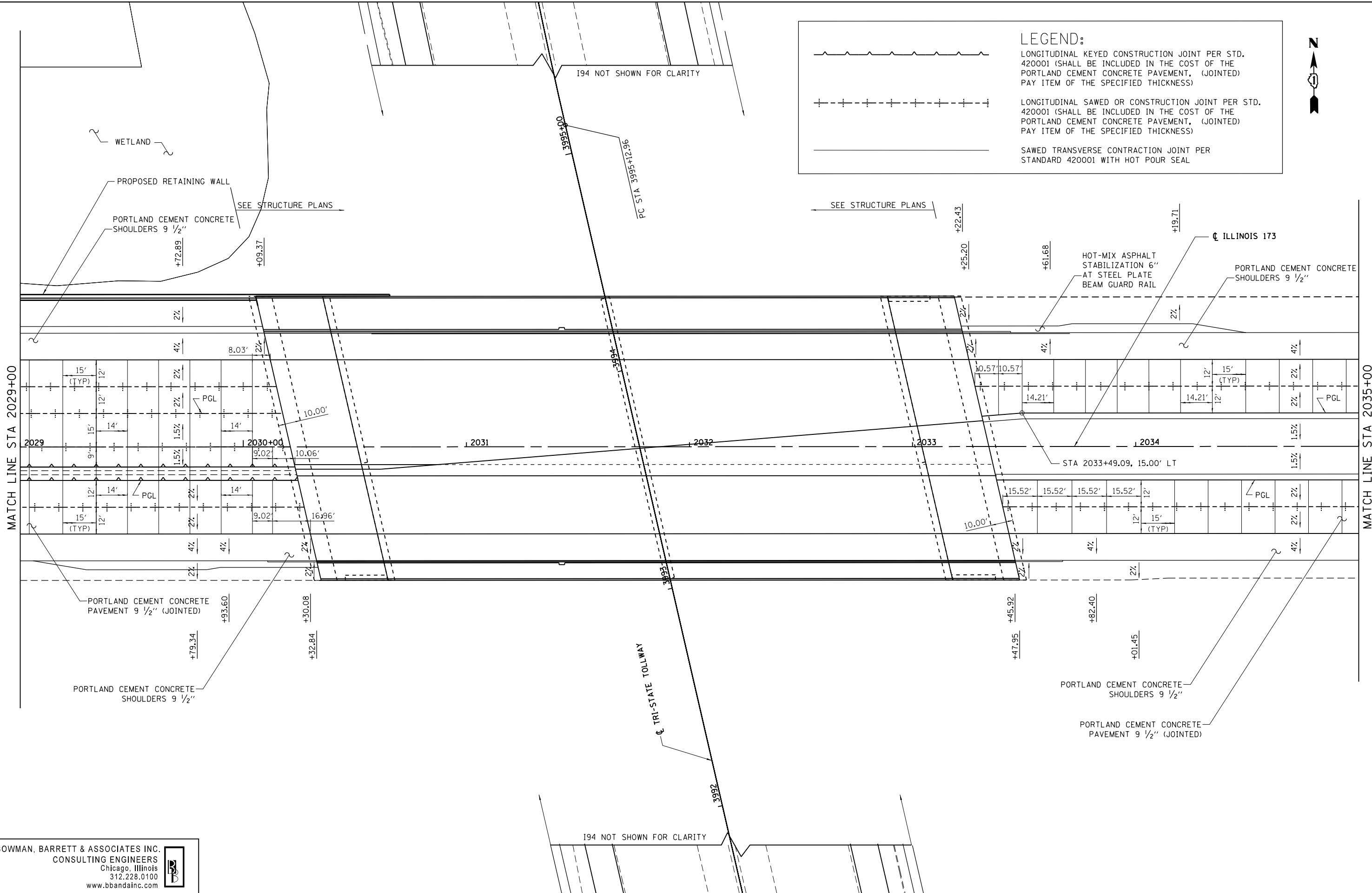

BOWMAN, BARRETT & ASSOCIATES INC.  
 CONSULTING ENGINEERS  
 Chicago, Illinois  
 312.228.0100  
 www.bbainc.com

FILE NAME = \$FILES\$	USER NAME = default	DESIGNED - JMG	REVISED -
		DRAWN - JMG	REVISED -
	PLOT SCALE = H=1"=10' V=1"=5'	CHECKED - RGR	REVISED -
	PLOT DATE = 6/20/2012	DATE - 6/19/2012	REVISED -

**STATE OF ILLINOIS  
 DEPARTMENT OF TRANSPORTATION**

**ILLINOIS 173 JOINTING PLAN**

SCALE: 1" = 1120'    SHEET NO. 13 OF 17 SHEETS    STA. 2029+00 TO STA. 2035+00

F.A. RTE.	SECTION	COUNTY	TOTAL SHEETS	SHEET NO.
94	49-1-R-1	LAKE	677	240
<b>CONTRACT NO. 60L77</b>				
ILLINOIS FED. AID PROJECT				

S:\1101\95-CADD\60L77 IL 173\60L77 Sheets\0160L77-shr-jointing13.dgn