

NOTES

1. ELEVATIONS ARE GIVEN EVERY 20 FEET ON EVEN STATIONS UNLESS OTHERWISE NOTED.

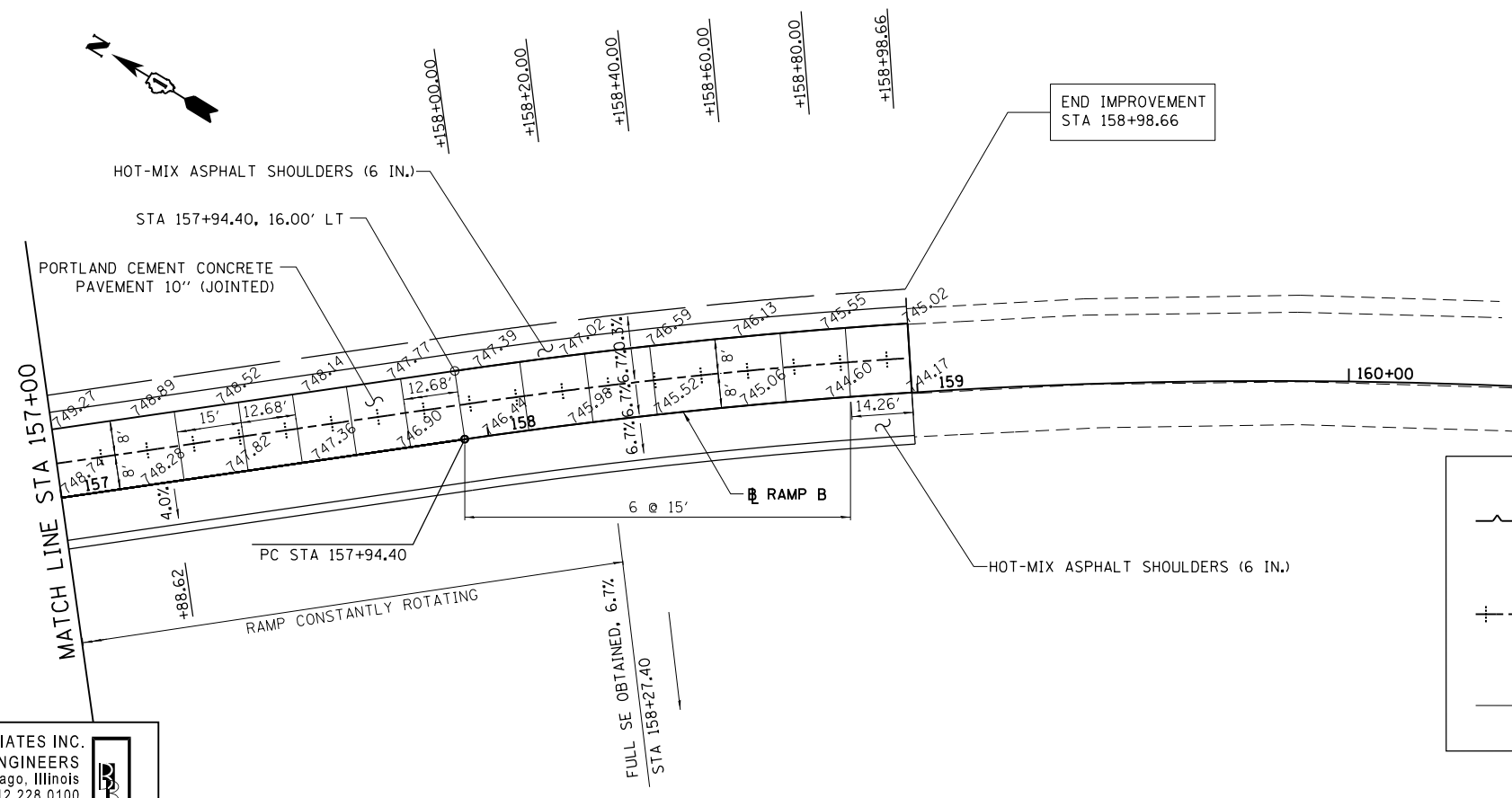
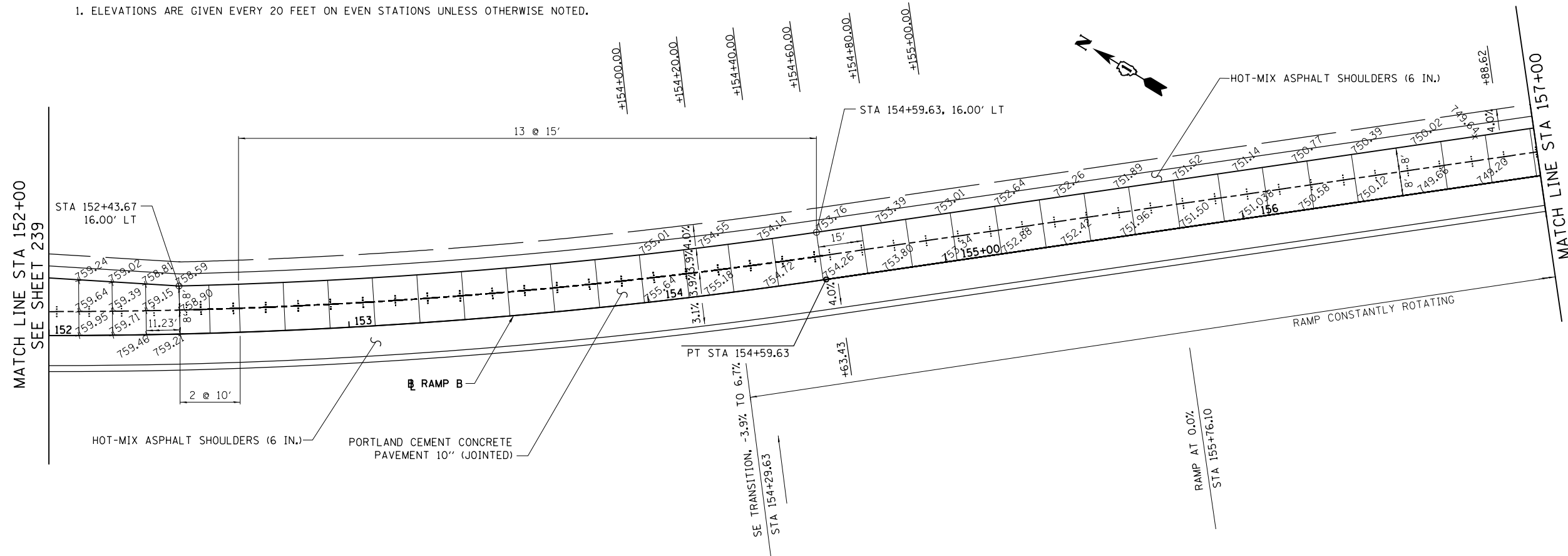

LEGEND:

	LONGITUDINAL KEYPED CONSTRUCTION JOINT PER STD. 420001 (SHALL BE INCLUDED IN THE COST OF THE PORTLAND CEMENT CONCRETE PAVEMENT, (JOINTED) PAY ITEM OF THE SPECIFIED THICKNESS)
	LONGITUDINAL SAWED OR CONSTRUCTION JOINT PER STD. 420001 (SHALL BE INCLUDED IN THE COST OF THE PORTLAND CEMENT CONCRETE PAVEMENT, (JOINTED) PAY ITEM OF THE SPECIFIED THICKNESS)
	SAWED TRANSVERSE CONTRACTION JOINT PER STANDARD 420001 WITH HOT POUR SEAL

BOWMAN, BARRETT & ASSOCIATES INC.
 CONSULTING ENGINEERS
 Chicago, Illinois
 312.228.0100
 www.bbandainc.com

FILE NAME = #FILES#	USER NAME = default	DESIGNED - JMG	REVISED -
		DRAWN - JMG	REVISED -
	PLOT SCALE = H1"=10' V1"=5'	CHECKED - RGR	REVISED -
	PLOT DATE = 6/20/2012	DATE - 6/19/2012	REVISED -

STATE OF ILLINOIS
 DEPARTMENT OF TRANSPORTATION

ILLINOIS 173 RAMP B JOINTING PLAN
 SCALE: 1" = 20'
 SHEET NO. 16 OF 17 SHEETS
 STA. 152+00 TO STA. 158+98.66

F.A. RTE.	SECTION	COUNTY	TOTAL SHEETS	SHEET NO.
94	49-1-R-1	LAKE	677	243
CONTRACT NO. 60L77				
ILLINOIS FED. AID PROJECT				

S:\1101\95-CADD\60L77 IL 173\60L77 Sheets\0160L77-INT-jointing16.dgn