

DATE	
BY	
FINAL SURVEY	
PLOTTED	
NOTE BOOK	
TEMPLATE	
AREAS CHECKED	
NO.	

DATE	
BY	
ORIGINAL SURVEY	
PLOTTED	
NOTE BOOK	
TEMPLATE	
AREAS CHECKED	
NO.	

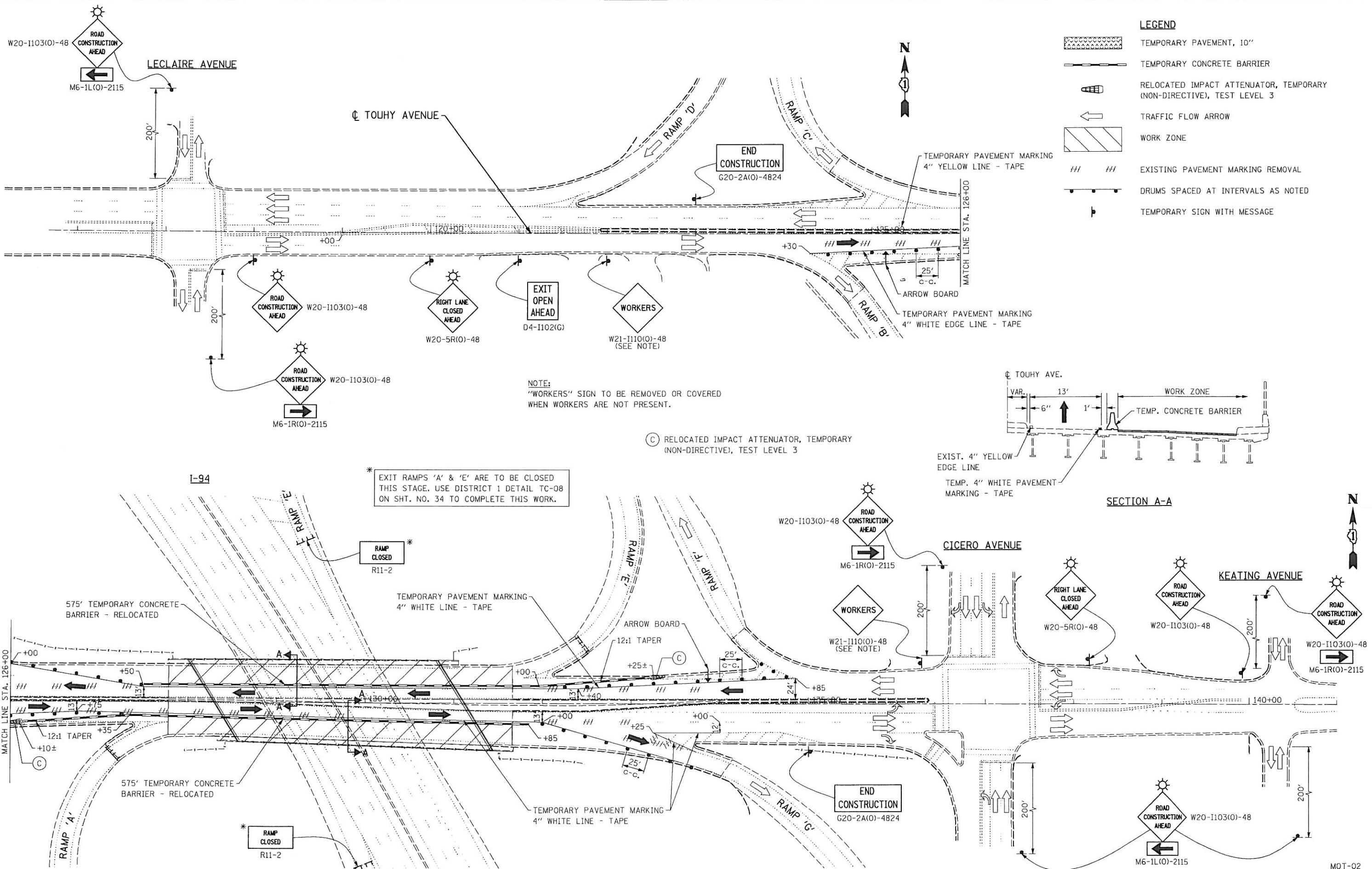

LEGEND

	TEMPORARY PAVEMENT, 10"
	TEMPORARY CONCRETE BARRIER
	RELOCATED IMPACT ATTENUATOR, TEMPORARY (NON-DIRECTIVE), TEST LEVEL 3
	TRAFFIC FLOW ARROW
	WORK ZONE
	EXISTING PAVEMENT MARKING REMOVAL
	DRUMS SPACED AT INTERVALS AS NOTED
	TEMPORARY SIGN WITH MESSAGE

NOTE:
"WORKERS" SIGN TO BE REMOVED OR COVERED WHEN WORKERS ARE NOT PRESENT.

(C) RELOCATED IMPACT ATTENUATOR, TEMPORARY (NON-DIRECTIVE), TEST LEVEL 3

* EXIT RAMP 'A' & 'E' ARE TO BE CLOSED THIS STAGE. USE DISTRICT 1 DETAIL TC-08 ON SHT. NO. 34 TO COMPLETE THIS WORK.

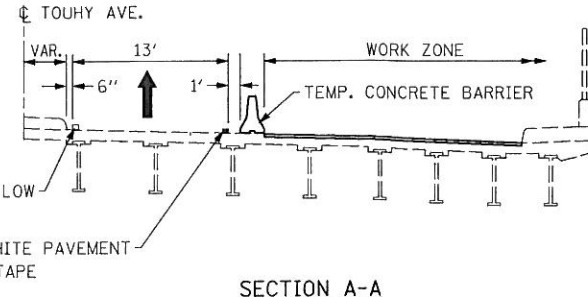

FILE NAME = D160P72-shr-stage2.01.dgn
 PLOT DATE = 5/14/2012
 PLOT SCALE = 58.0000' / IN.

CHRISTIAN-ROGE & ASSOCIATES, INC.
 ENGINEERS-PLANNERS-SURVEYORS
 211 WEST WACKER DRIVE
 CHICAGO, ILLINOIS 60606
 PHONE: (312)372-2023 FAX: (312)372-5274

DESIGNED -	E.J.M.	REVISED -	
DRAWN -	B.K.	REVISED -	
CHECKED -	G.F.L.	REVISED -	
DATE -	MAY 2012	REVISED -	

STATE OF ILLINOIS
DEPARTMENT OF TRANSPORTATION

TRAFFIC CONTROL AND PROTECTION
TOUHY AVENUE OVER I-94
STAGE II

SCALE: SHEET NO. OF SHEETS STA. TO STA.

F.A.I. RTE.	SECTION	COUNTY	TOTAL SHEETS	SHEET NO.
94	0304.1 HB-I-2	COOK	44	10
CONTRACT NO. 60P72				
FED. ROAD DIST. NO. 1 ILLINOIS FED. AID PROJECT				

MOT-02