

SPECIFICATIONS, STANDARDS AND SPECIAL PROVISIONS

ALL REFERENCES TO STANDARD SPECIFICATIONS IN THESE GENERAL NOTES SHALL BE INTERPRETED TO MEAN THE "STANDARD SPECIFICATIONS FOR ROAD AND BRIDGE CONSTRUCTION" ADOPTED BY THE ILLINOIS DEPARTMENT OF TRANSPORTATION, JANUARY 1, 2012 AND THE SUPPLEMENTAL SPECIFICATIONS AND RECURRING SPECIAL PROVISIONS, ADOPTED JANUARY 1, 2012.

ALL CONSTRUCTION SHALL BE IN ACCORDANCE WITH THE STANDARD SPECIFICATIONS; THE LATEST EDITION OF THE "MANUAL ON UNIFORM TRAFFIC CONTROL DEVICES FOR STREETS AND HIGHWAYS" (MUTCD); THE DETAILS IN THE PLANS AND THE SPECIAL PROVISIONS, IDOT STANDARD DRAWINGS, VILLAGE OF BUFFALO GROVE, VILLAGE OF ARLINGTON HEIGHTS, AND VILLAGE OF WHEELING.

ALL REFERENCE TO "ENGINEER" SHALL BE INTERPRETED AS THE RESIDENT ENGINEER.

DISTRICT ONE DETAILS:

- BD--01 DRIVEWAY DETAILS DISTANCE BETWEEN R.O.W. AND FACE OF CURB/EDGE OF SHOULDER \geq 15'
- BD--02 DRIVEWAY DETAILS DISTANCE BETWEEN R.O.W. AND FACE OF CURB $<$ 15' (4.5M)
- BD--24 CURB OR CURB AND GUTTER REMOVAL AND REPLACEMENT
- BD--32 BUTT JOINT AND HMA TAPER DETAILS
- TC--10 TRAFFIC CONTROL AND PROTECTION FOR SIDE ROADS, INTERSECTIONS, AND DRIVEWAYS
- TC--13 DISTRICT ONE TYPICAL PAVEMENT MARKINGS
- TC--22: ARTERIAL ROAD INFORMATION SIGN

EARTHWORK SCHEDULE		
LOCATION	REMOVAL AND DISPOSAL OF UNSUITABLE MATERIAL (CU. YD.)	TOPSOIL FURNISH AND PLACE, 4" (SQ. YD.)
STA. 00+07 TO STA. 10+00	457	3590
STA. 10+00 TO STA. 59+50	145	167
STA. 59+50 TO STA. 70+00	306	332
STA. 70+00 TO STA. 77+88	227	336
STA. 83+07 TO STA. 92+00	106	350
STA. 92+00 TO STA. 94+72	132	728
TOTAL	1373	5503

HOT-MIX ASPHALT MIXTURE REQUIREMENTS	
MIXTURE TYPE	AIR VOIDS @ Hdes
DRIVEWAYS	
HMA SURFACE COURSE, MIX D, N 50 (IL 9.5 mm); 2"	4% @ 50 GYR
HMA BASE COURSE (HMA BINDER IL-19 mm);	4% @ 50 GYR
PE - 6" (3 LIFTS), CE - 8" (4 LIFTS)	4% @ 50 GYR

THE UNIT WEIGHT USED TO CALCULATE ALL HMA SURFACE MIXTURE QUANTITIES IS 112 LBS/SQ YD/IN.

THE "AC TYPE" FOR POLYMERIZED HMA MIXES SHALL BE SBS/SBR PG76-22" AND FOR NONPOLYMERIZED HMA THE "AC TYPE" SHALL BE "PG 64-22" UNLESS MODIFIED BY DISTRICT ONE.

FOR PERCENT OF RAP SEE DISTRICT ONE SPECIAL PROVISIONS.

GENERAL NOTES

1. THE CONTRACTOR SHALL NOTIFY J.U.L.I.E. (800-892-0123) AT LEAST 48 HOURS PRIOR TO CONSTRUCTION FOR LOCATIONS OF UTILITIES, AND SHALL BE RESPONSIBLE FOR THE PROTECTION OF THE SAME.
2. THE CONTRACTOR SHALL CONTACT IDOT TRAFFIC CONTROL SUPERVISOR AT (847) 705-4470 A MINIMUM OF 72 HOURS PRIOR TO BEGINNING ANY WORK IN STATE ROW.
3. THE CONTRACTOR SHALL NOTIFY BURNS & McDONNELL (THE ENGINEER), IDOT, THE VILLAGE OF BUFFALO GROVE & THE VILLAGE OF WHEELING AT LEAST 48 HOURS IN ADVANCE OF CONSTRUCTION. NO UNDERGROUND WORK SHALL BE COVERED UNTIL IT HAS BEEN INSPECTED. APPROVAL TO PROCEED MUST BE OBTAINED FROM THE ENGINEER PRIOR TO POURING ANY CONCRETE AFTER FORMS HAVE BEEN SET.
4. CONTRACTORS ARE CAUTIONED AGAINST INSTITUTING ANY CHANGES AND/OR SUBSTITUTIONS TO THE PROJECT REPRESENTED BY THESE DRAWINGS WITHOUT PRIOR WRITTEN APPROVAL BY THE ENGINEER. VISUAL CONTACT WITH THESE DRAWINGS SHALL CONSTITUTE CONCLUSIVE EVIDENCE OF ACCEPTANCE OF THESE RESTRICTIONS.
5. WRITTEN DIMENSIONS ON THESE DRAWINGS SHALL TAKE PRECEDENCE OVER SCALED DIMENSIONS. CONTRACTORS SHALL VERIFY AND BE RESPONSIBLE FOR ALL ELEVATIONS, DIMENSIONS, AND CONDITIONS ON THE JOB. THE ENGINEER SHALL BE NOTIFIED AS SOON AS POSSIBLE OF ANY VARIATIONS FROM THE DIMENSIONS AND CONDITIONS SHOWN ON THESE DRAWINGS.
6. THE CONTRACTOR SHALL BE RESPONSIBLE FOR THE PROTECTION OF ALL PUBLIC AND PRIVATE UTILITIES, EVEN THOUGH THEY MAY NOT BE SHOWN ON THE DRAWINGS. ANY UTILITY DAMAGES DURING CONSTRUCTION SHALL BE REPAIRED OR REPLACED TO THE SATISFACTION OF THE OWNER AT THE CONTRACTOR'S EXPENSE.
7. THE CONTRACTOR SHALL BE RESPONSIBLE FOR REMOVING IMMEDIATELY ANY MUD, DIRT, OR DEBRIS DEPOSITED ON ROADWAYS FROM ANY VEHICLES EXITING OR ENTERING THE SITE.
8. THE CONTRACTOR IS ESPECIALLY ALERTED TO THE FACT THAT IT IS HIS RESPONSIBILITY TO GUARD AND PROTECT NEWLY POURED CONCRETE AGAINST ANY FOREIGN MARKINGS, GRAFFITI OR OTHER DAMAGE, AND AT HIS EXPENSE, REPLACE ANY SIDEWALK NOT ACCEPTABLE TO THE ENGINEER.
9. TRAFFIC CONTROL SHALL CONFORM TO IDOT'S HIGHWAY STANDARDS AND THE "MANUAL ON UNIFORM TRAFFIC CONTROL DEVICES FOR STREETS AND HIGHWAYS" AT ALL TIMES DURING CONSTRUCTION. TRAFFIC CONTROL SHALL INCLUDE ADVANCE WARNING LANE CLOSURE SIGNAGE, AN ARROW BOARD AND TYPE II BARRICADES OR DRUMS.
10. THE CONTRACTOR SHALL COORDINATE CONSTRUCTION ACTIVITIES WITH UTILITY COMPANIES AND THE VILLAGE OF BUFFALO GROVE.
11. ANY SIGNAGE AFFECTED DURING CONSTRUCTION SHALL BE REPLACED TO ITS ORIGINAL CONDITION (OR REPLACED) AND LOCATION (OR AS CLOSE AS REASONABLE).
12. THE RESIDENT ENGINEER SHALL CONTACT WALTER CZARNY, IDOT AREA TRAFFIC FIELD ENGINEER, AT 847-715-8419 A MINIMUM OF 2 WEEKS PRIOR TO PLACING PERMANENT PAVEMENT MARKINGS.



13. THE GENERAL CONTRACTOR IS REQUIRED TO HIRE AN ENVIRONMENTAL FIRM WITH AT LEAST FIVE (5) DOCUMENTED LEAKING UNDERGROUND STORAGE TANK CLEANUPS OR THAT IS PRE-QUALIFIED IN HAZARDOUS WASTE IN THE DEPARTMENT TO REMEDIATE THE SOIL CONTAMINATION AND MONITOR FOR WORKERS PROTECTION.

TREE SCHEDULE

Tree Removal		Proposed Tree	
Station	Offset	Station	Offset
4+90.88	39.79 LT	56+25.86	34.92 LT
6+65.98	40.84 LT	56+75.98	35.86 LT
8+35.03	40.23 LT	57+25.25	35.73 LT
11+60.63	46.75 LT	58+77.20	34.95 LT
12+33.48	47.37 LT	71+48.59	42.85 LT
12+73.17	47.49 LT	71+83.46	43.22 LT
13+12.93	46.61 LT	72+25.86	43.45 LT
64+80.56	39.77 LT	72+61.86	43.24 LT
68+31.74	42.67 LT	72+93.91	42.96 LT
68+69.72	42.00 LT	73+26.78	42.89 LT
69+00.94	42.43 LT	73+63.70	42.86 LT
69+42.06	42.20 LT	73+98.02	42.74 LT
69+79.83	42.52 LT	74+46.53	43.52 LT
70+24.43	44.34 LT	74+80.10	43.62 LT
70+74.74	47.76 LT	75+27.32	44.06 LT
71+19.22	50.16 LT	77+61.87	48.21 LT
74+50.66	55.25 LT	84+66.29	48.03 LT

SUMMARY OF QUANTITIES

SP	CODE NO.	ITEM	UNIT	TOTAL QUANTITY	CONSTRUCTION CODE	
					CMAQ	
					100% VILLAGE STREETScape 0031 URBAN	80% FED 20% VILLAGE ROADWAY 0021 URBAN
	20100110	TREE REMOVAL (6 TO 15 UNITS DIAMETER)	UNIT	235		235
	20100210	TREE REMOVAL (OVER 15 UNITS DIAMETER)	UNIT	58		58
	20101000	TEMPORARY FENCE	FOOT	175		175
A	20101200	TREE ROOT PRUNING	EACH	6		6
A	20101400	NITROGEN FERTILIZER NUTRIENT	POUND	53		53
A	20101500	PHOSPHORUS FERTILIZER NUTRIENT	POUND	53		53
A	20101600	POTASSIUM FERTILIZER NUTRIENT	POUND	53		53
	20201200	REMOVAL AND DISPOSAL OF UNSUITABLE MATERIAL	CU YD	1363		1363
A	21101615	TOPSOIL FURNISH AND PLACE, 4"	SQ YD	5024		5024
A	25200110	SODDING, SALT TOLERANT	SQ YD	5024		5024
A	25200200	SUPPLEMENTAL WATERING	UNIT	38		38
	28000610	INLET FILTERS	EACH	27		27
	35101500	AGGREGATE BASE COURSE, TYPE B	CU YD	683		683
	35501308	HOT-MIX ASPHALT BASE COURSE, 6"	SQ YD	3		3
	35501316	HOT-MIX ASPHALT BASE COURSE, 8"	SQ YD	21		21
	40201000	AGGREGATE FOR TEMPORARY ACCESS	TON	24		24
	40603336	HOT-MIX ASPHALT SURFACE COURSE, MIX "D", N50	TON	2		2
	42300400	PORTLAND CEMENT CONCRETE DRIVEWAY PAVEMENT, 8 INCH	SQ YD	769		769
	42400200	PORTLAND CEMENT CONCRETE SIDEWALK 5 INCH	SQ FT	31254		31254
	42400400	PORTLAND CEMENT CONCRETE SIDEWALK 7 INCH	SQ FT	5543		5543
	42400600	DETECTABLE WARNINGS	SQ FT	834		834
	44000200	DRIVEWAY PAVEMENT REMOVAL	SQ YD	1410		1410
	44000500	COMBINATION CONCRETE CURB AND GUTTER REMOVAL	FOOT	851		851
	44000600	SIDEWALK REMOVAL	SQ FT	17992		17992
	60256500	MANHOLES TO BE ADJUSTED	EACH	5		5
	60603800	COMBINATION CONCRETE CURB & GUTTER, TYPE B-8-12	FOOT	793		793
	63200310	GUARDRAIL REMOVAL	FOOT	14		14
	63700175	CONCRETE BARRIER, SINGLE FACE, 42-INCH HEIGHT	FOOT	290		290
	67100100	MOBILIZATION	L SUM	1		1
	70102630	TRAFFIC CONTROL AND PROTECTION, STANDARD 701601	L SUM	1		1
	70102632	TRAFFIC CONTROL AND PROTECTION, STANDARD 701602	L SUM	1		1
	70102635	TRAFFIC CONTROL AND PROTECTION, STANDARD 701701	L SUM	1		1
	70102640	TRAFFIC CONTROL AND PROTECTION, STANDARD 701801	L SUM	1		1
A	78000100	THERMOPLASTIC PAVEMENT MARKING - LETTERS AND SYMBOLS	SQ FT	22		22
A	66900200	NON-SPECIAL WASTE DISPOSAL	SQ YD	2,000		2,000
A	66900400	SPECIAL WASTE BILLS AND REPORTS	L SUM	1		1
A	66900500	SOIL DISPOSAL ANALYSIS	EACH	5		5
A	20076500	TRAINEES TRAINING PROGRAM GRADUATE	Hour	500		500

SP	CODE NO.	ITEM	UNIT	TOTAL QUANTITY	CONSTRUCTION CODE	
					CMAQ	
					100% VILLAGE STREETScape 0031 URBAN	80% FED 20% VILLAGE ROADWAY 0021 URBAN
A	78000400	THERMOPLASTIC PAVEMENT MARKING - LINE 6"	FOOT	534		534
A	78000650	THERMOPLASTIC PAVEMENT MARKING - LINE 24"	FOOT	16		16
A	B2003116	TREE, MALUS CORALBURST, (CORALBURST CRABAPPLE), 2" CALIPER, TREE FORM, BALLED AND BURLAPPED	EACH	18		18
A	C2009918	SHRUB, SPIREA X BUMALDA GOLDFLAME (GOLD FLAME BUMALDA SPIREA), 18" HEIGHT CONTAINER	EACH	5		5
A	C2012824	SHRUB VIBURNUM TRILOBUM BAILEY COMPACT (BAILEY COMPACT AMERICAN CRANBERRY VIBURNUM), 2' HEIGHT, CONTAINER	EACH	10		10
A	C2C15781	SHRUB, SPIREA JAPONICA NEON FLASH (NEON FLASH JAPANESE SPIREA), 18" HEIGHT, 5 GALLON CONTAINER	EACH	11		11
A	K0012990	PERENNIAL PLANTS, ORNAMENTAL TYPE, GALLON POT	UNIT	24		24
	K0020830	SHRUB REMOVAL	EACH	57	57	
A	X0324815	RELOCATE LIGHTING UNITS AND POLES	EACH	2	2	
A	X000959	TRASH RECEPTACLES	EACH	4	4	
A	X002133	RELOCATE SIGN AND BASE	EACH	2		2
	X0006428	SIDEWALK SPECIAL	SQ FT	126		126
	X006898	STAMPED COLORED PORTLAND CEMENT CONCRETE	SQ FT	495	495	
A	20003850	BENCHES	EACH	4	4	
	20013798	CONSTRUCTION LAYOUT	L SUM	1		1
	20030850	TEMPORARY INFORMATION SIGNING	SQ FT	27		27
	20052000	SAW CUTTING	FOOT	1588		1588
	20076500	TRAINEES	Hour	500		500

Construction Type Code 0042
A SPECIALTY ITEMS

PLAN SHEET NO. 343
DATE 08-16-2010
DRAWN BY TWC
CHECKED BY AUB
DESIGNED BY TWC

PROFILE SHEET NO. 343
DATE 08-16-2010
DRAWN BY TWC
CHECKED BY AUB
DESIGNED BY TWC

PLAN SHEET C001
 DRAWN BY: TMC
 CHECKED BY: AUS
 DATE: 8-16-2010
 PROJECT: DUNDEE ROAD IMPROVEMENTS
 CONTRACT NO. 63614

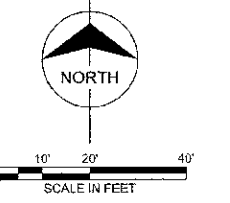
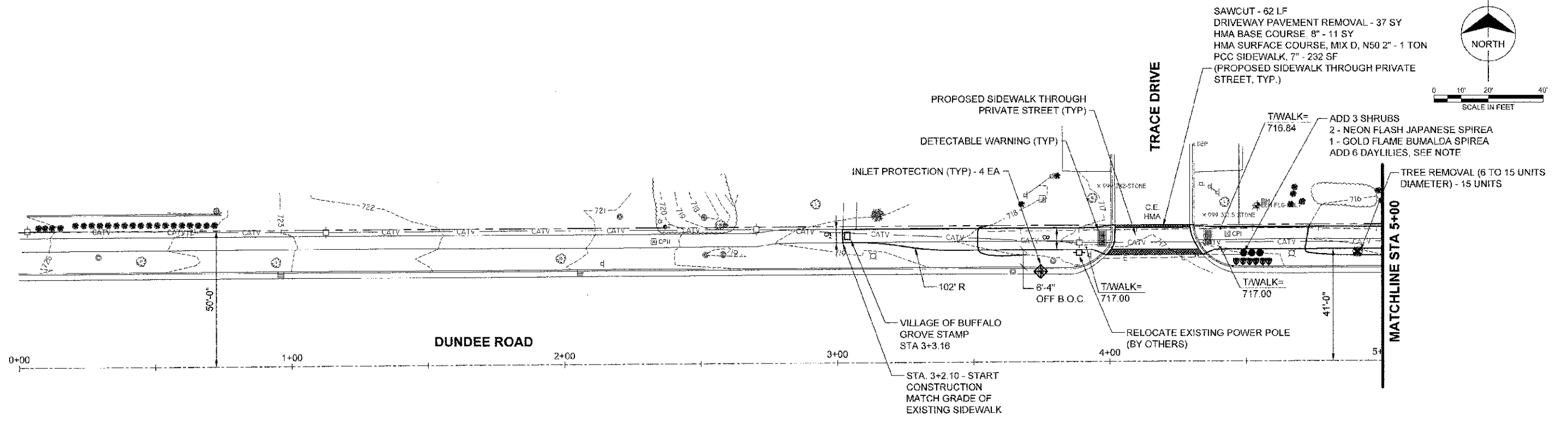

PLAN SHEET C001
 DRAWN BY: TMC
 CHECKED BY: AUS
 DATE: 8-16-2010
 PROJECT: DUNDEE ROAD IMPROVEMENTS
 CONTRACT NO. 63614

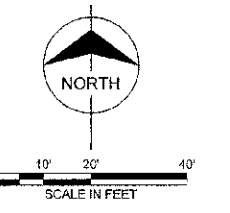
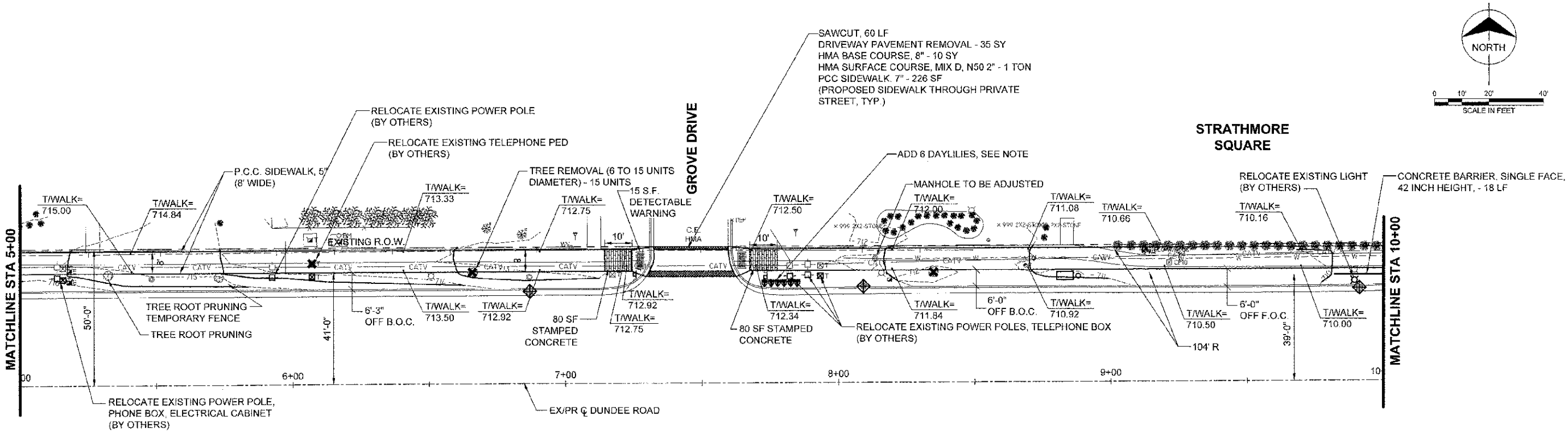

NOTES:
 1. UTILIZE EQUAL QUANTITIES OF THE FOLLOWING FOR DAY LILIES:
 HEMEROCALLIS HAPPY RETURNS (HAPPY RETURNS DAYLILY), 1-GALLON CONTAINER
 HEMEROCALLIS CHICAGO APACHE (CHICAGO APACHE DAYLILY), 1-GALLON CONTAINER
 HEMEROCALLIS ROSY RETURNS (ROSY RETURNS DAYLILY), 1-GALLON CONTAINER
 2. THE GENERAL CONTRACTOR IS REQUIRED TO HIRE AN ENVIRONMENTAL FIRM WITH AT LEAST FIVE (5) DOCUMENTED LEAKING UNDERGROUND STORAGE TANK CLEANUPS OR THAT IS PRE-QUALIFIED IN HAZARDOUS WASTE BY THE DEPARTMENT TO REMEDIATE THE SOIL CONTAMINATION AND MONITOR FOR WORKERS PROTECTION.

QUANTITIES
 25 LF TEMPORARY FENCE
 60 SF DETECTABLE WARNING
 3085 SF SIDEWALK REMOVAL
 4937 SF PCC SIDEWALK, 5"
 458 SF PCC SIDEWALK, 7"
 2 TON HMA SURFACE COURSE, MIX "D", N 50

TITLE NAME: Dundee Road	USER NAME: D. CHAVIZ	DESIGNED: TMC	DATE: 7-26-2012
DRAWN: TMC	CHECKED: AUS	REVISIONS:	
DATE: 8-16-2010			

STATE OF ILLINOIS
DEPARTMENT OF TRANSPORTATION

PLAN SHEET C001
STA 0+00 TO 10+00

SCALE: 1" = 20' | SHEET NO. 1 OF 3 SHEETS | STA. 0+07 TO STA. 10+00

SECTION: 08-00095-00-SW	COUNTY: COOK	TOTAL SHEETS: 11	SHEET NO.: 5
CONTRACT NO. 63614		FED. ROAD DIST. NO. 1 - ILLINOIS FED. AID PROJECT	

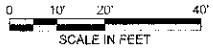

DATE	
BY	
CHECKED	
IN CHARGE	
PROJECT NO.	
PROJECT NAME	
SCALE	
DATE	

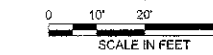
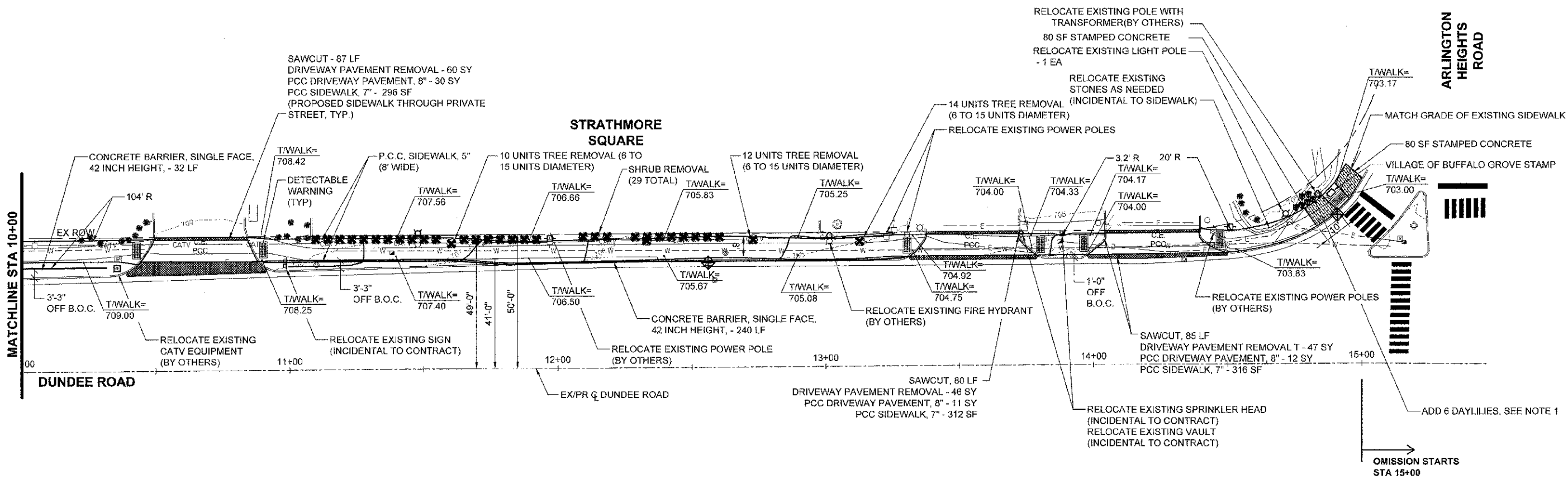

DATE	
BY	
CHECKED	
IN CHARGE	
PROJECT NO.	
PROJECT NAME	
SCALE	
DATE	

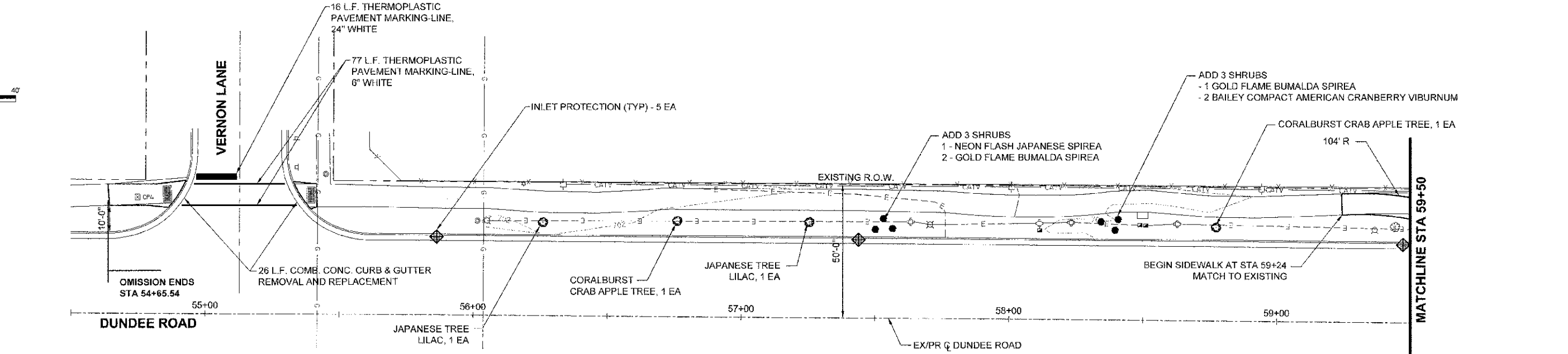

NOTES:

- UTILIZE EQUAL QUANTITIES OF THE FOLLOWING FOR DAY LILIES:
 HEMEROCALLIS HAPPY RETURNS (HAPPY RETURNS DAYLILY), 1-GALLON CONTAINER
 HEMEROCALLIS CHICAGO APACHE (CHICAGO APACHE DAYLILY), 1 GALLON CONTAINER
 HEMEROCALLIS ROSY RETURNS (ROSY RETURNS DAYLILY), 1-GALLON CONTAINER
- THE GENERAL CONTRACTOR IS REQUIRED TO HIRE AN ENVIRONMENTAL FIRM WITH AT LEAST FIVE (5) DOCUMENTED LEAKING UNDERGROUND STORAGE TANK CLEANUPS OR THAT IS PRE-QUALIFIED IN HAZARDOUS WASTE BY THE DEPARTMENT TO REMEDIATE THE SOIL CONTAMINATION AND MONITOR FOR WORKERS PROTECTION.

QUANTITIES	
135 SF	DETECTABLE WARNING
2500 SF	SIDEWALK REMOVAL
3458 SF	PCC SIDEWALK, 5"
924 SF	PCC SIDEWALK, 7"

REVISIONS				
NO.				
DATE				
BY				
DESCRIPTION				
1				
2				
3				
4				
5				
6				
7				
8				
9				
10				
11				
12				
13				
14				
15				
16				
17				
18				
19				
20				

PROFILE				
NO.				
DATE				
BY				
DESCRIPTION				
1				
2				
3				
4				
5				
6				
7				
8				
9				
10				
11				
12				
13				
14				
15				
16				
17				
18				
19				
20				

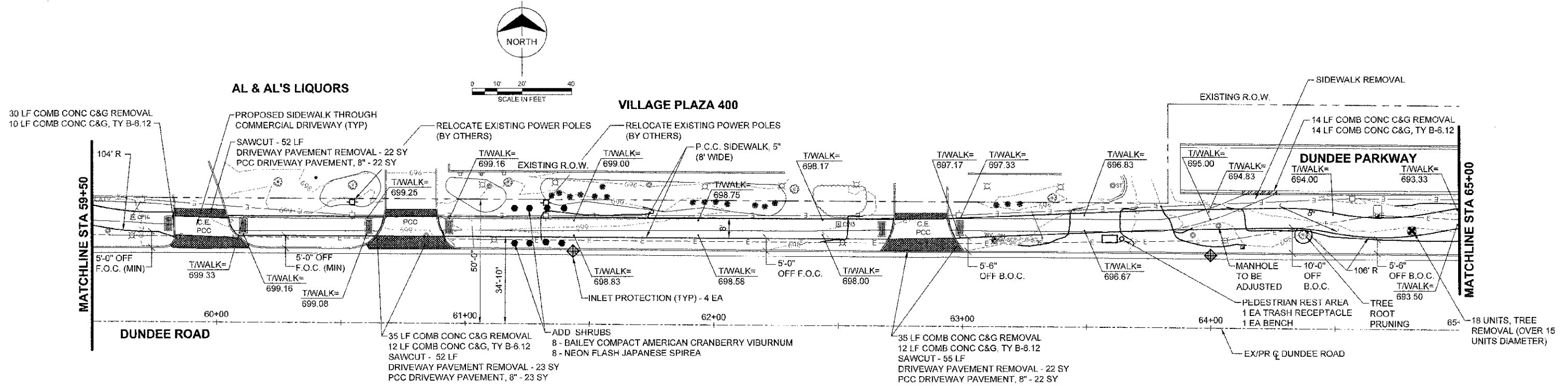

NOTES:

- UTILIZE EQUAL QUANTITIES OF THE FOLLOWING FOR DAY LILIES:
 HEMEROCALLIS HAPPY RETURNS (HAPPY RETURNS DAYLILY), 1-GALLON CONTAINER
 HEMEROCALLIS CHICAGO APACHE (CHICAGO APACHE DAYLILY), 1 GALLON CONTAINER
 HEMEROCALLIS ROSEY RETURNS (ROSEY RETURNS DAYLILY), 1-GALLON CONTAINER
- THE GENERAL CONTRACTOR IS REQUIRED TO HIRE AN ENVIRONMENTAL FIRM WITH AT LEAST FIVE (5) DOCUMENTED LEAKING UNDERGROUND STORAGE TANK CLEANUPS OR THAT IS PRE-QUALIFIED IN HAZARDOUS WASTE BY THE DEPARTMENT TO REMEDIATE THE SOIL CONTAMINATION AND MONITOR FOR WORKERS PROTECTION.

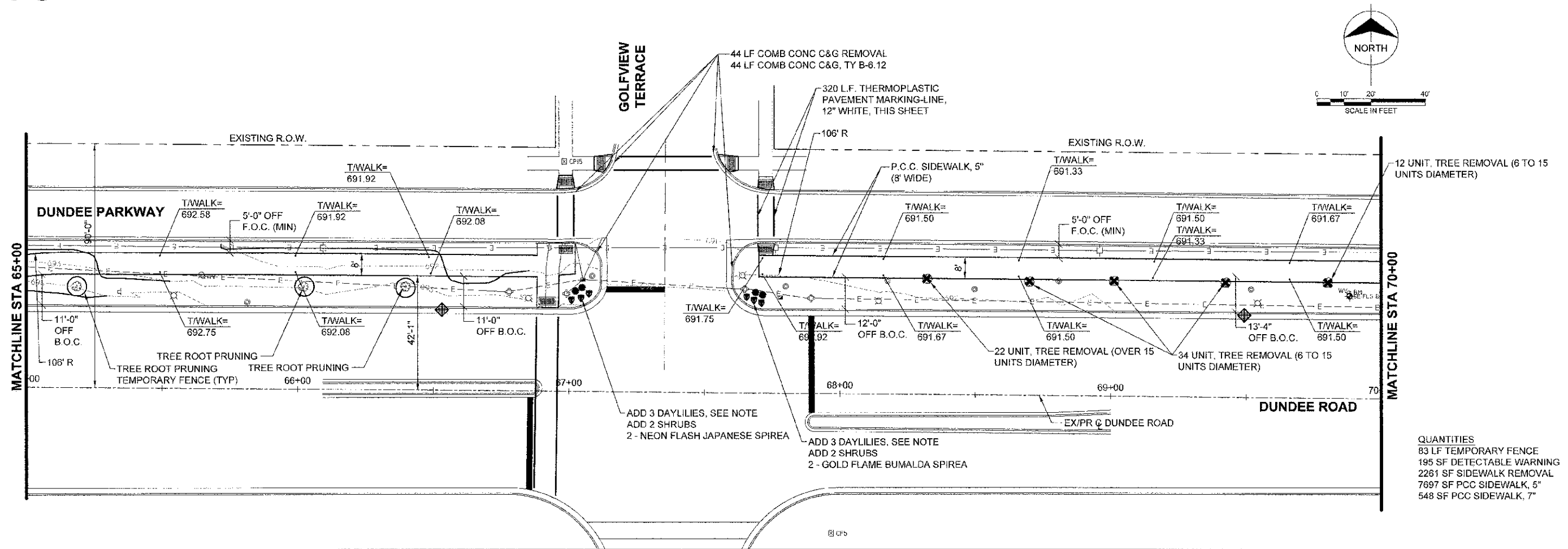

QUANTITIES
 83 LF TEMPORARY FENCE
 195 SF DETECTABLE WARNING
 2261 SF SIDEWALK REMOVAL
 7697 SF PCC SIDEWALK, 5"
 548 SF PCC SIDEWALK, 7"

FILE NAME: I:\Eulalia_Cove\54363 - Dundee Road Streetscape and Misc. Grant	DESIGNED: TWC	REVISOR: 7-26-2012	STATE OF ILLINOIS DEPARTMENT OF TRANSPORTATION	PLAN SHEET C003 STA 59+50 TO 70+00			SECTION: 08-30095-00-SW	COUNTY: COOK	TOTAL SHEETS: 11	SHEET NO: 7	
DRAWN: IWC	REVISOR: ---	REVISOR: ---		SCALE: 1"=20'	SHEET NO: 3 OF 6 SHEETS	STA. 59+50 TO STA. 70+00	CONTRACT NO. 63614				
CHECKED: AJB	REVISOR: ---	REVISOR: ---		RD. ROAD DIST. NO. 1 ILLINOIS FED. AID PROJECT							
DATE: 8-16-2010	REVISOR: ---	REVISOR: ---									
PROJECT DATE: 10/08/2010	REVISOR: ---	REVISOR: ---									

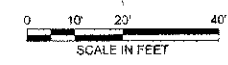

PLAN	NO. 1
DATE	8-16-2010
BY	...
CHECKED	...
DESIGNED	...
IN CHARGE	...

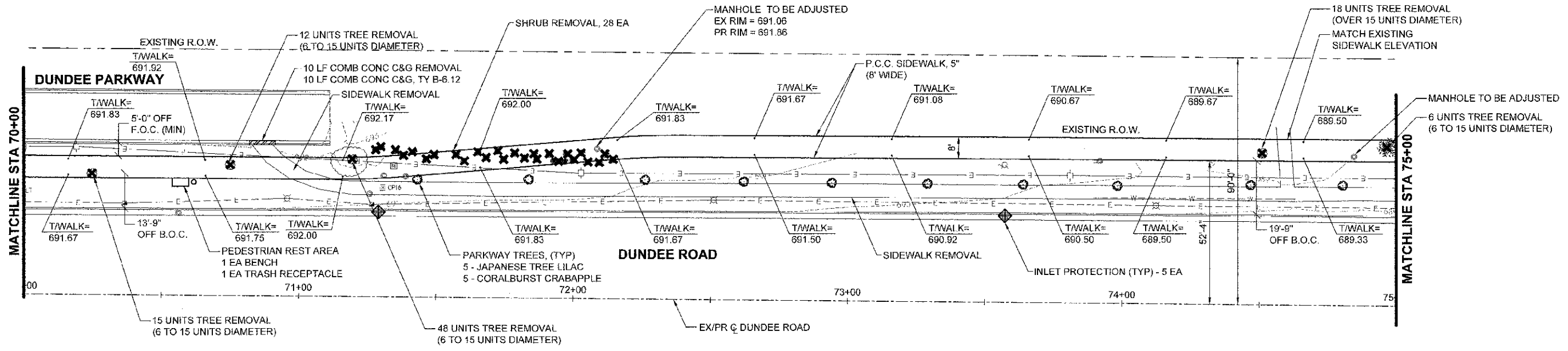

PLAN	NO. 2
DATE	8-16-2010
BY	...
CHECKED	...
DESIGNED	...
IN CHARGE	...

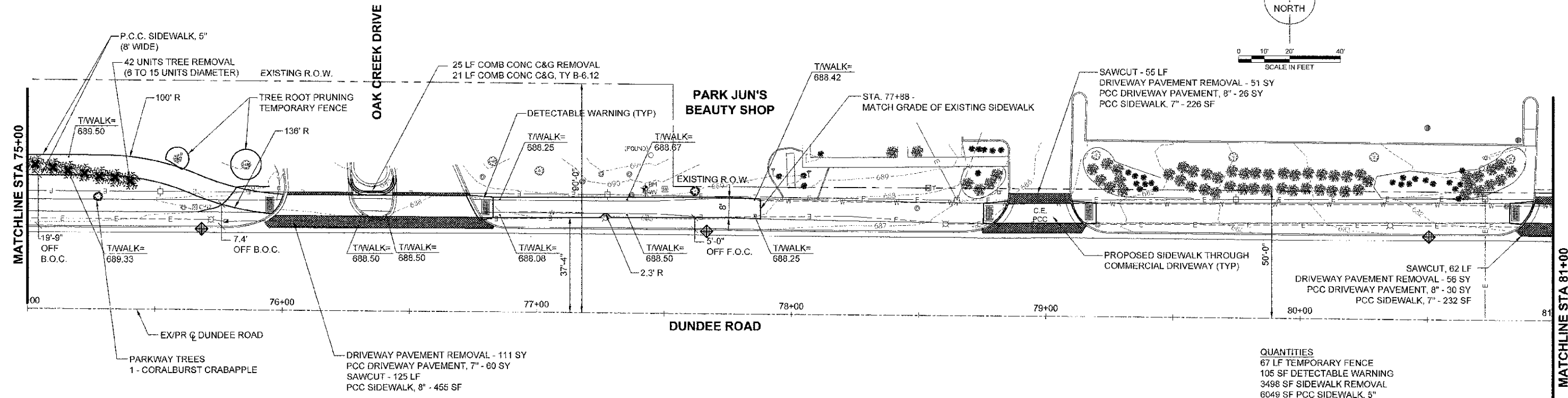
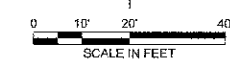

QUANTITIES

67 LF TEMPORARY FENCE
105 SF DETECTABLE WARNING
3498 SF SIDEWALK REMOVAL
6049 SF PCC SIDEWALK, 5"
913 SF PCC SIDEWALK, 7"

- NOTES:**
- UTILIZE EQUAL QUANTITIES OF THE FOLLOWING FOR DAY LILIES:
 HEMEROCALLIS HAPPY RETURNS (HAPPY RETURNS DAYLILY), 1 - GALLON CONTAINER
 HEMEROCALLIS CHICAGO APACHE (CHICAGO APACHE DAYLILY), 1 - GALLON CONTAINER
 HEMEROCALLIS ROBY RETURNS (ROBY RETURNS DAYLILY), 1 - GALLON CONTAINER
 - THE GENERAL CONTRACTOR IS REQUIRED TO HIRE AN ENVIRONMENTAL FIRM WITH AT LEAST FIVE (5) DOCUMENTED LEAKING UNDERGROUND STORAGE TANK CLEANUPS OR THAT IS PRE-QUALIFIED IN HAZARDOUS WASTE BY THE DEPARTMENT TO REMEDIATE THE SOIL CONTAMINATION AND MONITOR FOR WORKERS PROTECTION.

Project Name: Dundee Road
 Stationing: 70+00 to 81+00
 Date: 8-16-2010

DESIGNED	TMC	REVISION	7-26-2012
DRAWN	TMC	REVISION	
CHECKED	AJB	REVISION	
DATE	8-16-2010	REVISION	

**STATE OF ILLINOIS
 DEPARTMENT OF TRANSPORTATION**

**PLAN SHEET C004
 STA 70+00 TO 81+00**

SCALE: 1"=20'	SHEET NO. 4 OF 6 SHEETS	STA. 70+00 TO STA. 77+88	F.A.U. RTE. 1273	SECTION 08-00095-00-SW	COUNTY COOK	TOTAL SHEETS 11	SHEET NO. 8	CONTRACT NO. 63614
---------------	-------------------------	--------------------------	------------------	------------------------	-------------	-----------------	-------------	--------------------

PLAN	DATE
REVISED	
DATE	
BY	
NO.	

PROJECT	DATE
NO.	
NO.	
NO.	

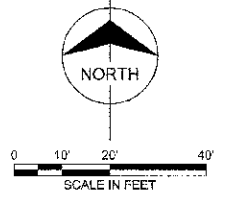
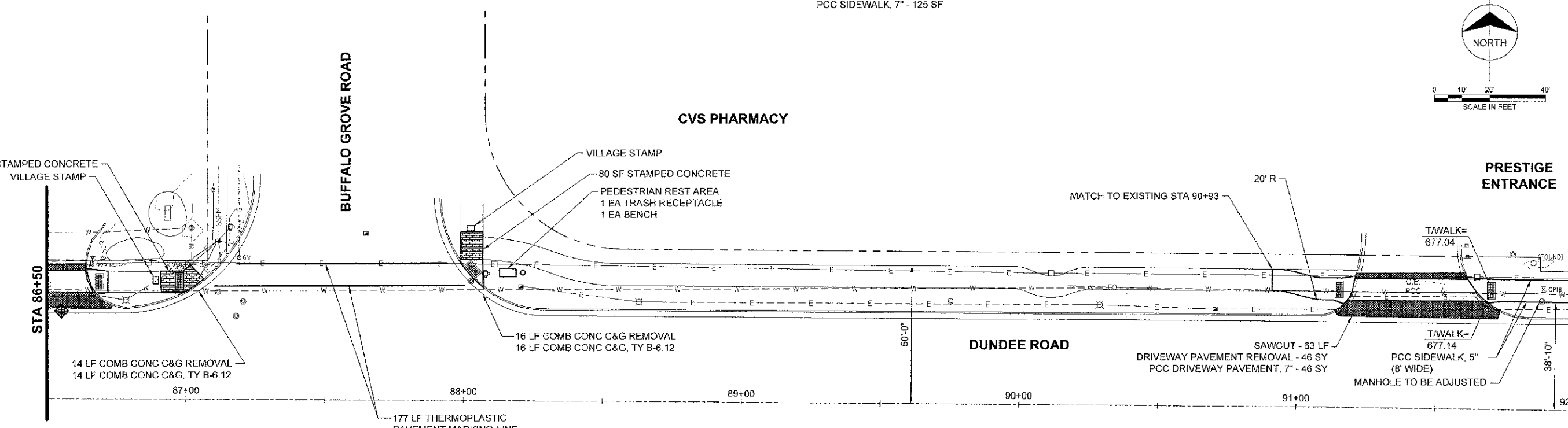
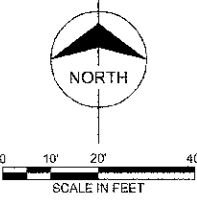
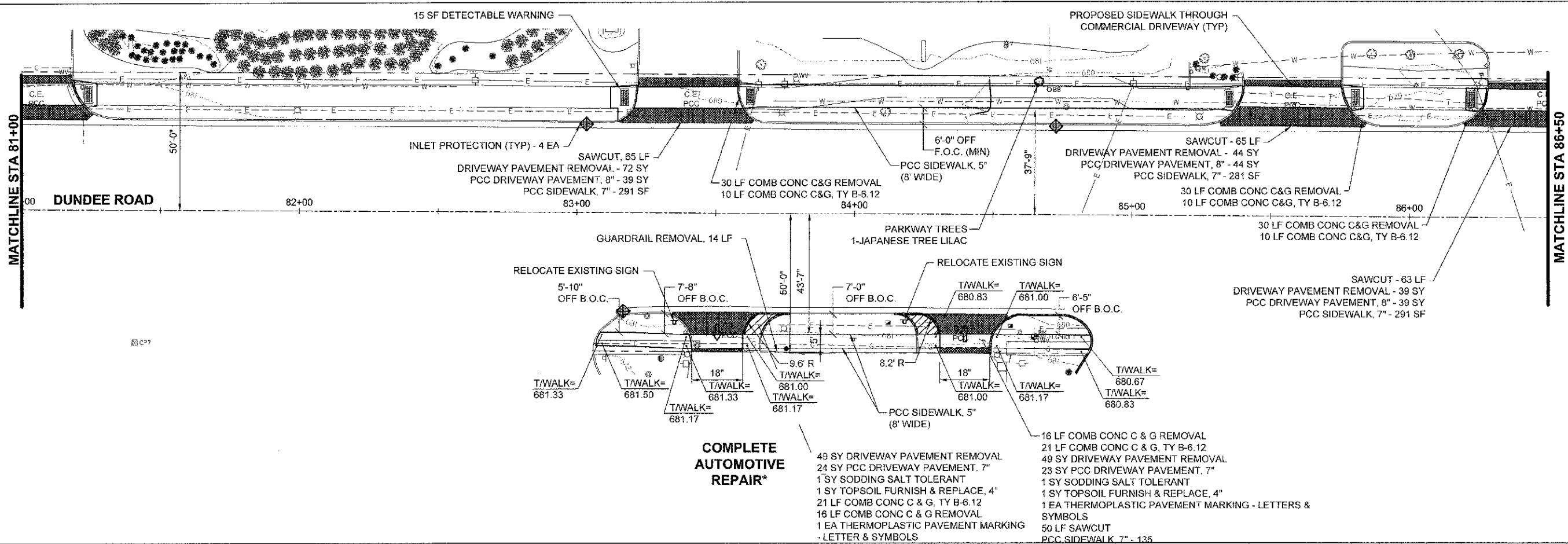

- NOTES:**
- UTILIZE EQUAL QUANTITIES OF THE FOLLOWING FOR DAY LILIES:
 HEMEROCALLIS HAPPY RETURNS (HAPPY RETURNS DAYLILY), 1-GALLON CONTAINER
 HEMEROCALLIS CHICAGO APACHE (CHICAGO APACHE DAYLILY), 1 GALLON CONTAINER
 HEMEROCALLIS ROSY RETURNS (ROSY RETURNS DAYLILY), 1 GALLON CONTAINER
 - THE GENERAL CONTRACTOR IS REQUIRED TO HIRE AN ENVIRONMENTAL FIRM WITH AT LEAST FIVE (5) DOCUMENTED LEAKING UNDERGROUND STORAGE TANK CLEANUPS OR THAT IS PRE-QUALIFIED IN HAZARDOUS WASTE BY THE DEPARTMENT TO REMEDIATE THE SOIL CONTAMINATION AND MONITOR FOR WORKERS PROTECTION.

QUANTITIES

165 SF DETECTABLE WARNING
2398 SF SIDEWALK REMOVAL
2358 SF PCC SIDEWALK, 5"
1481 SF PCC SIDEWALK, 7"

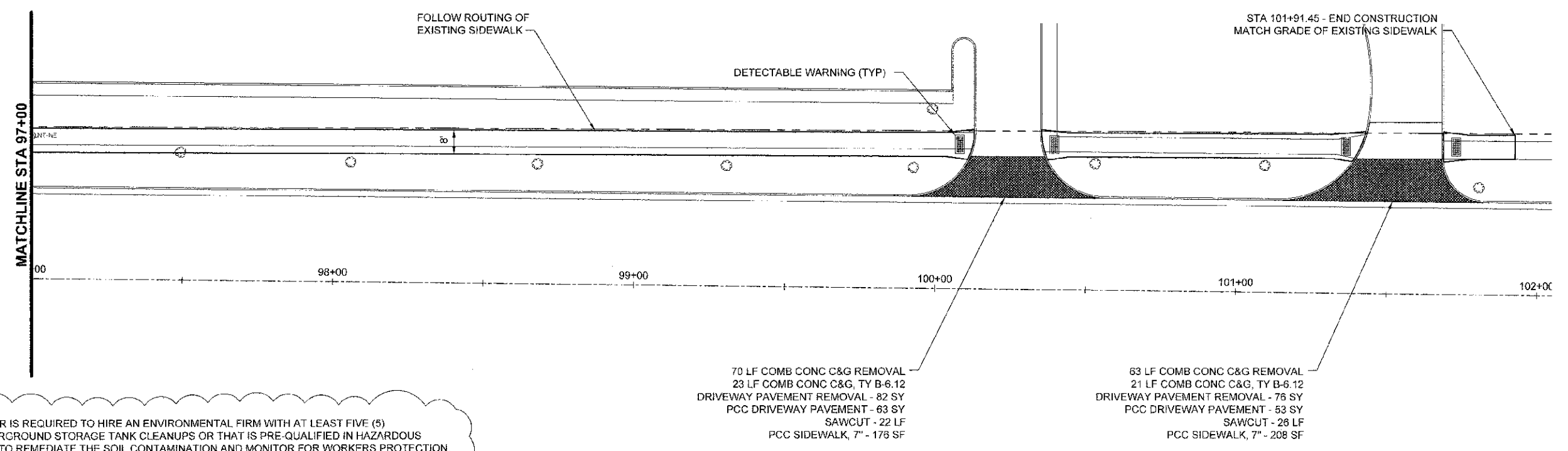
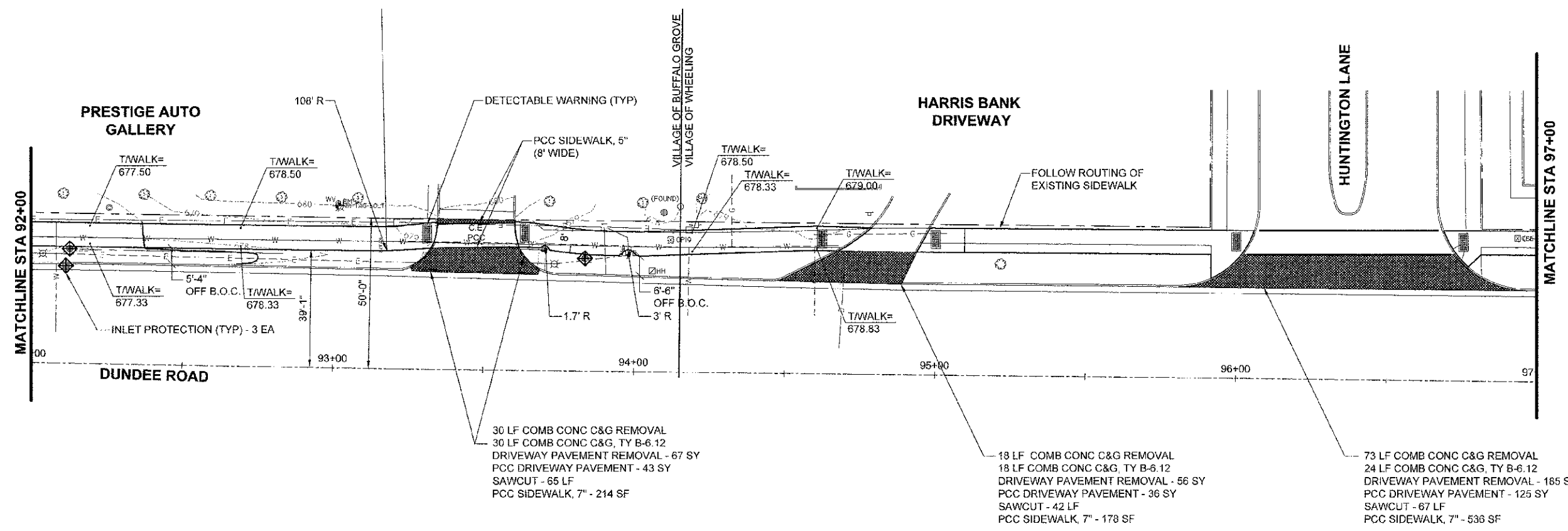
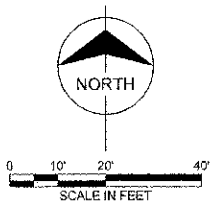

NOTES:
 1. THE GENERAL CONTRACTOR IS REQUIRED TO HIRE AN ENVIRONMENTAL FIRM WITH AT LEAST FIVE (5) DOCUMENTED LEAKING UNDERGROUND STORAGE TANK CLEANUPS OR THAT IS PRE-QUALIFIED IN HAZARDOUS WASTE BY THE DEPARTMENT TO REMEDIATE THE SOIL CONTAMINATION AND MONITOR FOR WORKERS PROTECTION.

QUANTITIES FOR BUFFALO GROVE	QUANTITIES FOR WHEELING
30 SF DETECTABLE WARNING	120 SF DETECTABLE WARNING
971 SF SIDEWALK REMOVAL	3272 SF SIDEWALK REMOVAL
1508 SF PCC SIDEWALK, 5"	5236 SF PCC SIDEWALK, 5"
214 SF PCC SIDEWALK, 7"	1347 SF PCC SIDEWALK, 7"

PLAN	BY
DATE	
REVISION	
NO.	
DATE	
BY	
DESCRIPTION	

PROF. ILL. ENGINEER	BY
DATE	
REVISION	
NO.	
DATE	
BY	
DESCRIPTION	