

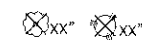

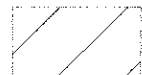

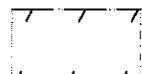

**LEGEND**

-  TREE REMOVAL (SIZE AS NOTED)
-  HOT-MIX ASPHALT SURFACE REMOVAL, 1/2"
-  PAVEMENT REMOVAL OR DRIVEWAY PAVEMENT REMOVAL
-  REMOVING MANHOLES, CATCH BASINS, OR INLETS
-  PIPE CULVERT OR STORM SEWER REMOVAL
-  RELOCATE EXISTING LIGHTING UNIT AND REMOVAL OF POLE FOUNDATION
-  COMBINATION CURB AND GUTTER REMOVAL
-  REMOVE SIGN PANEL ASSEMBLY OR RELOCATE SIGN PANEL ASSEMBLY
-  FIRE HYDRANT AND VALVE TO BE MOVED

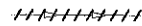

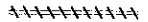
MATCH LINE STA. 443+50  
(SEE SHEET NO. 22)

MATCH LINE STA. 449+00  
(SEE SHEET NO. 24)

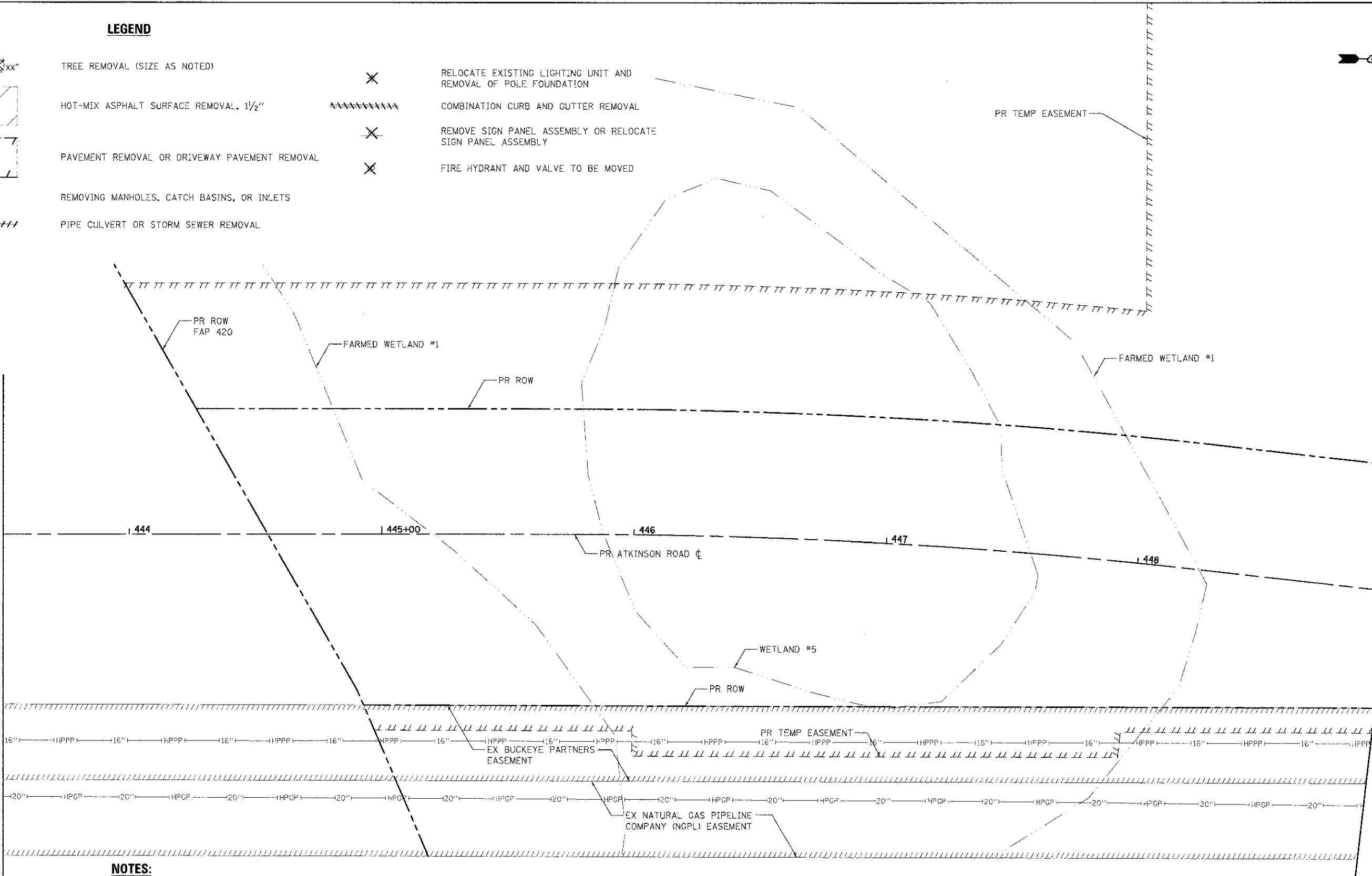

**NOTES:**

1. SEE ALIGNMENT, TIES, AND RIGHT-OF-WAY SHEETS FOR PROPOSED R.O.W. AND EASEMENT LOCATIONS, STATION EQUATIONS, AND CURVE INFORMATION.
2. FOR TRAFFIC SIGNAL REMOVAL AND RELOCATION PLANS, SEE TRAFFIC SIGNAL SHEETS.
3. FOR SIGN REMOVAL AND RELOCATION PLANS, SEE PAVEMENT MARKING AND SIGN SHEETS.

**ATKINSON ROAD**

	USER NAME = ads	DESIGNED = JSM	REVISED =	<b>STATE OF ILLINOIS</b> <b>DEPARTMENT OF TRANSPORTATION</b>	<b>ATKINSON ROAD</b> <b>REMOVAL PLAN</b>	F.A.U. = 198	SECTION = 90-00045-00-PV	COUNTY = LAKE	TOTAL SHEETS = 195	SHEET NO. = 23
	FILE NAME = ...206-Removal\2169-phtrrem03	DRAWN = JSM	REVISED =			SCALE: 1" = 20'	SHEET NO. 3 OF 13 SHEETS	STA. 443+50 TO STA. 449+00	FED. ROAD DIST. NO. 1 [ILLINOIS] FED. AID PROJECT	
PLOT SCALE = 20:0000 1/2 in.	CHECKED = DNM	REVISED =	REVISED =	CONTRACT NO. 63640						
PLOT DATE = 2/2/2012	DATE = 02/06/12	REVISED =	REVISED =							