

PLAN	DATE
NO. OF HOURS	NO. OF DAYS
NO. OF DAYS	NO. OF DAYS
NO. OF DAYS	NO. OF DAYS

PROJ. FILE	DATE
NO. OF HOURS	NO. OF DAYS
NO. OF DAYS	NO. OF DAYS
NO. OF DAYS	NO. OF DAYS

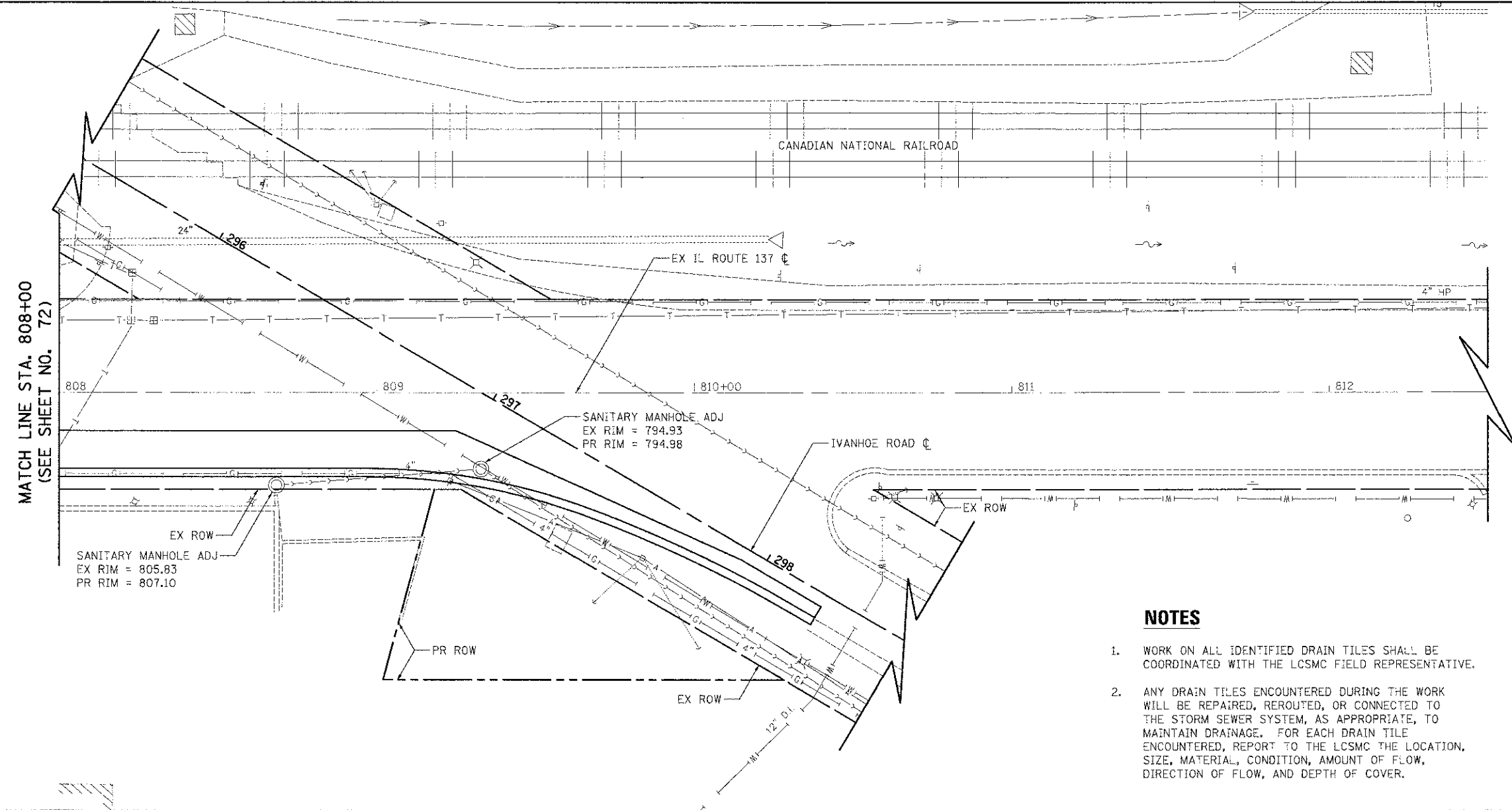

NOTES

1. WORK ON ALL IDENTIFIED DRAIN TILES SHALL BE COORDINATED WITH THE LCSMC FIELD REPRESENTATIVE.
2. ANY DRAIN TILES ENCOUNTERED DURING THE WORK WILL BE REPAIRED, REROUTED, OR CONNECTED TO THE STORM SEWER SYSTEM, AS APPROPRIATE, TO MAINTAIN DRAINAGE. FOR EACH DRAIN TILE ENCOUNTERED, REPORT TO THE LCSMC THE LOCATION, SIZE, MATERIAL, CONDITION, AMOUNT OF FLOW, DIRECTION OF FLOW, AND DEPTH OF COVER.

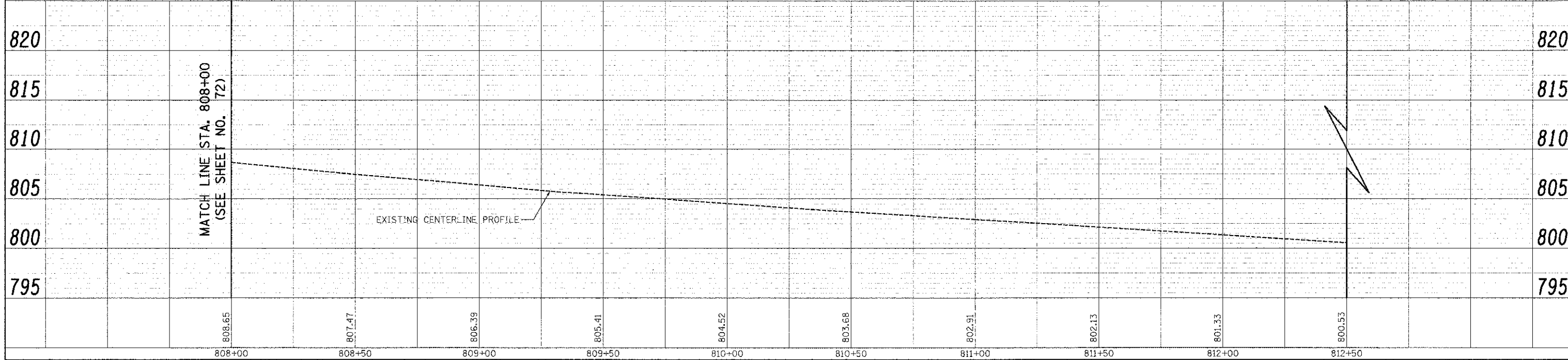

USER NAME = eds
 FILE NAME = ...2189-shdtdrain12.dgn
 PLOT SCALE = 20.00000 / in.
 PLOT DATE = 2/2/2012

DESIGNED - MJP
 DRAWN - MJP
 CHECKED - DNM
 DATE - 02/06/12

REVISED -
 REVISED -
 REVISED -
 REVISED -

**STATE OF ILLINOIS
 DEPARTMENT OF TRANSPORTATION**

**IL ROUTE 137
 DRAINAGE AND UTILITIES**

SCALE: 1" = 20' SHEET NO. 12 OF 15 SHEETS STA. 808+00 TO STA. 810+56.65

F.A.U. RTE. 198	SECTION 00-00045-00-PV	COUNTY LAKE	TOTAL SHEETS 195	SHEET NO. 73
CONTRACT NO. 63640				
FED. ROAD DIST. NO. 1 ILLINOIS FED. AID PROJECT				