

PLAN	SUBMITTED	BY	DATE
NOTE BOOK	ALIGNED		
NO.	DATE		
NO.	DATE		

PROFILE	SUBMITTED	BY	DATE
NOTE BOOK	ALIGNED		
NO.	DATE		
NO.	DATE		

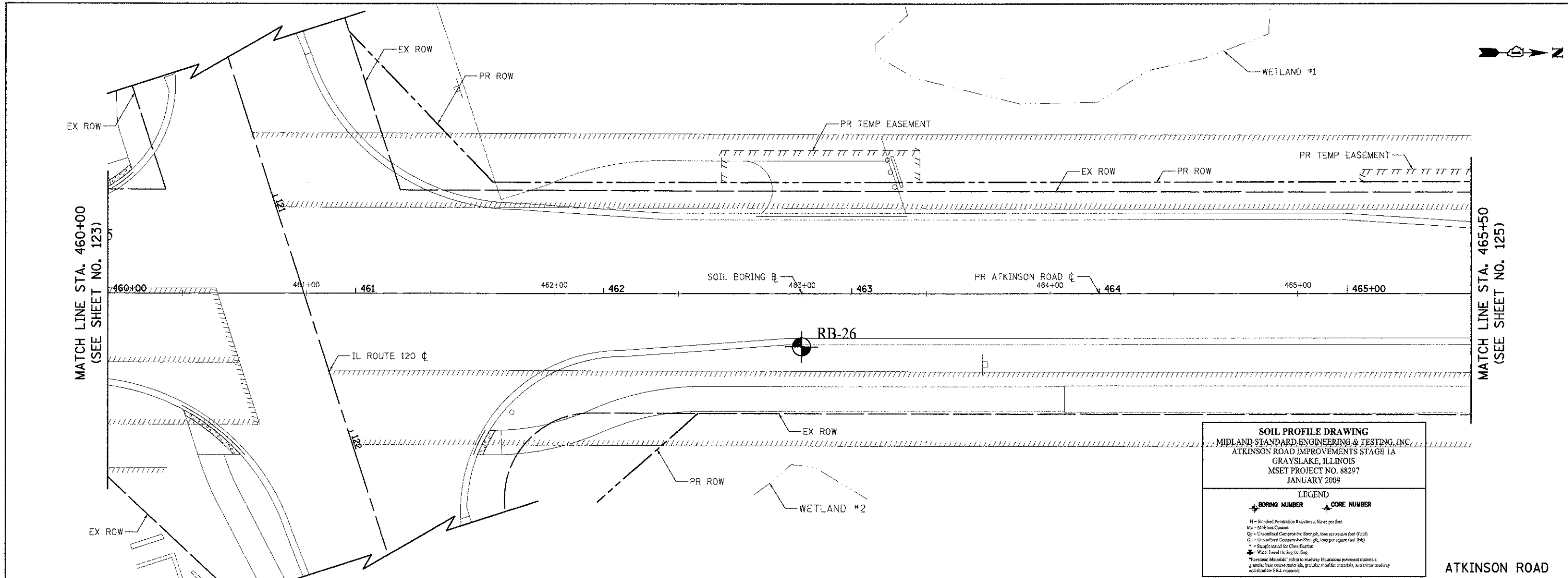

SOIL PROFILE DRAWING
 MIDLAND STANDARD ENGINEERING & TESTING, INC.
 ATKINSON ROAD IMPROVEMENTS STAGE 1A
 GRAYSLAKE, ILLINOIS
 MSET PROJECT NO. 88297
 JANUARY 2009

LEGEND

BORING NUMBER CORE NUMBER
 N = Standard Penetration Test, blow per foot
 Mc = Moisture Content
 Qp = Unconfined Compressive Strength, tons per square foot (field)
 Qu = Unconfined Compressive Strength, tons per square foot (lab)
 + = Sample tested for Classification
 Wetland Boundary
 * Pavement Materials refers to roadway structural pavement materials, granular base course materials, granular subbase materials, and prior roadway soil disposal in place materials

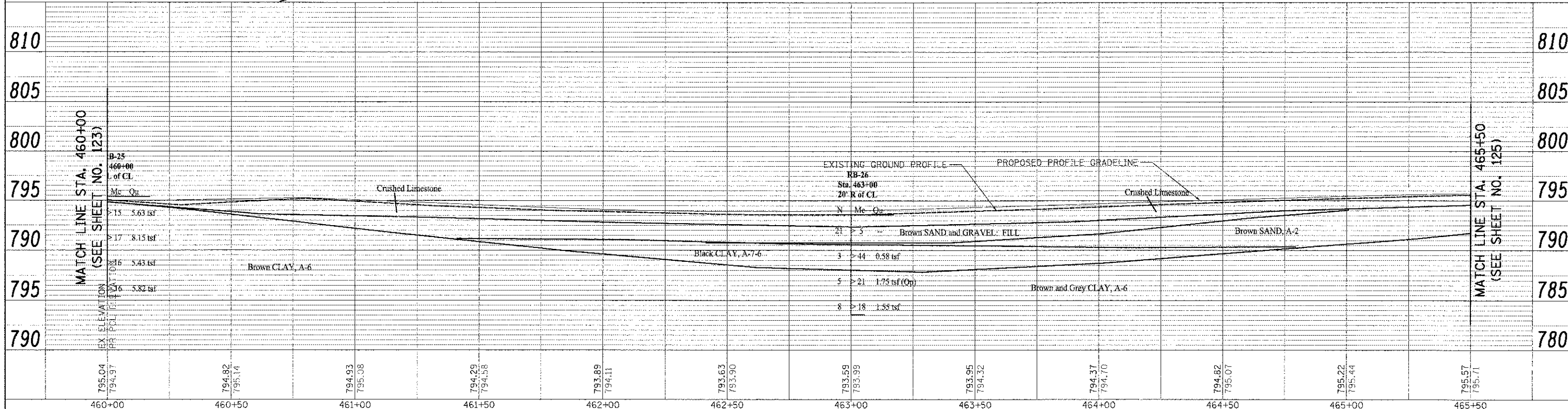

460+00	460+50	461+00	461+50	462+00	462+50	463+00	463+50	464+00	464+50	465+00	465+50
795.04 794.97	794.82 795.14	794.93 795.08	794.29 794.58	793.89 794.11	793.63 793.90	793.59 793.99	793.95 794.32	794.37 794.70	794.82 795.07	795.22 795.44	795.57 795.71



USPR NAME = eds	DESIGNED - MSET	REVISED -
FILE NAME = ...2189-shr-se-106.dgn	DRAWN - MSET	REVISED -
PILOT SCALE = 20.0000' / 1"	CHECKED - MSET	REVISED -
PILOT DATE = 2/2/2012	DATE - 02/06/12	REVISED -

STATE OF ILLINOIS
DEPARTMENT OF TRANSPORTATION

ATKINSON ROAD
SOIL BORING LOCATION PLAN & SOIL PROFILE
 SCALE: 1" = 20' SHEET NO. 6 OF 13 SHEETS STA. 460+00 TO STA. 465+50

F.A.U. RTE. 198	SECTION 00-00045-00-PV	COUNTY LAKE	TOTAL SHEETS 195	SHEET NO. 124
CONTRACT NO. 63640				
FED. ROAD DIST. NO. 1 ILLINOIS FED. AID PROJECT				