

SOIL PROFILE DRAWING
 MIDLAND STANDARD ENGINEERING & TESTING, INC.
 ATKINSON ROAD IMPROVEMENTS STAGE 1A
 GRAYSLAKE, ILLINOIS
 MSET PROJECT NO. 88297
 JANUARY 2009

LEGEND

BORING NUMBER CORE NUMBER

N - Standard Penetration Testimony, blows per foot
 Mc - Moisture Content
 Q_u - Unconfined Compressive Strength, tons per square foot (tsf)
 C_u - Unconfined Compressive Strength, tons per square foot (tsf)
 - Sample tested for Classification
 - Water Content (Liquid Limit)
 "Passive Materials" refers to roadway construction pavement materials, granular base course materials, granular shoulder materials, and other roadway and shoulder FILL materials

SUPERSEDED BY: _____ DATE: _____
 ALTERNATE (P/REV) _____
 NO. OF BOOK _____
 NO. OF SHEETS _____
 NO. OF SHEETS CHECKED _____
 NO. OF SHEETS IN THIS BOOK _____

PROFILE GRADE: _____ DATE: _____
 GRADES CHECKED _____
 (S.M. INTENT) _____
 NO. OF BOOK _____
 NO. OF SHEETS _____
 NO. OF SHEETS IN THIS BOOK _____

MATCH LINE STA. 803+50
(SEE SHEET NO. 128)

MATCH LINE STA. 808+00
(SEE SHEET NO. 130)

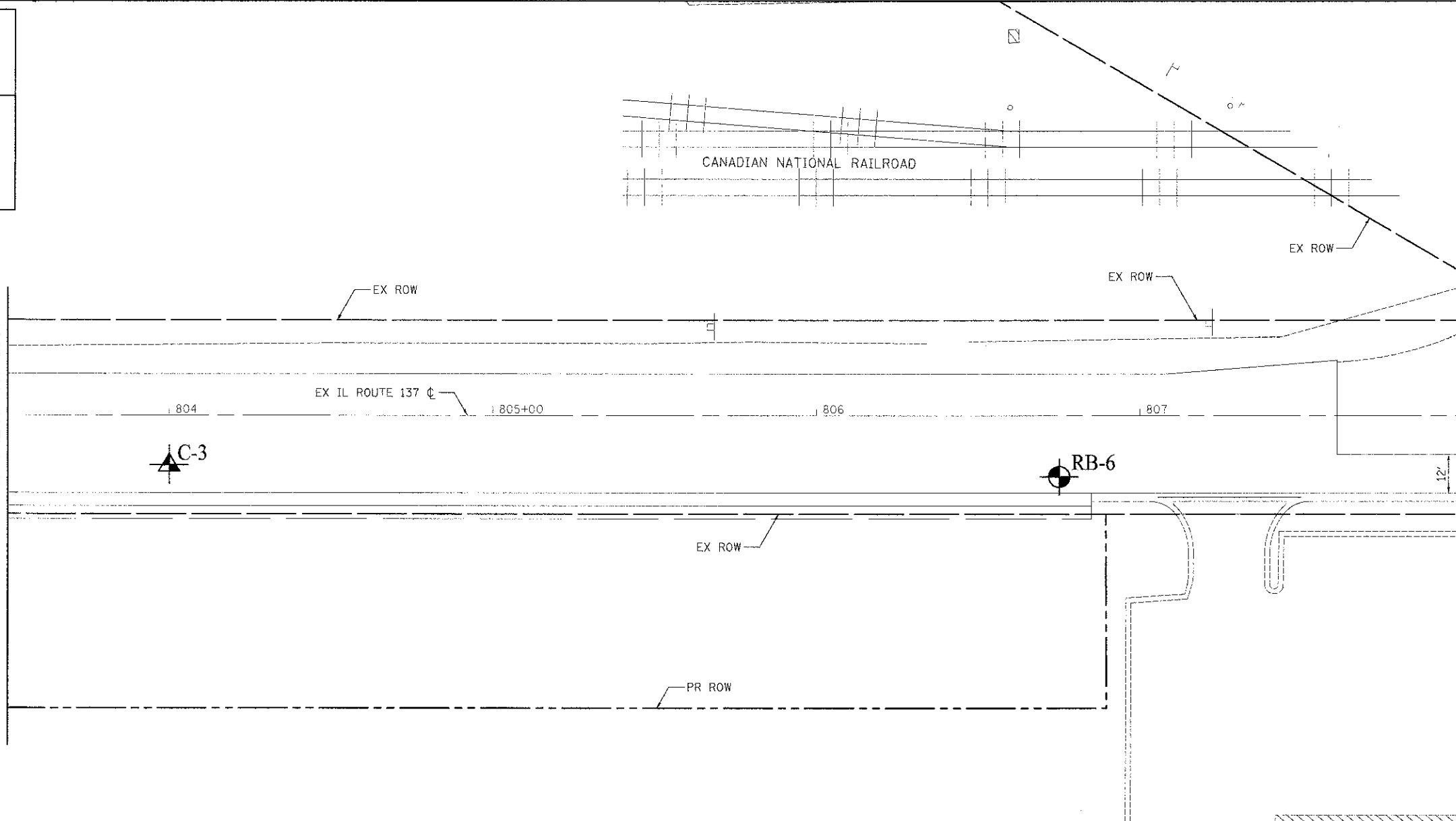

IL ROUTE 137

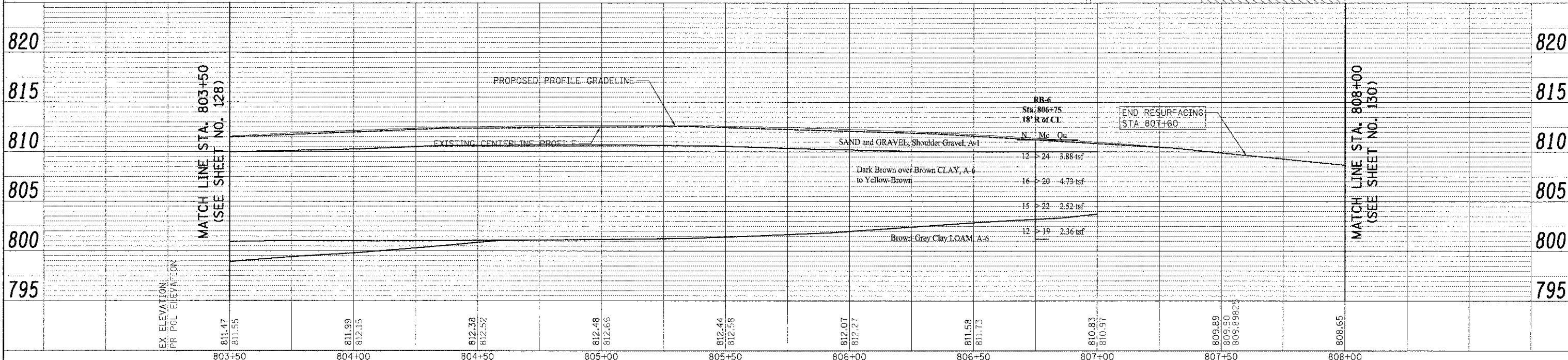

USER NAME = eds	DESIGNED - MSET	REVISED -
FILE NAME = ...2189-shr-soil11.dgn	DRAWN - MSET	REVISED -
PLOT SCALE = 28.0000	CHECKED - MSET	REVISED -
PLOT DATE = 2/2/2012	DATE - 02/06/12	REVISED -

STATE OF ILLINOIS
DEPARTMENT OF TRANSPORTATION

IL ROUTE 137
 SOIL BORING LOCATION PLAN & SOIL PROFILE
 SCALE: 1" = 20'
 SHEET NO. 4 OF 5 SHEETS
 STA. 803+50 TO STA. 808+00

F.A.U. RTE. 198	SECTION 00-00045-00-PV	COUNTY LAKE	TOTAL SHEETS 195	SHEET NO. 129
CONTRACT NO. 63640				
FED. ROAD DIST. NO. 1 ILLINOIS FED. AID PROJECT				