

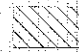

BY: [ ] DATE: [ ]  
 FIRM: [ ]  
 SURVEY: [ ]  
 NOTE BOOK: [ ]  
 AREAS CHECKED: [ ]

BY: [ ] DATE: [ ]  
 ORIGINAL SURVEY: [ ]  
 NOTE BOOK: [ ]  
 AREAS CHECKED: [ ]

**LEGEND**

-  TOPSOIL REMOVAL
-  REMOVAL AND DISPOSAL OF UNSUITABLE MATERIALS
-  POROUS GRANULAR EMBANKMENT, SUBGRADE
-  PAVEMENT REMOVAL

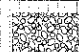
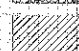
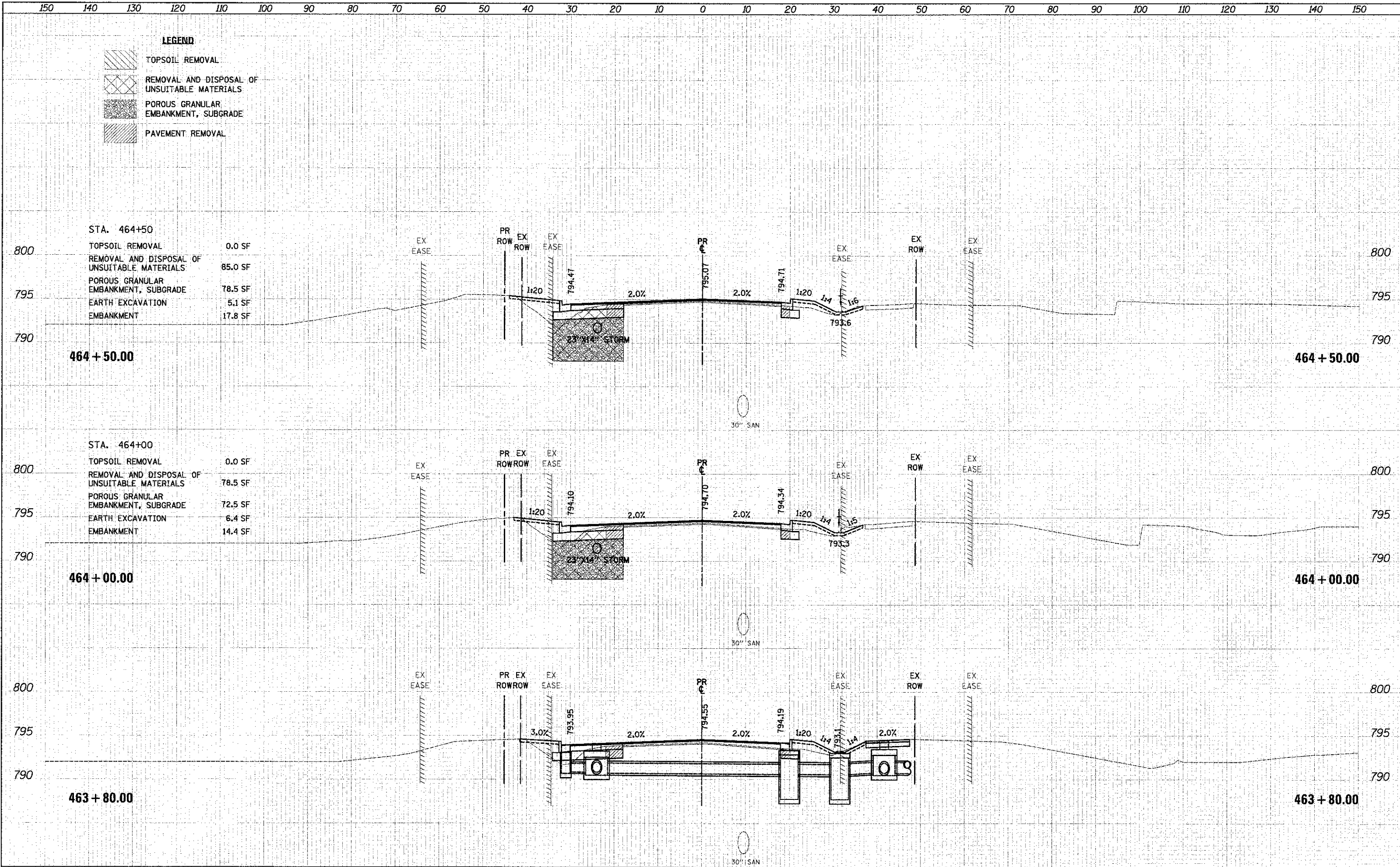

STA. 464+50

TOPSOIL REMOVAL	0.0 SF
REMOVAL AND DISPOSAL OF UNSUITABLE MATERIALS	85.0 SF
POROUS GRANULAR EMBANKMENT, SUBGRADE	78.5 SF
EARTH EXCAVATION	5.1 SF
EMBANKMENT	17.8 SF

STA. 464+00

TOPSOIL REMOVAL	0.0 SF
REMOVAL AND DISPOSAL OF UNSUITABLE MATERIALS	78.5 SF
POROUS GRANULAR EMBANKMENT, SUBGRADE	72.5 SF
EARTH EXCAVATION	6.4 SF
EMBANKMENT	14.4 SF

STA. 463+80.00

TOPSOIL REMOVAL	0.0 SF
REMOVAL AND DISPOSAL OF UNSUITABLE MATERIALS	78.5 SF
POROUS GRANULAR EMBANKMENT, SUBGRADE	72.5 SF
EARTH EXCAVATION	6.4 SF
EMBANKMENT	14.4 SF

150 140 130 120 110 100 90 80 70 60 50 40 30 20 10 0 10 20 30 40 50 60 70 80 90 100 110 120 130 140 150



USER NAME: = esa	DESIGNED - JSM	REVISED -
FILE NAME: = ...\2189-shr-xseht.atk.dgn	DRAWN - JSM	REVISED -
PLD1 SCALE = 1/8"=1'-0" / in.	CHECKED - DNM	REVISED -
PLD1 DATE = 2/2/2012	DATE - 02/06/12	REVISED -

STATE OF ILLINOIS  
 DEPARTMENT OF TRANSPORTATION

CROSS SECTIONS - ATKINSON ROAD  
 SCALE: 1"=5'-0" / 10'  
 SHEET NO. 24 OF 26 SHEETS  
 STA. 463+80.00 TO STA. 464+50.00

F.A.U. RTE. 198	SECTION 00-00045-00-PV	COUNTY LAKE	TOTAL SHEET NO. 195
CONTRACT NO. 63640			SHEETS 163
FED. ROAD DIST. NO. 1 (ILLINOIS) FED. AID PROJECT			