

|                |  |
|----------------|--|
| DATE           |  |
| BY             |  |
| FINAL SURVEYED |  |
| NOTED          |  |
| REVISIONS      |  |
| DATE           |  |
| BY             |  |
| DESCRIPTION    |  |

|                   |  |
|-------------------|--|
| DATE              |  |
| BY                |  |
| ORIGINAL SURVEYED |  |
| NOTED             |  |
| REVISIONS         |  |
| DATE              |  |
| BY                |  |
| DESCRIPTION       |  |

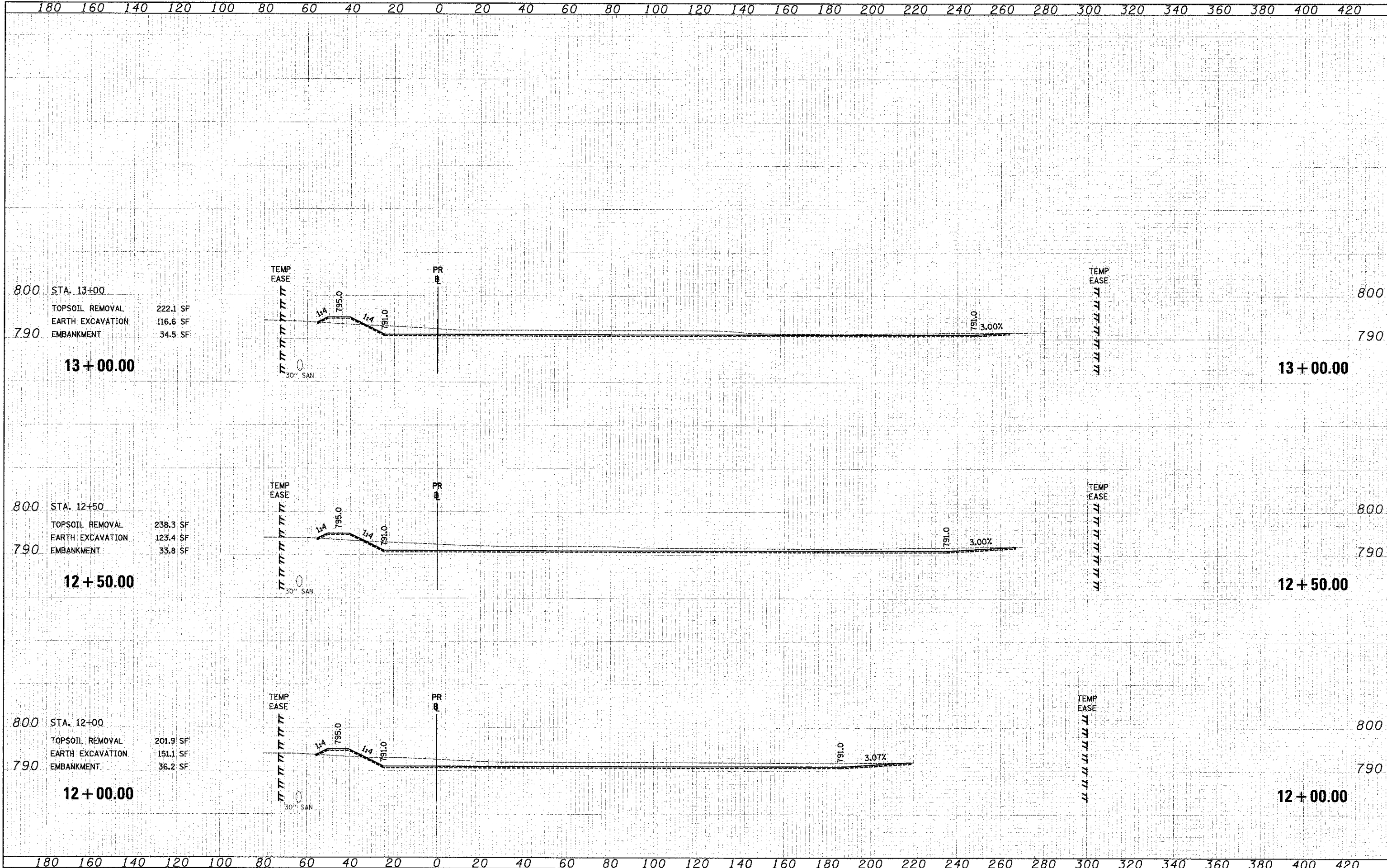

800 STA. 13+00  
 TOPSOIL REMOVAL 222.1 SF  
 EARTH EXCAVATION 116.6 SF  
 790 EMBANKMENT 34.5 SF  
**13+00.00**

800 STA. 12+50  
 TOPSOIL REMOVAL 238.3 SF  
 EARTH EXCAVATION 123.4 SF  
 790 EMBANKMENT 33.8 SF  
**12+50.00**

800 STA. 12+00  
 TOPSOIL REMOVAL 201.9 SF  
 EARTH EXCAVATION 151.1 SF  
 790 EMBANKMENT 36.2 SF  
**12+00.00**

180 160 140 120 100 80 60 40 20 0 20 40 60 80 100 120 140 160 180 200 220 240 260 280 300 320 340 360 380 400 420



USER NAME : ods  
 FILE NAME : ...12189-shtr-ssthr-pond.dgn  
 PLOT SCALE : 20.0000 / 1 in.  
 PLOT DATE : 2/2/2012

DESIGNED - MJP  
 DRAWN - MJP  
 CHECKED - DNM  
 DATE - 02/06/12

REVISED -  
 REVISED -  
 REVISED -  
 REVISED -

STATE OF ILLINOIS  
 DEPARTMENT OF TRANSPORTATION

CROSS SECTIONS - POND & DEPRESSIONAL AREA

SCALE: 1"=10'V/20'H SHEET NO. 6 OF 9 SHEETS STA. 12+00.00 TO STA. 13+00.00

|   |                |        |                    |
|---|----------------|--------|--------------------|
| F.A.U. RTE.                                       | SECTION        | COUNTY | TOTAL SHEET        |
| 198   | 00-00045-00-PV | LAKE   | SHEETS NO. 195 192 |
| FED. ROAD DIST. NO. 1 (ILLINOIS) FED. AID PROJECT |                |        | CONTRACT NO. 63640 |