

F.A.P. RTE.	SECTION	COUNTY	TOTAL SHEETS	SHEET NO.
	09-00010-00-BR	LAKE	41	1
FED. ROAD DIST. NO. 1		ILLINOIS	CONTRACT NO. 63716	

STATE OF ILLINOIS  
DEPARTMENT OF TRANSPORTATION  
DIVISION OF HIGHWAYS

**PLANS FOR  
PROPOSED FEDERAL  
AID HIGHWAY**

**WOODLAND DRIVE OVER FLINT CREEK  
BRIDGE REPLACEMENT**

SECTION NO. 09-00010-00-BR  
PROJECT NO. BRM-9003(504)  
JOB NO. C-91-123-10  
VILLAGE OF LAKE BARRINGTON  
LAKE COUNTY

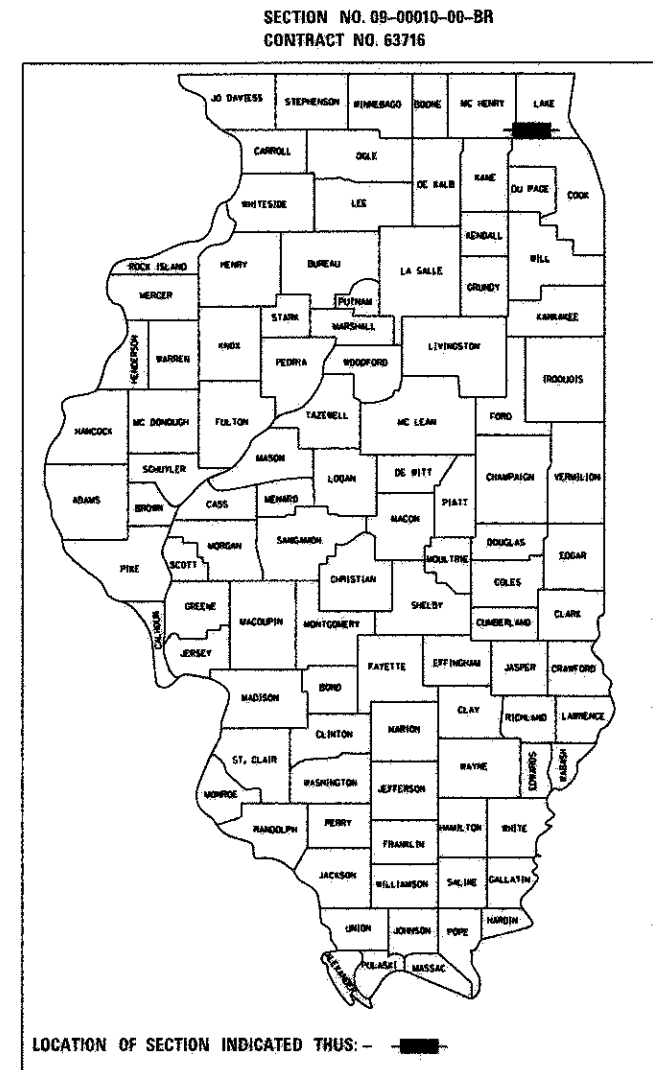

FOR INDEX OF SHEETS, SEE SHEET NO. 2  
FOR HIGHWAY STANDARDS, SEE SHEET NO. 2

DESIGN DESIGNATION = LOCAL ROAD  
TRAFFIC = < 500 VPD  
POSTED SPEED LIMIT = 25 MPH

PROJECT LOCATED IN THE  
VILLAGE OF LAKE BARRINGTON

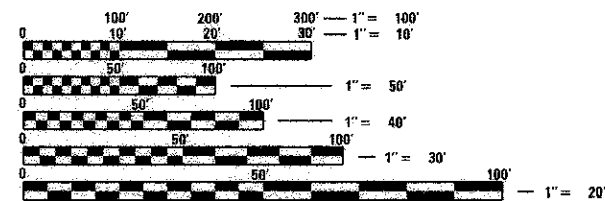

FULL SIZE PLANS HAVE BEEN PREPARED USING STANDARD ENGINEERING SCALES. REDUCED SIZED PLANS WILL NOT CONFORM TO STANDARD SCALES. IN MAKING MEASUREMENTS ON REDUCED PLANS, THE ABOVE SCALES MAY BE USED.

J.U.L.I.E.  
JOINT UTILITY LOCATION INFORMATION FOR EXCAVATION  
1-800-892-0123  
OR 811



NAME: RICK YOUNG  
EXP. 11/30/2013  
DATE:  
SHT NO. 1-13, 30-41

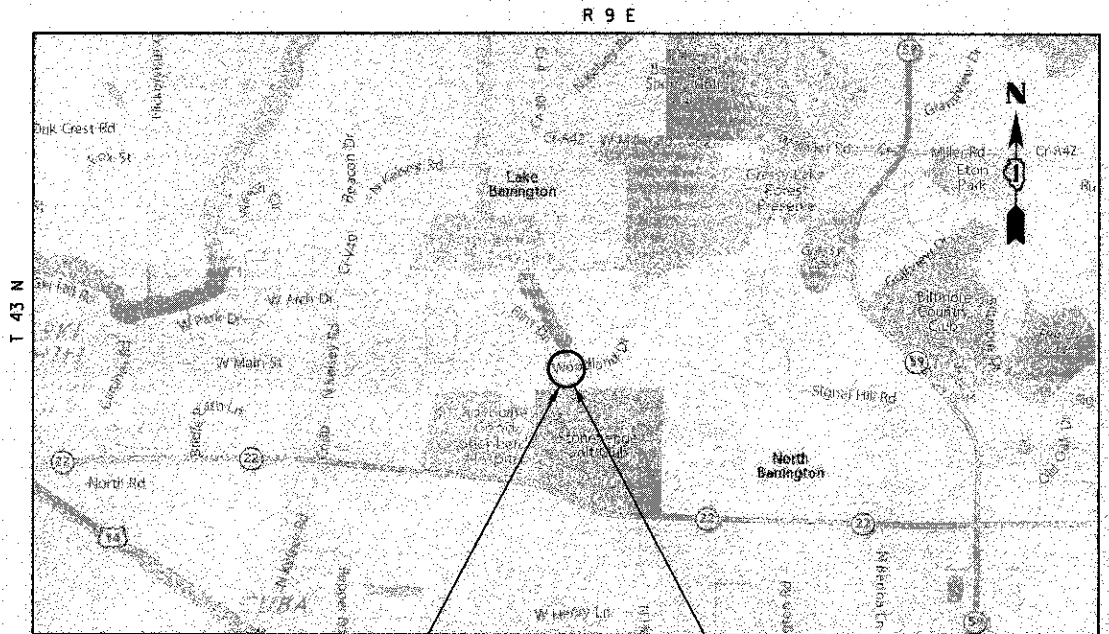

BEGIN IMPROVEMENT  
STA 13+26.58 @ WOODLAND DR.  
END IMPROVEMENT:  
STA 14+16.58 @ WOODLAND DR.

LOCATION MAP  
N.T.S.

BRIDGE REPLACEMENT  
STA. 13+71.58  
EXISTING SN 049-6750  
PROPOSED SN 049-6751

GROSS AND NET LENGTH = 90 FT. = 0.017 MILE

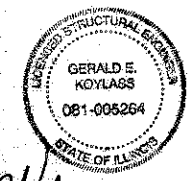

NAME: GERALD KOYLARS  
EXP. 11/30/2012  
DATE:  
SHT NO. 14-29

STATE OF ILLINOIS DEPARTMENT OF TRANSPORTATION DIVISION OF HIGHWAYS	
APPROVED	MAY 4, 2012 <i>Car Martin</i> VILLAGE ENGINEER ADMINISTRATOR
PASSED	MAY 22, 2012 <i>Colbert</i> DISTRICT 1 ENGINEER LOCAL ROADS AND STREETS
RELEASED FOR BID BASED ON LIMITED REVIEW	MAY 24, 2012 <i>Diane M. O'Keefe</i> DEPUTY DIRECTOR OF HIGHWAYS, REGION 1 ENGINEER

PRINTED BY THE AUTHORITY  
OF THE STATE OF ILLINOIS

**McDonough Associates Inc.**  
Engineers/Architects  
180 North Stetson Avenue - Suite 1500  
Chicago, Illinois 60601 Phone: (312) 946-8600

PROGRAM AND OFFICE ENGINEER: CHARLES F. RIDDLE, P.E. (847) 705-4406 SCHAUMBURG, IL

CONTRACT NO. 63716