

F.A.S. RTE.	SECTION	COUNTY	TOTAL SHEETS	SHEET NO.
636	(4)RS-5	CHRISTIAN	6	1
FED. ROAD DIST. NO.	ILLINOIS	CONTRACT NO. 72F53		

STATE OF ILLINOIS  
DEPARTMENT OF TRANSPORTATION  
DIVISION OF HIGHWAYS

# PROPOSED CONTRACT MAINTENANCE

FOR INDEX OF SHEETS, SEE SHEET NO. 2

FAS 636 (MT AUBURN RD)  
SECTION (4)RS-5

CHRISTIAN COUNTY

C-96-071-12  
R 2 W

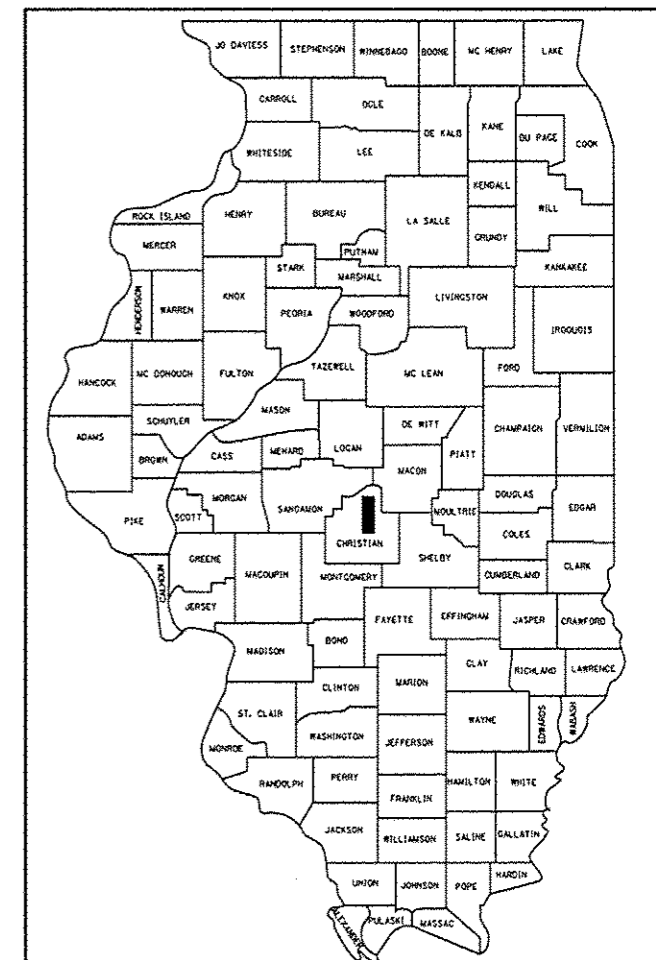

LOCATION OF SECTION INDICATED THUS:

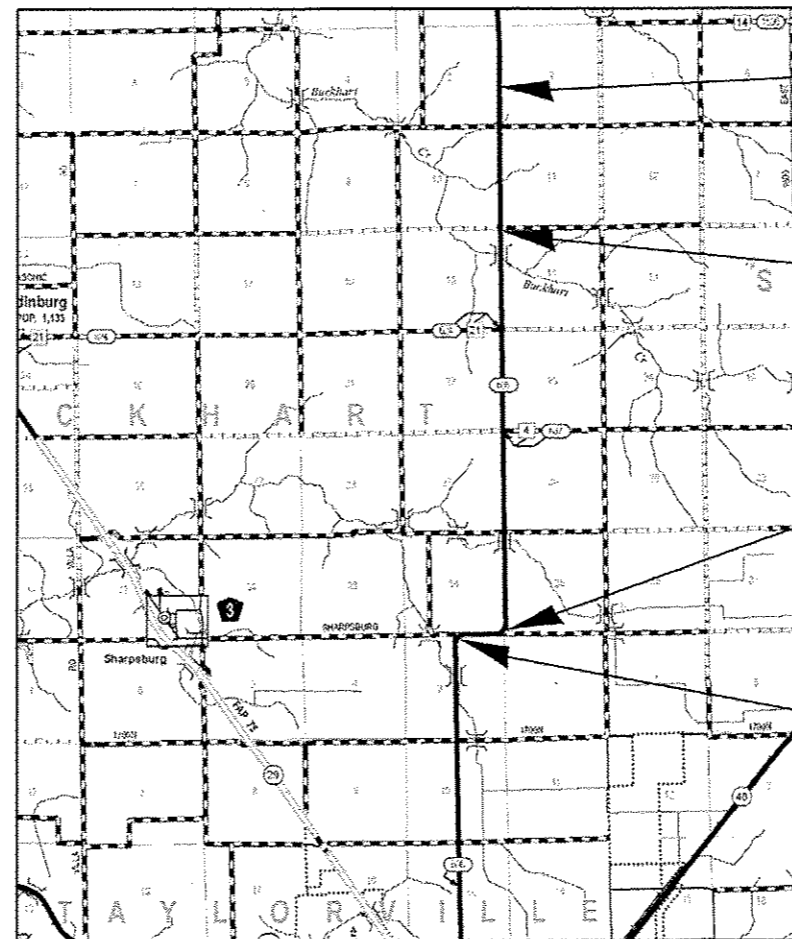

BEGIN PROJECT  
STA. 332 + 37

STA. EQ. 411 + 99.79BK  
= 411 + 85.09AH

STA. EQ. 627 + 30.29BK  
= 628 + 56.48AH

END PROJECT  
STA. 635 + 94

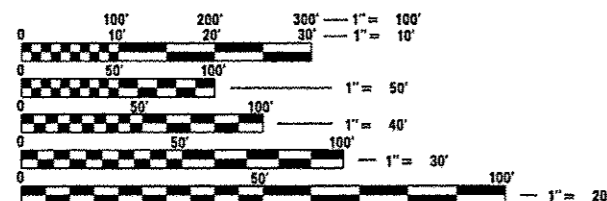

FULL SIZE PLANS HAVE BEEN PREPARED USING STANDARD ENGINEERING SCALES. REDUCED SIZED PLANS WILL NOT CONFORM TO STANDARD SCALES. IN MAKING MEASUREMENTS ON REDUCED PLANS, THE ABOVE SCALES MAY BE USED.

J.U.L.I.E.  
JOINT UTILITY LOCATION INFORMATION FOR EXCAVATION  
1-800-892-0123  
OR 811

PLAN AND CONTRACT TECHNICIAN  
TIMOTHY SHARP (217)782-7743

CONTRACT NO. 72F53

GROSS LENGTH = 30,245.51 FT. = 5.728 MILE

STATE OF ILLINOIS  
DEPARTMENT OF TRANSPORTATION  
DIVISION OF HIGHWAYS

SUBMITTED JUNE 11 20 12  
Rogers L. Driskell  
DEPUTY DIRECTOR OF HIGHWAYS, REGION ENGINEER

June 29 20 12  
John D. Baranzelli, P.E.  
acting ENGINEER OF DESIGN AND ENVIRONMENT

June 29 20 12  
William R. Frey, Jr.  
acting DIRECTOR OF HIGHWAYS, CHIEF ENGINEER

PRINTED BY THE AUTHORITY  
OF THE STATE OF ILLINOIS