

STATE OF ILLINOIS
DEPARTMENT OF TRANSPORTATION
DIVISION OF HIGHWAYS
PROPOSED
CONTRACT MAINTENANCE

FOR INDEX OF SHEETS, SEE SHEET NO. 2

FAS 636 (MT AUBURN RD)
SECTION (4)RS-5

CHRISTIAN COUNTY

C-96-071-12
 R 2 W

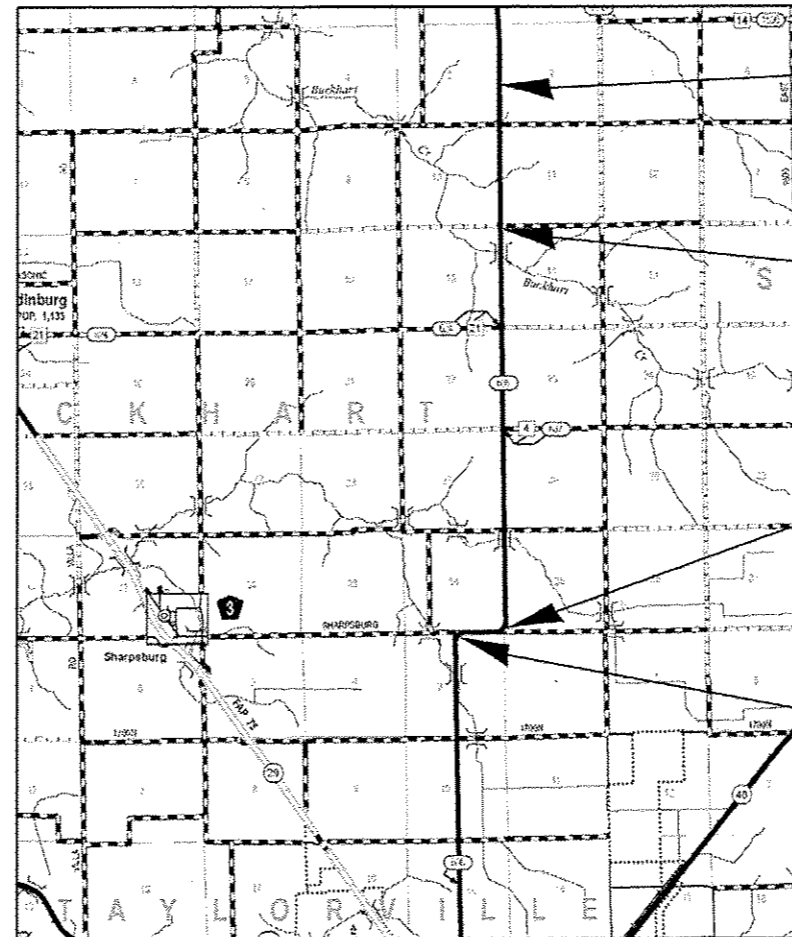

BEGIN PROJECT
STA. 332 + 37

STA. EQ. 411 + 99.79BK
= 411 + 85.09AH

STA. EQ. 627 + 30.29BK
= 628 + 56.48AH

END PROJECT
STA. 635 + 94

GROSS LENGTH = 30,245.51 FT. = 5.728 MILE

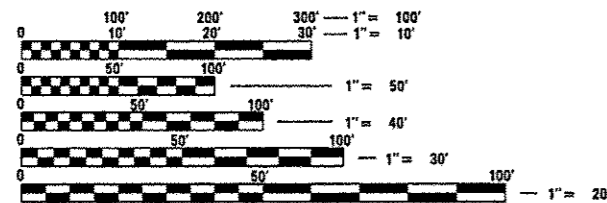

FULL SIZE PLANS HAVE BEEN PREPARED USING STANDARD ENGINEERING SCALES. REDUCED SIZED PLANS WILL NOT CONFORM TO STANDARD SCALES. IN MAKING MEASUREMENTS ON REDUCED PLANS, THE ABOVE SCALES MAY BE USED.

J.U.L.I.E.
 JOINT UTILITY LOCATION INFORMATION FOR EXCAVATION
 1-800-892-0123
 OR 811

PLAN AND CONTRACT TECHNICIAN
TIMOTHY SHARP (217)782-7743

CONTRACT NO. 72F53

F.A.S. RTE.	SECTION	COUNTY	TOTAL SHEETS	SHEET NO.
636	(4)RS-5	CHRISTIAN	6	1
FED. ROAD DIST. NO.	ILLINOIS	CONTRACT NO. 72F53		

D-96-071-12

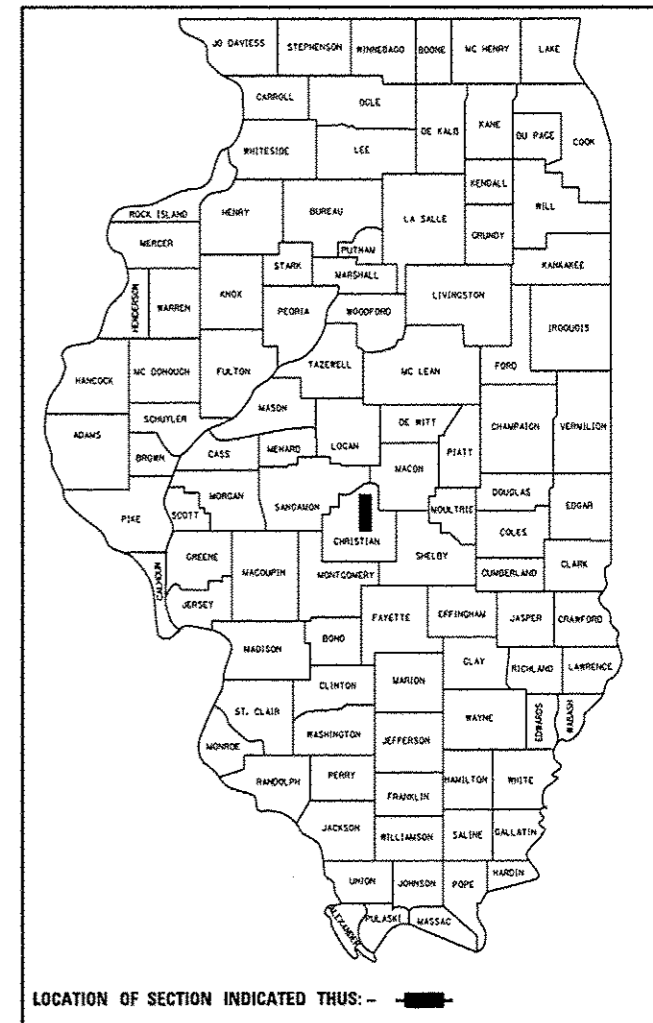

LOCATION OF SECTION INDICATED THIS: - [black rectangle] -

STATE OF ILLINOIS
 DEPARTMENT OF TRANSPORTATION
 DIVISION OF HIGHWAYS

SUBMITTED JUNE 11 20 12
Rogers L. Driskell
 DEPUTY DIRECTOR OF HIGHWAYS, REGION ENGINEER

June 29 20 12
John D. Baranzelli, P.E.
 acting ENGINEER OF DESIGN AND ENVIRONMENT

June 29 20 12
William R. Frey, Jr.
 acting DIRECTOR OF HIGHWAYS, CHIEF ENGINEER

PRINTED BY THE AUTHORITY
OF THE STATE OF ILLINOIS

CODE NO.	ITEM	UNIT	TOTAL QUANTITY	100% STATE	
				0005	RURAL
40300400	BITUMINOUS MATERIALS (COVER AND SEAL COATS)	TON	137	137	
40300600	SEAL COAT AGGREGATE	TON	925	925	
67100100	MOBILIZATION	L SUM	1	1	
70100460	TRAFFIC CONTROL AND PROTECTION, STANDARD 701306	L SUM	1	1	
X 78001120	PAINT PAVEMENT MARKING - LINE 5"	FOOT	71205	71205	
X 78100100	RAISED REFLECTIVE PAVEMENT MARKER	EACH	19	19	

X SPECIALTY
ITEM

FILE NAME : c:\pwork\pwork\sporkage\40300420\QUANTITIES.dgn	USER NAME : sporkage	DESIGNED - DRAWN - CHECKED - DATE -	REVISED - REVISED - REVISED - REVISED -	STATE OF ILLINOIS DEPARTMENT OF TRANSPORTATION	SUMMARY OF QUANTITIES				F.A.S. RTE. 636	SECTION (4)RS-5	COUNTY CHRISTIAN	TOTAL SHEETS 6	SHEET NO. 3
PLOT SCALE : 100.0000' / 1"	PLOT DATE : Jun-11-2012 01:50:17PM				SCALE:	SHEET	OF	SHEETS	STA.	TO STA.	ILLINOIS FED. AID PROJECT CONTRACT NO. 72F53		

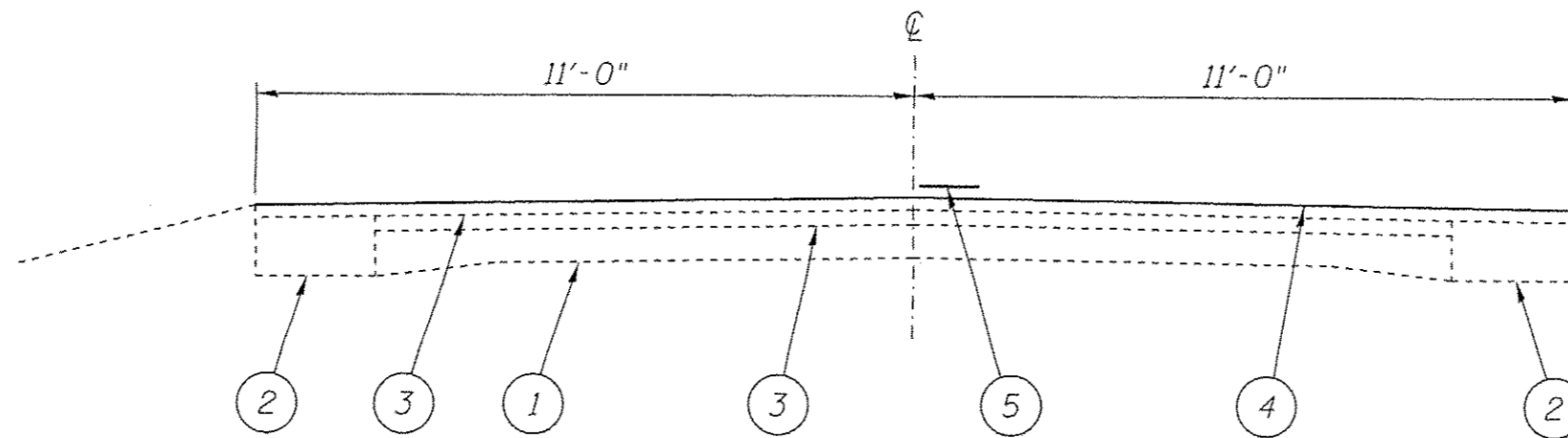

STA. 332+37 TO 635+94
 STA. EQ. 411+99.79bk=411+85.09ah
 STA. EQ. 627+30.29bk=628+56.48ah

L E G E N D

- 1- EXIST. P.C.C. PAVEMENT 9'-6 $\frac{1}{2}$ "-9
- 2- EXIST. PAVEMENT WIDENING
- 3- EXIST. HOT-MIX ASPHALT SURFACE
- 4- PROP. BIT. SURF. TREATMENT (CL. A-1)
- 5- PAINT PAVEMENT MARKING - LINE 5"

FILE NAME :	USER NAME : sparksgv	DESIGNED -	REVISED -	STATE OF ILLINOIS DEPARTMENT OF TRANSPORTATION	TYPICAL SECTION	F.A.S. RTE.	SECTION	COUNTY	TOTAL SHEETS	SHEET NO.	
c:\pwork\puidot\sparksgv\d8308428\0672F53.sht-typicel.dgn	DRAWN -	REVISED -	636			(4)RS-5	CHRISTIAN	6	4		
SHT_PLAN	PLOT SCALE : 2.9544" / 1"	CHECKED -	REVISED -			CONTRACT NO. 72F53					
	PLOT DATE : Jun-11-2012 01:50:18PM	DATE -	REVISED -			ILLINOIS FED. AID PROJECT					
						SCALE:	SHEET 1	OF 1	SHEETS	STA. TO STA.	

PAVEMENT MARKING SCHEDULE					
STATION RANGE			TYPE	PAINT PAVEMENT MARKING LINE 5"	
				WHITE (FT)	YELLOW (FT)
332+37	TO	620+10	SKIP DASH	-	7,200
614+10	TO	635+94	NO PASSING	-	3,515
332+37	TO	635+94	EDGE LINE	60,490	-
TOTALS				60,490	10,715

*STA. EQN. 411+99.79BK = 411+85.09AH
 STA. EQN. 627+30.29BK = 628+56.48AH

RAISED REFLECTIVE PAVEMENT MARKERS			
620+10	TO	627+30	19

NOTES:
 1. STATIONS ARE APPROXIMATE

FILE NAME : c:\p\work\p\idot\sparkgr\d0380420\067	USER NAME : sparkgr PF53-sht-schedule.dgn	DESIGNED - DRAWN -	REVISED - REVISED -	STATE OF ILLINOIS DEPARTMENT OF TRANSPORTATION	SCHEDULE OF QUANTITIES	F.A.S RTE. 636	SECTION (4)RS-5	COUNTY CHRISTIAN	TOTAL SHEETS 6	SHEET NO. 5	
PLOT SCALE : 100.0000 / in.	CHECKED -	REVISED -	SCALE:			SHEET OF SHEETS	STA. TO STA.	ILLINOIS FED. AID PROJECT			
Default	PLOT DATE : Jun-11-2012 01:50:19PM	DATE -	REVISED -								

03/15/12

BEGIN PROJECT
Sta. 332+37



STA. EQ.
627+30.29BK
=628+56.48AH

END PROJECT
STA. 635+94

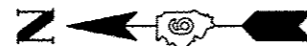

STA. EQ. 411+99.79BK
=411+85.09AH

FILE NAME =	USER NAME = sparkgv	DESIGNED -	REVISED -
c:\pwork\pwork\sparkgv\108300420\067	P53-shs-plan.dgn	DRAWN -	REVISED -
	PLOT SCALE = 100.246984' / in.	CHECKED -	REVISED -
Default	PLOT DATE = Jun-11-2012 01:50:23PM	DATE -	REVISED -

STATE OF ILLINOIS
DEPARTMENT OF TRANSPORTATION

PLAN
MT AUBURN ROAD

F.A.S. RTE.	SECTION	COUNTY	TOTAL SHEETS	SHEET NO.
636	41RS-5	CHRISTIAN	6	6
CONTRACT NO. 72F53				
ILLINOIS FED. AID PROJECT				

SCALE: SHEET 1 OF 1 SHEETS STA. 332+37 TO STA. 635+94