

F.A.U. RTE.	SECTION	COUNTY	TOTAL SHEETS	SHEET NO.
-	08-00461-00-LS	SANGAMON	11	1

• PW - CITY OF SPRINGFIELD

UTILITY NOTE

THE LOCATIONS OF THOSE BURIED AND ABOVEGROUND UTILITIES SHOWN ARE APPROXIMATE, ARE SHOWN FOR CONTRACTOR INFORMATIONAL USE ONLY, AND ARE NOT TO BE REFERENCED FOR CONSTRUCTION PURPOSES. THE IMPLIED PRESENCE OR ABSENCE OF UTILITIES IS NOT TO BE CONSTRUED BY THE OWNER, ENGINEER, CONTRACTOR, OR SUBCONTRACTORS TO BE AN ACCURATE AND COMPLETE REPRESENTATION OF UTILITIES THAT MAY OR MAY NOT EXIST ON THE CONSTRUCTION SITE. BURIED AND ABOVEGROUND UTILITY LOCATION, IDENTIFICATION, AND MARKING ARE THE SOLE RESPONSIBILITY OF THE CONTRACTOR. REROUTING, DISCONNECTION, PROTECTION, ETC. OF ANY UTILITIES MUST BE COORDINATED BETWEEN THE CONTRACTOR, UTILITY COMPANY, AND OWNER. SITE SAFETY INCLUDING THE AVOIDANCE OF HAZARDS, ASSOCIATED WITH BURIED AND ABOVEGROUND UTILITIES, REMAIN THE SOLE RESPONSIBILITY OF THE CONTRACTOR.

J.U.L.I.E.
JOINT UTILITY LOCATING INFORMATION FOR EXCAVATORS
1-800-892-0123

Utility Companies

- | | |
|---|---|
| City Water, Light and Power - Water Dept.
401 N. 11th Street
Springfield, IL 62707
Attention: Steve Stewart (217) 789-2022 | Springfield Metro Sanitary District
3017 N. 8th Street Road
Springfield, IL 62707
Attention: Gregg Humphrey (217) 528-0491 |
| City Water, Light and Power - Electric Dept.
1008 East Miller
Springfield, IL 62701
Attention: Roleen Thoole (217) 757-8520 | Comcast
711 S. Dirksen Parkway
Springfield, IL 62703
Attention: David Bly (217) 527-2967 |
| AT&T
529 S. Seventh Street, Floor 3E
Springfield, IL 62721
Attention: Rich Weingand (217) 789-8227 | Ameren CILCO (Gas)
825 N. Macarthur Boulevard
Springfield, IL 62702
Attention: Rick Combs (217) 753-5187 |
| Office of Public Works
Room 201, Municipal Center West
Springfield, IL 62701
Attention: Lori Williams, Traffic Engineer (217) 789-8227 | |

Index of Sheets

- 1 Cover Sheet
- 2 Summary of Quantities
- 3 Planting Plan - Sta 34+00 to 39+00
- 4 Planting Plan - Sta 39+00 to 48+00
- 5 Planting Plan - Sta 48+00 to 58+00
- 6 Planting Plan - Sta 58+00 to 70+00
- 7 Planting Plan - Sta 70+00 to 86+00
- 8 Planting Plan - Sta 86+00 to 102+00
- 9 Planting Plan - Sta 102+00 to 118+00
- 10 Planting Plan - Sta 118+00 to Dirksen Pkwy.
- 11 Plant Details

Highway Standards

- 701001-02
- 701101-02
- 701502-04
- 701601-07
- 701606-08
- 701701-08
- 701901-02

CONTRACT NO. **93581**

STATE OF ILLINOIS
DEPARTMENT OF TRANSPORTATION
DIVISION OF HIGHWAYS

SPRINGFIELD GREEN - MADISON/JEFFERSON/CLEAR LAKE (LANDSCAPE PORTION)

ILLINOIS TRANSPORTATION ENHANCEMENT PROGRAM (ITEP NO. 602025)
(FOR CONSTRUCTION SECTION)

SECTION 08-00461-00LS
PROJECT TE-00D6(085)
CITY OF SPRINGFIELD, SANGAMON COUNTY
JOB NUMBER C-96-235-08

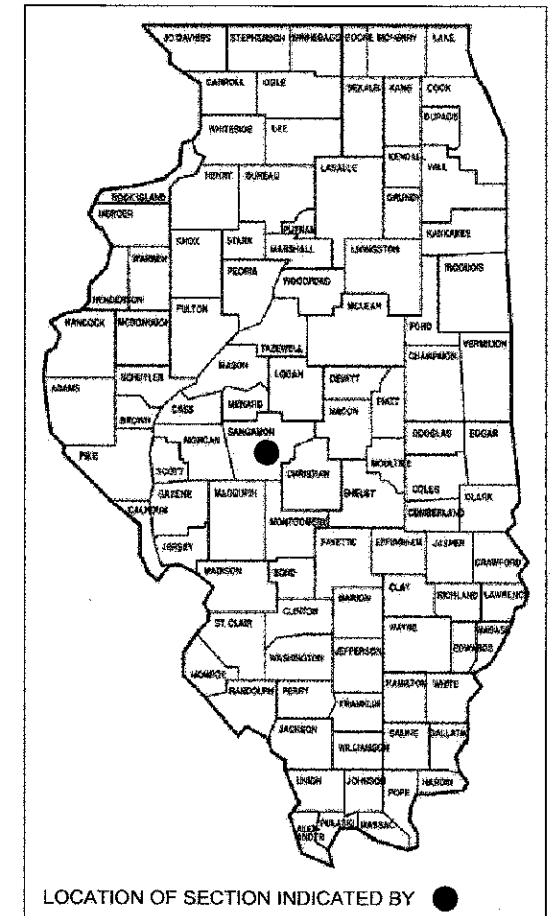
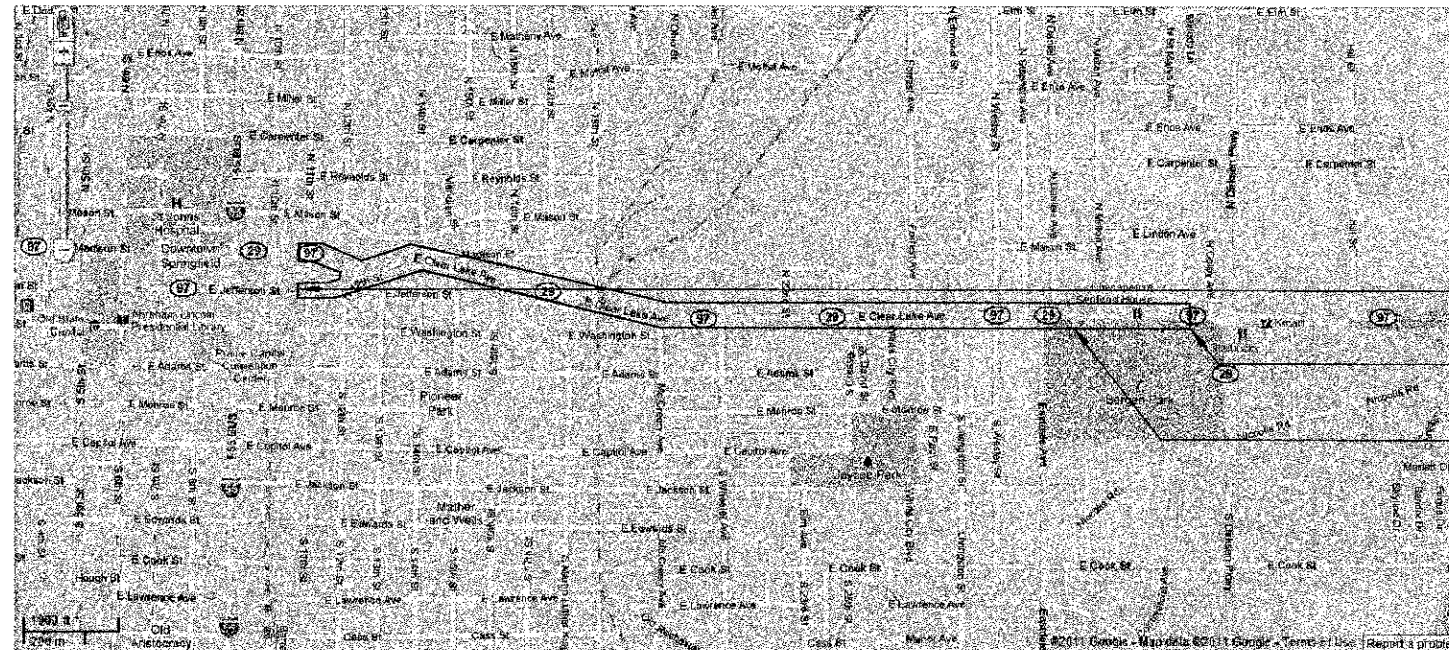

Begin Enhancement
STA 34+00 - CLEAR LAKE AVE.

End Enhancement
STA 127+50 - CLEAR LAKE AVE.

Corridor Improvements
Project Location

1/5 MI. 0 1/5 MI. 2/5 MI.

DESIGN DESIGNATION: URBAN COLLECTOR
LENGTH ENHANCEMENT = 9,350 FT. = 1.771 MILES

Massie & Massie
Associates

1210 S. 5th Street, Springfield, IL 62703 217-544-3210
www.Massie-Massie-Associates.com

State of Illinois
Professional Landscape Architect
Neil F. Beaulieu
157.001366

SIGNATURE: *Neil F. Beaulieu*
DATE SIGNED: 4/19/2012
LISC. EXP. DATE: 8/31/2013

APPROVED APRIL 20 2012
Michael Hammer
MAYOR

APPROVED April 19 2012
Andy D. ...
CITY ENGINEER

APPROVED Terrence Fontaine 2012
DISTRICT LOCAL ROADS AND STREETS ENGINEER

APPROVED April 24 2012
Ron ...
DISTRICT CONSTRUCTION ENGINEER

RELEASING FOR BID BASED ON LIMITED REVIEW Roger ... 2012
DEPUTY DIRECTOR OF HIGHWAYS, REGION FOUR ENGINEER

4/24/2012
 FILE NAME: Springfield Green-Madison/Jefferson/Clear Lake Landscape Portion
 PLOT SCALE:
 USER NAME:

SUMMARY OF QUANTITIES

CODE NO.	ITEM DESCRIPTION	UNIT	TOTAL QUANTITY
25000400	NITROGEN FERTILIZER NUTRIENT	POUND	9
25000500	PHOSPHORUS FERTILIZER NUTRIENT	POUND	9
25000600	POTASSIUM FERTILIZER NUTRIENT	POUND	9
25000210	SEEDING, CLASS 2A	ACRE	0.1
67100100	MOBILIZATION	L SUM	1
A2000090	TREE, ACER X FREEMANII ARMSTRONG (ARMSTRONG FREEMAN MAPLE), 3" CALIPER, BALLED AND BURLAPPED	EACH	5
B2001168	TREE, CERCIS CANADENSIS (EASTERN REDBUD), 7' HEIGHT, CLUMP FORM, BALLED AND BURLAPPED	EACH	7
B2001420	TREE, CORNUS MAS (CORNELIAN CHERRY DOGWOOD) 2" CALIPER, TREE FORM, BALLED AND BURLAPPED	EACH	7
B2004118	TREE, MALUS PRAIRIFIRE (PRAIRIFIRE CRABAPPLE) 2" CALIPER, TREE FORM, BALLED AND BURLAPPED	EACH	7
B2005018	TREE, MALUS SNOWDRIFT (SNOWDRIFT CRABAPPLE), 2" CALIPER, TREE FORM, BALLED AND BURLAPPED	EACH	3
C2000448	SHRUB, ARONIA ARBUTIFOLIA BRILLIANT ISSIMA (BRILLIANT RED CHOKEBERRY), 4' HEIGHT, BALLED AND BURLAPPED	EACH	43
D2001788	EVERGREEN, PICEA ABIES (NORWAY SPRUCE), 8' HEIGHT, BALLED AND BURLAPPED	EACH	3
D2002986	EVERGREEN, PINUS STROBUS (EASTERN WHITE PINE), 10' HEIGHT, BALLED AND BURLAPPED	EACH	5
* K0012990	PERENNIAL PLANTS, ORNAMENTAL TYPE, GALLON POT	UNIT	56
X2010505	CLEARING, SPECIAL	L SUM	1
X2110100	TOPSOIL FURNISH AND PLACE, SPECIAL	CU YD	100
X7010216	TRAFFIC CONTROL AND PROTECTION, (SPECIAL)	L SUM	1
C2004548	SHRUB, MYRICA PENNSYLVANICA (BAYBERRY), 4' HEIGHT, BALLED AND BURLAPPED	EACH	18
C2001865	SHRUB, ROSA X KNOCK OUT (KNOCK OUT ROSE) CONTAINER GROWN, 5-GALLON	EACH	57

* QUANTITY OF 100 PERENNIAL PLANTS IS EQUAL TO 1 UNIT.

CONSTRUCTION TYPE CODE : 0031

FILE NAME =	USER NAME =	DESIGNED - KM	REVISED -	STATE OF ILLINOIS DEPARTMENT OF TRANSPORTATION	SPRINGFIELD GREEN- MADISON/JEFFERSON/CLEAR LAKE (LANDSCAPE PORTION) SUMMARY OF QUANTITIES			F.A. - RTE.	SECTION	COUNTY	TOTAL SHEETS	SHEET NO.
FILE #		DRAWN - NFB	REVISED -		N/A	08-00461-00LS	SANAGAMON	11	2			
	PLOT SCALE =	CHECKED - KM	REVISED -		CONTRACT NO. 08-00461-00LS			FED. ROAD DIST. NO. - ILLINOIS FED. AID PROJECT				
	PLOT DATE = 4-24-2012	DATE - 4-24-2012	REVISED -		SCALE: N/A	SHEET NO. 2 OF 11 SHEETS	STA. N/A TO STA. N/A					

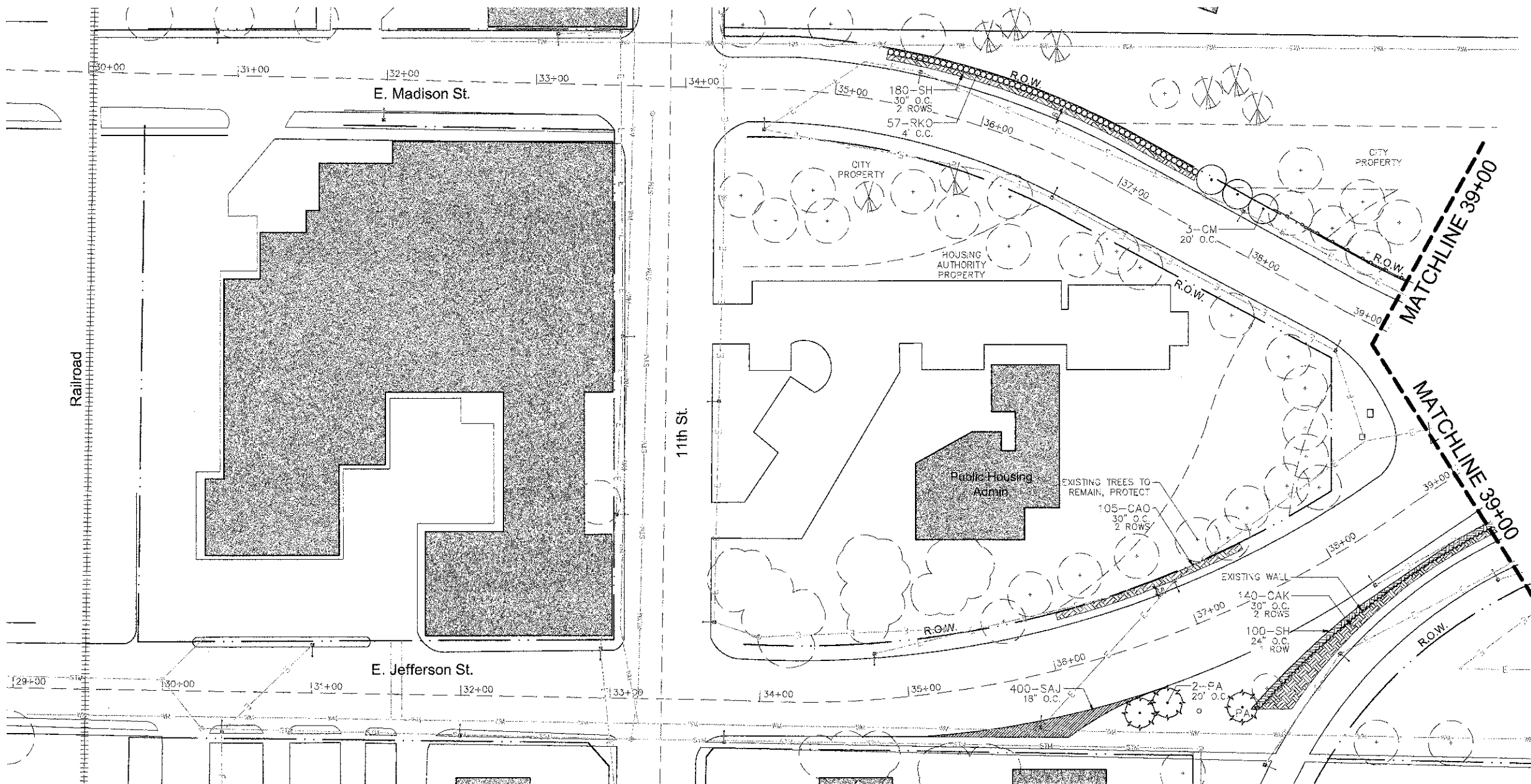

LEGEND

- Right-of-Way
- Property Line
- Existing Fence
- Street Light
- Overhead Electric
- Water Line
- Sanitary Sewer
- Existing Trees
- Proposed Shade Tree
- Proposed Evergreen Tree
- Proposed Ornamental or Columnar Tree
- Proposed Shrub
- Perennial Planting
- Ornamental Grasses
- Turf Seeding
- Buildings

* Mulch entire plant bed areas.

PLANT SCHEDULE - STA. 34+00 TO 39+00				
QTY	SYM	BOTANICAL NAME	COMMON NAME	SIZE
EVERGREEN TREE				
3	PA	PICEA ABIES	NORWAY SPRUCE	8' HEIGHT, BB
ORNAMENTAL/COLUMNAR TREE				
3	CM	CORNUS MAS	CORNELIAN CHERRY DOGWOOD	2" CAL., B.B. TREE FORM
SHRUB				
57	RKO	ROSA X 'KNOCK OUT'	KNOCK OUT ROSE	5-GAL., 3' HT.
PERENNIALS AND ORNAMENTAL GRASS				
140	CAK	CALAMAGROSTIS ACUTIFLORA 'KARL FOERSTER'	KARL FOERSTER REED GRASS	1-GAL. WELL DEVELOPED
105	CAO	CALAMAGROSTIS ACUTIFLORA 'OVERDAM'	OVERDAM REED GRASS	1-GAL. WELL DEVELOPED
400	SAJ	SEDUM 'AUTUMN JOY'	AUTUMN JOY SEDUM	1-GAL. WELL DEVELOPED
280	SH	SPOROBOLUS HETEROLEPIS	PRAIRIE DROPSEED	1-GAL. WELL DEVELOPED

NOTES:

- CONTRACTOR TO CONTACT J.U.I.E. (1-800-892-0123) BEFORE DIGGING TO LOCATE UNDERGROUND UTILITIES.
- ALL UTILITY LOCATIONS ARE PER UTILITY AND CITY OF SPRINGFIELD RECORD DRAWINGS. SPECIFIC LOCATIONS WERE NOT EXCAVATED FOR FIELD VERIFICATION.

40 0 40 80

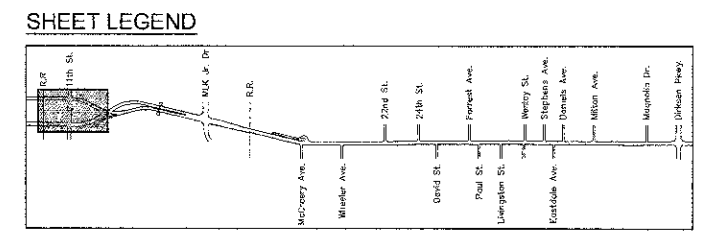

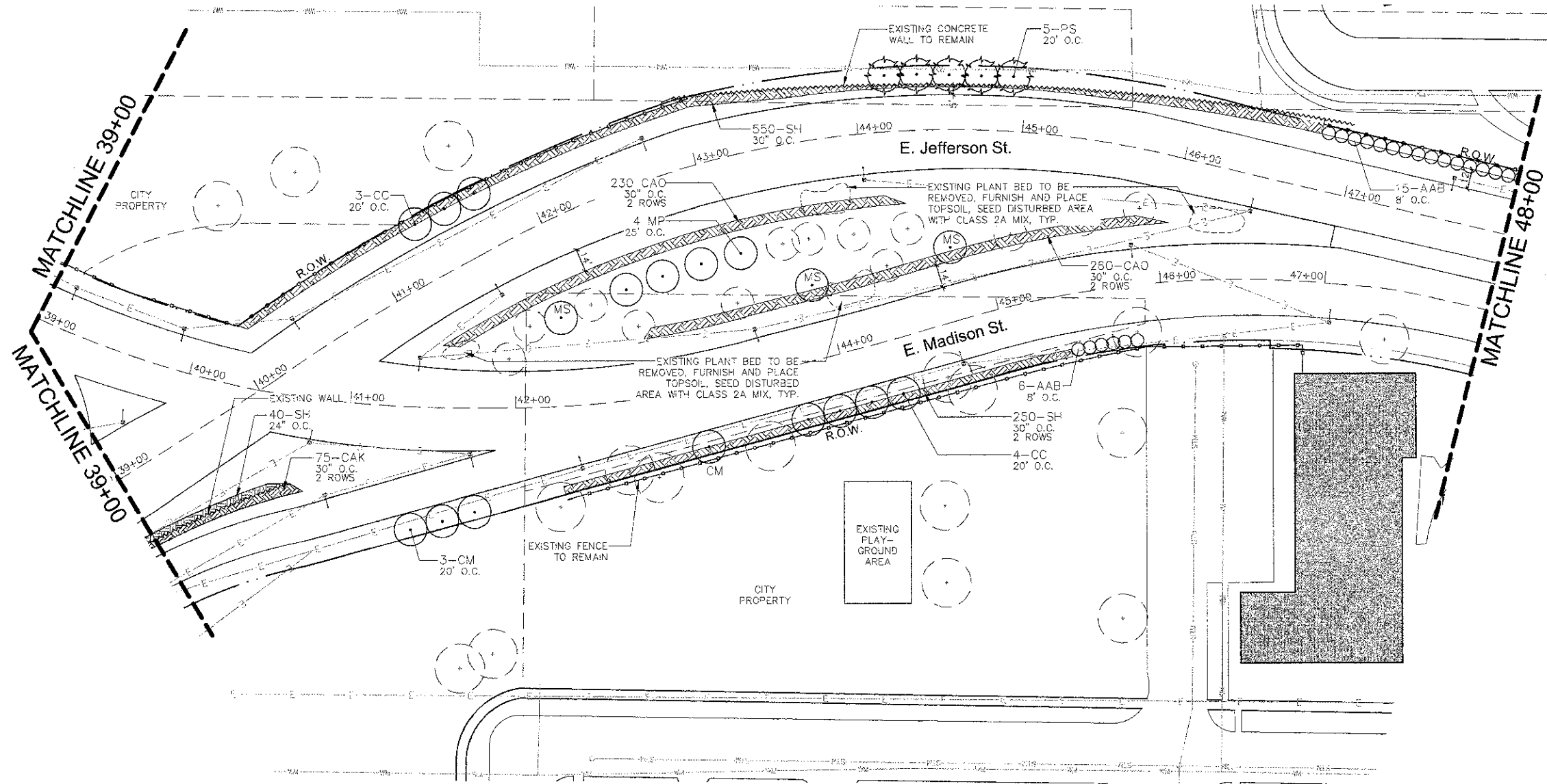

LEGEND

- Right-of-Way
- Property Line
- Existing Fence
- Street Light
- Overhead Electric
- Water Line
- Sanitary Sewer
- Existing Trees
- Proposed Shade Tree
- Proposed Evergreen Tree
- Proposed Ornamental or Columnar Tree
- Proposed Shrub
- Perennial Planting
- Ornamental Grasses
- Turf Seeding
- Buildings

* Much entire plant bed areas.

PLANT SCHEDULE - STA. 39+00 TO 48+00

QTY	SYM	BOTANICAL NAME	COMMON NAME	SIZE
EVERGREEN TREE				
5	PS	PINUS STROBUS	EASTERN WHITE PINE	10' HEIGHT, BB
ORNAMENTAL/COLUMNAR TREE				
7	CC	CERCIS CANADENSIS	EASTERN REDBUD	7' HEIGHT, BB CLUMP FORM
4	CM	CORNUS MAS	CORNELIAN CHERRY DOGWOOD	2" CAL., B.B. TREE FORM
4	MP	MALUS X 'PRAIRIFIRE'	PRAIRIFIRE CRABAPPLE	2" CAL., BB TREE FORM
3	MS	MALUS SNOWDRIFT	SNOWDRIFT CRABAPPLE	2" CAL., BB TREE FORM
SHRUB				
21	AAB	ARONIA ARBUTIFOLIA BRILLIANTISSIMA	BRILLIANT RED CHOKEBERRY	4' HEIGHT B.B.
PERENNIALS OR ORNAMENTAL GRASS				
75	CAK	CALAMAGROSTIS ACUTIFLORA 'KARL FOERSTER'	KARL FOERSTER REED GRASS	1-CAL. WELL DEVELOPED
490	CAO	CALAMAGROSTIS ACUTIFLORA 'OVERDAM'	OVERDAM REED GRASS	1-CAL. WELL DEVELOPED
840	SH	SPOROBOLUS HETEROLEPIS	PRAIRIE DROPSEED	1-CAL. WELL DEVELOPED

- NOTES:**
- CONTRACTOR TO CONTACT J.U.L.I.E. (1-800-892-0123) BEFORE DIGGING TO LOCATE UNDERGROUND UTILITIES.
 - ALL UTILITY LOCATIONS ARE PER UTILITY AND CITY OF SPRINGFIELD RECORD DRAWINGS. SPECIFIC LOCATIONS WERE NOT EXCAVATED FOR FIELD VERIFICATION.



SHEET LEGEND

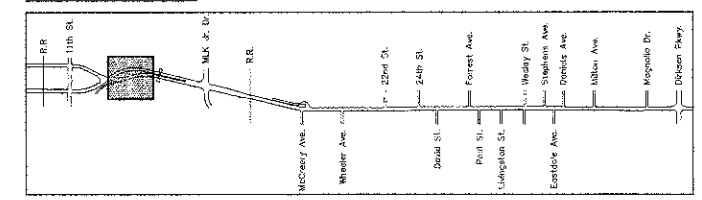

Massie & Massie Associates
 1210 S. 5th Street, Springfield, IL 62703 217-544-3210
 421 West Main Street, Decatur, IL 62522 217-424-0792

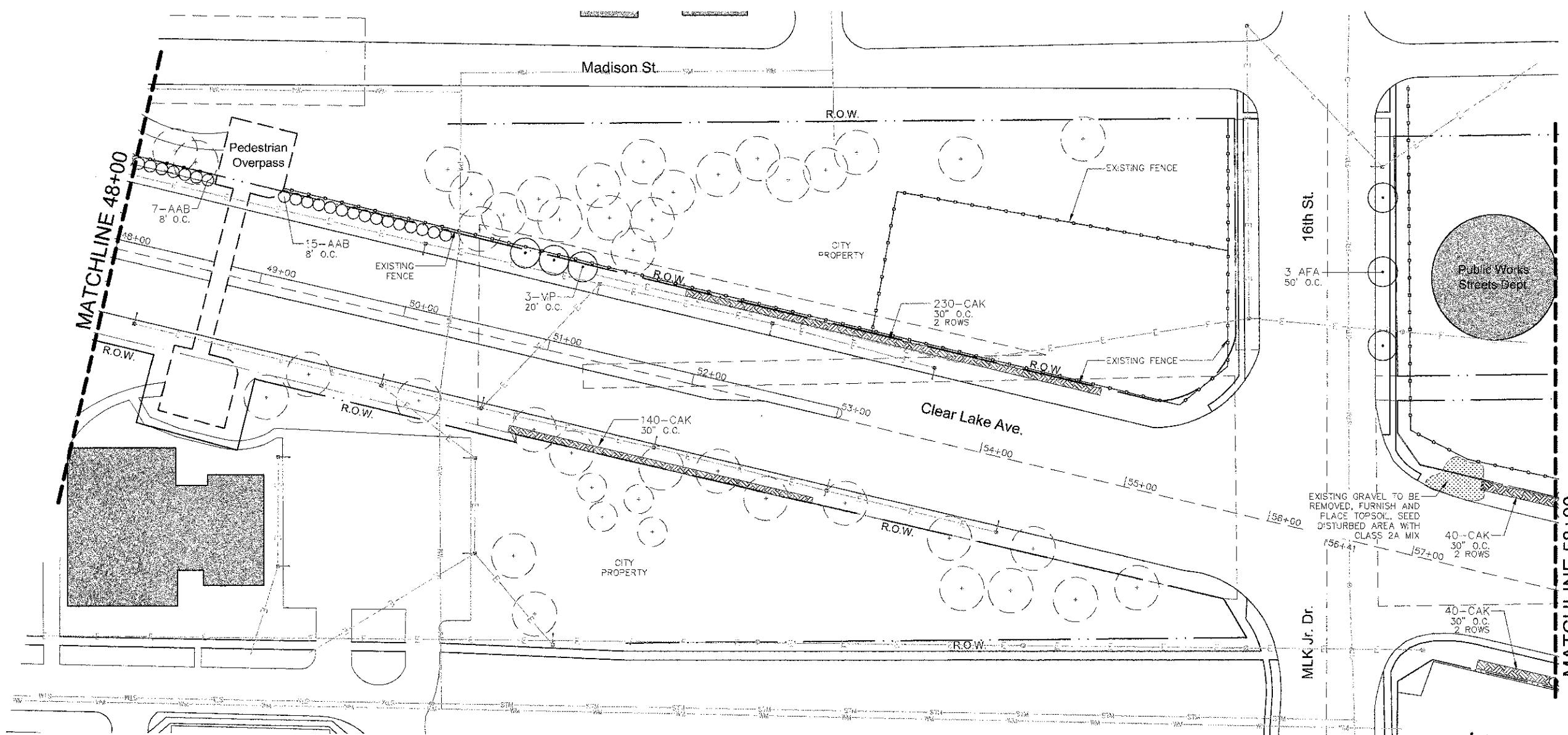

LEGEND

- Right-of-Way
- Property Line
- Existing Fence
- Street Light
- Overhead Electric
- Water Line
- Sanitary Sewer
- Existing Trees
- Proposed Shade Tree
- Proposed Evergreen Tree
- Proposed Ornamental or Columnar Tree
- Proposed Shrub
- Perennial Planting
- Ornamental Grasses
- Turf Seeding
- Buildings

* Mulch entire plant bed areas.

PLANT SCHEDULE - STA. 48+00 TO 58+00

QTY	SYM	BOTANICAL NAME	COMMON NAME	SIZE
SHADE TREE				
3	AFA	ACER X FREEMANII ARMSTRONG	ARMSTRONG FREEMAN MAPLE	3" CAL., BB
ORNAMENTAL/COLUMNAR TREE				
3	MP	MALUS X 'PRAIRIFIRE'	PRAIRIFIRE CRABAPPLE	2" CAL., BB TREE FORM
SHRUB				
22	AAB	ARONIA ARBUTIFOLIA BRILLIANTISSIMA	BRILLIANT RED CHOKEBERRY	4' HEIGHT B.B.
PERENNIALS OR ORNAMENTAL GRASS				
450	CAK	CALAMAGROSTIS ACUTIFLORA 'KARL FOERSTER'	KARL FOERSTER REED GRASS	1-GAL WELL DEVELOPED

SEEDING SCHEDULE - STA. 48+00 TO 58+00

CLASS 2A - SALT TOLERANT ROADSIDE MIXTURE	
COMMON NAME	LBS/ACRE
INFERNO TALL FESCUE OR TARHEEL II TALL FESCUE	60
PERENNIAL RYEGRASS	20
AUDUBON RED FESCUE	30
RESCUE 911 HARD FESCUE	30
FULTS SALT GRASS1	60







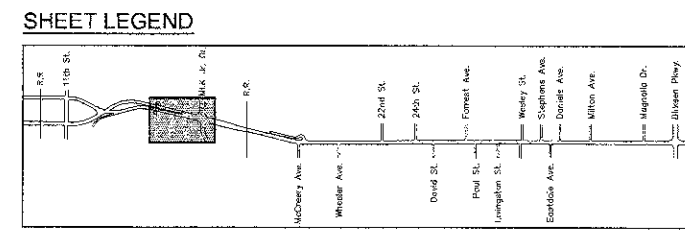



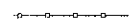
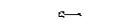
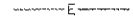
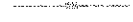

NOTES:

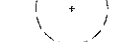
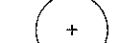
- CONTRACTOR TO CONTACT J.U.L.I.E. (1-800-892-9123) BEFORE DIGGING TO LOCATE UNDERGROUND UTILITIES.
- ALL UTILITY LOCATIONS ARE PER UTILITY AND CITY OF SPRINGFIELD RECORD DRAWINGS. SPECIFIC LOCATIONS WERE NOT EXCAVATED FOR FIELD VERIFICATION.

40 0 40 80



LEGEND

- Right-of-Way 
- Property Line 
- Existing Fence 
- Street Light 
- Overhead Electric 
- Water Line 
- Sanitary Sewer 
- Existing Trees 
- Proposed Shade Tree 
- Proposed Evergreen Tree 
- Proposed Ornamental or Columnar Tree 
- Proposed Shrub 
- Perennial Planting 
- Ornamental Grasses 
- Turf Seeding 
- Buildings 

* Mulch entire plant bed areas.

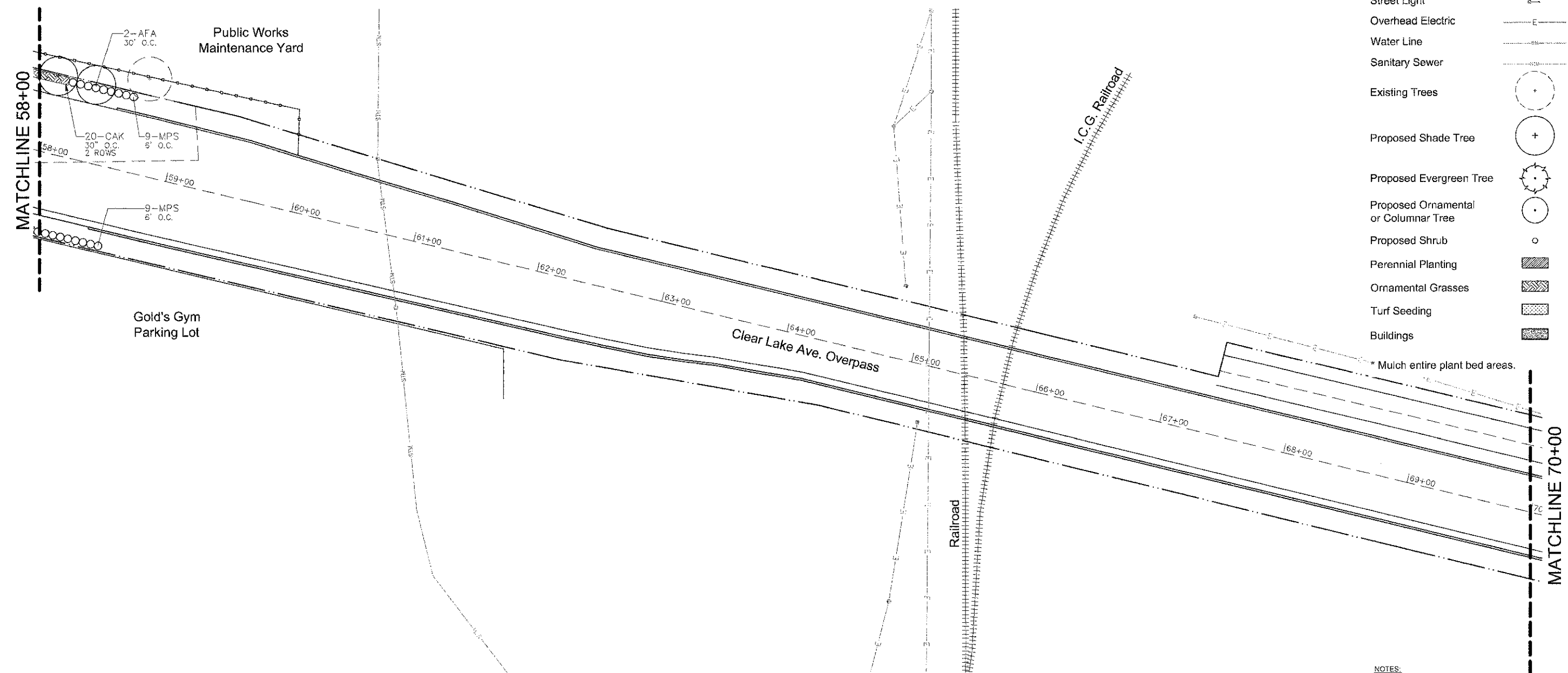

PLANT SCHEDULE - STA. 58+00 TO 70+00				
QTY	SYM	BOTANICAL NAME	COMMON NAME	SIZE
SHADE TREE				
2	AFA	ACER X FREEMANII ARMSTRONG	ARMSTRONG FREEMAN MAPLE	3" CAL., BB
SHRUB				
18	MPS	MYRICA PENNSYLVANICA	BAYBERRY	4' HEIGHT B.B.
PERENNIALS OR ORNAMENTAL GRASS				
20	CAK	CALAMAGROSTIS ACUTIFLORA "KARL FOERSTER"	KARL FOERSTER REED GRASS	1-GAL. WELL DEVELOPED

- NOTES:**
- CONTRACTOR TO CONTACT J.U.L.I.E. (1-800-892-0123) BEFORE DIGGING TO LOCATE UNDERGROUND UTILITIES.
 - ALL UTILITY LOCATIONS ARE PER UTILITY AND CITY OF SPRINGFIELD RECORD DRAWINGS. SPECIFIC LOCATIONS WERE NOT EXCAVATED FOR FIELD VERIFICATION.

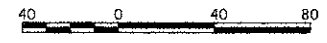

SHEET LEGEND

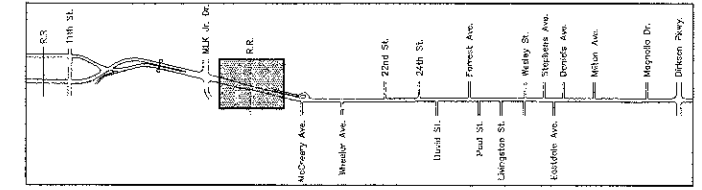

Massie & Massie Associates
 1210 S. 5th Street, Springfield, IL 62703 217-544-3210
 421 West Main Street, Decatur, IL 62522 217-424-0792

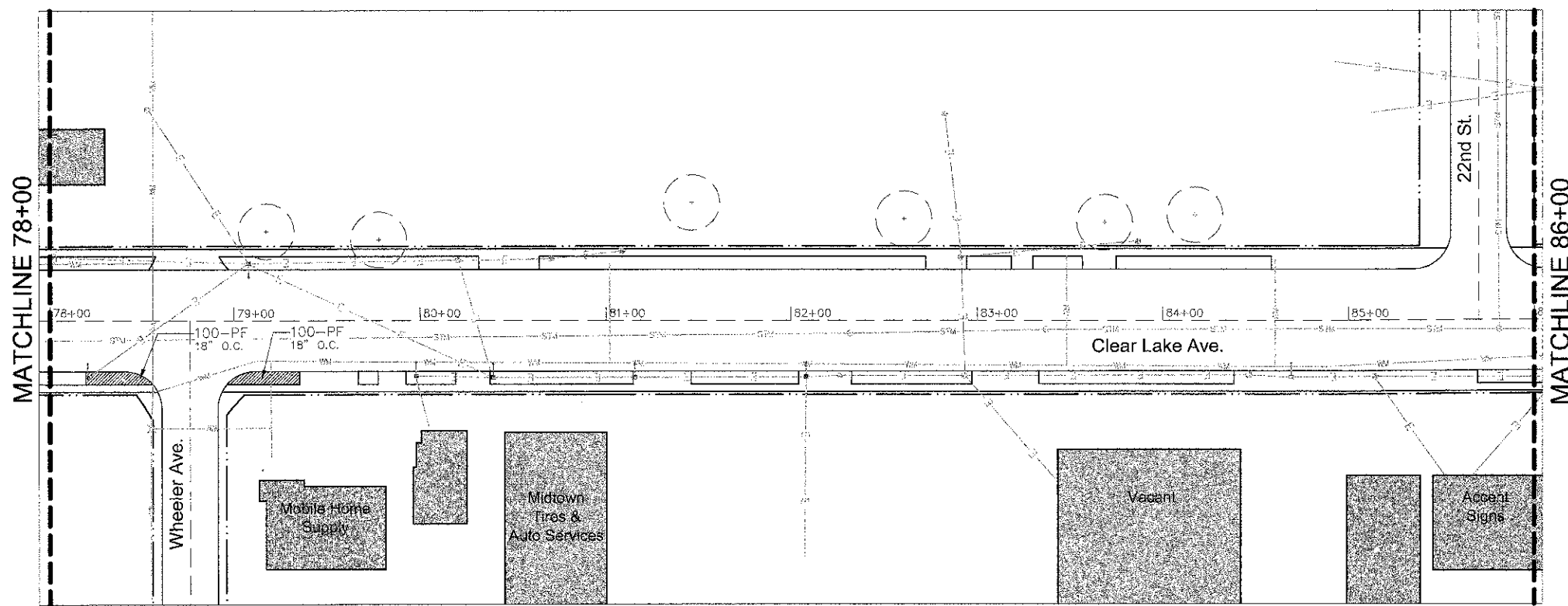
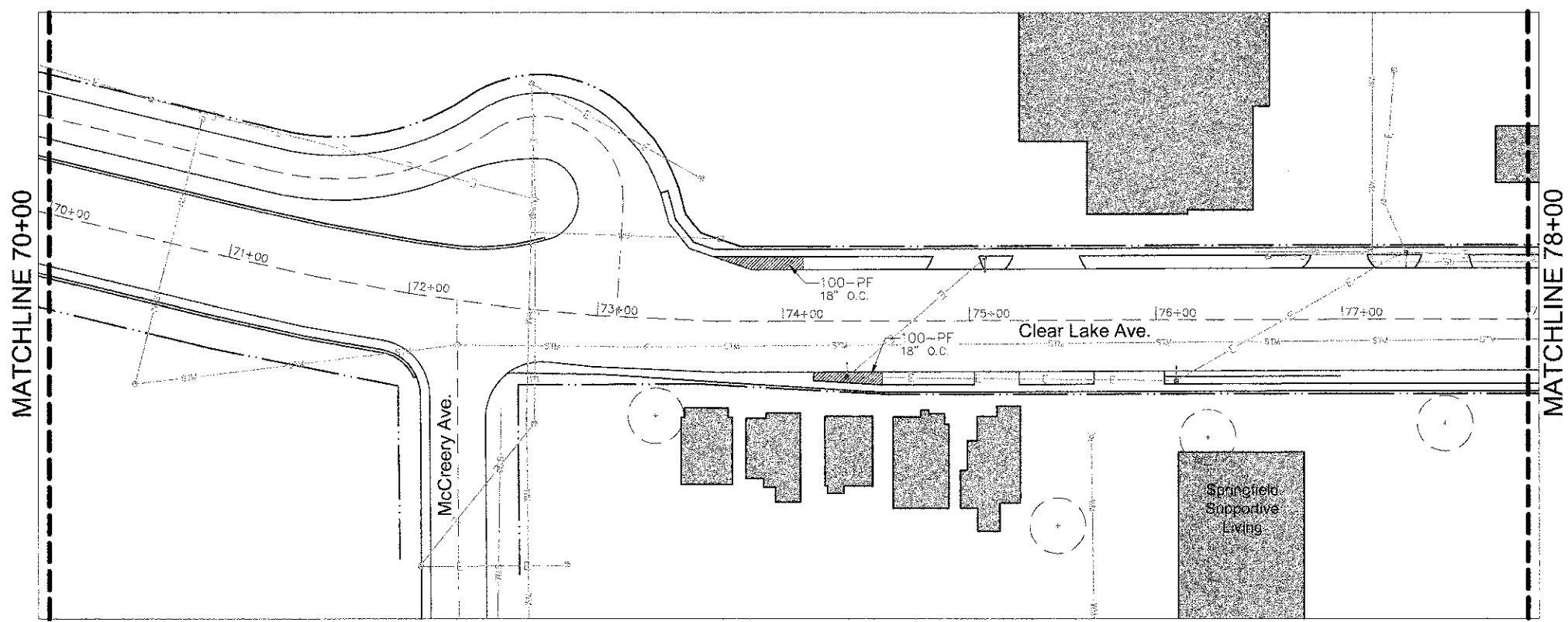

LEGEND

- Right-of-Way
- Property Line
- Existing Fence
- Street Light
- Overhead Electric
- Water Line
- Sanitary Sewer
- Existing Trees
- Proposed Shade Tree
- Proposed Evergreen Tree
- Proposed Ornamental or Columnar Tree
- Proposed Shrub
- Perennial Planting
- Ornamental Grasses
- Turf Seeding
- Buildings

* Mulch entire plant bed areas.

PLANT SCHEDULE - STA. 70+00 TO 86+00				
QTY	SYM	BOTANICAL NAME	COMMON NAME	SIZE
PERENNIALS OR ORNAMENTAL GRASS				
400	PF	DAYLILY FLOWER MIX. 1/3 BLACK EYED STELLA DAYLILY (ORANGE), 1/3 PARDON ME DAYLILY (RED), AND 1/3 STELLA D'ORO DAYLILY (YELLOW). PLANT DAYLILIES IN ALTERNATING PATTERN TO MIX VARIETIES UNIFORMLY THROUGHOUT THE PLANT BED.		
133		HEMEROCALLIS 'BLACK EYED STELLA'	BLACK EYED STELLA DAYLILY	1-GAL. WELL DEVELOPED
133		HEMEROCALLIS 'PARDON ME'	PARDON ME DAYLILY	1-GAL. WELL DEVELOPED
134		HEMEROCALLIS 'STELLA D'ORO'	STELLA D'ORO DAYLILY	1-GAL. WELL DEVELOPED

- NOTES:**
- CONTRACTOR TO CONTACT J.U.L.I.E. (1-800-892-0123) BEFORE DIGGING TO LOCATE UNDERGROUND UTILITIES.
 - ALL UTILITY LOCATIONS ARE PER UTILITY AND CITY OF SPRINGFIELD RECORD DRAWINGS. SPECIFIC LOCATIONS WERE NOT EXCAVATED FOR FIELD VERIFICATION.



SHEET LEGEND

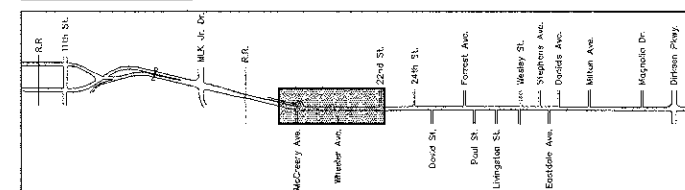

FILE NAME =	USER NAME =	DESIGNED - KM	REVISED -	STATE OF ILLINOIS DEPARTMENT OF TRANSPORTATION	CITY OF SPRINGFIELD CLEAR LAKE AVENUE IMPROVEMENTS PLANTING PLAN - STA. 70+00 TO STA. 86+00	F.A. RTE.	SECTION	COUNTY	TOTAL SHEETS	SHEET NO.	
#FILE#		DRAWN - NFB	REVISED -			N/A	08-00461-D0L5	SANGAMON	11	7	
	PLOT SCALE = 1" = 40'	CHECKED - KM	REVISED -			CONTRACT NO. 03581					
	PLOT DATE = 4-18-2012	DATE - 4-18-2012	REVISED -			FED. ROAD DIST. NO. - ILLINOIS FED. AID PROJECT					
				SCALE: 1"=40'		SHEET NO. 7 OF 11 SHEETS		STA. 70+00 TO STA. 86+00			

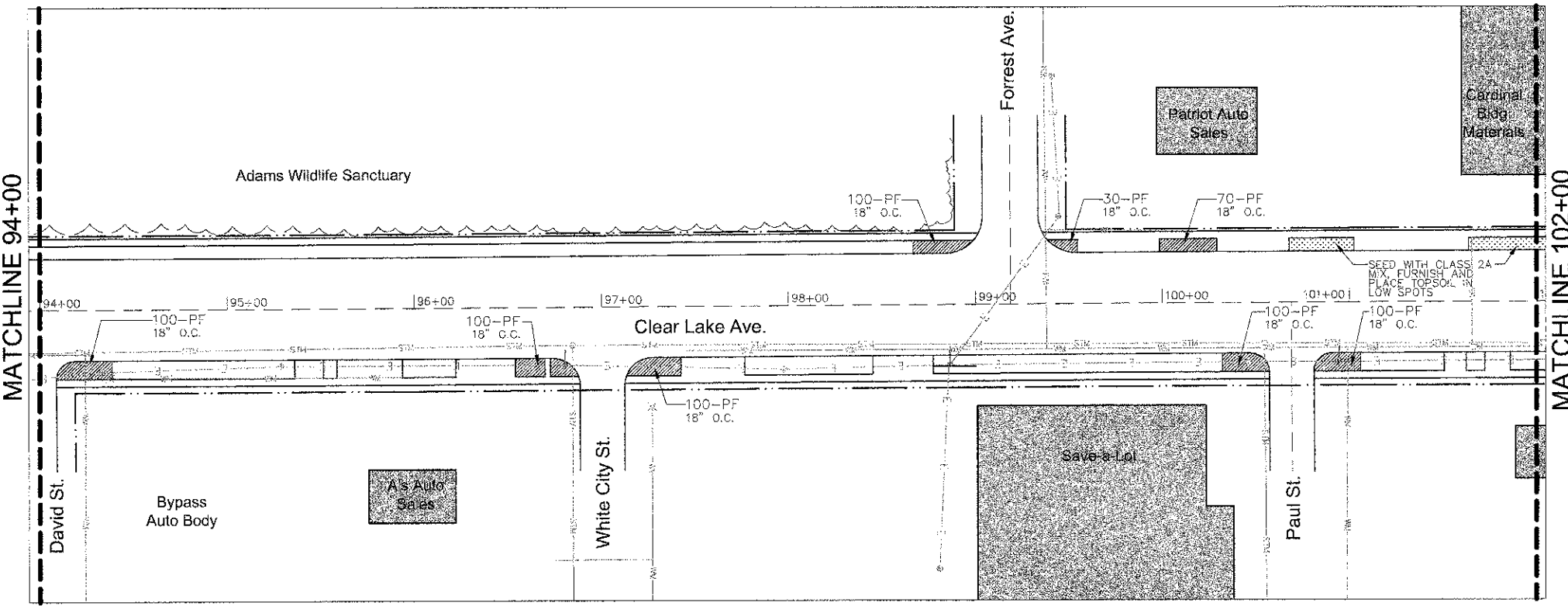
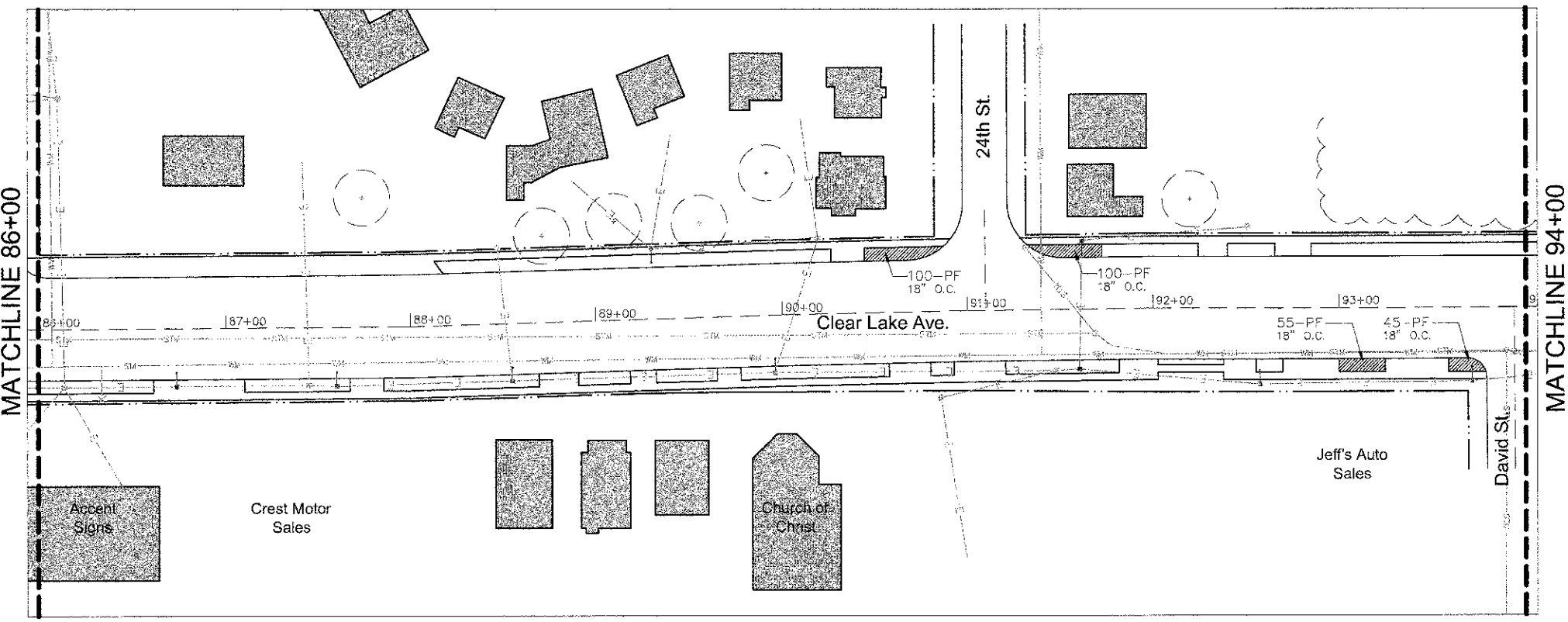

LEGEND

- Right-of-Way
- Property Line
- Existing Fence
- Street Light
- Overhead Electric
- Water Line
- Sanitary Sewer
- Existing Trees
- Proposed Shade Tree
- Proposed Evergreen Tree
- Proposed Ornamental or Columnar Tree
- Proposed Shrub
- Perennial Planting
- Ornamental Grasses
- Turf Seeding
- Buildings

* Mulch entire plant bed areas.

PLANT SCHEDULE - STA. 86+00 TO 102+00

QTY	SYM	BOTANICAL NAME	COMMON NAME	SIZE
PERENNIALS OR ORNAMENTAL GRASS				
1,000	PF	DAYLILY FLOWER MIX, 1/3 BLACK EYED STELLA DAYLILY (ORANGE), 1/3 PARDON ME DAYLILY (RED), AND 1/3 STELLA D'ORO DAYLILY (YELLOW). PLANT DAYLILIES IN ALTERNATING PATTERN TO MIX VARIETIES UNIFORMLY THROUGHOUT THE PLANT BED.		
333		HEMEROCALLIS 'BLACK EYED STELLA'	BLACK EYED STELLA DAYLILY	1-GAL. WELL DEVELOPED
333		HEMEROCALLIS 'PARDON ME'	PARDON ME DAYLILY	1-GAL. WELL DEVELOPED
334		HEMEROCALLIS 'STELLA D'ORO'	STELLA D'ORO DAYLILY	1-GAL. WELL DEVELOPED

SEEDING SCHEDULE - STA. 86+00 TO 102+00

CLASS 2A - SALT TOLERANT ROADSIDE MIXTURE		LBS/ACRE
COMMON NAME		
INFERNAL TALL FESCUE OR TARHEEL II TALL FESCUE		60
PERENNIAL RYEGRASS		20
AUDUBON RED FESCUE		30
RESCUE 911 HARD FESCUE		30
FULTS SALT GRASS1		60

- NOTES:**
- CONTRACTOR TO CONTACT J.U.L.I.E. (1-800-892-0123) BEFORE DIGGING TO LOCATE UNDERGROUND UTILITIES.
 - ALL UTILITY LOCATIONS ARE PER UTILITY AND CITY OF SPRINGFIELD RECORD DRAWINGS. SPECIFIC LOCATIONS WERE NOT EXCAVATED FOR FIELD VERIFICATION.



SHEET LEGEND

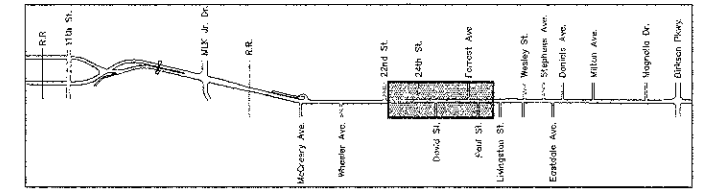

FILE NAME = #FILE#	USER NAME =	DESIGNED - KM	REVISED -	STATE OF ILLINOIS DEPARTMENT OF TRANSPORTATION	CITY OF SPRINGFIELD CLEAR LAKE AVENUE IMPROVEMENTS PLANTING PLAN - STA. 86+00 TO STA 102+00			F.A. RTE. N/A	SECTION 08-00461-00LS	COUNTY SANGAMON	TOTAL SHEETS 11	SHEET NO. 8
	PLOT SCALE = 1" = 40'	DRAWN - NFB	REVISED -		SCALE: 1"=40'	SHEET NO. 8 OF 11 SHEETS	STA. 86+00 TO STA. 102+00	FED. ROAD DIST. NO. .	ILLINOIS FED. AID PROJECT	CONTRACT NO. 93581		
	PLOT DATE = 4-18-2012	CHECKED - KM	REVISED -									
		DATE - 4-18-2012	REVISED -									

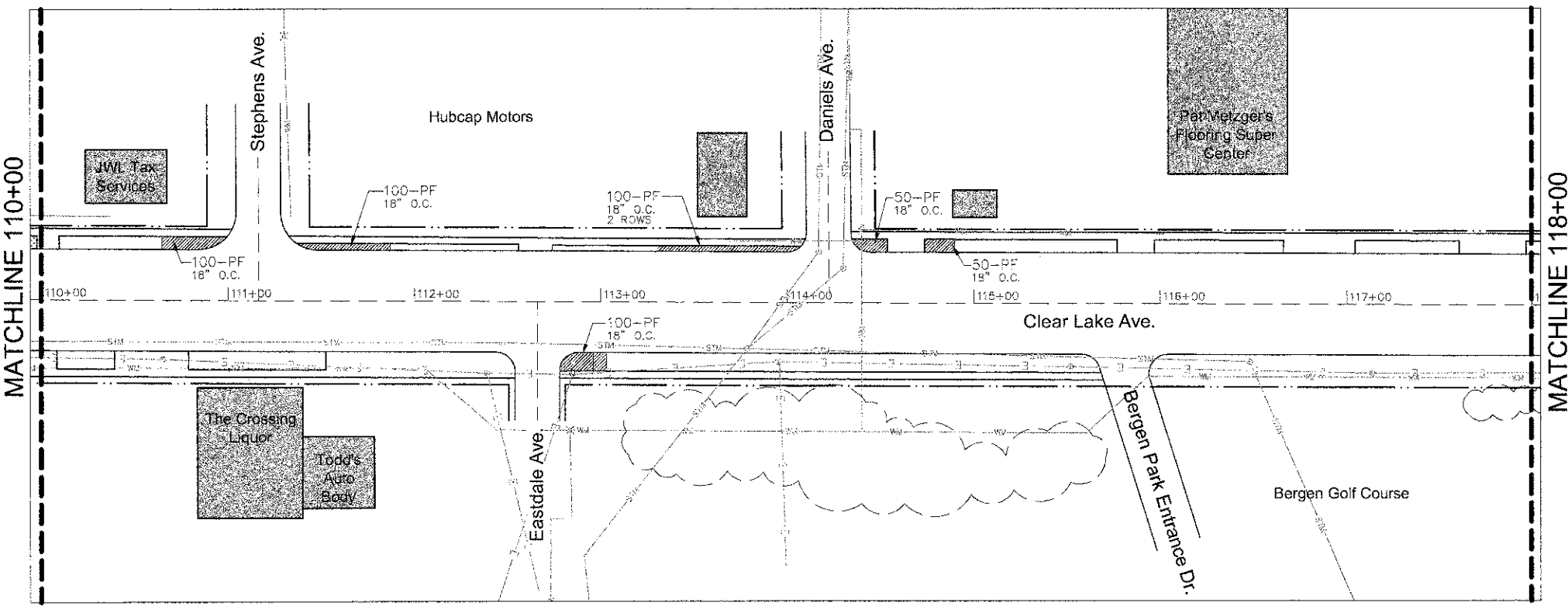
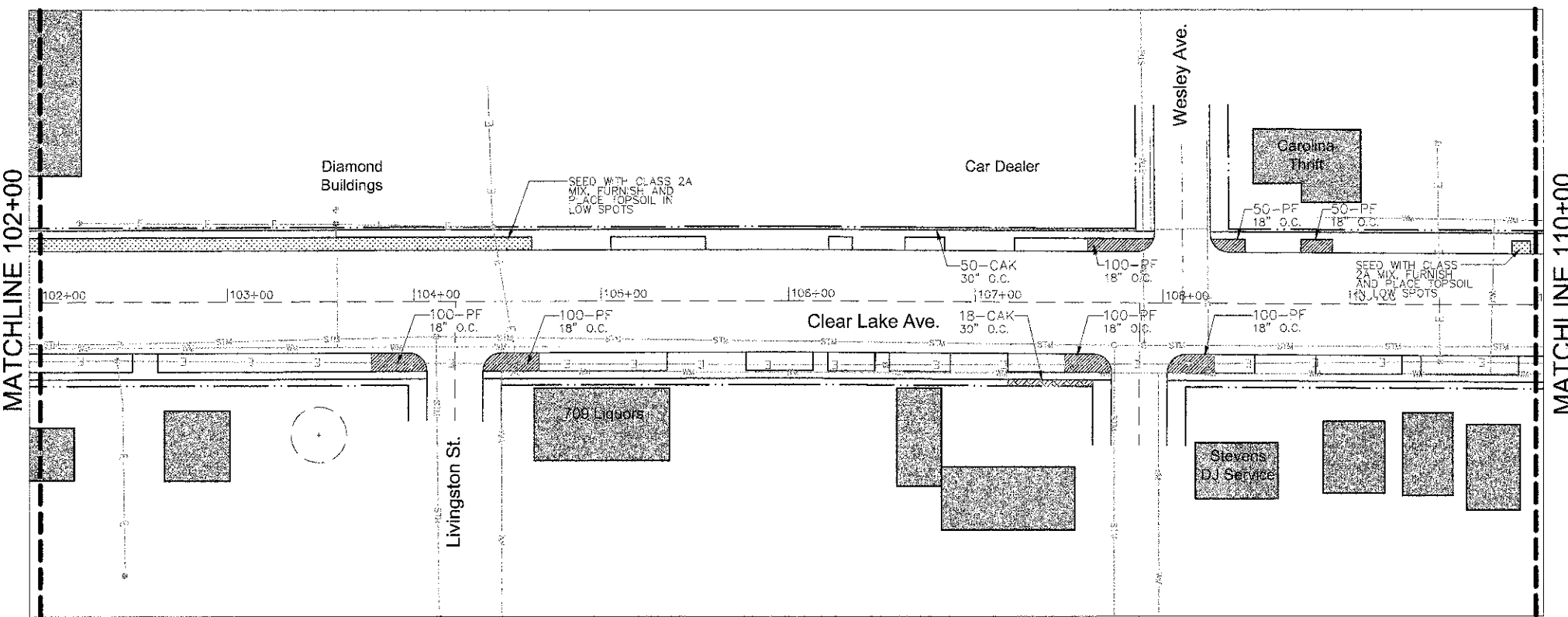

LEGEND

- Right-of-Way
- Property Line
- Existing Fence
- Street Light
- Overhead Electric
- Water Line
- Sanitary Sewer
- Existing Trees
- Proposed Shade Tree
- Proposed Evergreen Tree
- Proposed Ornamental or Columnar Tree
- Proposed Shrub
- Perennial Planting
- Ornamental Grasses
- Turf Seeding
- Buildings

* Mulch entire plant bed areas.

PLANT SCHEDULE - STA. 102+00 TO 118+00

QTY	SYM	BOTANICAL NAME	COMMON NAME	SIZE
PERENNIALS OR ORNAMENTAL GRASS				
1,100	PF	DAYLILY FLOWER MIX. 1/3 BLACK EYED STELLA DAYLILY (ORANGE), 1/3 PARDON ME DAYLILY (RED), AND 1/3 STELLA D'ORO DAYLILY (YELLOW). PLANT DAYLILIES IN ALTERNATING PATTERN TO MIX VARIETIES UNIFORMLY THROUGHOUT THE PLANT BED.		
366		HEMEROCALLIS 'BLACK EYED STELLA'	BLACK EYED STELLA DAYLILY	1-GAL. WELL DEVELOPED
367		HEMEROCALLIS 'PARDON ME'	PARDON ME DAYLILY	1-GAL. WELL DEVELOPED
367		HEMEROCALLIS 'STELLA D'ORO'	STELLA D'ORO DAYLILY	1-GAL. WELL DEVELOPED
68	CAK	CALAMAGROSTIS ACUTIFLORA 'KARL FOERSTER'	KARL FOERSTER REED GRASS	1-GAL. WELL DEVELOPED

SEEDING SCHEDULE - STA. 102+00 TO 118+00

CLASS 2A - SALT TOLERANT ROADSIDE MIXTURE		LBS./ACRE
COMMON NAME		
INFERNAL TALL FESCUE OR TARHEEL II TALL FESCUE		60
PERENNIAL RYEGRASS		20
AUDUBON RED FESCUE		30
RESCUE 911 HARD FESCUE		30
FULTS SALT GRASS I		60

NOTES:

- CONTRACTOR TO CONTACT J.U.L.I.E. (1-800-892-0223) BEFORE DIGGING TO LOCATE UNDERGROUND UTILITIES.
- ALL UTILITY LOCATIONS ARE PER UTILITY AND CITY OF SPRINGFIELD RECORD DRAWINGS. SPECIFIC LOCATIONS WERE NOT EXCAVATED FOR FIELD VERIFICATION.



SHEET LEGEND

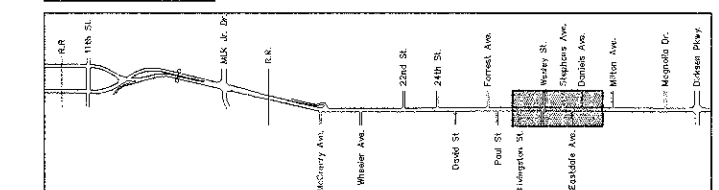

FILE NAME =	USER NAME =	DESIGNED - KM	REVISED -	STATE OF ILLINOIS DEPARTMENT OF TRANSPORTATION	CITY OF SPRINGFIELD CLEAR LAKE AVENUE IMPROVEMENTS PLANTING PLAN - STA. 102+00 TO STA 118+00		F.A.R.T.E.	SECTION	COUNTY	TOTAL SHEETS	SHEET NO.	
FILE#		DRAWN - NFB	REVISED -		N/A	08-00461-00LS	SANAGAMON	11	9			
	PLOT SCALE = 1" = 40'	CHECKED - KM	REVISED -		SCALE: 1"=40'		SHEET NO. 9 OF 11 SHEETS		STA. 102+00 TO STA. 118+00		CONTRACT NO. 9358	
	PLOT DATE = 4-18-2012	DATE - 4-18-2012	REVISED -		FED. ROAD DIST. NO. [ILLINOIS] FED. AID PROJECT							

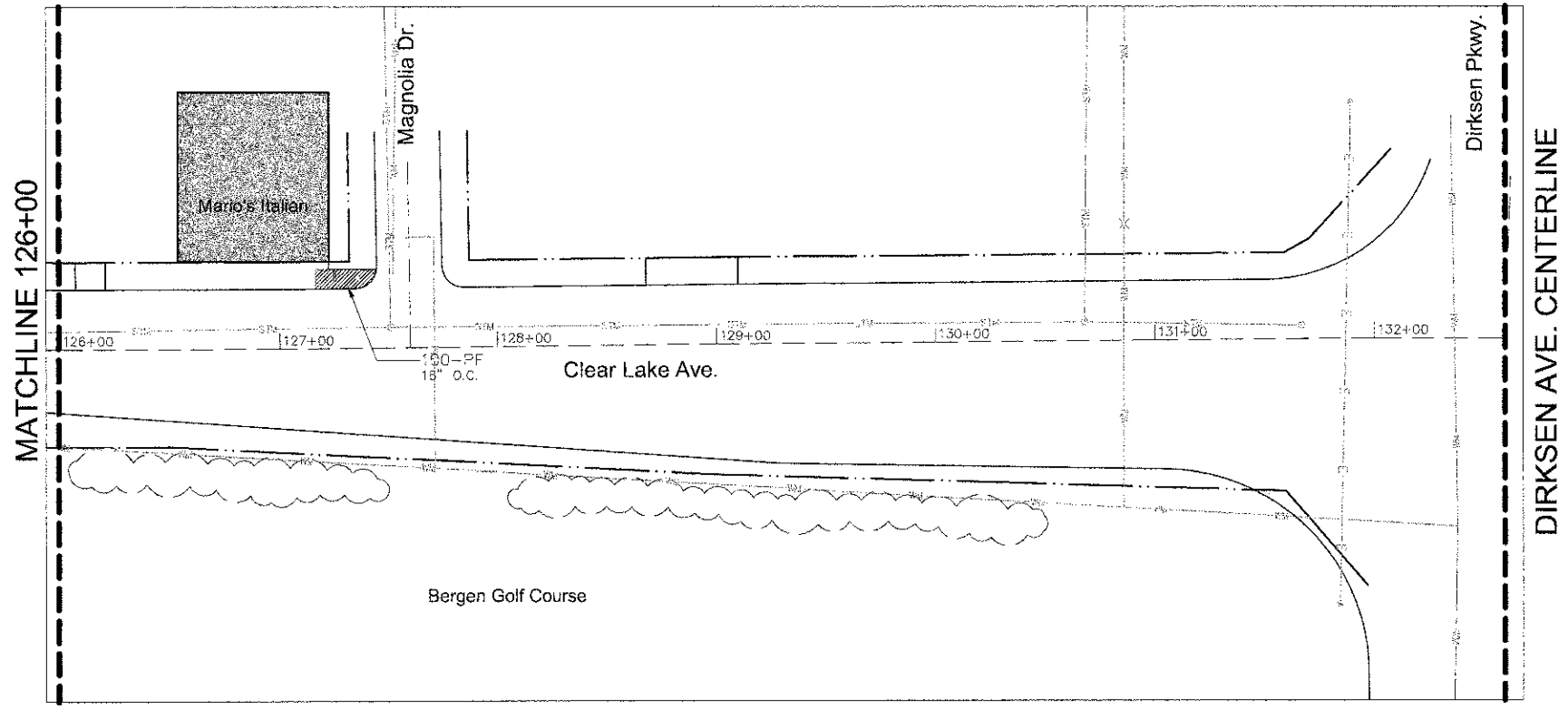
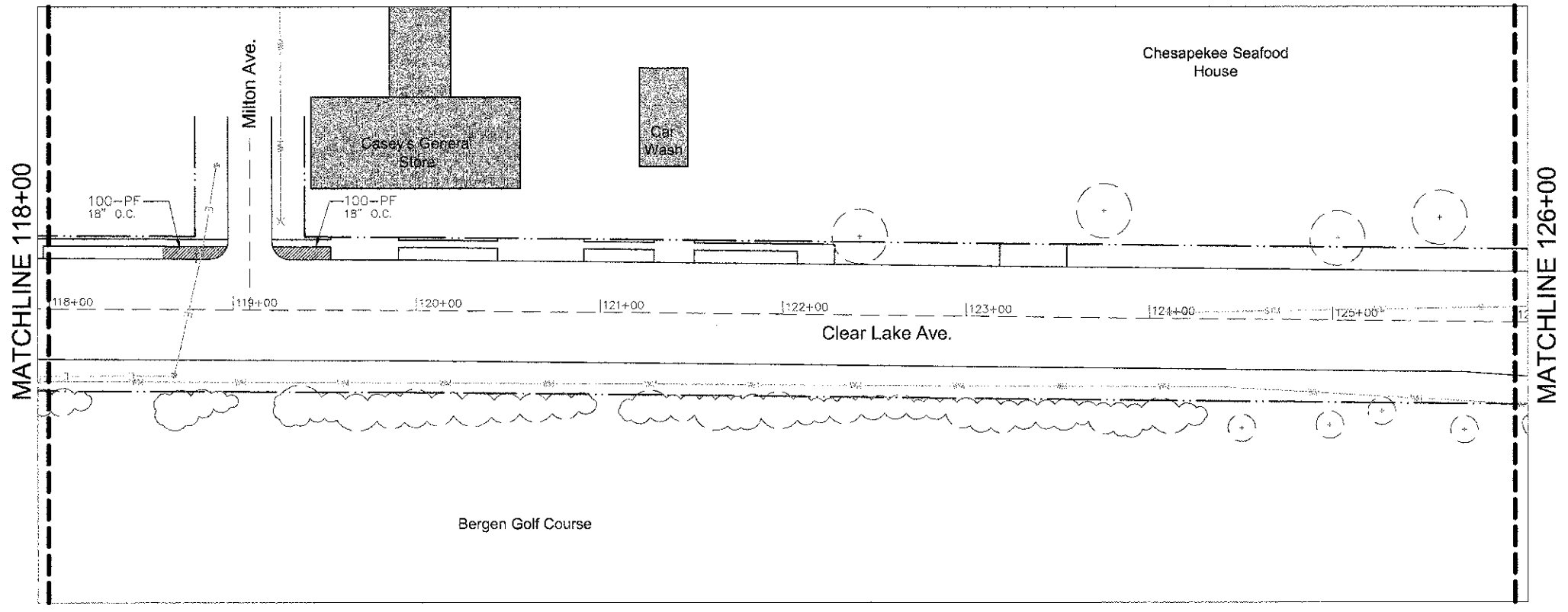

LEGEND

- Right-of-Way
 - Property Line
 - Existing Fence
 - Street Light
 - Overhead Electric
 - Water Line
 - Sanitary Sewer
 - Existing Trees
 - Proposed Shade Tree
 - Proposed Evergreen Tree
 - Proposed Ornamental or Columnar Tree
 - Proposed Shrub
 - Perennial Planting
 - Ornamental Grasses
 - Turf Seeding
 - Buildings
- * Mulch entire plant bed areas.

PLANT SCHEDULE - STA. 118+00 TO 127+50				
QTY	SYM	BOTANICAL NAME	COMMON NAME	SIZE
PERENNIALS OR ORNAMENTAL GRASS				
300	PF	DAYLILY FLOWER MIX, 1/3 BLACK EYED STELLA DAYLILY (ORANGE), 1/3 PARDON ME DAYLILY (RED), AND 1/3 STELLA D'ORO DAYLILY (YELLOW). PLANT DAYLILIES IN ALTERNATING PATTERN TO MIX VARIETIES UNIFORMLY THROUGHOUT THE PLANT BED.		
100		HEMEROCALLIS 'BLACK EYED STELLA'	BLACK EYED STELLA DAYLILY	1-GAL. WELL DEVELOPED
100		HEMEROCALLIS 'PARDON ME'	PARDON ME DAYLILY	1-GAL. WELL DEVELOPED
100		HEMEROCALLIS 'STELLA D'ORO'	STELLA D'ORO DAYLILY	1-GAL. WELL DEVELOPED

- NOTES:**
- CONTRACTOR TO CONTACT J.U.L.I.E. (1-800-892-0123) BEFORE DIGGING TO LOCATE UNDERGROUND UTILITIES.
 - ALL UTILITY LOCATIONS ARE PER UTILITY AND CITY OF SPRINGFIELD RECORD DRAWINGS. SPECIFIC LOCATIONS WERE NOT EXCAVATED FOR FIELD VERIFICATION.



SHEET LEGEND

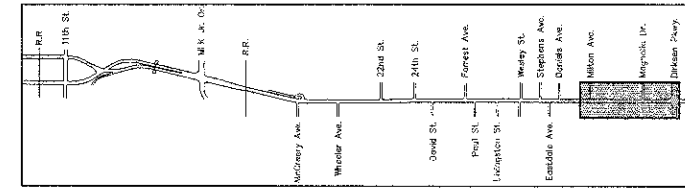

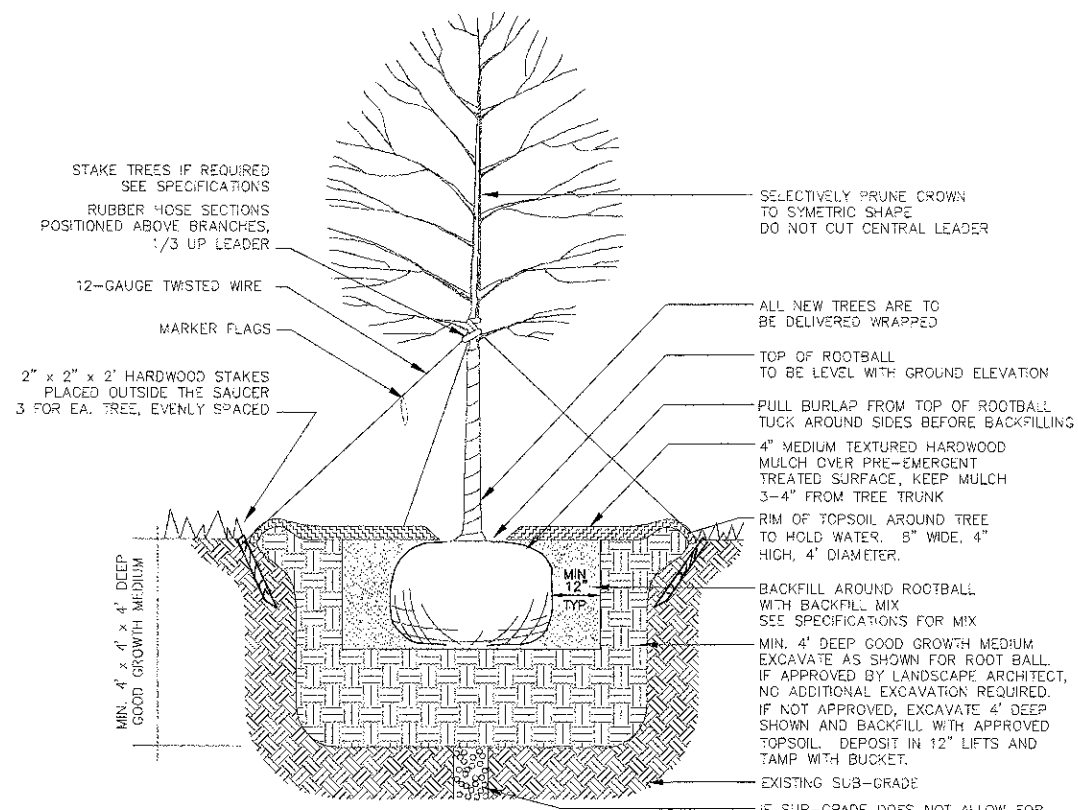

A TRENDS
NOT TO SCALE

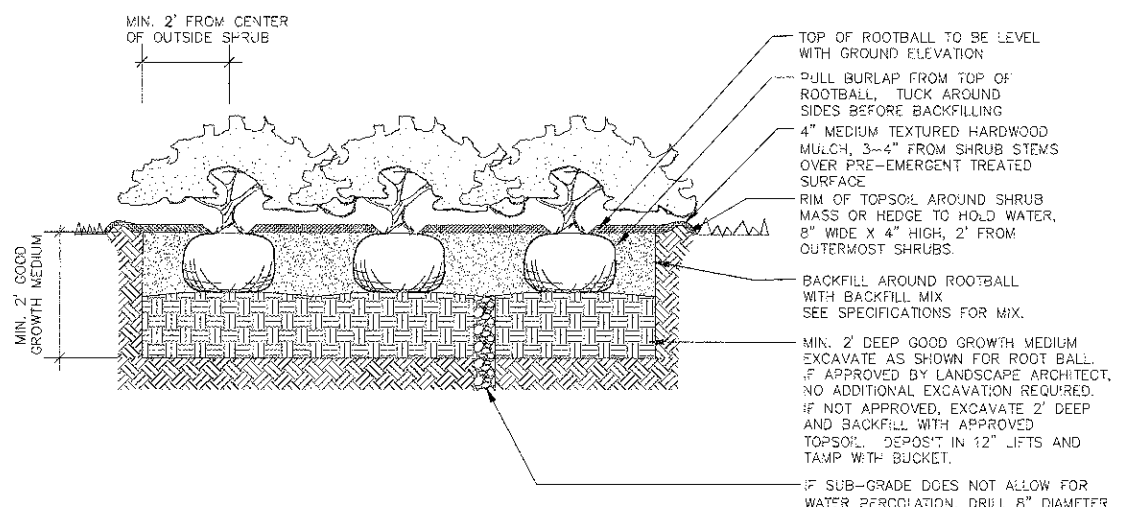

B SHRUB BEDS
NOT TO SCALE

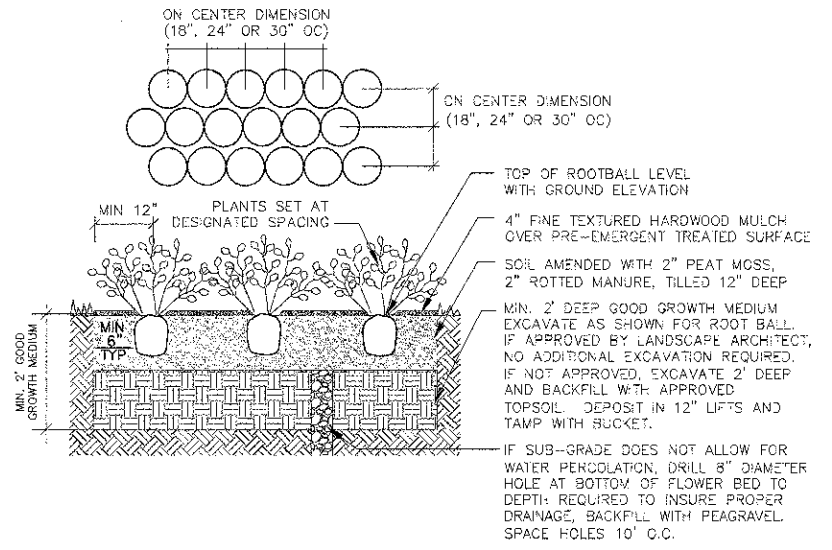

C ORNAMENTAL GRASS AND PERENNIAL BEDS
NOT TO SCALE

- NOTES:**
- CONTRACTOR TO CONTACT J.U.L.I.E. (1-800-892-0123) BEFORE DIGGING TO LOCATE UNDERGROUND UTILITIES.
 - ALL UTILITY LOCATIONS ARE PER UTILITY AND CITY OF SPRINGFIELD RECORD DRAWINGS. SPECIFIC LOCATIONS WERE NOT EXCAVATED FOR FIELD VERIFICATION.

FILE NAME =	USER NAME =	DESIGNED - KM	REVISED -	STATE OF ILLINOIS DEPARTMENT OF TRANSPORTATION	CITY OF SPRINGFIELD CLEAR LAKE AVENUE IMPROVEMENTS PLANTING DETAILS			F.A. RTE. N/A	SECTION 08-00461-00LS	COUNTY SANAGAMON	TOTAL SHEETS 11	SHEET NO. 11
FILE#	PLOT SCALE = 1" = 4'	DRAWN - NFB	REVISED -		SCALE: 1"=40'	SHEET NO. 11 OF 11 SHEETS	STA. _____ TO STA. _____	CONTRACT NO. 93581				
	PLOT DATE = 4-18-2012	CHECKED - KM	REVISED -					FED. ROAD DIST. NO. - ILLINOIS FED. AID PROJECT				
		DATE - 4-18-2012	REVISED -									