

FINAL SURVEY	BY	DATE
SUBMITTED		
PLOTTED		
TEMPLATE		
NOTE BOOK		
AREAS		
CHECKED		
NO.		

ORIGINAL SURVEY	BY	DATE
SUBMITTED		
PLOTTED		
TEMPLATE		
NOTE BOOK		
AREAS		
CHECKED		
NO.		

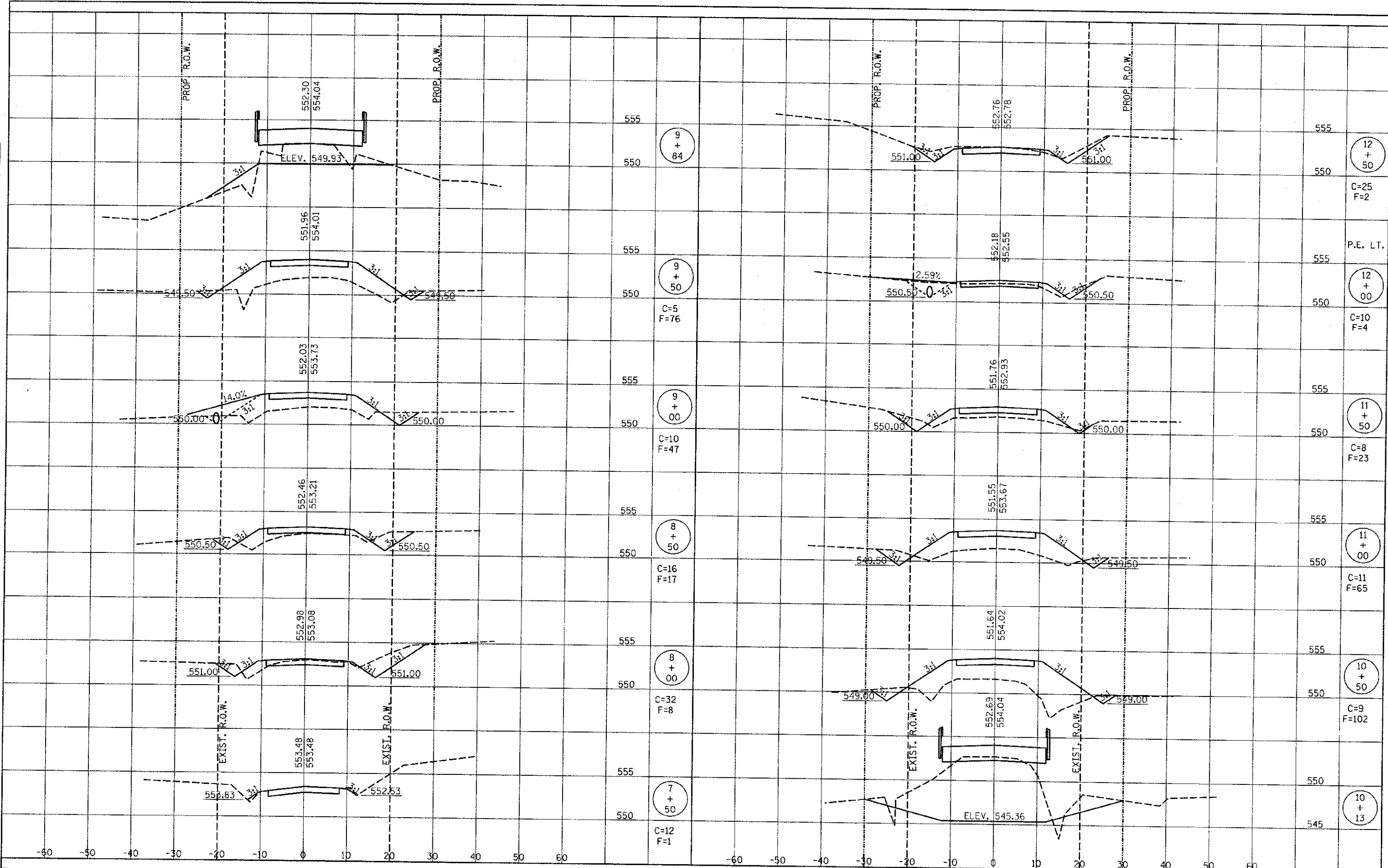

RHUTASEL and ASSOCIATES, INC.
 CONSULTING ENGINEERS • LAND SURVEYORS
 CENTRALIA, ILLINOIS FREEBURG, ILLINOIS

DESIGNED -	BLT	REVISED -	
DRAWN -	JN	REVISED -	
CHECKED -	GLH	REVISED -	
DATE -	05/18/2012	REVISED -	

STATE OF ILLINOIS
DEPARTMENT OF TRANSPORTATION

CROSS SECTIONS OF ROADWAY
STRUCTURE NO. 026-3453

STA. 7+50 TO STA. 12+50

ROUTE	SECTION	COUNTY	TOTAL SHEETS	SHEET NO.
TR 352	10-20128-00-BR	FAYETTE	10	10
RAAT JOB NO. 5101			ILLINOIS FED. AID PROJECT	
			CONTRACT NO. 95692	