

- NOTE:
- 1.) SIGN COST INCIDENTAL TO CONTRACT
 - 2.) WARNING SIGN SHALL REMAIN THE PROPERTY OF THE AIRPORT UPON COMPLETION OF THE PROJECT
 - 3.) BACKGROUND - ORANGE
LETTERS - BLACK

WARNING SIGN DETAIL
NOT TO SCALE

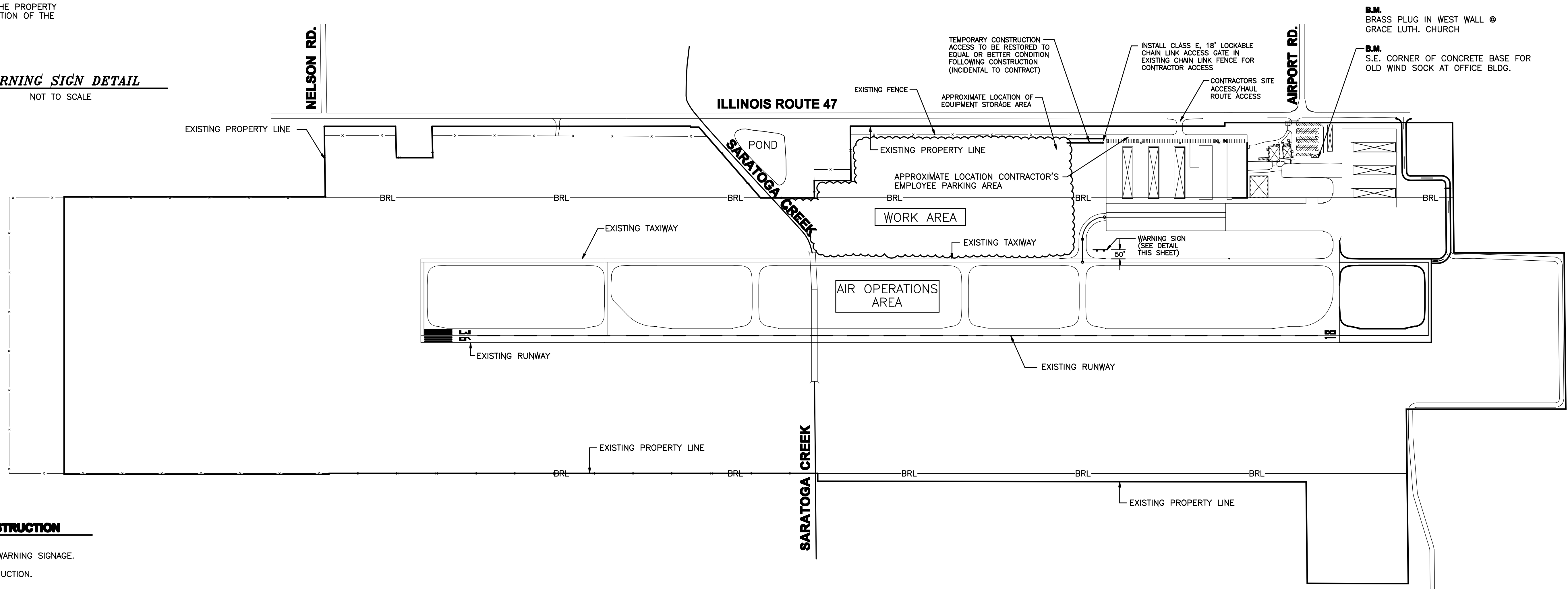

SEQUENCE OF CONSTRUCTION

1. PUT UP CONSTRUCTION WARNING SIGNAGE.
2. STAKE LIMITS OF CONSTRUCTION.
3. INSTALL CLASS E, 18' LOCKABLE CHAIN LINK ACCESS GATE IN EXISTING CHAIN LINK FENCE.
4. CONSTRUCT STORMWATER CONTROLS IN ACCORDANCE WITH EROSION CONTROL PLAN.
5. NOTIFY AIRPORT MANAGER, JEFF VOGEN, WHENEVER CONSTRUCTION ACTIVITY WILL OCCUR WITHIN 50 FEET OF TAXIWAY.
6. STRIP TOPSOIL AND PLACE IN TEMPORARY TOPSOIL STOCKPILE.
7. CONSTRUCT EMBANKMENT AND PERFORM EXCAVATION TO THE LINES AND GRADES OF THE PLANS MAKING ALLOWANCE FOR 6" TOPSOIL RESPREAD.
8. CONSTRUCT STORM DRAINAGE AND RIP-RAP AT OUTFALL.
9. RESPREAD TOPSOIL AT 6" MINIMUM.
10. APPLY FERTILIZER, SEEDING, MULCHING AND EROSION CONTROL BLANKET.
11. INSTALL TEMPORARY DITCH CHECKS.
12. RESTORE TEMPORARY CONSTRUCTION ACCESS ROUTE AREA.
13. CLEAN PREMISES.
14. REMOVE CONSTRUCTION WARNING SIGN AND NOTIFY AIRPORT MANAGER, JEFF VOGEN.
15. REMOVE TEMPORARY EROSION CONTROL MEASURES ONCE GRASS IS ESTABLISHED.

GENERAL NOTES AND SCOPE OF WORK

- 1.) SCOPE OF WORK: THIS PROJECT CONSISTS OF REGRADING APPROXIMATELY 20 ACRES SOUTH OF THE EXISTING HANGARS AND WEST OF THE EXISTING TAXIWAY, INCLUDING ALL NECESSARY EARTHWORK, GRADING, DRAINAGE, EROSION CONTROL AND FENCING.
- 2.) THE MAXIMUM ANTICIPATED CONSTRUCTION EQUIPMENT HEIGHT IS 30'-0".
- 3.) THE CONTRACTOR SHALL USE THE DESIGNATED ACCESS ROAD AS SHOWN ON THIS SHEET. THE CONTRACTOR SHALL MAINTAIN THE PROPOSED ACCESS ROAD THROUGHOUT THE COURSE OF THE PROJECT. AT THE CONCLUSION OF THE PROJECT ANY AREAS DAMAGED OUTSIDE THE AREAS SHOWN FOR CONSTRUCTION SHALL BE REPAIRED BY THE CONTRACTOR AT HIS OWN EXPENSE. RESTORATION OF THE ACCESS ROAD WILL BE CONSIDERED INCIDENTAL TO THE PROJECT.
- 4.) THE CONTRACTOR SHALL INVESTIGATE EXISTING DRAINAGE PIPES AND FIELD TILES TO DETERMINE THEIR EXTENT. ALL FIELD TILES AND DRAIN PIPES SHALL BE EXTENDED, REROUTED, OR MAINTAINED TO PROVIDE CONTINUOUS UNOBSTRUCTED DRAINAGE.
- 5.) PUMPING GROUND WATER AND/OR STORM WATER FROM THE WORK AREA IS CONSIDERED INCIDENTAL TO THE PROJECT.
- 6.) DUE TO THE CLOSE PROXIMITY TO AIRCRAFT OPERATIONS, THE CONTRACTOR IS REQUIRED TO STRICTLY ADHERE TO THE GUIDELINES REGARDING CONSTRUCTION SAFETY AS SET FORTH IN FAA ADVISORY CIRCULAR 150/5370-2E

LEGEND



SAFETY PLAN NOTES

- 1.) THE SEQUENCE OF CONSTRUCTION SHOWN ON THIS SHEET IS INTENDED TO ALLOW ORDERLY AND SAFE CONSTRUCTION, AND TO AVOID LENGTHY TAXIWAY CLOSINGS.
- 2.) BARRICADES SHALL BE PLACED AND MAINTAINED AS SHOWN HEREIN, AS INDICATED IN THE SPECIAL PROVISIONS AND AS DIRECTED BY THE ENGINEER. PLACEMENT AND MAINTENANCE OF BARRICADES ARE INCIDENTAL TO CONTRACT.
- 3.) THE CONTRACTOR SHALL BE RESPONSIBLE FOR FURNISHING AND INSTALLING CLOSED TAXIWAY MARKERS AS SHOWN ON THIS SHEET AND AS DIRECTED BY THE AIRPORT MANAGER AND THE ENGINEER. MARKERS SHALL BE PLACED AND REMOVED WHEN SO DIRECTED BY THE OWNER THROUGH THE ENGINEER. THE OWNER SHALL BE RESPONSIBLE FOR NOTIFYING THE FLIGHT SERVICE STATION REGARDING RUNWAY CLOSURE.
- 4.) ALL BARRICADES, MARKINGS, LATHE, FLAGGING, AND TRAFFIC CONTROL ITEMS ARE INCIDENTAL TO THE CONTRACT.
- 5.) ALL IDOT TYPE III BARRICADES SHALL HAVE FOUR STANDARD SIZE SAND BAGS PER LEG.

POINT OF CONTACT

AIRPORT MANAGER:
JEFF VOGEN
MORRIS MUNICIPAL AIRPORT
9980 N. RTE. 47
MORRIS, IL 60450
(815) 942-1600

CHAMLIN & ASSOCIATES, INC. © 2009
Drawing Name: MR019 - 831 IMPROVEMENT PLANS BASE.dwg
Last Modified: Jul 03, 2012 - 10:41 am
Plotted on: Jul 24, 2012 - 9:31 am
by: rmp

DRAWN BY: RGP		REVISIONS	
LEVEL	BY	DATE	DESCRIPTION
1	RGP	6/19/12	AS PER IDA COMMENTS
CHECKED BY: RTS			
CREATED: 5/25/12			

CHAMLIN & ASSOCIATES
PERU MORRIS ILLINOIS

MORRIS MUNICIPAL AIRPORT
MORRIS, ILLINOIS

CONSTRUCTION SAFETY PLAN

APPROVED FOR CONSTRUCTION

CURRENT AS OF: 07/03/12	
SCALE: 1" = 300'	SHEET 2
FILE NO.: 13117	OF 4