

INDEX OF SHEETS

SHEET NO. DESCRIPTION

- 1 COVER SHEET
- 2 INDEX OF SHEETS, STANDARDS, AND GENERAL NOTES
- 3-4 SUMMARY OF QUANTITIES
- 5 TYPICAL SECTIONS PLANS
- 6 ALIGNMENT, TIES & BENCHMARKS PLAN
- 7-12 TRAFFIC CONTROL PLAN
- 13-18 PROPOSED ROADWAY PLAN AND PROFILE
- 19-22 PROPOSED DRAINAGE PLAN
- 23-24 PROPOSED EROSION CONTROL & LANDSCAPING PLAN
- 25-26 PROPOSED PAVEMENT MARKING PLAN
- 27 TRAFFIC CONTROL DETAILS FOR FREEWAY SINGLE & MULTI-LANE WEAVE (TC-09)
- 28-29 MULTI-LANE FREEWAY PAVEMENT MARKING DETAILS (TC-12)
- 30 TRAFFIC CONTROL FOR FREEWAY SHOULDER CLOSURES AND PARTIAL RAMP CLOSURES (TC-17)
- 31 FREEWAY/ EXPRESSWAY SIGNING FOR FLAGGING OPERATIONS AT WORK ZONE OPENING (TC-18)
- 32-49 CROSS SECTION PLANS

STANDARD NO. DESCRIPTION

- 000001-06 STANDARD SYMBOLS, ABBREVIATIONS AND PATTERNS
- 280001-07 TEMPORARY EROSION CONTROL SYSTEMS
- 542301-03 PRECAST REINFORCED CONCRETE FLARED END SECTION
- 642001-02 SHOULDER RUMBLE STRIPS, 16 IN.
- 701400-09 APPROACH TO LANE CLOSURE FREEWAY/ EXPRESSWAY
- 701401-11 LANE CLOSURE, FREEWAY/ EXPRESSWAY
- ~~701406-11 LANE CLOSURE, FREEWAY / EXPRESSWAY, DAY OPERATION ONLY~~
- 701428-01 TRAFFIC CONTROL, SETUP AND REMOVAL, FREEWAY/ EXPRESSWAY
- 701901-07 TRAFFIC CONTROL DEVICES
- 704001-08 TEMPORARY CONCRETE BARRIER
- 782006 GUARDRAIL AND BARRIER WALL REFLECTOR MOUNTING DETAILS



GENERAL NOTES

1. BEFORE STARTING ANY EXCAVATION, THE CONTRACTOR SHALL CALL "JULIE" AT 800-892-0123 OR 811 FOR FIELD LOCATIONS OF BURIED ELECTRIC, TELEPHONE AND GAS FACILITIES. (48 HOUR NOTIFICATION IS REQUIRED).
2. THE CONTRACTOR SHALL COORDINATE CONSTRUCTION ACTIVITIES WITH UTILITY COMPANIES, WILMINGTON AND CHANNAHON TOWNSHIPS.
3. THE CONTRACTOR WILL NOT BE ALLOWED TO SET UP A YARD OR FIELD OFFICE ON STATE PROPERTY WITHOUT WRITTEN PERMISSION FROM THE DEPARTMENT.
4. THE RESIDENT ENGINEER SHALL CONTACT MRS. REGINA COOPER, IDOT'S AREA TRAFFIC FIELD ENGINEER, VIA EMAIL AT REGINA.COOPER@ILLINOIS.GOV OR AT (847) 705-4153 A MINIMUM OF 2 WEEKS PRIOR TO PLACEMENT OF PERMANENT PAVEMENT MARKING.
5. IT SHALL BE THE CONTRACTOR'S RESPONSIBILITY TO VERIFY ALL DIMENSIONS AND CONDITIONS EXISTING IN THE FIELD PRIOR TO CONSTRUCTION AND ORDERING OF MATERIALS.
6. THE CONTRACTOR SHALL CONTACT THE DISTRICT ONE EXPRESSWAY TRAFFIC CONTROL SUPERVISOR AT (847)705-4151 A MINIMUM OF 72 HOURS IN ADVANCE OF BEGINNING WORK.
7. THE CONTRACTOR SHALL BE REQUIRED TO PROVIDE ACCESS TO ABUTTING PROPERTY AT ALL TIMES DURING THE CONSTRUCTION OF THIS PROJECT.
8. PRIOR TO EMBANKMENT PLACEMENT, ALL VEGETATION, LOOSE MATERIAL, AND UNSTABLE MATERIAL SHOULD BE REMOVED TO DEPTH ENCOUNTERED AND REPLACED WITH SUITABLE EMBANKMENT MATERIAL. ANY EMBANKMENT WIDENING ON EXISTING SLOPES SHOULD BE BENCHED IN ACCORDANCE WITH ARTICLE 205.04 OF THE STANDARD SPECIFICATIONS FOR ROAD AND BRIDGE CONSTRUCTION.
9. SAW CUTTING OF PAVEMENT, SHOULDERS SHALL BE FULL DEPTH AND SHALL RESULT IN A CLEAN, STRAIGHT EDGE ON THE PORTION REMAINING. ALL SAW CUTTING SHALL BE CONSIDERED AS PART OF THE ITEM BEING REMOVED.
10. THE DEPARTMENT HAS NOT OBTAINED ANY PERMITS FOR OFFSITE BORROW, WASTE, USE (BWU) AREAS. PRIOR TO WORKING IN BWU AREAS, IF THE CONTRACTOR CHOOSES TO USE ACTIVITIES REQUIRING PERMITS IT IS THE CONTRACTOR'S RESPONSIBILITY TO SECURE THE PROPER PERMITS. IN ADDITION TO THE BORROW REVIEW (BDE 2289) AND USE/WASTE REVIEW(BDE 2290) SUBMITTALS, THE CONTRACTOR SHALL SUBMIT AN EROSION AND SEDIMENT CONTROL (ESC) PLAN FOR EVERY BWU SITE TO THE DEPARTMENT FOR ACCEPTANCE. GUIDELINES FOR ACCEPTABLE BWU PRACTICES CAN BE FOUND IN SECTION II.G.1 AND 2 OF THE SWPPP. THE COST OF ALL MATERIALS AND LABOR NECESSARY TO COMPLY WITH THE ABOVE PROVISIONS TO PREPARE AND IMPLEMENT ESC PLANS WILL NOT BE PAID FOR SEPARATELY, BUT SHALL BE CONSIDERED AS INCLUDED IN THE UNIT BID PRICES OF THE CONTRACT AND NO ADDITIONAL COMPENSATION WILL BE ALLOWED.

EROSION CONTROL NOTES

1. ALL ESC MEASURES WILL BE MAINTAINED IN ACCORDANCE WITH THE IDOT EROSION AND SEDIMENT CONTROL FIELD GUIDE FOR CONSTRUCTION INSPECTION AND IDOT'S BEST MANAGEMENT PRACTICES - MAINTENANCE GUIDE: (HTTP://WWW.IDOT.ILLINOIS.GOV/TRANSPORTATION-SYSTEM/ENVIRONMENT/EROSION-AND-SEDIMENT-CONTROL).
2. THE CONTRACTOR WILL ASSUME RESPONSIBILITY FOR MAINTENANCE OF ALL SOIL EROSION CONTROL DURING CONSTRUCTION.
3. THE CONTRACTOR SHALL CHECK ALL ESC MEASURES WEEKLY AND AFTER EACH RAINFALL, 0.5 INCHES OR GREATER IN A 24-HOUR PERIOD, OR EQUIVALENT SNOWFALL. ADDITIONALLY, DURING WINTER MONTHS, ALL MEASURES SHOULD BE CHECKED BY THE CONTRACTOR AFTER EACH SIGNIFICANT SNOWMELT.
4. THE CONTRACTOR SHOULD PROVIDE TO THE RE A PLAN TO ENSURE THAT A STABILIZED FLOW LINE WILL BE PROVIDED DURING STORM SEWER CONSTRUCTION. THE USE OF A STABILIZED FLOW LINE BETWEEN INSTALLED STORM SEWER AND OPEN DISTURBANCE WILL REDUCE THE POTENTIAL FOR THE OFFSITE DISCHARGE OF SEDIMENT-BEARING WATERS, ESPECIALLY WHEN RAIN IS FORECASTED, SO THAT FLOW WILL NOT ERODE. LACK OF APPROVED PLAN OR FAILURE TO COMPLY WILL RESULT IN AN ESC DEFICIENCY DEDUCTION.
5. ANY LOOSE MATERIAL DEPOSITED IN THE FLOW LINE OF DRAINAGE STRUCTURES, WHICH OBSTRUCTS THE NATURAL FLOW OF WATER, SHALL BE REMOVED AT THE CLOSE OF EACH WORKING DAY. PRIOR TO ACCEPTANCE OF THE IMPROVEMENT, ALL DRAINAGE STRUCTURES SHALL BE FREE OF DIRT AND DEBRIS. THIS WORK WILL NOT BE PAID FOR SEPARATELY BUT SHALL BE CONSIDERED AS INCIDENTAL.
6. TEMPORARY OR PERMANENT STABILIZATION SHALL BE INITIATED IMMEDIATELY UPON COMPLETION OF DISTURBANCE OR IF THE WORK AREA IS TO BE LEFT UNDISTURBED FOR 14 DAYS OR MORE.
7. UNDER NO CIRCUMSTANCES SHALL THE CONTRACTOR PROLONG FINAL GRADING AND SHAPING SO THAT THE ENTIRE PROJECT CAN BE PERMANENTLY SEEDED AT ONE TIME.
8. EROSION CONTROL ITEMS ARE CONSIDERED TO BE A HIGH PRIORITY ON THIS CONTRACT. THE CONTRACTOR IS RESPONSIBLE FOR INSTALLATION OF ANY ADDITIONAL EROSION CONTROL MEASURES NECESSARY TO PREVENT EROSION AND SEDIMENTATION AS DETERMINED BY THE RE.
9. "WETLANDS NO INTRUSION" SIGNAGE SHOULD ALSO BE PROVIDED AT THE BOUNDARY OF ALL UN-IMPACTED WETLANDS AND/OR WOUS. THE CONTRACTOR CAN BORROW THE SIGNS FROM THE BUREAU OF MAINTENANCE. INCLUDE TEMPORARY FENCING AND WETLAND SIGNAGE WITHIN THE EROSION AND SEDIMENT CONTROL STRATEGY.



REV. 7-23-2018

MODEL: Default FILE NAME: P:\1108\BAREID\NTEC_illinois.gov\PIWDOT\Documents\IDOT_Offices\District_1\Projects\130618\CADD\Design\130618-ah-gemore.dgn

USER NAME = pyzranowski	DESIGNED -	REVISED -
	DRAWN -	REVISED -
PLOT SCALE = 100.0000' / in.	CHECKED -	REVISED -
PLOT DATE = 7/17/2018	DATE -	REVISED -

**STATE OF ILLINOIS
DEPARTMENT OF TRANSPORTATION**

**INDEX OF SHEETS, STANDARDS AND
GENERAL NOTES**

SCALE: SHEET OF SHEETS STA. TO STA.

F.A.I. RTE.	SECTION	COUNTY	TOTAL SHEETS	SHEET NO.
55	87-MED-1	WILL	49	2
CONTRACT NO. 62G46				
ILLINOIS FED. AID PROJECT				

SUMMARY OF QUANTITIES			CONSTRUCTION TYPE CODE 0044					SUMMARY OF QUANTITIES			CONSTRUCTION TYPE CODE 0044						
CODE NO	ITEM	UNIT	URBAN TOTAL QUANTITIES	0044 90% FED 10% STATE					CODE NO	ITEM	UNIT	URBAN TOTAL QUANTITIES	0044 90% FED 10% STATE				
20200100	EARTH EXCAVATION	CU YD	3435	3435					63200400	CABLE ROAD GUARD REMOVAL	FOOT	3190	3190				
* 20201200	REMOVAL AND DISPOSAL OF UNSUITABLE MATERIAL	CU YD	2562	2562					64200116	SHOULDER RUMBLE STRIPS, 16 INCH	FOOT	9603	9603				
21001000	GEOTECHNICAL FABRIC FOR GROUND STABILIZATION	CU YD	2562	2562					64300450	IMPACT ATTENUATORS (NON-REDIRECTIVE), TEST LEVEL 3	EACH	4	4				
21101505	TOPSOIL EXCAVATION AND PLACEMENT	CU YD	3162	3162					64401300	HIGH TENSION CABLE MEDIAN BARRIER TERMINALS	EACH	4	4				
25000210	SEEDING, CLASS 2A	ACRE	0.75	0.75					67100100	MOBILIZATION	L SUM	1	1				
25100630	EROSION CONTROL BLANKET	SQ YD	3560	3560					70200100	NIGHTTIME WORK ZONE LIGHTING	L SUM	1	1				
28000500	INLET AND PIPE PROTECTION	EACH	2	2					70300904	PAVEMENT MARKING TAPE, TYPE IV 4"	FOOT	19198	19198				
30300001	AGGREGATE SUBGRADE IMPROVEMENT	CU YD	1370	1370					70300905	PAVEMENT MARKING TAPE, TYPE IV 5"	FOOT	2400	2400				
30300112	AGGREGATE SUBGRADE IMPROVEMENT 12"	SO YD	13706	13706					70400100	TEMPORARY CONCRETE BARRIER	FOOT	7362.5	7362.5				
35501328	HOT-MIX ASPHALT BASE COURSE, 11"	SO YD	13706	13706					70400200	RELOCATE TEMPORARY CONCRETE BARRIER	FOOT	1625	1625				
40600290	BITUMINOUS MATERIALS (TACK COAT)	POUND	6168	6168					70600250	IMPACT ATTENUATORS, TEMPORARY (NON-REDIRECTIVE), TEST LEVEL 3	EACH	4	4				
40603340	HOT-MIX ASPHALT SURFACE COURSE, MIX "D", N70	TON	1540	1540					* 78008210	POLYUREA PAVEMENT MARKING TYPE I - LINE 4"	FOOT	19198	19198				
44004250	PAVED SHOULDER REMOVAL	SO YD	2913	2913					* 78008220	POLYUREA PAVEMENT MARKING TYPE I - LINE 5"	FOOT	2400	2400				
54213663	PRECAST REINFORCED CONCRETE FLARED END SECTIONS 18"	EACH	4	4					* 78100300	REPLACEMENT REFLECTOR	EACH	60	60				
550A0380	STORM SEWERS, CLASS A, TYPE 2 18"	FOOT	125	125					* 78200011	BARRIER WALL REFLECTORS, TYPE C	EACH	560	560				
									X0325201	SHOULDER RUMBLE STRIP REMOVAL	SO YD	1423	1423				



△ REV. 7-23-2018

FILE NAME =	USER NAME = mdy/ja	DESIGNED -	REVISED -	STATE OF ILLINOIS DEPARTMENT OF TRANSPORTATION	I-55 MEDIAN CROSSOVER SUMMARY OF QUANTITIES	F.A.I. RTE. =	SECTION	COUNTY	TOTAL SHEETS	SHEET NO.
pw:\NLOBAEBIDINT\EG\Illinois.gov\FWIDOT\Documents\DOCS\Offices\Districtal\NProjects\DI306IB\CADD\Design\DI306IB\BRAND.mxd	PLLOT SCALE = 100,0000' / 1in.	CHECKED -	REVISED -			55	87-MED-1	WILL	49	3
PLLOT DATE = 6/14/2018	DATE -	REVISED -	SCALE:			SHEET NO.	OF SHEETS	STA.	TO STA.	FED. ROAD DIST. NO. 1 ILLINOIS FED. AID PROJECT
						CONTRACT NO. 62G46				

* = SPECIALTY ITEM

SUMMARY OF QUANTITIES			CONSTRUCTION TYPE CODE 0044			
CODE NO	ITEM	UNIT	URBAN TOTAL QUANTITIES	0044 90% FED 10% STATE		
X0327980	PAVEMENT MARKING REMOVAL - WATER BLASTING	SO FT	5002	5002		
X7011015	TRAFFIC CONTROL AND PROTECTION (EXPRESSWAYS)	L SUM	1	1		
X7015005	CHANGEABLE MESSAGE SIGN	CAL DA	120	120		
X7030005	TEMPORARY PAVEMENT MARKING REMOVAL	SO FT	8996	8996		
Z0013798	CONSTRUCTION LAYOUT	L SUM	1	1		
Z0028415	GEOTECHNICAL REINFORCEMENT	SO YD	560	560		
* Z0054400	ROCK FILL	CU YD	235	235		
Z0065765	SLOTTED DRAIN 18" WITH VARIABLE SLOT	FOOT	1630	1630		
* 66900200	NON-SPECIAL WASTE DISPOSAL	CU YD	360	360		
* 66900450	SPECIAL WASTE PLANS AND REPORTS	L SUM	1	1		
* 66900530	SOIL DISPOSAL ANALYSIS	EACH	1	1		



SUMMARY OF QUANTITIES			CONSTRUCTION TYPE CODE			
CODE NO	ITEM	UNIT	TOTAL QUANTITIES			

* 66900200 NON-SPECIAL WASTE DISPOSAL CU YD 360 360

* 66900450 SPECIAL WASTE PLANS AND REPORTS L SUM 1 1

* 66900530 SOIL DISPOSAL ANALYSIS EACH 1 1

FILE NAME =	USER NAME = mlayja	DESIGNED -	REVISED -
p:\N\LOB\EBID\INTEG\Illinois.gov\PWIDOT\Documents\DOT	Offices\District N\Projects\DI306\B\CADD\Design\DI306	BY	REVISION
	PLOT SCALE = 100,000' / 1" =	CHECKED -	REVISED -
	PLOT DATE = 6/13/2018	DATE -	REVISED -

**STATE OF ILLINOIS
DEPARTMENT OF TRANSPORTATION**

**I-55 MEDIAN CROSSOVER
SUMMARY OF QUANTITIES**

SCALE: SHEET NO. OF SHEETS STA. TO STA.

F.A.I. RTE.	SECTION	COUNTY	TOTAL SHEETS	SHEET NO.
55	87-MED-1	WILL	49	4
CONTRACT NO. 62G46				
FED. ROAD DIST. NO. 1 ILLINOIS FED. AID PROJECT				

⚠ REV. 7-23-2018

*= SPECIALTY ITEM

LEGEND

- 1 TYPE III BARRICADE
- DRUM WITH STEADY BURN MONODIRECTIONAL LIGHT
- ▬ IMPACT ATTENUATORS, TEMPORARY (NON-REDIRECTIVE), TEST LEVEL 3
- ▬ TEMPORARY CONCRETE BARRIER

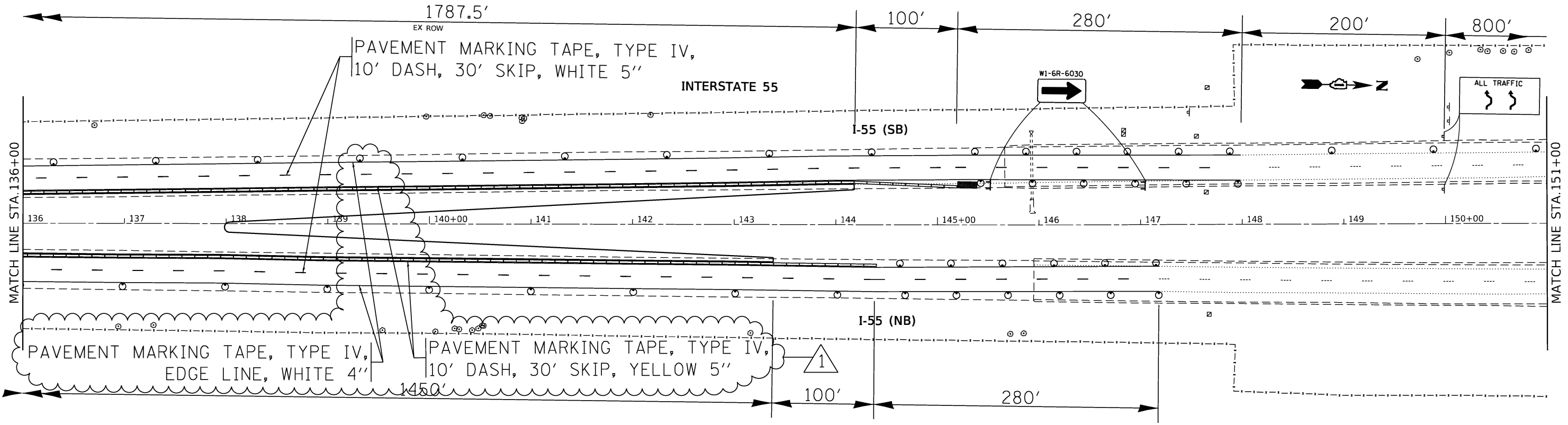
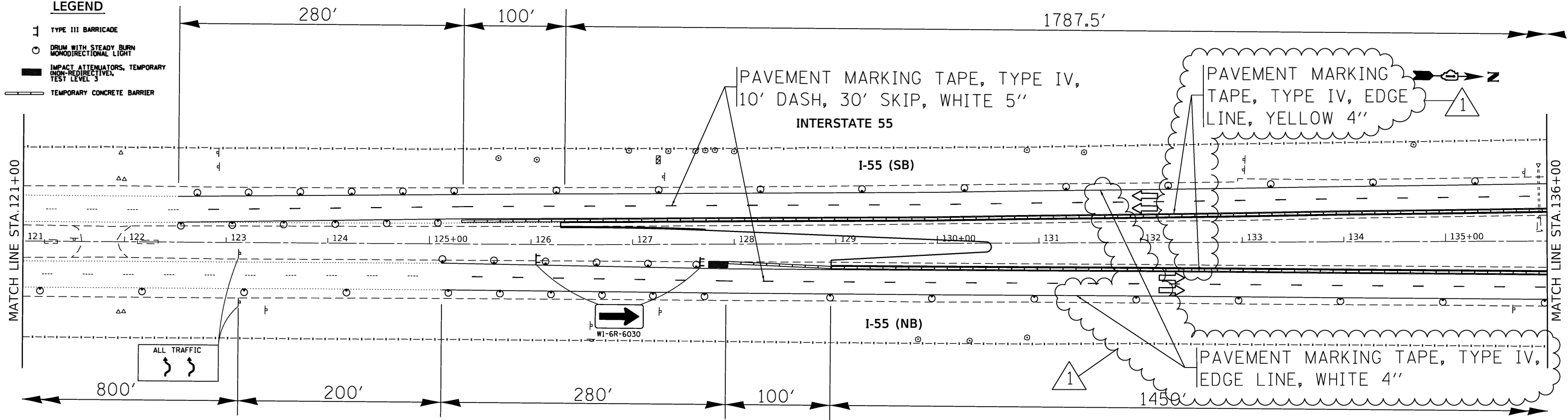

1 REV. 7-23-2018

MODEL: Default
 FILE NAME: P:\IULIB\BENIDITEC\Illinois.gov\PIWDOT\Documents\DOT_Offices\District_1\Projects\ID1306\BICAD\BICAD\Design\ID130618-ah-staging.dgn

USER NAME = pyzranowski	DESIGNED -	REVISED -
	DRAWN -	REVISED -
PLOT SCALE = 100.0000' / in.	CHECKED -	REVISED -
PLOT DATE = 7/12/2018	DATE -	REVISED -

**STATE OF ILLINOIS
DEPARTMENT OF TRANSPORTATION**

STAGING PLAN (NB CROSSOVER)			
I-55 OVER BNSF RR AND GRANT CREEK			
SCALE: 1" = 50'	SHEET	OF SHEETS	STA. TO STA.

F.A.I. RTE.	SECTION	COUNTY	TOTAL SHEETS	SHEET NO.
55	87-MED-1	WILL	49	9
CONTRACT NO. 62G46				
ILLINOIS FED. AID PROJECT				

LEGEND

- TYPE III BARRICADE
- DRUM WITH STEADY BURN MONODIRECTIONAL LIGHT
- IMPACT ATTENUATORS, TEMPORARY (NON-REDIRECTIVE), TEST LEVEL 3
- TEMPORARY CONCRETE BARRIER

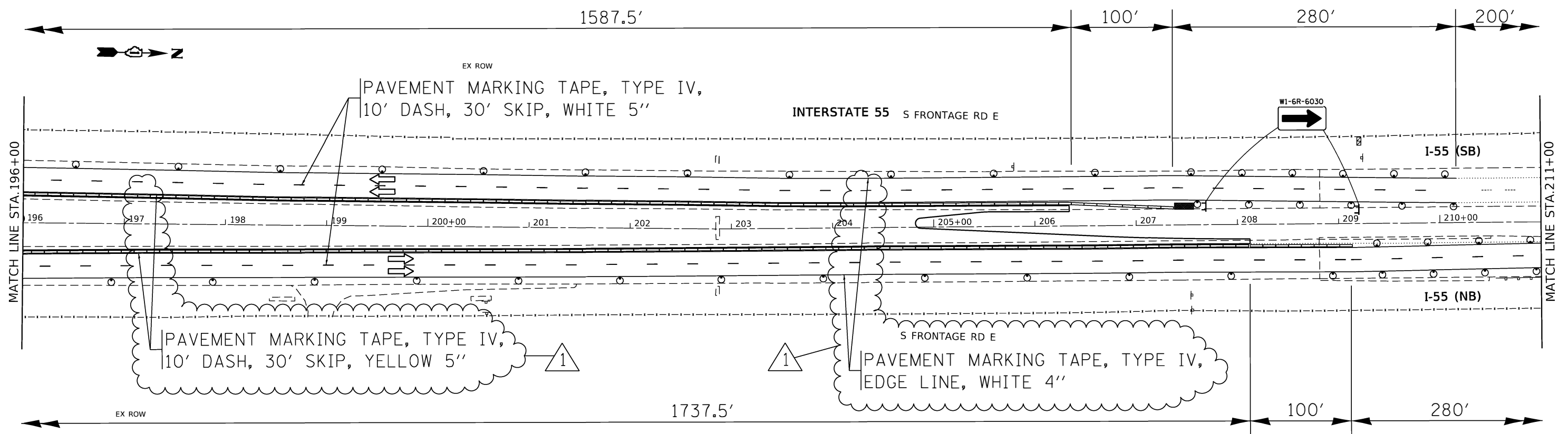
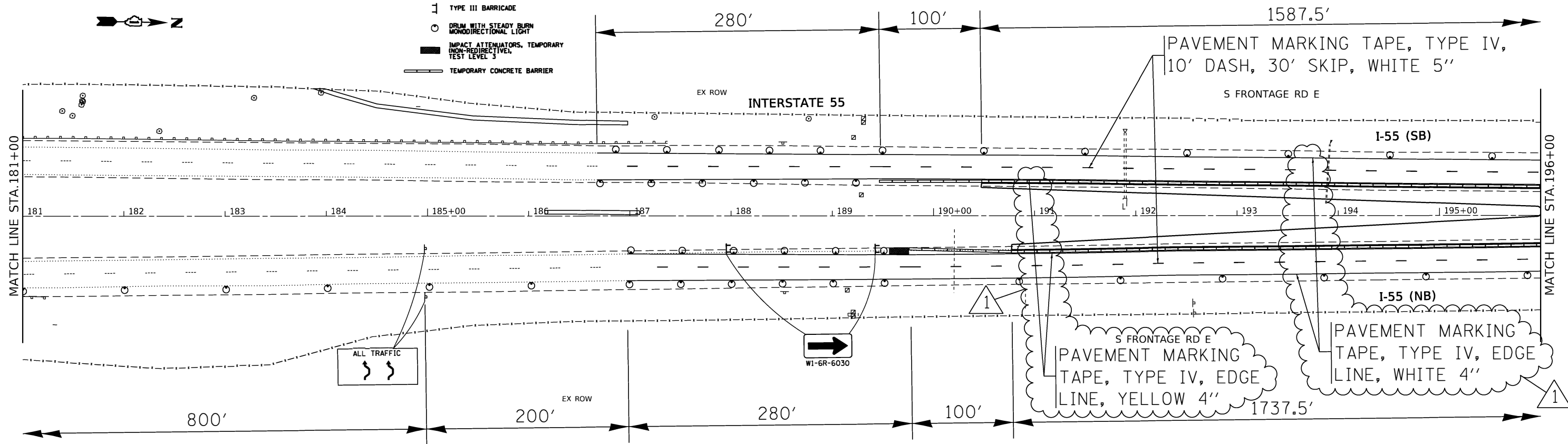

1 REV. 7-23-2018

MODEL: Default
FILE NAME: p:\u00484EBID\NTEC\Illinois.gov\RWIDOT\Documents\DOT Offices\District 3\Projects\1305\BICAD\BICAD.dwg
PROJECT: 1305 BICAD\BICAD.dwg
DATE: 7/12/2018

USER NAME = pyzranowskirb	DESIGNED -	REVISED -
DRAWN -	REVISOR -	REVISOR -
PLOT SCALE = 100.0000' / in.	CHECKED -	REVISOR -
PLOT DATE = 7/12/2018	DATE -	REVISOR -

**STATE OF ILLINOIS
DEPARTMENT OF TRANSPORTATION**

STAGING PLAN (NB CROSSOVER) I-55 OVER BNSF RR AND GRANT CREEK			
SCALE: 1" = 50'	SHEET	OF SHEETS	STA. TO STA.

F.A.I. RTE.	SECTION	COUNTY	TOTAL SHEETS	SHEET NO.
55	87-MED-1	WILL	49	11
CONTRACT NO. 62G46				
ILLINOIS FED. AID PROJECT				