

**State of Illinois**  
**Department of Natural Resources**  
**Office of Mines and Minerals**  
**Division of Abandoned Mined Lands**

Funded by the  
 United States Department of Interior  
 Federal Office of Surface Mining

**Williamson County Airport Remedial  
 Reclamation Project**  
**AML-GWmE-0514**  
**Williamson County**  
**1LR**



Williamson County Airport  
 Williamson County

**SCHEDULE OF DRAWINGS:**

1. Cover Sheet
2. Summary of Quantities / General Notes / Location Map
3. Site Information
4. Existing & Proposed Conditions - Western Ditch Check
5. Existing & Proposed Conditions - Eastern Ditch Check
6. Existing Conditions - Channel
7. Proposed Conditions - Channel
- 8.-10. Cross Sections
11. Details

Prepared By IDNR Staff

Approved for Bidding:

  
 Joe Angleton, Director  
 Office of Mines and Minerals

Approved By:

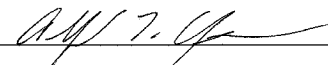
  
 Alfred L. Clayborne, Manager  
 AML Division

Approved By:

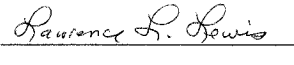
  
 Lawrence L. Lewis, P.E.  
 IL Licensed Professional Engineer  
 No. 0062-038880



**Summary of Quantities**

#	Item	Section	Quantity	Unit	Rates/Remarks
1	Earth Excavation	202	343	C.Y.	
2	Riprap Excavation	202	322	C.Y.	
3	Seeding	250	4.5	ACRE	
4	Nitrogen Fertilizer Nutrient	250	450	POUND	100 LB / ACRE
5	Phosphorus Fertilizer Nutrient	250	675	POUND	150 LB / ACRE
6	Potassium Fertilizer Nutrient	250	1,575	POUND	350 LB / ACRE
7	Agricultural Ground Limestone	250	22.5	TON	5 TON / ACRE
8	Mulch, Method 2, Procedure 2	IDOT 251	4.5	ACRE	2 TON / ACRE
9	Riprap Ditch Checks, A-4	280	2	EACH	
10	Pipe Culvert, Polyethylene, 12" Diameter	280	140	FOOT	
11	Stone Dumped Riprap, A-4	IDOT 281	149.0	TON	
12	Grout for use with Riprap	425	190.2	C.Y.	
13	Concrete Structures	503	20.1	C.Y.	
14	Reinforcement Bars, Epoxy Coated	508	1,521	POUND	
15	Precast Concrete Box Culverts	IDOT 540	6	FOOT	REPLACE EXISTING SECTION
16	Adjusting Water Service Lines	IDOT 563	100	FOOT	
17	Cofferdams	616	1	EACH	
18	Mobilization (Max. 6% of Bid)	671	1	L.S.	

**GENERAL NOTES**

Unless otherwise noted on the plans, all disturbed areas within the construction limits will be amended with agricultural ground limestone, fertilizer nutrients, seeded and mulched at the required rates specified in the plans.

The contractor is responsible for visiting the site and familiarizing himself with the existing conditions and the proposed reclamation work prior to submitting a bid.

The contractor shall provide and pay for all field engineering services to execute the project as specified in the Field Engineering section of the Special Provisions.

The contractor is responsible for locating and protecting all existing utility lines pertaining to the work.

Unless noted on the plans, all onsite access roads may be used for construction and must be maintained during construction. Access roads to the site as designated on the plans are to be maintained to the satisfaction of the engineer.

The construction limits will be staked by the contractor prior to construction. The contractor is responsible for the repair and or restitution at his own expense for all damages done to any area outside the construction limits.

Application rates specified in the plans are shown in the Summary of Quantities-Rates/Remarks column.

**CONSTRUCTION NOTES**

**BURIAL/REMOVAL OF MATERIAL**-Concrete and masonry debris designated for burial by the engineer shall be buried at least three foot below proposed final grade. Onsite organic debris and trash shall be disposed of in an engineer approved offsite landfill in accordance with Sections 201 and 501 of the Special Provisions.

**TREE REMOVAL**-Trees removed shall be disposed of onsite per Section 201 of the Special Provisions.

**ACID WATER TREATMENT**-Acid mine drainage treatment shall be in accordance with Section 614 of the Special Provisions.

**EROSION CONTROL**-The contractor shall schedule his operations and take such precautions that may be necessary to prevent or minimize erosion. Failure to comply with this requirement shall cause the contractor to be fully responsible for repairing any eroded areas and cleaning up areas or drainage structures that have become silted in or damaged.

**AGRICULTURAL GROUND LIMESTONE**-Immediately prior to seed bed preparation, fertilizer nutrients and agricultural ground limestone shall be uniformly spread at the rates specified in the plans.

**MULCHING**-Within 24 hours from the time seeding has been performed, the seeded area shall be given a covering of mulch at the rates specified in the plans. The mulch is to be anchored into the soil in accordance with the requirements for method 2, procedure 2 of Article 251.03 of the Standard Specifications. If Excelsior or Special Excelsior Blanket is to be used, the blanket shall be placed the same day that the areas are seeded.

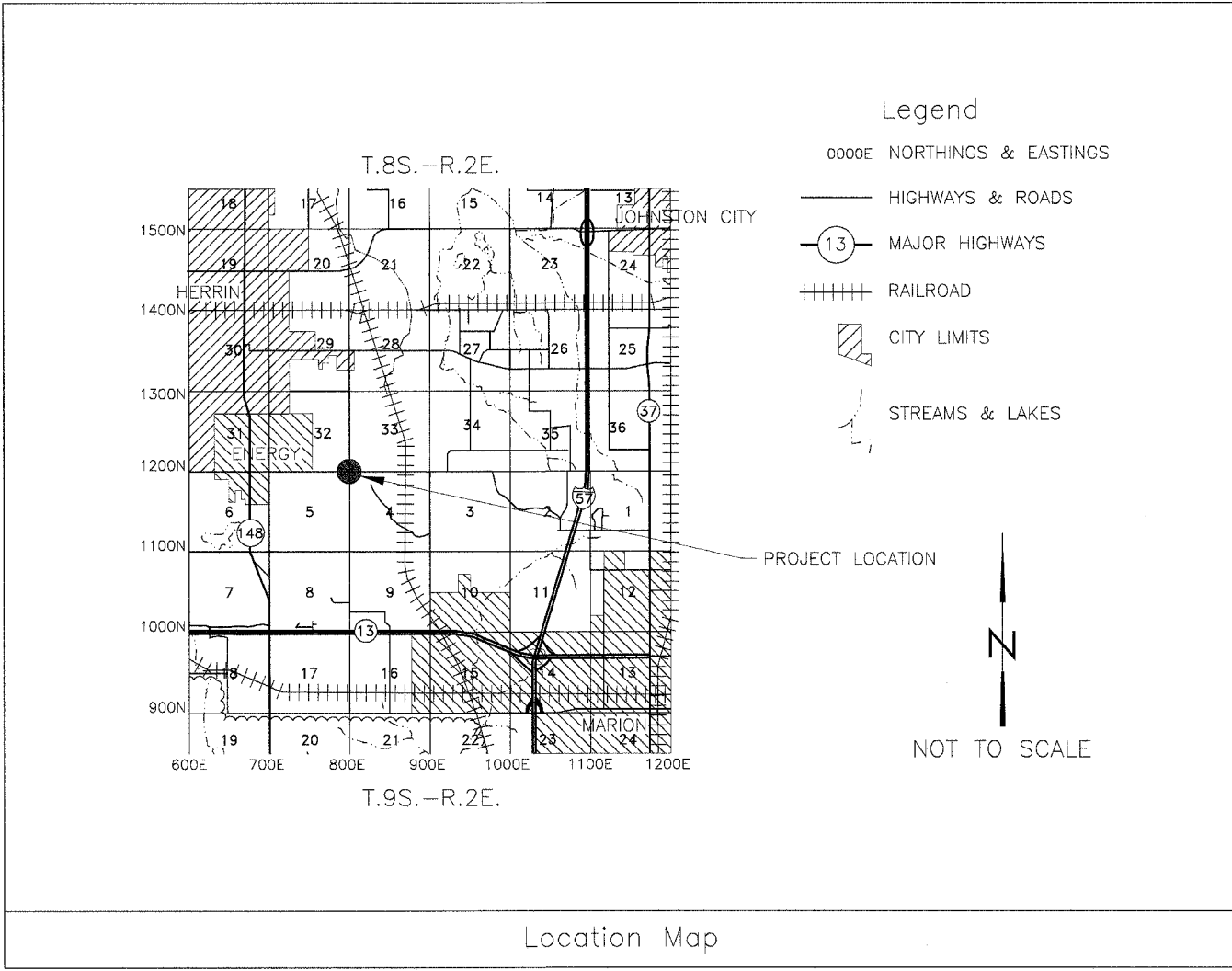

Schedule of Seeding, Fertilizer Nutrients and Mulch	
ITEM (unit)	FALL 2006 APPLICATION AUG 20 - OCT 15
SEEDING (acres)	4.5
NITROGEN FERTILIZER NUTRIENT (pounds)	450
PHOSPHORUS FERTILIZER NUTRIENT (pounds)	675
POTASSIUM FERTILIZER NUTRIENT (pounds)	1575
AGRICULTURAL GROUND LIMESTONE (tons)	22.5
MULCH, METHOD 2, PROCEDURE 2 (acres)	4.5



- ### Notes
1. CONTROL POINT INFORMATION, INCLUDING NORTHINGS, EASTINGS, ELEVATIONS AND DESCRIPTION, WILL BE PROVIDED TO THE CONTRACTOR BY AMLRD PRIOR TO THE PRE-CONSTRUCTION MEETING.
  2. ALL AREAS WITHIN THE CONSTRUCTION LIMITS ARE TO BE SEEDED EXCEPT THE UNVEGETATED ROAD LEADING TO THE WESTERN RIPRAP DITCH CHECK. SEEDING AND SOIL AMENDMENTS SHALL BE IN ACCORDANCE WITH SECTION 250 OF THE SPECIAL PROVISIONS.
  3. ALL WORK COMPLETED SOUTH OF CRENSHAW ROAD SHALL BE COORDINATED WITH THE WILLIAMSON REGIONAL AIRPORT AUTHORITY, WHICH WILL REQUIRE AND PROVIDE SAFETY FLAGGING FOR ALL CONSTRUCTION VEHICLES.
  4. THE PROPOSED COFFERDAM SHALL BE CONSTRUCTED AND REMOVED ACCORDING TO SECTION 616 OF THE SPECIAL PROVISIONS. THE WATER SURFACE ELEVATION ON THE UPSTREAM SIDE OF THE COFFERDAM SHALL BE MAINTAINED AT OR BELOW ELEVATION 443.0. EXISTING CULVERTS UNDER CRENSHAW ROAD MAY BE UTILIZED IF PUMPING IS REQUIRED.

### Legend

— 440 —	EXISTING CONTOUR
— — —	PROPOSED CONTOUR
~~~~~	TREE LINE
- - - - -	BASELINE FOR CROSS SECTION
- x - x -	EXISTING FENCE
- - - - -	CONSTRUCTION LIMITS
— OHE —	OVERHEAD ELECTRIC LINE
○	EXISTING UNDERGROUND UTILITY MARKER
◇	EXISTING POWER POLE

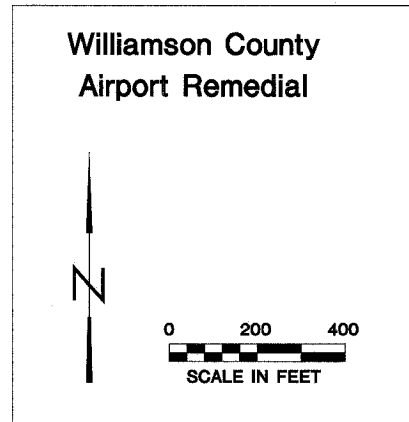

**State of Illinois  
Department of Natural Resources**

**Williamson County Airport  
Remedial Reclamation Project  
AML-GWmE-0514  
Williamson County**

Drawn By: JLU Date: 7/6/06  
Checked By: \_\_\_\_\_

**SITE INFORMATION**  
  
**Sheet 3 of 11**

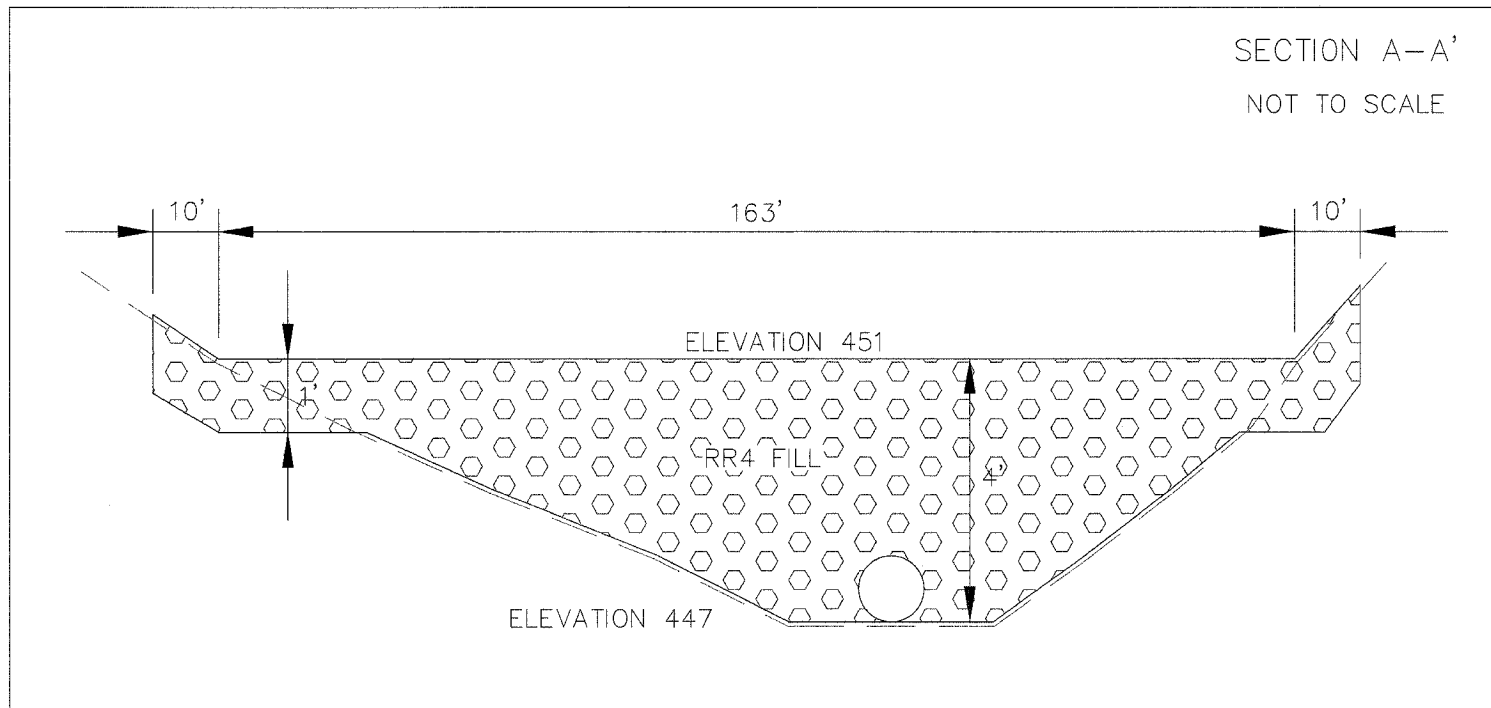
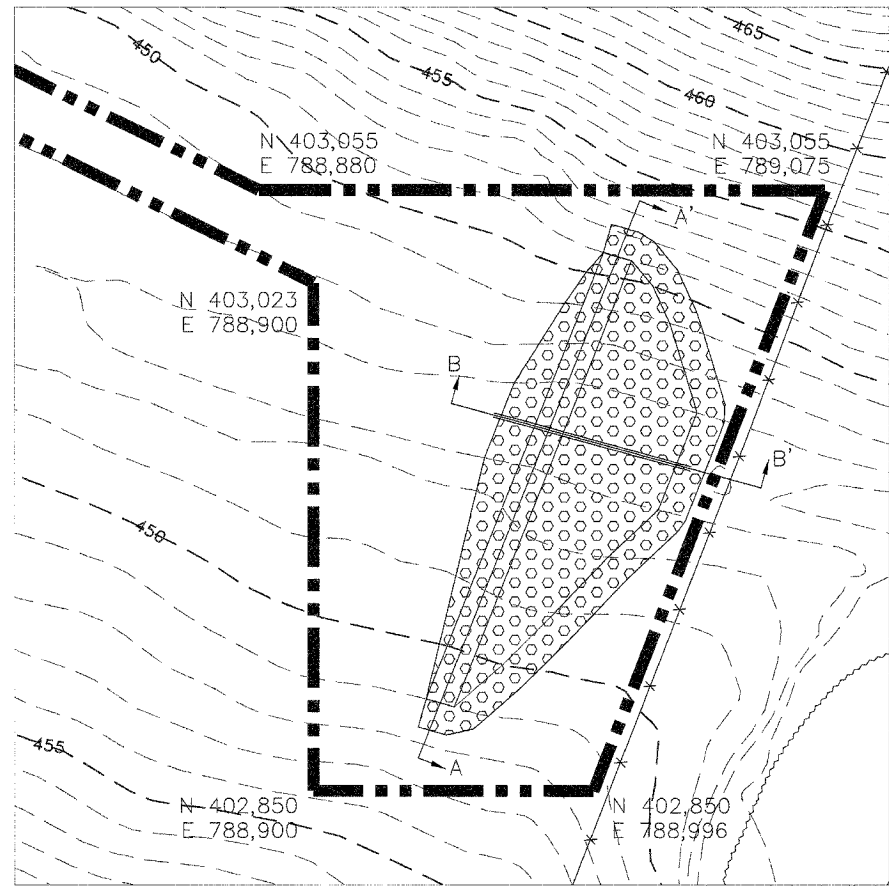

- Notes**
1. THE PROPOSED PIPE CULVERT, POLYETHYLENE, IS TO BE SET ON THE EXISTING GROUND AT THE APPROXIMATE ELEVATION OF 447.
  2. PER SECTION 280 OF THE SPECIAL PROVISIONS, THE RIPRAP DITCH CHECK SHALL BE CONSTRUCTED AS SHOWN IN THE PLANS AND APPROVED BY THE ENGINEER. THE ESTIMATED VOLUME OF RIPRAP, A-4, REQUIRED TO COMPLETE THIS WORK IS 768 TONS, BUT THE WORK WILL BE PAID FOR AS EACH.

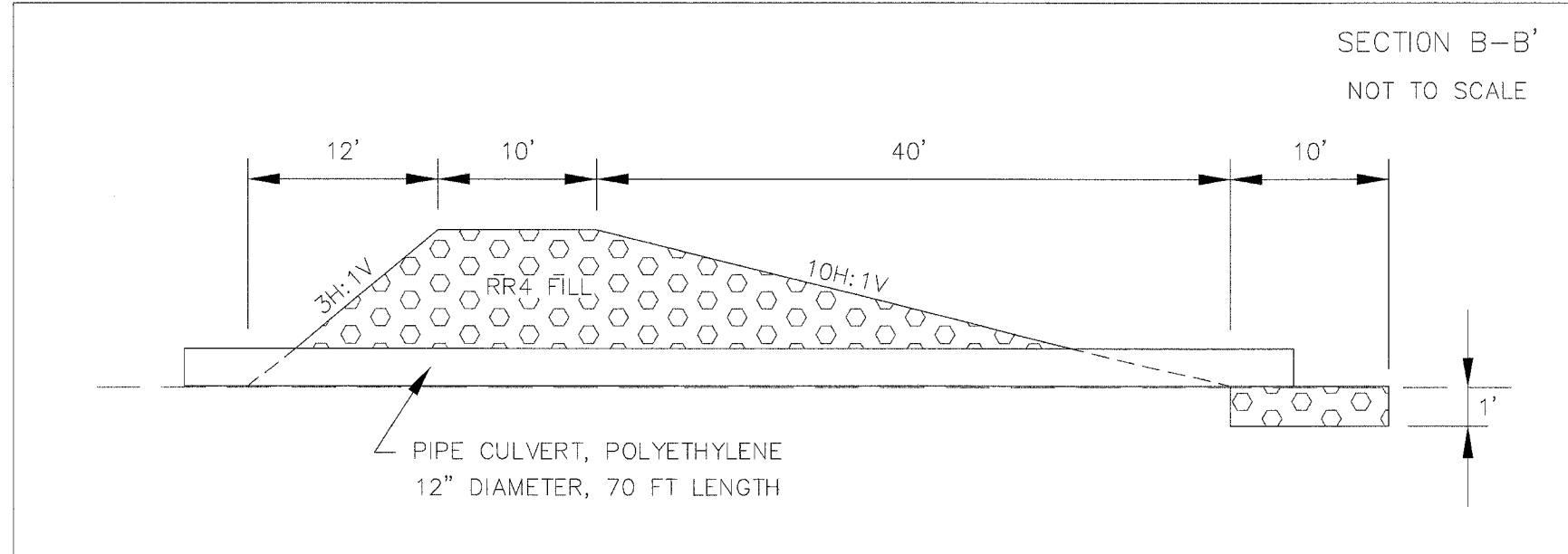

**Legend**

--- 440 ---	EXISTING CONTOUR
~~~~~	TREE LINE
-X-X-	EXISTING FENCE
-----	CONSTRUCTION LIMITS
○○○○○	PROPOSED RIPRAP

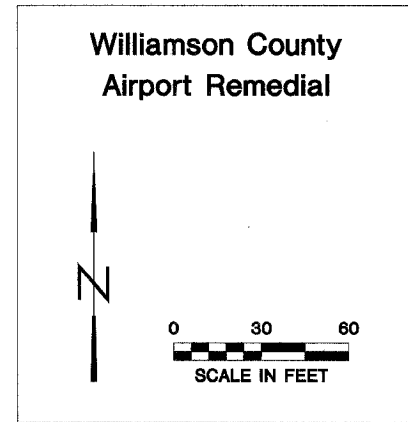

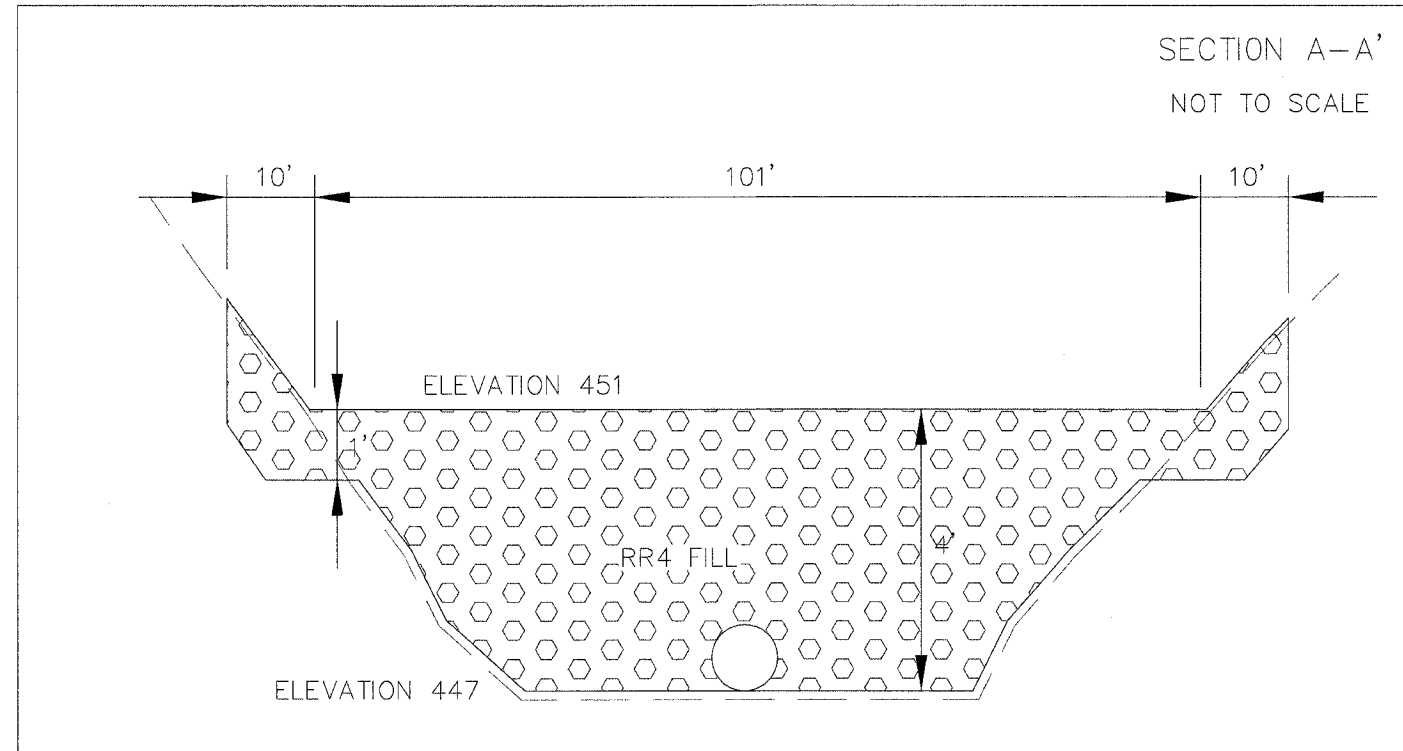
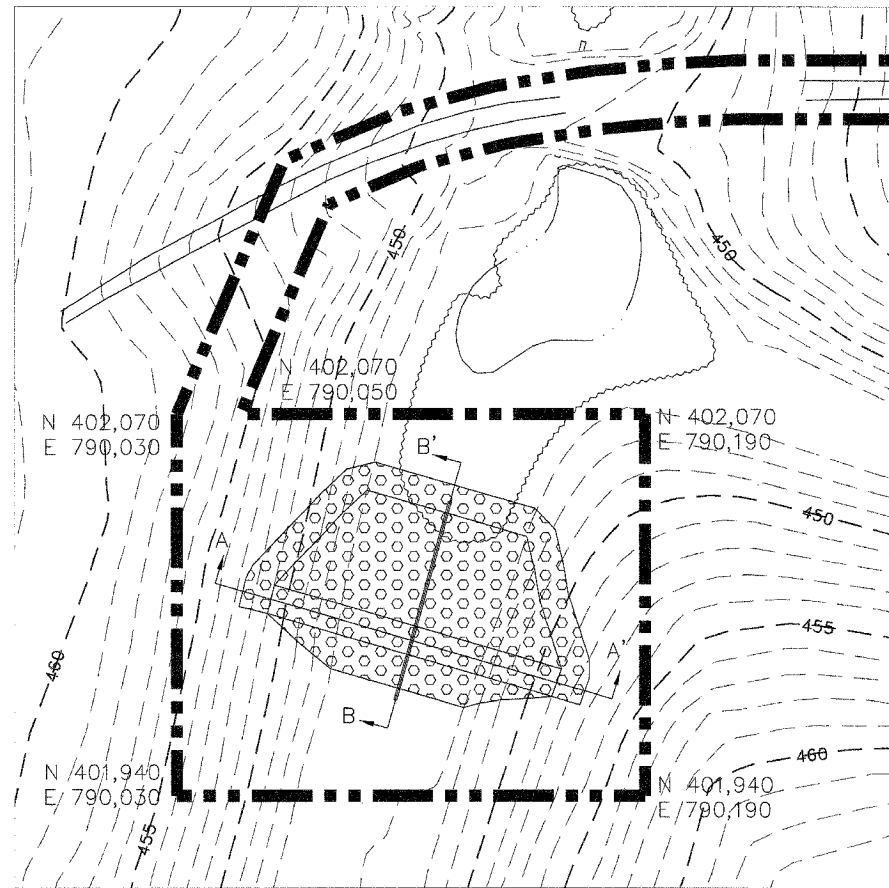

- Notes**
1. THE PROPOSED PIPE CULVERT, POLYETHYLENE, IS TO BE SET ON THE EXISTING GROUND AT THE APPROXIMATE ELEVATION OF 447.
  2. PER SECTION 280 OF THE SPECIAL PROVISIONS, THE RIPRAP DITCH CHECK SHALL BE CONSTRUCTED AS SHOWN IN THE PLANS AND APPROVED BY THE ENGINEER. THE ESTIMATED VOLUME OF RIPRAP, A-4, REQUIRED TO COMPLETE THIS WORK IS 624 TONS, BUT THE WORK WILL BE PAID FOR AS EACH.

	440	EXISTING CONTOUR
		TREE LINE
		EXISTING FENCE
		CONSTRUCTION LIMITS
		PROPOSED RIPRAP

**Legend**

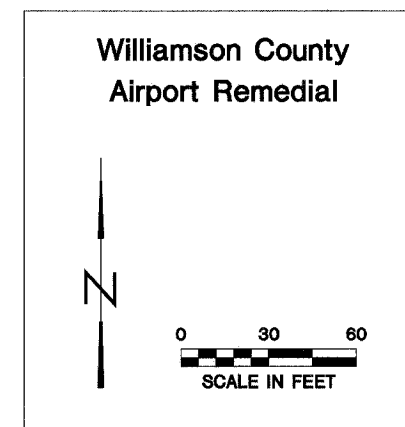
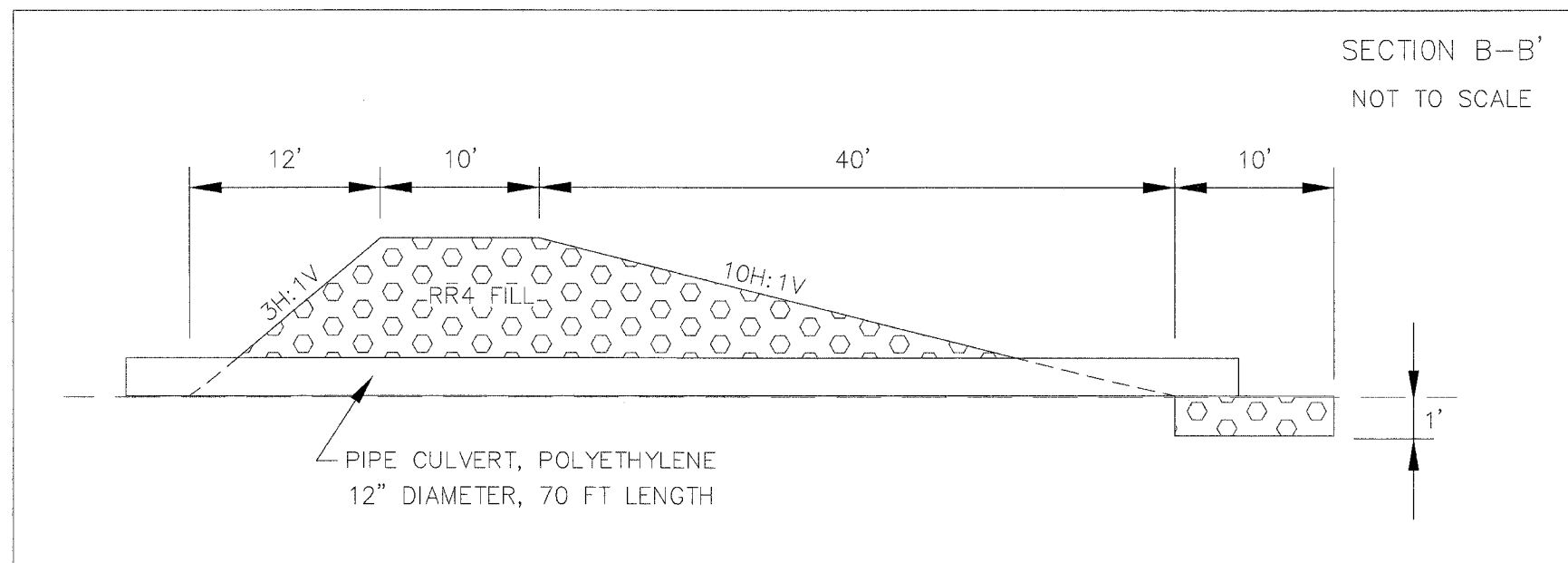

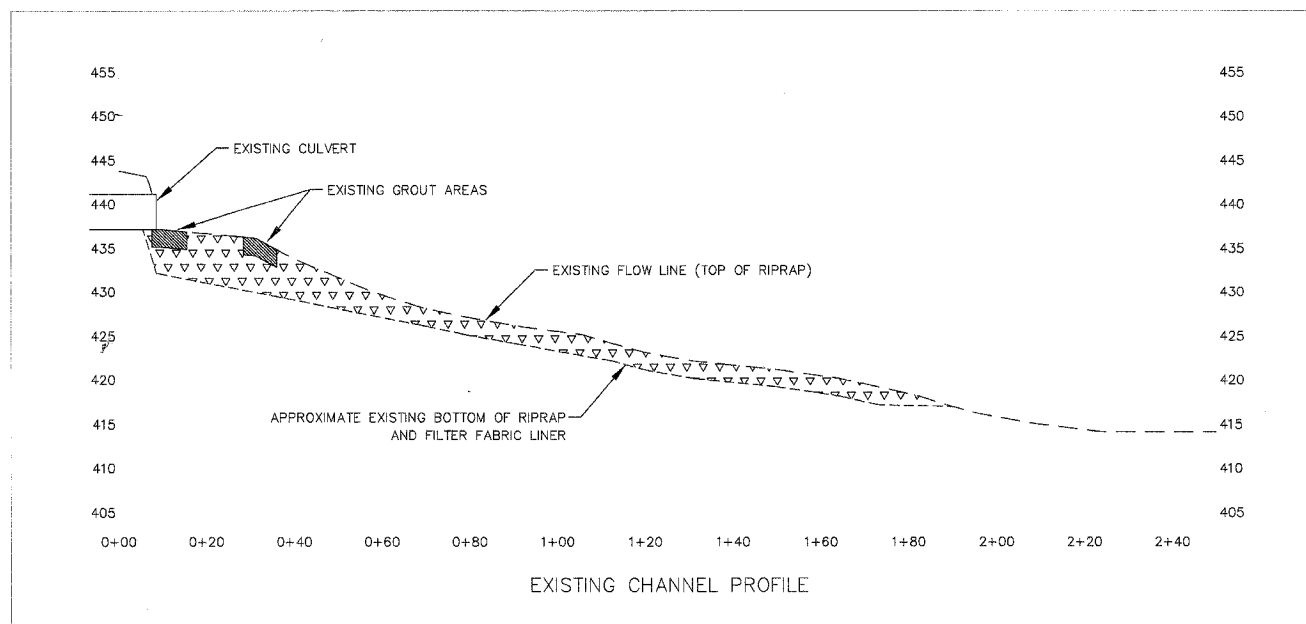
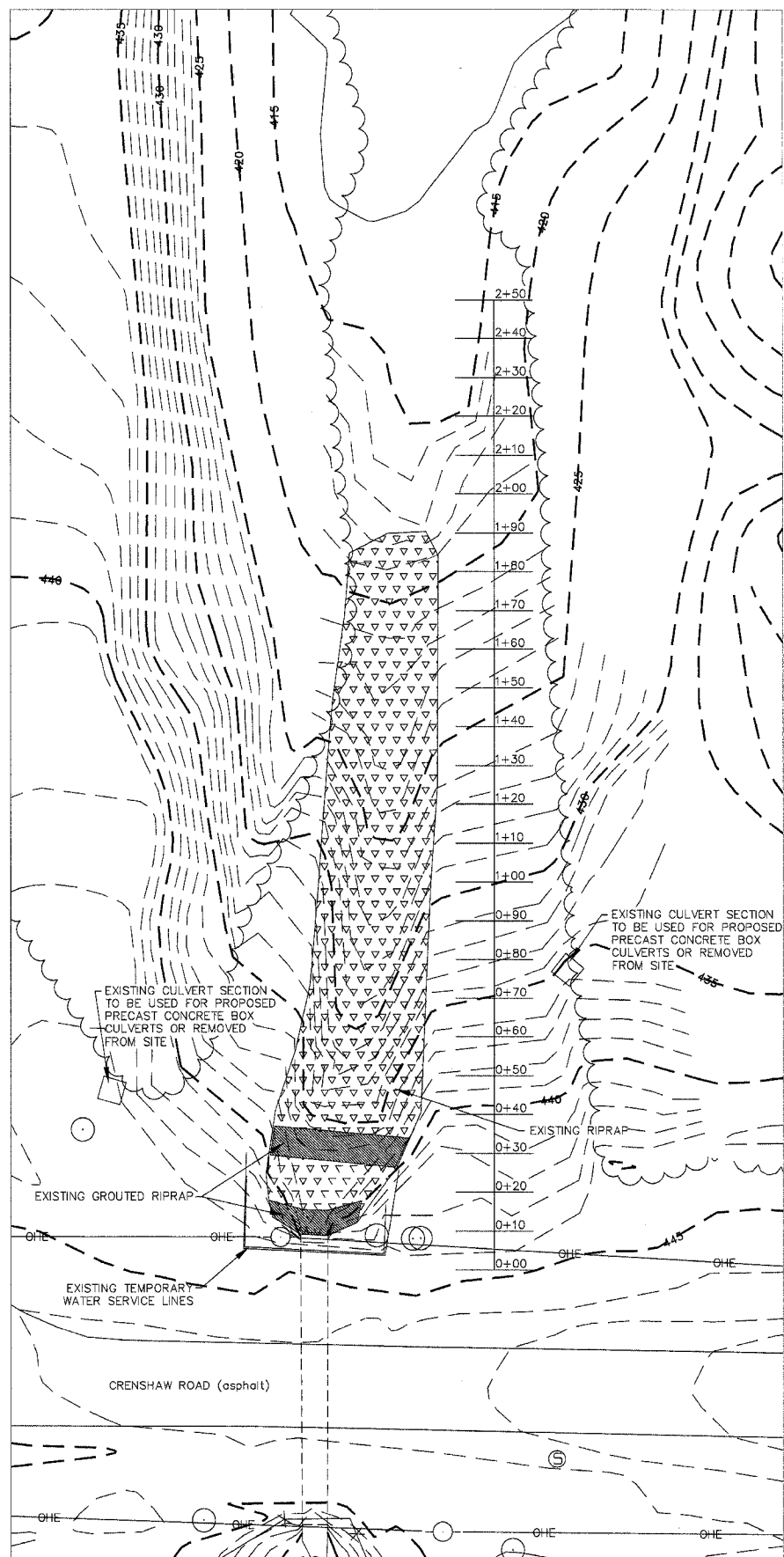

**Notes**

1. THE LOCATIONS OF THE EXISTING TEMPORARY WATER SERVICE LINES ARE TO BE ADJUSTED ACCORDING TO SECTION 563 OF THE STANDARD PROVISIONS.

	EXISTING CONTOUR
	TREE LINE
	BASELINE FOR CROSS SECTION
	WATER SERVICE LINE
	OVERHEAD ELECTRIC LINE
	EXISTING RIPRAP
	EXISTING GROUDED RIPRAP
	EXISTING UNDERGROUND UTILITY MARKER
	EXISTING POWER POLE

**Legend**

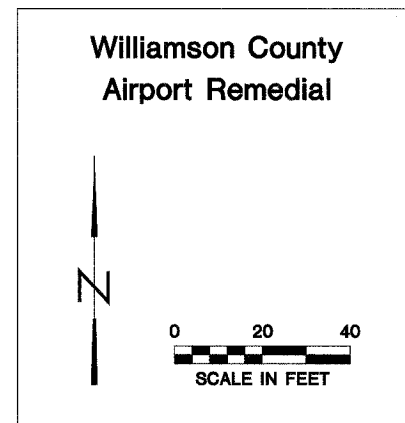

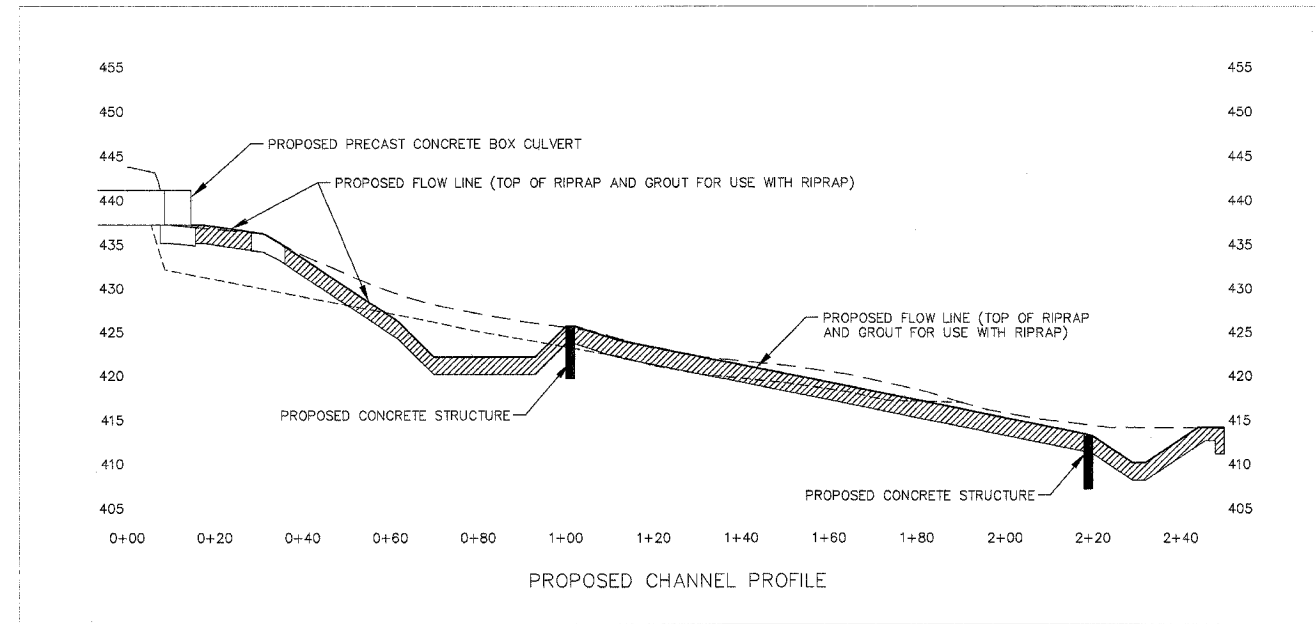
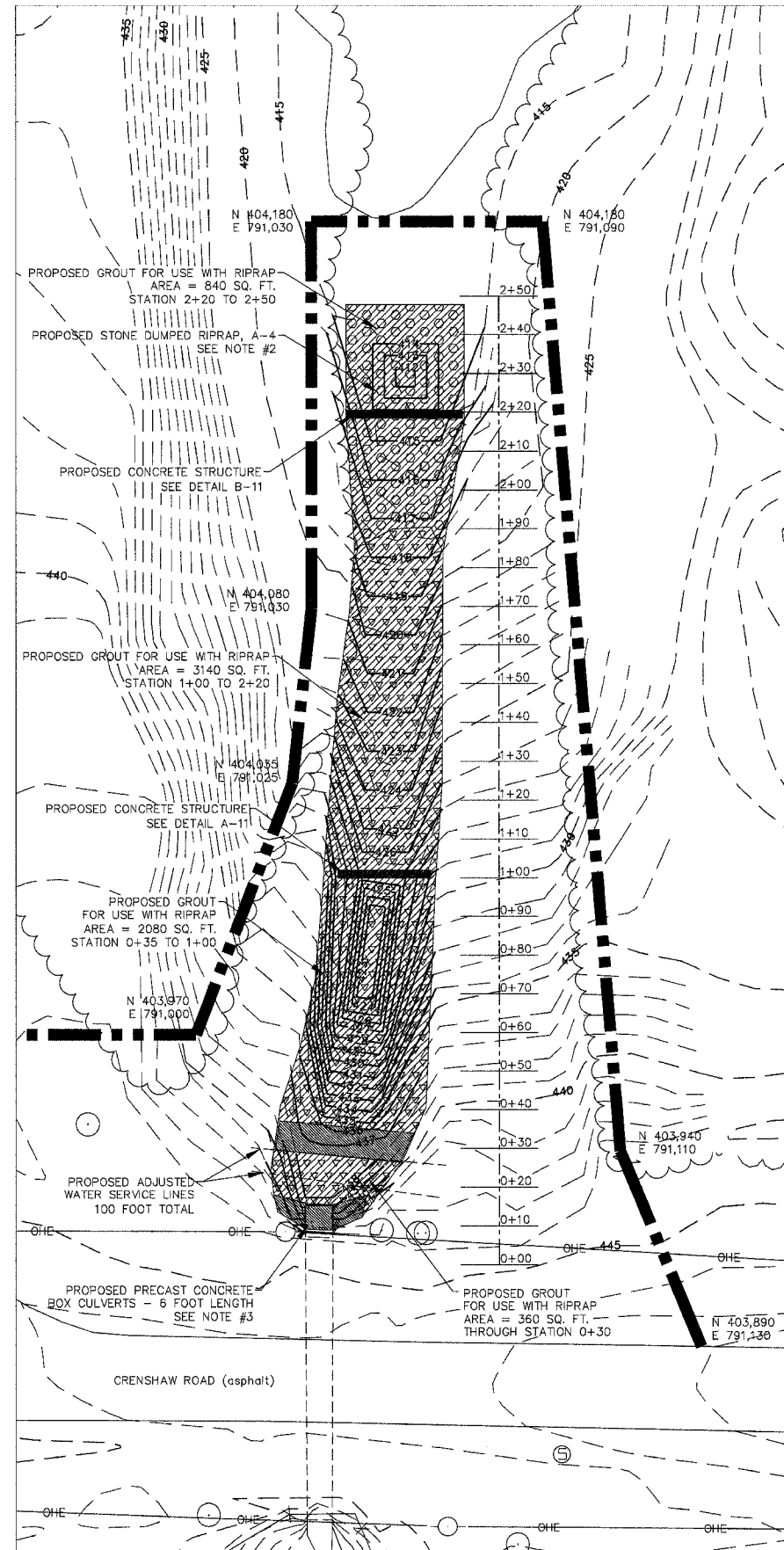

- ### Notes
- EXCAVATED EARTH MATERIAL SHALL BE GRADED AROUND THE PROPOSED PRECAST CONCRETE BOX CULVERT SECTION AND BLENDED INTO THE EXISTING GRADE ALONG THE EAST SIDE OF THE CHANNEL.
  - EXCAVATED RIPRAP MATERIAL SHALL BE STOCKPILED AND KEPT CLEAN TO BE USED AS RIPRAP FILL. AN ADDITIONAL 149.0 TONS OF STONE DUMPED RIPRAP, A-4, IS ALSO REQUIRED.
  - THE PRECAST CONCRETE BOX CULVERT SHALL BE CONSTRUCTED FROM ONE 6' SECTION ALREADY ON-SITE. THE SECTION SHALL BE PLACED AT THE SAME ELEVATION AS THE EXISTING OUTLET FLOWLINE. THE SUBGRADE PREPARATION AND JOINING METHOD SHALL MEET THE REQUIREMENTS OF SECTION 540 OF THE STANDARD PROVISIONS.

### Legend

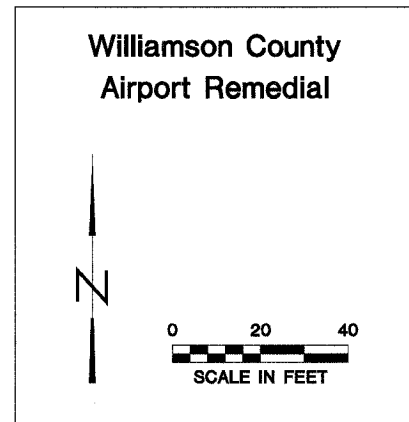

- 440 EXISTING CONTOUR
- 440 PROPOSED CONTOUR
- TREE LINE
- BASELINE FOR CROSS SECTION
- WATER SERVICE LINE
- OVERHEAD ELECTRIC LINE
- CONSTRUCTION LIMITS
- EXISTING RIPRAP
- PROPOSED RIPRAP
- EXISTING GROUTED RIPRAP
- PROPOSED GROUTED RIPRAP
- EXISTING UNDERGROUND UTILITY MARKER
- EXISTING POWER POLE



Drawn By: JLU Date: 7/6/06  
Checked By:

WILLIAMSON COUNTY AIRPORT  
 REMEDIAL RECLAMATION PROJECT  
 AML-GWmE-0514  
 WILLIAMSON COUNTY

LEGEND

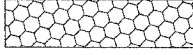
- EXISTING CONTOUR
- PROPOSED CONTOUR
- - - - - EXISTING BOTTOM OF RIPRAP
- PROPOSED BOTTOM OF RIPRAP
-  EARTH CUT (AREA IN SQ. FT.)
-  RIPRAP CUT (AREA IN SQ. FT.)
-  RIPRAP FILL (AREA IN SQ. FT.)

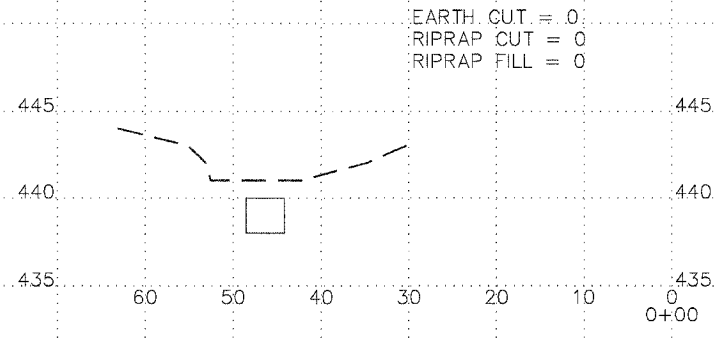
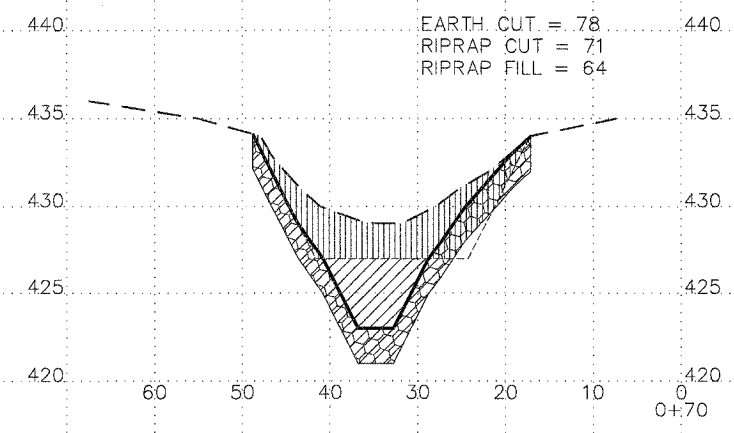
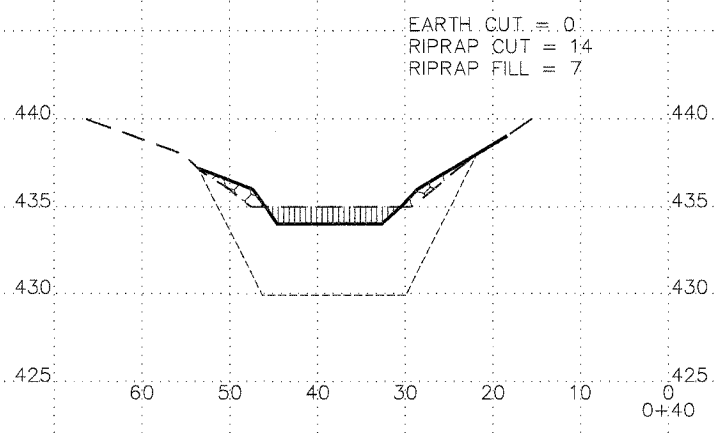
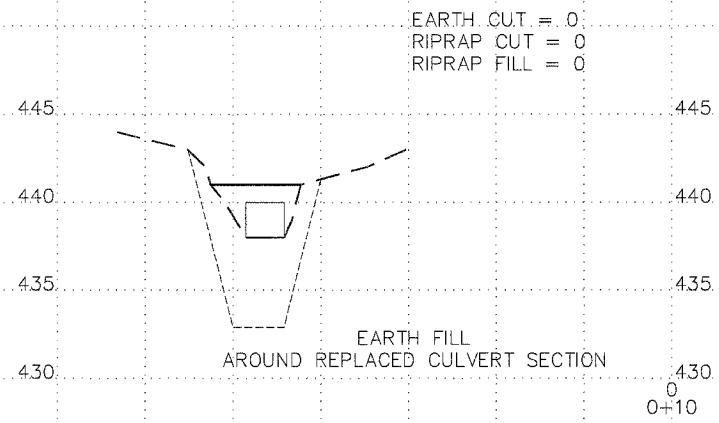
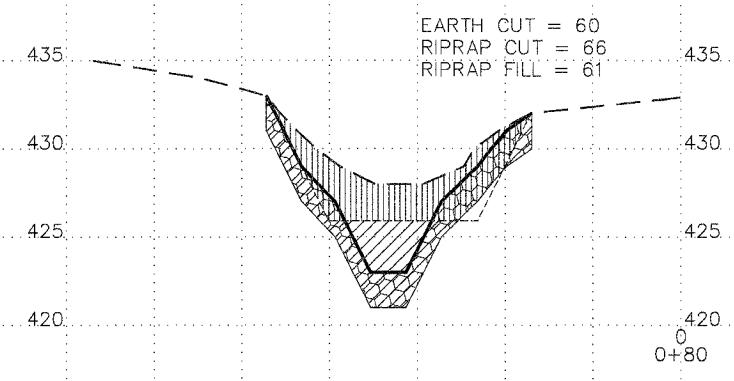
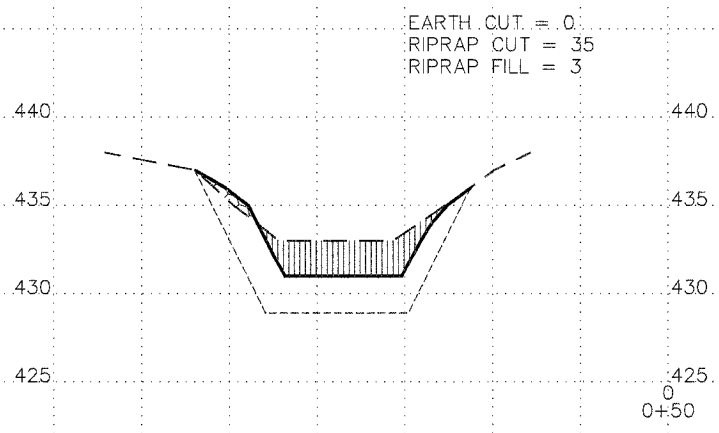
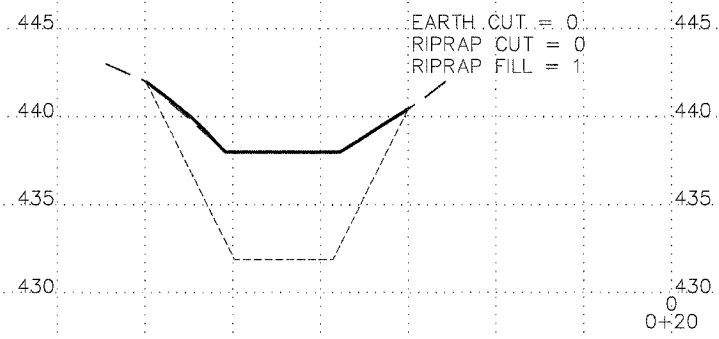
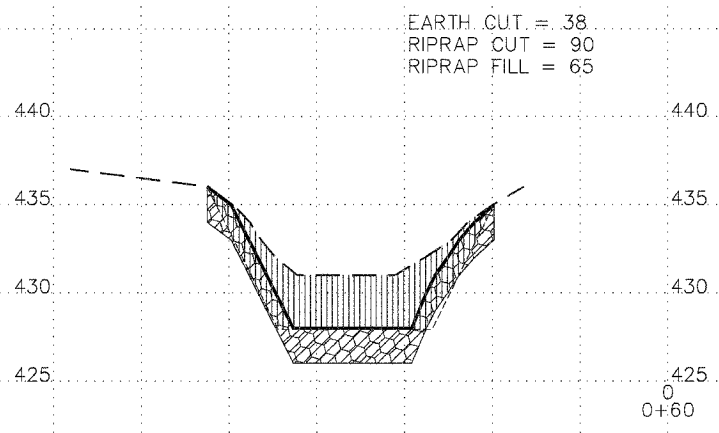
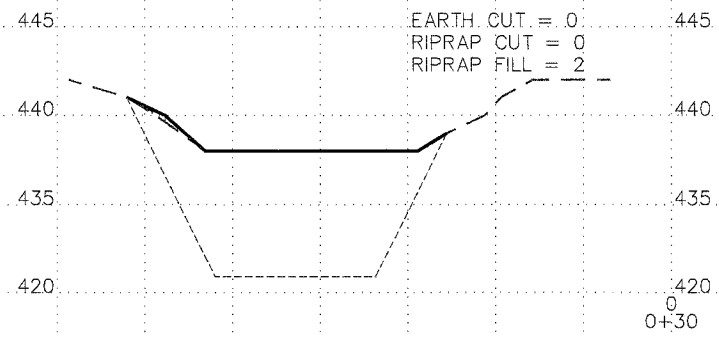



Horizontal Scale 10  
 Vertical Scale 5



WILLIAMSON COUNTY AIRPORT  
 REMEDIAL RECLAMATION PROJECT  
 AML-GWmE-0514  
 WILLIAMSON COUNTY

**LEGEND**

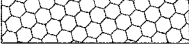
- EXISTING CONTOUR
- PROPOSED CONTOUR
- - - - - EXISTING BOTTOM OF RIPRAP
- PROPOSED BOTTOM OF RIPRAP
-  EARTH CUT (AREA IN SQ. FT.)
-  RIPRAP CUT (AREA IN SQ. FT.)
-  RIPRAP FILL (AREA IN SQ. FT.)

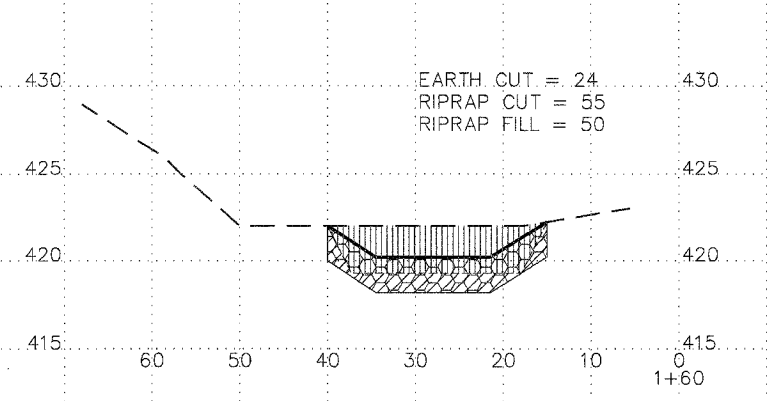
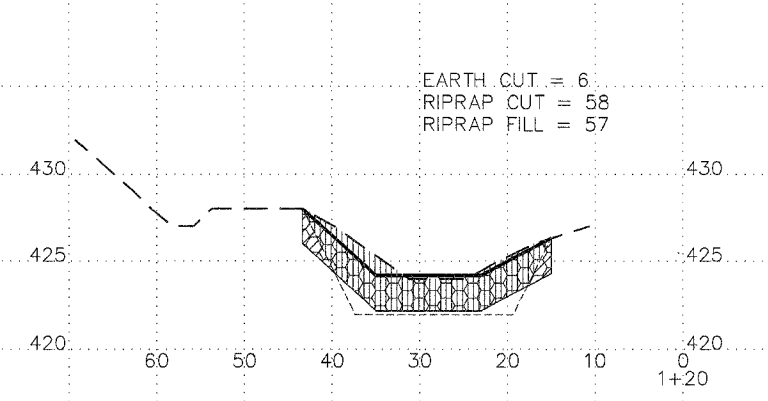
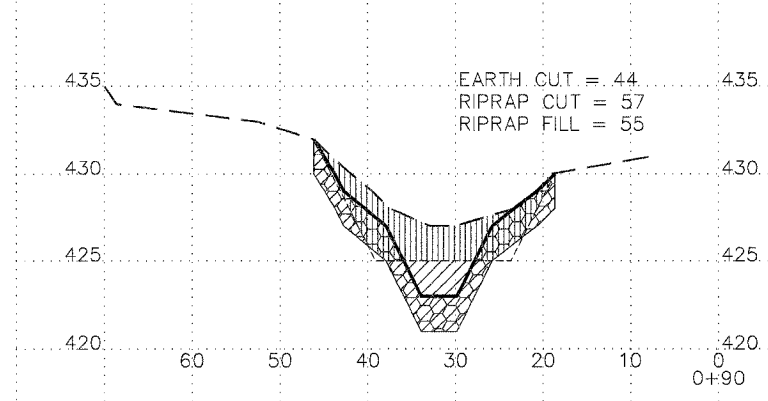
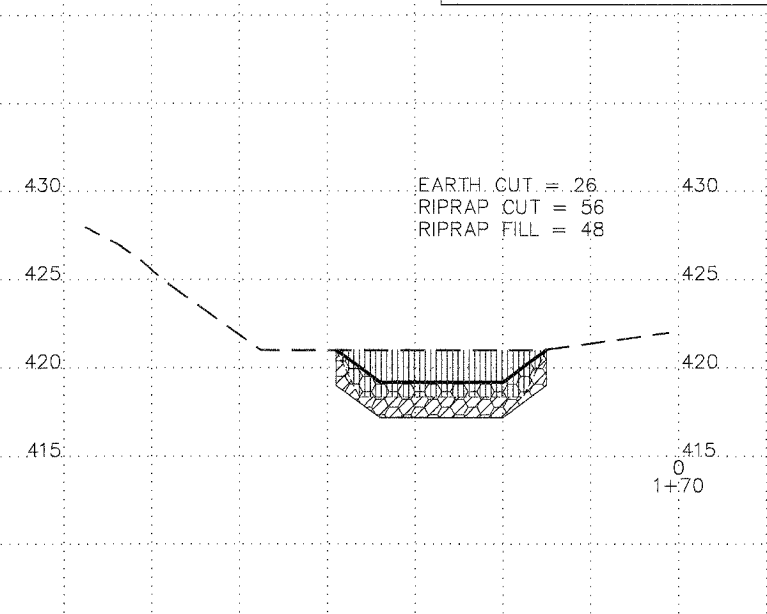
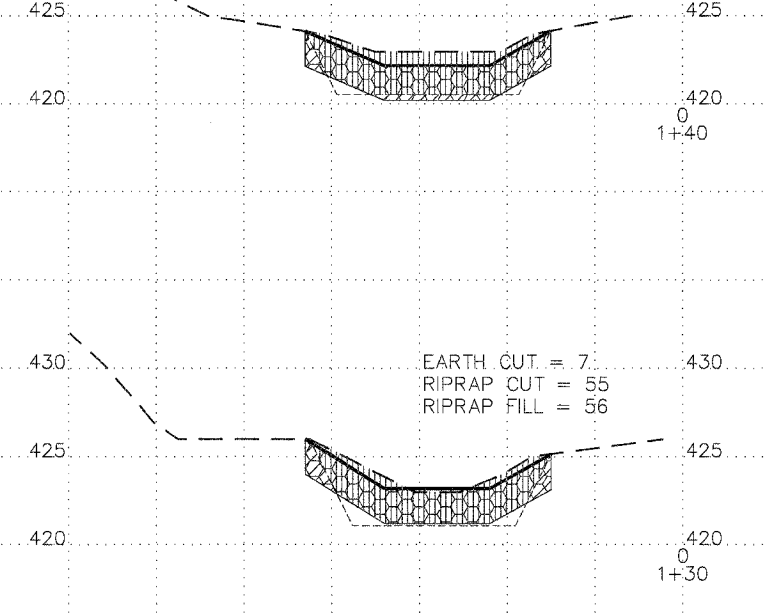
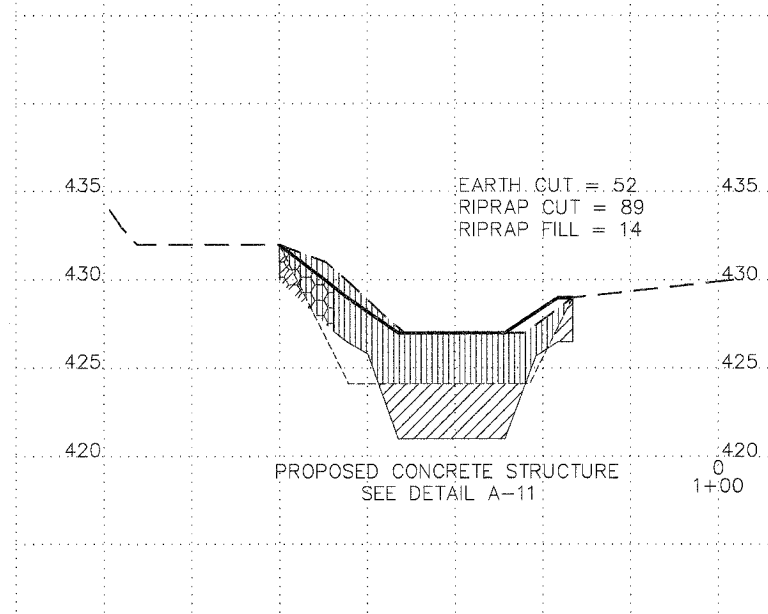
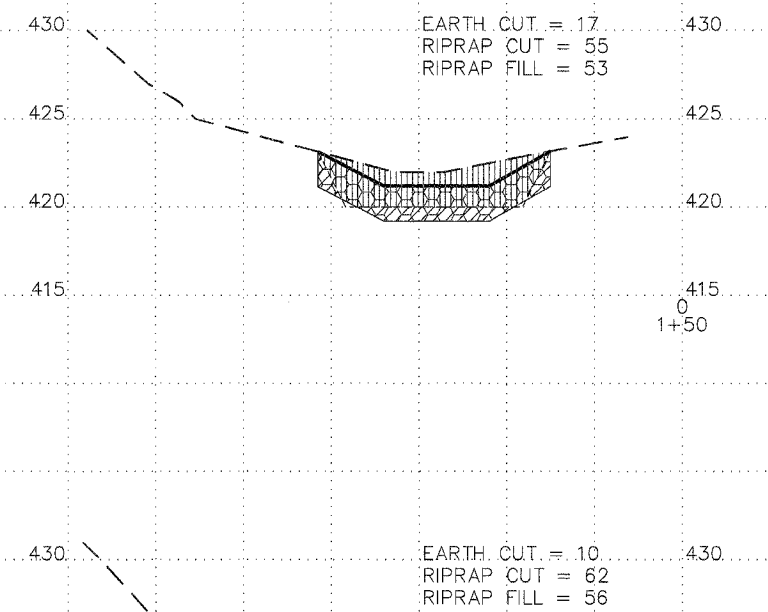
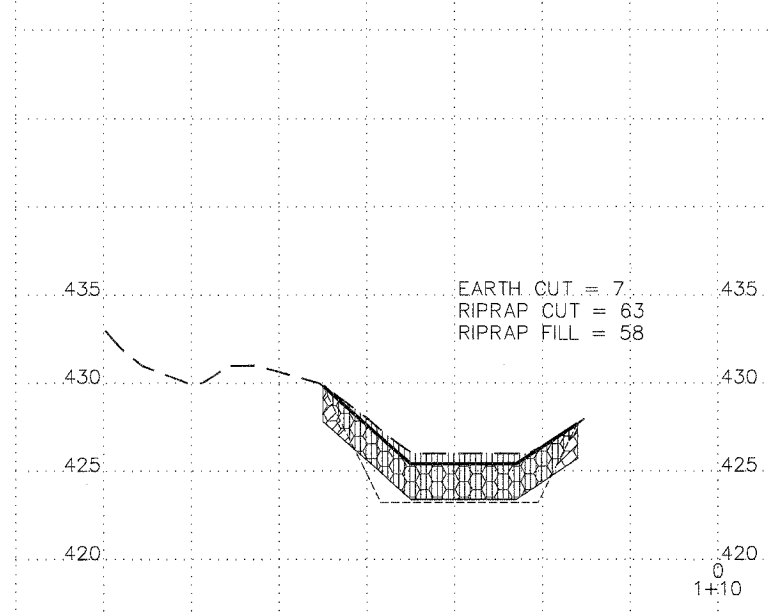

Horizontal Scale 10  
 Vertical Scale 5

WILLIAMSON COUNTY AIRPORT  
 REMEDIAL RECLAMATION PROJECT  
 AML-GWmE-0514  
 WILLIAMSON COUNTY

**LEGEND**

- EXISTING CONTOUR
- PROPOSED CONTOUR
- - - - - EXISTING BOTTOM OF RIPRAP
- PROPOSED BOTTOM OF RIPRAP
- [Diagonal Hatching] EARTH CUT (AREA IN SQ. FT.)
- [Vertical Hatching] RIPRAP CUT (AREA IN SQ. FT.)
- [Circular Pattern] RIPRAP FILL (AREA IN SQ. FT.)

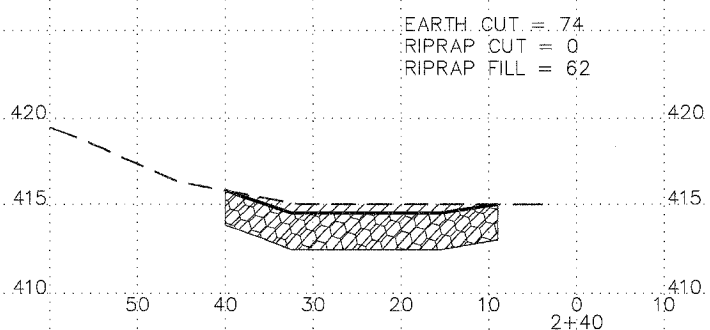
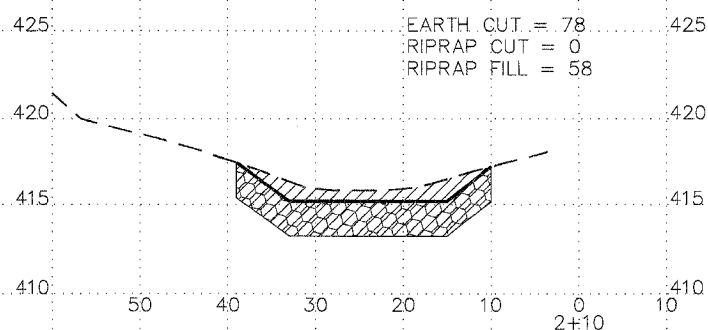
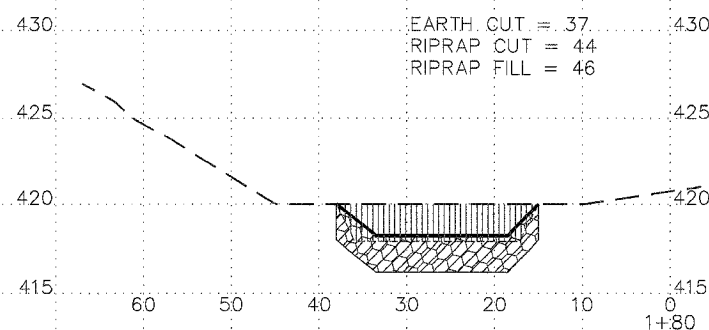
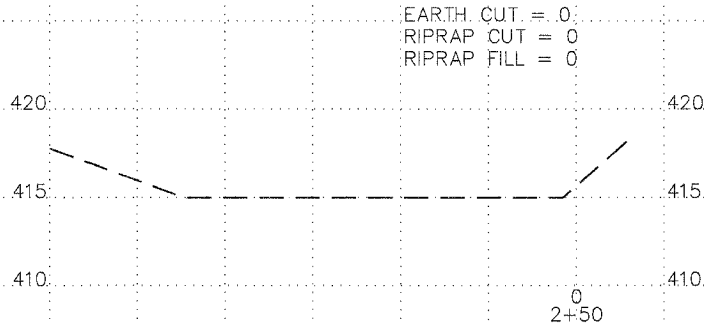
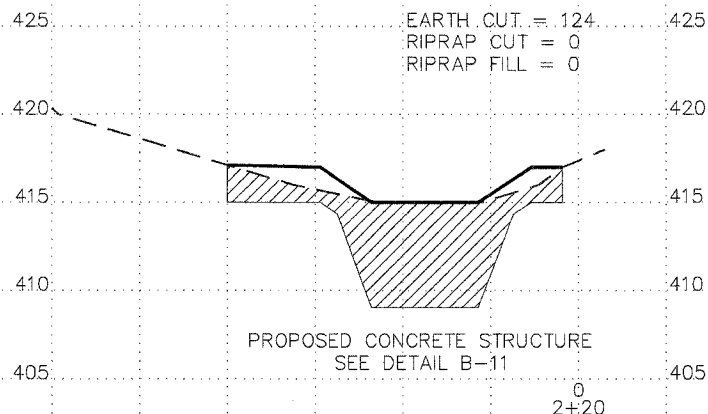
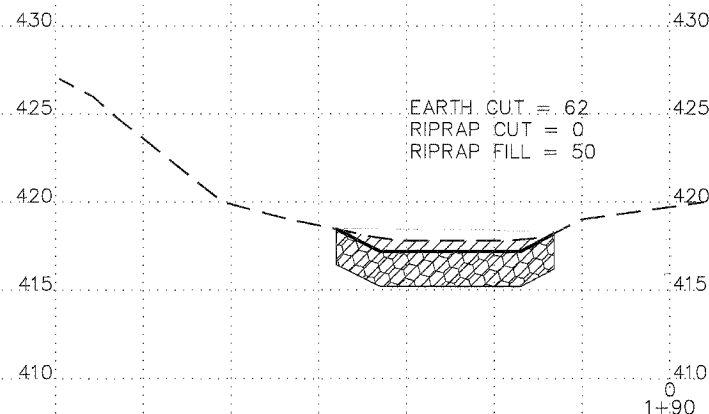
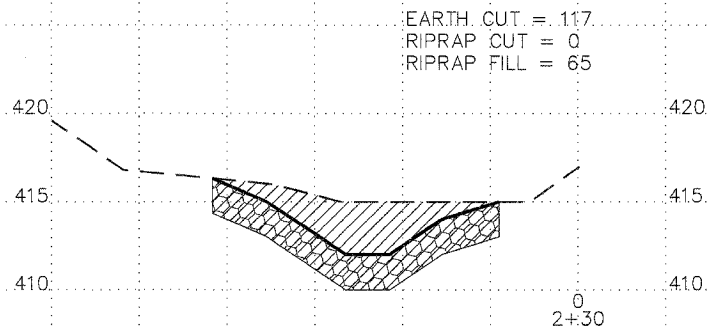
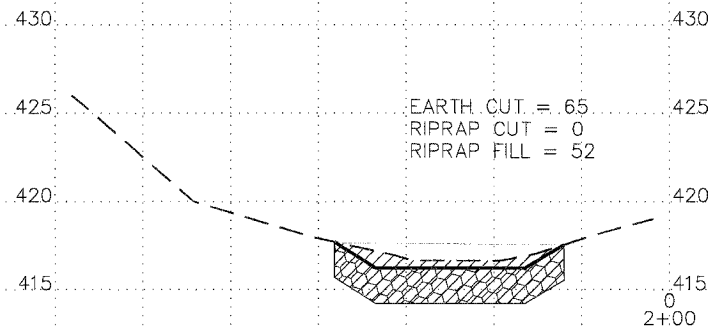

Horizontal Scale 10  
 Vertical Scale 5

