

CONTROL PT #1
(PK NAIL)
N10000.020
E10000.001
ELEV=97.17

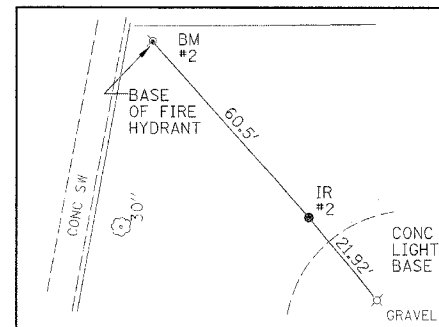

CONTROL PT #2
(IRON ROD)
N10752.413
E10020.798
ELEV=97.11

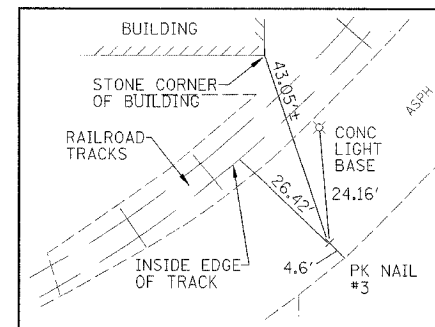

CONTROL PT #3
(PK NAIL)
N9989.810
E10421.806
ELEV=97.54

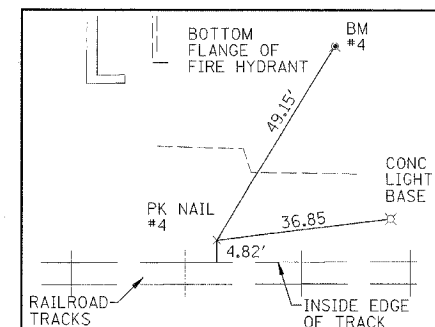

CONTROL PT #4
(PK NAIL)
N10248.978
E10165.146
ELEV=97.15

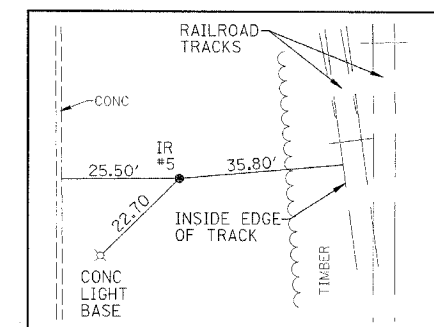

CONTROL PT #5
(IRON ROD)
N10271.111
E10439.198
ELEV=97.30

BENCHMARK LOCATIONS		
NUMBER	DESCRIPTION	ELEVATION
①	TOP FIRE HYDRANT NE CORNER OF E. 111TH ST & S. COTTAGE GROVE AVE	ASSUMED 100.00
②	TOP FIRE HYDRANT NW CORNER OF SITE (INSIDE FENCE)	99.80
③	TOP FIRE HYDRANT E SIDE NORTH BUILDING 150± S OF NE CORNER OF BUILDING	100.34
④	TOP FIRE HYDRANT 60'± E OF SE CORNER OF NORTH BUILDING	100.25

GENERAL NOTES

- 1.) THE CONTRACTOR SHALL COMPLY WITH ALL APPLICABLE AND GENERAL CONDITIONS FOR BOTH THE ILLINOIS DEPARTMENT OF TRANSPORTATION (IDOT) AND THE CITY OF CHICAGO.
- 2.) THE CONTRACTOR SHALL OBTAIN ALL PERMITS NECESSARY TO COMPLETE THE WORK AND SHALL COORDINATE WITH BOTH IDOT AND THE APPROPRIATE DEPARTMENT WITH THE CITY OF CHICAGO.
- 3.) THE CONTRACTOR SHALL NOTIFY THE SITE MANAGER, MR. MIKE WAGENBACH, AT 773-660-2341, FORTY-EIGHT HOURS PRIOR TO MAKING ANY EXCAVATIONS ON THE PROJECT SITE. THE SITE MANAGER DESIRES TO OBSERVE ANY EXCAVATIONS AND DOCUMENT ANY ARTIFACTS UNCOVERED DURING SAME.

BITUMINOUS TABLE			
MIXTURE USE (S):	SURFACE	LEVELING BINDER	BINDER
PG	58-22	58-22	58-22
RAP % (MAX)	15	25	30
DESIGN AIR VOIDS	4.2	4.2	4.2
MIXTURE COMPOSITION (GRADATION MIXTURE)	IL 9.5	IL 9.5	IL 19.0
FRICTION AGGREGATE	MIX C	N/A	N/A
20 YEAR ESAL	N30	N30	N30

APPLICATION RATES	
BITUMINOUS MATERIALS (PRIME COAT) MC-30	0.40 GAL/SY
BITUMINOUS MATERIALS (PRIME COAT) RC-70	0.10 GAL/SY
BITUMINOUS CONCRETE BINDER COURSE	112 LB/IN/SY
BITUMINOUS CONCRETE SURFACE COURSE	112 LB/IN/SY
GRANULAR MATERIALS	2.05 TONS/CY
NITROGEN FERTILIZER NUTRIENT	90 LB/ACRE
PHOSPHERUS FERTILIZER NUTRIENT	90 LB/ACRE
POTASSIUM FERTILIZER NUTRIENT	90 LB/ACRE
MULCH METHOD 1	2 TONS/ACRE

REVISIONS	
NAME	DATE

ILLINOIS DEPARTMENT OF TRANSPORTATION
SURVEY TIES, BENCHMARKS
AND GENERAL NOTES
IDOT / IHPA
PULLMAN STATE HISTORIC SITE

SCALE: VERT.
HORIZ.
DATE: 11/08/05

DRAWN BY: DJM
CHECKED BY: PJM