

F.A.I. RTE.	SECTION	COUNTY	TOTAL SHEETS	SHEET NO.
90/94	*	COOK	312	36
STA. 4410+00		TO STA. 4420+00		
FED. ROAD DIST. NO. 1 ILLINOIS FED. AID PROJECT				
60A62 * (1919.15, 2021-922 PT1 & PT2) R-1				

- LEGEND:**
- PAVEMENT REMOVAL
 - PAVED SHOULDER REMOVAL
 - LINEAR REMOVALS
 - TEMPORARY FENCE

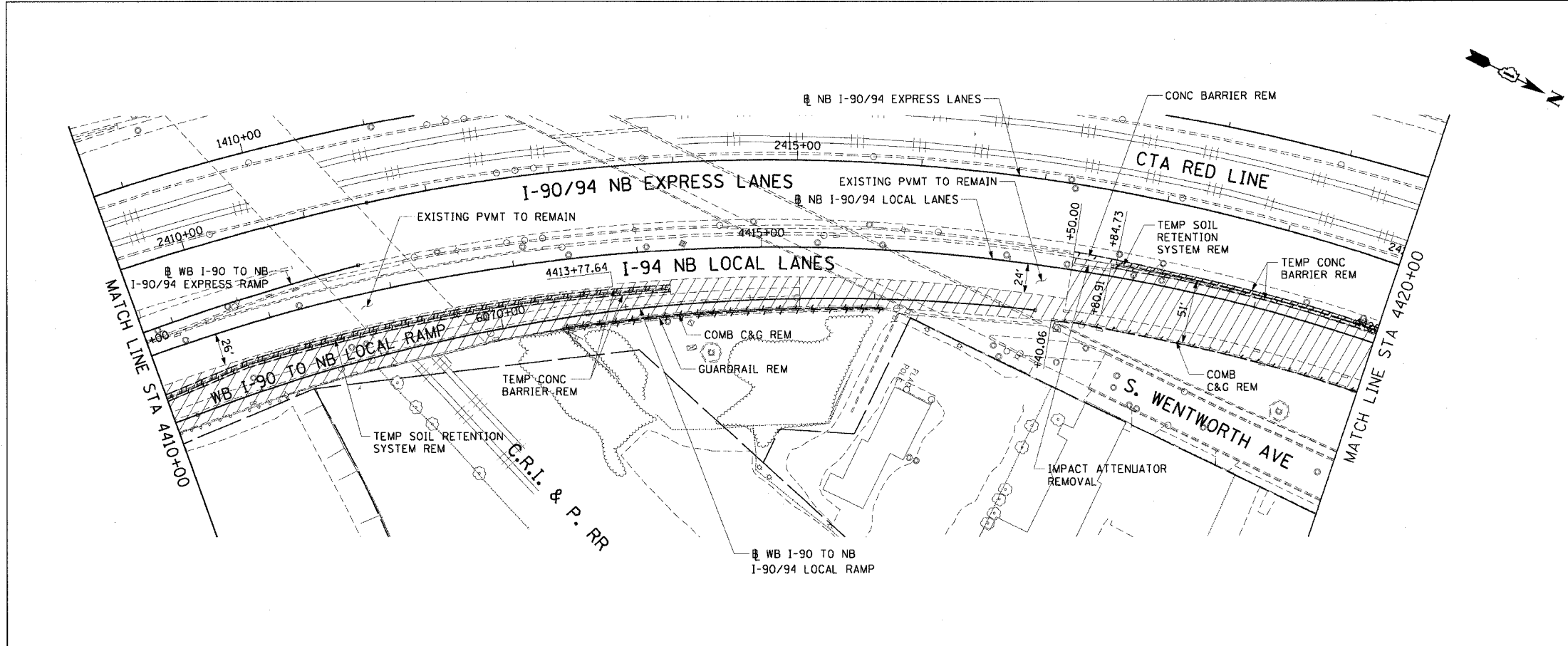

**EXISTING CONDITIONS AND REMOVAL
PROPOSED IMPROVEMENTS**

- NOTES:**
- STATION CALLOUTS ARE FROM THE NB I-90/94 LOCAL LANES BASELINE UNLESS OTHERWISE NOTED.
 - SEE ROADWAY DETAILS FOR BARRIER WALL TRANSITIONS AT BRIDGE PIERS AND SIGN STRUCTURES.
 - SEE ALIGNMENT PLANS FOR CURVE DATA.
 - SHOULDER RUMBLE STRIPS SHALL BE CONSTRUCTED IN THE PROPOSED AND EXISTING SHOULDERS OF THE LOCAL AND EXPRESS LANES ACCORDING TO IDOT STANDARD 642001. THE SHOULDER RUMBLE STRIPS SHALL EXTEND BEYOND THE ROADWAY LIMITS TO THE SOUTH TO STATION 2367+00.

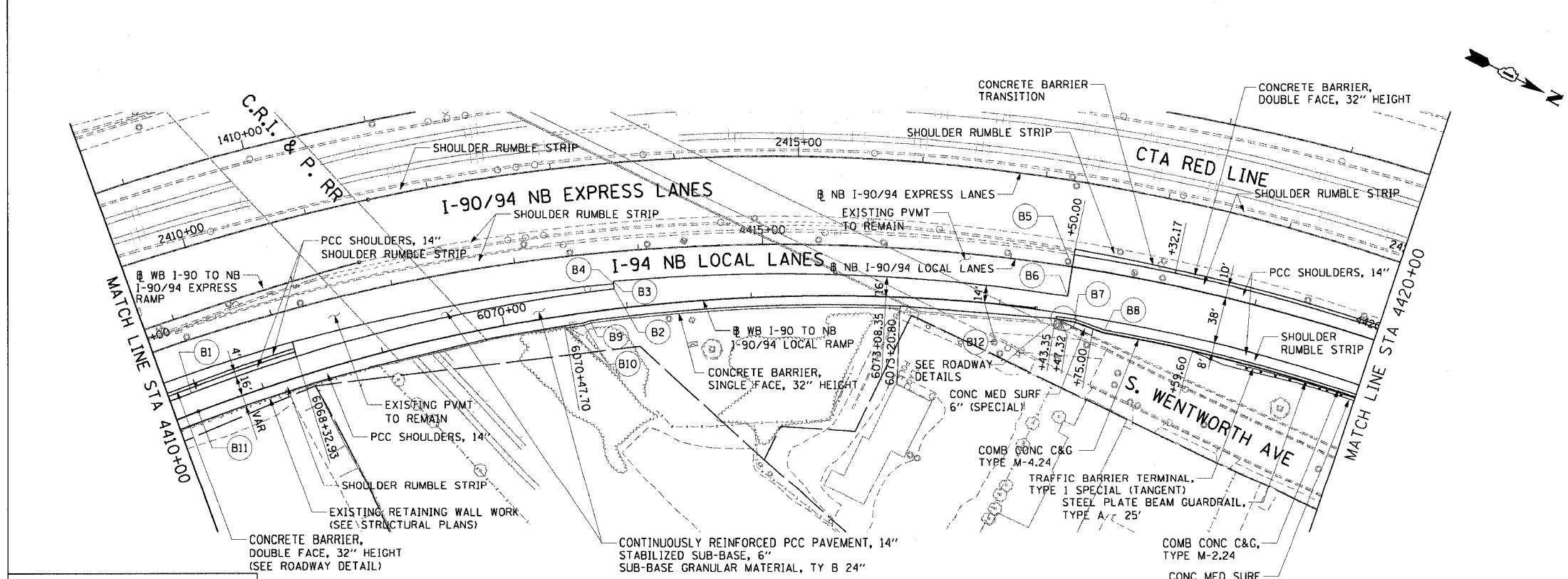

PT.	STATION	OFFSET	LOC
B1	6067+44.49	16.00' LT	EOP
B2	4413+77.64	30.00' RT	EOP
B3	4413+77.64	24.00' RT	EOP
B4	4413+77.64	26.00' RT	EOS
B5	4417+50.00	0.00'	EOP
B6	4417+50.00	24.00' RT	EOP
B7	4417+58.80	41.27' RT	EOS
B8	4417+84.49	46.00' RT	EOS
B9	6067+69.01	7.00' RT	EOS
B10	6070+62.79	8.24' RT	EOS
B11	6067+44.49	0.00'	EOP
B12	6073+87.84	0.00'	EOP

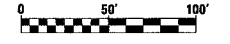

REVISIONS	NAME	DATE

ILLINOIS DEPARTMENT OF TRANSPORTATION
F.A.I. 90/94 (DAN RYAN EXPRESSWAY)
63RD STREET TO GARFIELD BLVD (NB LOCAL LANES)
EXISTING AND PROPOSED ROADWAY PLANS

SCALE: 1"=50'
DATE: June 9, 2006

DRAWN BY: PHP
CHECKED BY: NJH

CTE | AECOM

6/9/2006 9:34 AM RDY-2