

F.A.I. RTE.	SECTION	COUNTY	TOTAL SHEETS	SHEET NO.
90/94		COOK	312	53
STA. 4434+00 TO STA. 4458+00				
FED. ROAD DIST. NO. 1 ILLINOIS FED. AID PROJECT				
60A62 • (1919.15, 2021-922 PT1 & PT2) R-1				

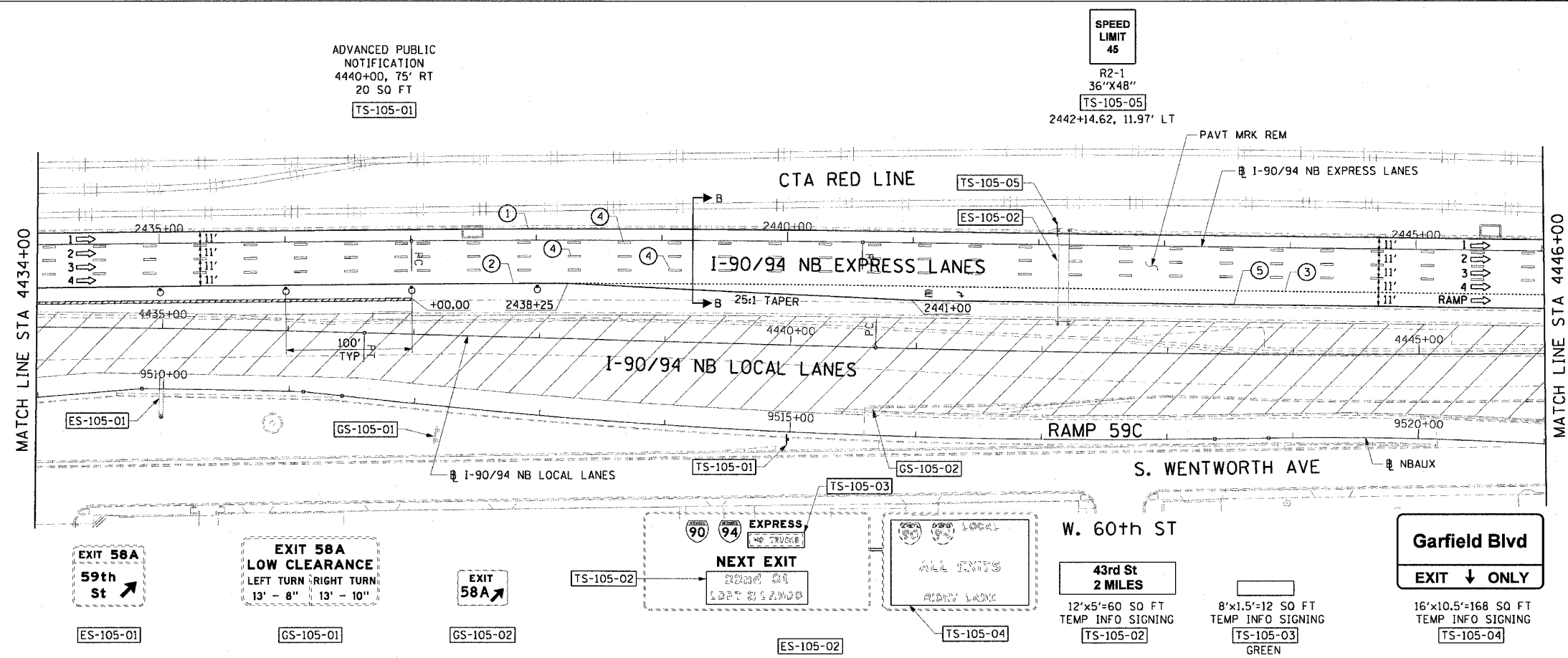

- LEGEND:**
- 1 → LANE NUMBER AND DIRECTION OF TRAFFIC
 - ▨ WORK AREA
 - ▨ TEMPORARY PAVEMENT
 - ∞ IMPACT ATTENUATORS, TEMPORARY (NON-REDIRECTIVE), TEST LEVEL 3
 - DRUM OR BARRICADE TYPE II WITH STEADY BURNING LIGHT
 - ⊥ BARRICADE TYPE III
 - ▨ TEMPORARY CONCRETE BARRIER
 - ① LINE 4" (YELLOW EDGE)
 - ② LINE 4" (WHITE EDGE)
 - ③ LINE 4" (SKIP DASH, 6' SKIP - 2' DASH, WHITE)
 - ④ LINE 5" (SKIP DASH, 30' SKIP - 10' DASH, WHITE)
 - ⑤ LINE 8" (WHITE GORE LINE)
 - ⑥ LINE 8" (SKIP DASH, 12' SKIP - 3' DASH, WHITE)
 - ⑦ LINE 12" (DIAGONAL, 30' C-C, WHITE)
 - ⑧ LETTERS AND SYMBOLS
 - ES-XXX-XX EXISTING OVERHEAD OR CANTILEVER SIGNS
 - GS-XXX-XX EXISTING POST MOUNTED SIGNS
 - TS-XXX-XX TEMPORARY SIGNS
- +XX.XX STATION PROVIDED FROM THE ± SB I-90/94 EXPRESS LANES
 (+XX.XX) STATION PROVIDED FROM THE ± SB I-90/94 LOCAL LANES

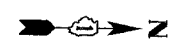
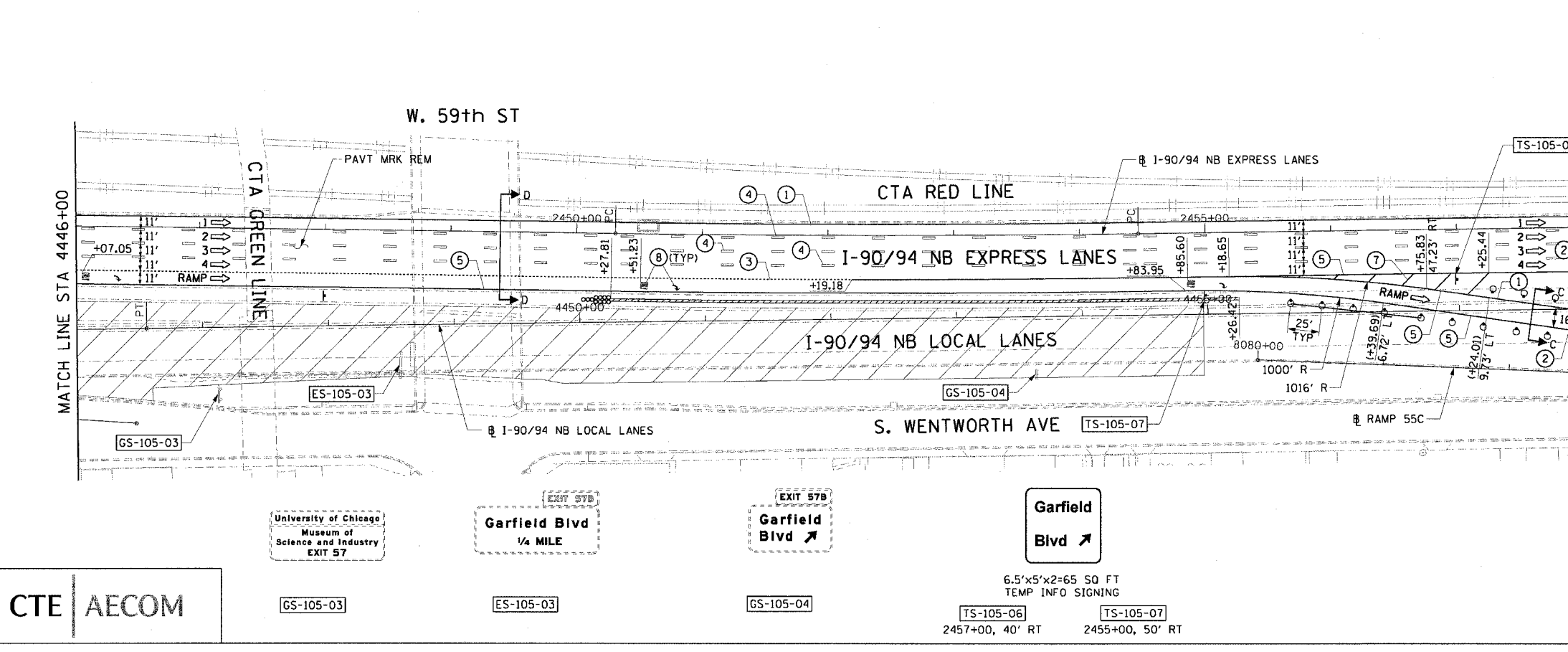
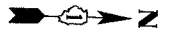

- NOTES:**
- SEE SHEET MOTTS-1 FOR TYPICAL SECTIONS.
 - SEE TEMPORARY SIGN PANEL SHEETS FOR DETAILS.
 - SIGN TS-105-01 SHALL BE ERECTED 2 WEEKS PRIOR TO WHEN RAMP 59D IS CLOSED TO TRAFFIC. FOR DETAILS SEE DISTRICT 1 DETAIL TC-8.

CTE | AECOM

REVISIONS	
NAME	DATE

MOT-105

ILLINOIS DEPARTMENT OF TRANSPORTATION
 F.A.I. 90/94 (DAN RYAN EXPRESSWAY)
 63RD STREET TO GARFIELD BLVD (NB LOCAL LANES)

SUGGESTED STAGES OF CONSTRUCTION AND TRAFFIC CONTROL
STAGE 1

SCALE: 1"=50'
 DATE: June 9, 2006

DRAWN BY: PHP
 CHECKED BY: RMG

P:\040468\ch108\ch108-entrs 18 & 19\dwg\ch108\mot105.dwg 3/3/2006 3:34:30 PM