

F.A.I. RTE.	SECTION	COUNTY	TOTAL SHEETS	SHEET NO.
90/94		COOK	312	63
STA. 000+00		TO STA. 4386+00		
FED. ROAD DIST. NO. 1 ILLINOIS FED. AID PROJECT				
60A62 • (1919.15, 2021-922 PT1 & PT2) R-1				

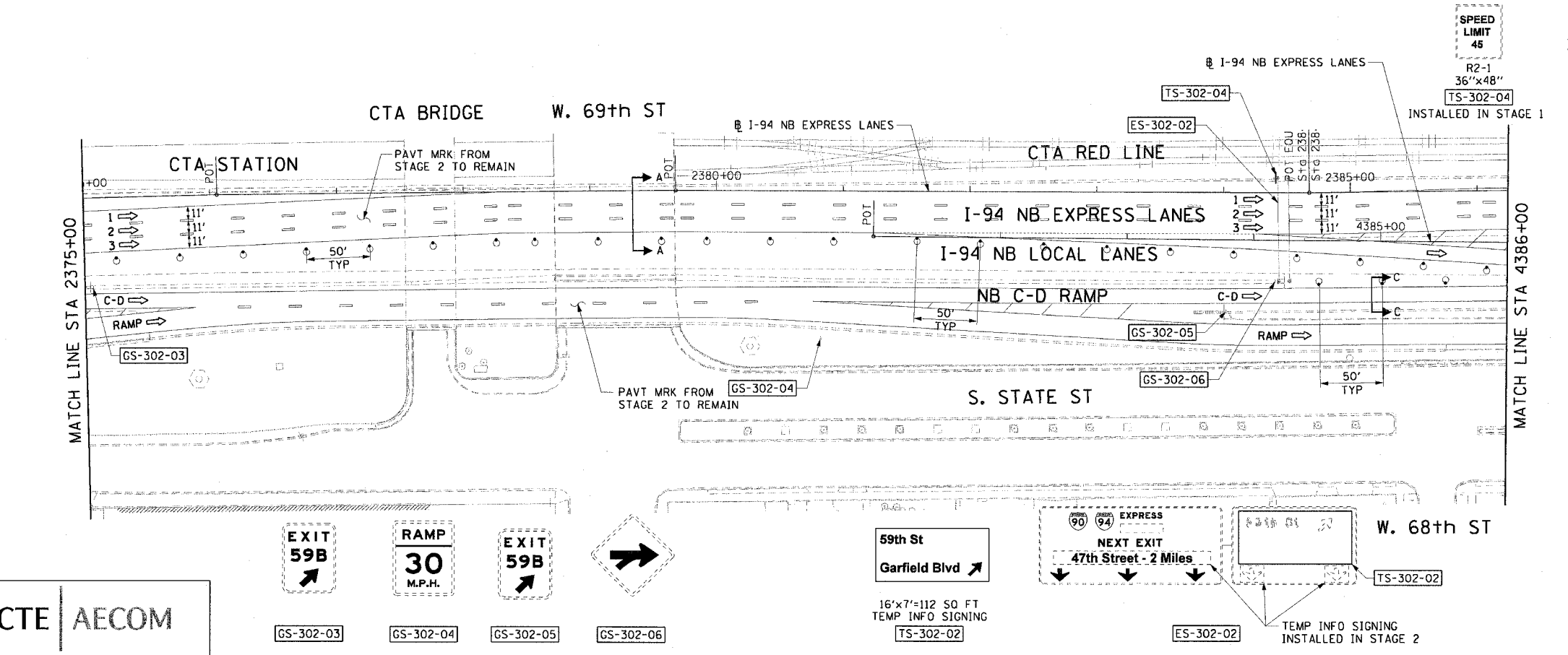

**LEGEND:**

- 1 → LANE NUMBER AND DIRECTION OF TRAFFIC
- [Hatched Box] WORK AREA
- [Dashed Box] TEMPORARY PAVEMENT
- [Symbol] IMPACT ATTENUATORS, TEMPORARY (NON-REDIRECTIVE), TEST LEVEL 3
- [Symbol] DRUM OR BARRICADE TYPE II WITH STEADY BURNING LIGHT
- [Symbol] BARRICADE TYPE III
- [Symbol] TEMPORARY CONCRETE BARRIER
- ① LINE 4" (YELLOW EDGE)
- ② LINE 4" (WHITE EDGE)
- ③ LINE 4" (SKIP DASH, 6' SKIP - 2' DASH, WHITE)
- ④ LINE 5" (SKIP DASH, 30' SKIP - 10' DASH, WHITE)
- ⑤ LINE 8" (WHITE GORE LINE)
- ⑥ LINE 8" (SKIP DASH, 12' SKIP - 3' DASH, WHITE)
- ⑦ LINE 12" (DIAGONAL, 30' C-C, WHITE)
- ⑧ LETTERS AND SYMBOLS
- [ES-XXX-XX] EXISTING OVERHEAD OR CANTILEVER SIGNS
- [GS-XXX-XX] EXISTING POST MOUNTED SIGNS
- [TS-XXX-XX] TEMPORARY SIGNS
- +XX.XX STATION PROVIDED FROM THE ± SB I-90/94 EXPRESS LANES
- (+XX.XX) STATION PROVIDED FROM THE ± SB I-90/94 LOCAL LANES

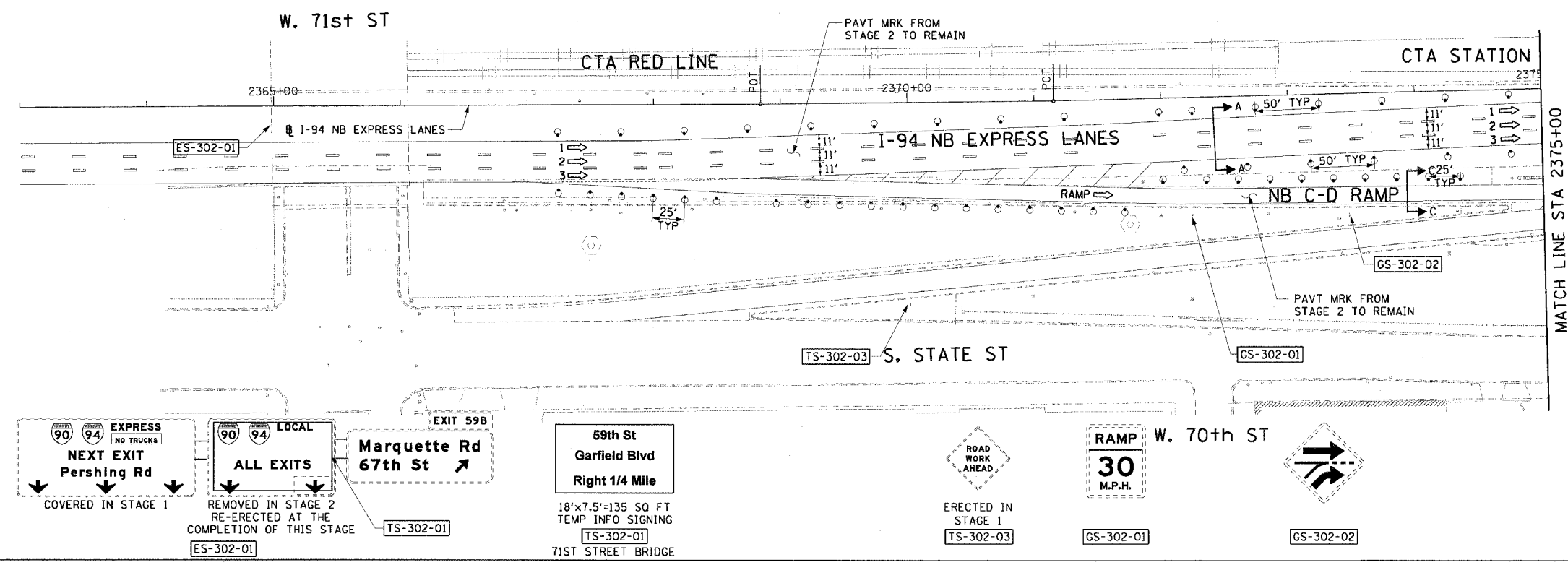

- NOTES:**
- SEE SHEET MOTTS-01 FOR TYPICAL SECTIONS.
  - SEE TEMPORARY SIGN PANEL SHEETS FOR DETAILS.
  - THE TEMPORARY INFORMATION SIGNING ON SIGN ES-302-01 SHALL BE REMOVED AT THE COMPLETION OF THIS STAGE.
  - ALL COVERED SIGN PANELS SHALL BE UNCOVERED AT THE COMPLETION OF THIS STAGE.

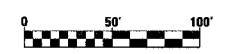

REVISIONS	
NAME	DATE

MOT-302

ILLINOIS DEPARTMENT OF TRANSPORTATION  
F.A.I. 90/94 (DAN RYAN EXPRESSWAY)  
63RD STREET TO GARFIELD BLVD (NB LOCAL LANES)

**SUGGESTED STAGES OF CONSTRUCTION AND TRAFFIC CONTROL  
STAGE 3**

SCALE: 1"=50'  
DATE: June 9, 2006

DRAWN BY: PHP  
CHECKED BY: RMC

CTE | AECOM

6/2/2006 3:34:45 PM P:\p468\civil\IB-entrs\IB & 19\ent\ent\156\mof\mof\_roadg3\_02.sit