

F.A.I. RTE.	SECTION	COUNTY	TOTAL SHEETS	SHEET NO.
90/94	*	COOK	247	37
STA. 3467+00		TO STA. 3475+50		
FED. ROAD DIST. NO. 1		ILLINOIS FED. AID PROJECT		
60A63		* (1919.15, 2021-922 PT1 & PT2) R-2		

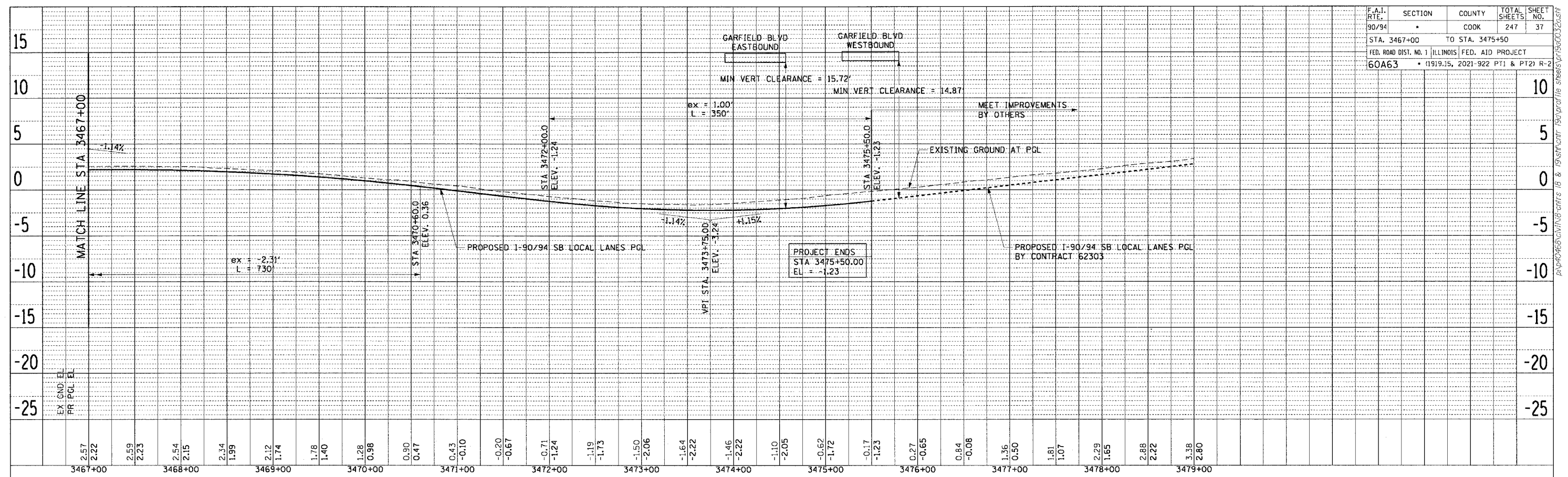

PLAN SURVEYED BY DATE
 PLOTTED BY
 NOTE BOOK NO. OF SHEETS CHECKED BY
 NO. PAID FILE NAME

PLAN SURVEYED BY DATE
 PLOTTED BY
 NOTE BOOK NO. OF SHEETS CHECKED BY
 NO. PAID FILE NAME

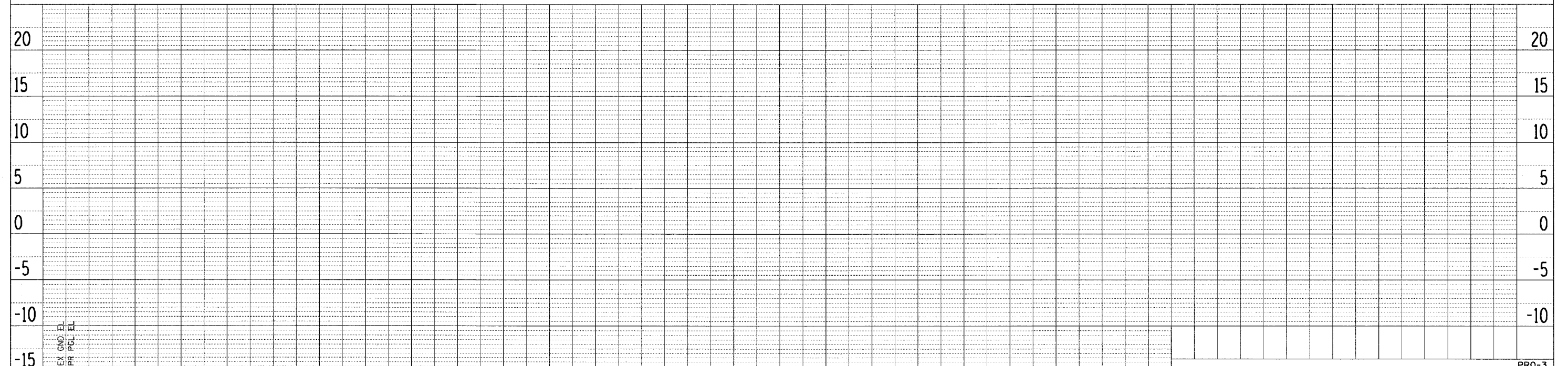

CTE | AECOM

REVISIONS	
NAME	DATE

PRO-3

ILLINOIS DEPARTMENT OF TRANSPORTATION
 F.A.I. 90/94 (DAN RYAN EXPRESSWAY)
 63RD STREET TO GARFIELD BLVD (SB LOCAL LANES)

**PROPOSED PROFILES
 SOUTHBOUND LOCAL LANES**

SCALE: H: 1"=50' V: 1"=5'
 DATE: June 9, 2006

DRAWN BY: PHP
 CHECKED BY: NJH

8/5/2006 10:54 PM I:\proj\90\profile sheets\vr35002.dwg