

F.A.I. RTE.	SECTION	COUNTY	TOTAL SHEETS	SHEET NO.
90/94	*	COOK	247	47
STA. 3386+00		TO STA. 3410+00		
FED. ROAD DIST. NO. 1 ILLINOIS FED. AID PROJECT				
60A63 • (1919.15, 2021-922 PT1 & PT2) R-2				

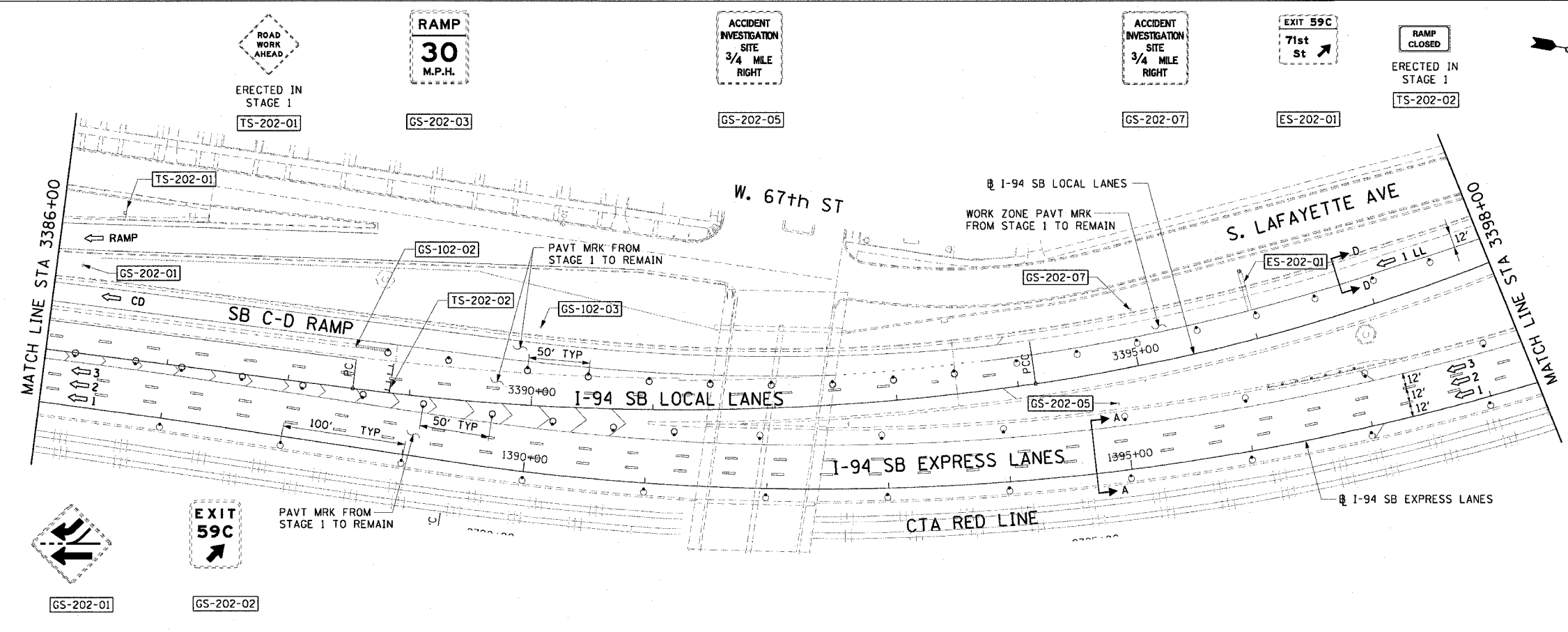

- LEGEND:**
- 1 → LANE NUMBER AND DIRECTION OF TRAFFIC
  - ▨ WORK AREA
  - ▨ TEMPORARY PAVEMENT
  - ⊙ IMPACT ATTENUATORS, TEMPORARY (NON-REDIRECTIVE), TEST LEVEL 3
  - ⊙ DRUM OR BARRICADE TYPE II WITH STEADY BURNING LIGHT
  - ⊙ BARRICADE TYPE III
  - ▬ TEMPORARY CONCRETE BARRIER
  - ① LINE 4" (YELLOW EDGE)
  - ② LINE 4" (WHITE EDGE)
  - ③ LINE 4" (SKIP DASH, 6' SKIP - 2' DASH, WHITE)
  - ④ LINE 5" (SKIP DASH, 30' SKIP - 10' DASH, WHITE)
  - ⑤ LINE 8" (WHITE GORE LINE)
  - ⑥ LINE 8" (SKIP DASH, 12' SKIP - 3' DASH, WHITE)
  - ⑦ LINE 12" (DIAGONAL, 30' C-C, WHITE)
  - ⑧ LETTERS AND SYMBOLS
  - ES-XXX-XX EXISTING OVERHEAD OR CANTILEVER SIGNS
  - GS-XXX-XX EXISTING POST MOUNTED SIGNS
  - TS-XXX-XX TEMPORARY SIGNS
- +XX.XX STATION PROVIDED FROM THE ± SB I-90/94 EXPRESS LANES  
 (+XX.XX) STATION PROVIDED FROM THE ± SB I-90/94 LOCAL LANES

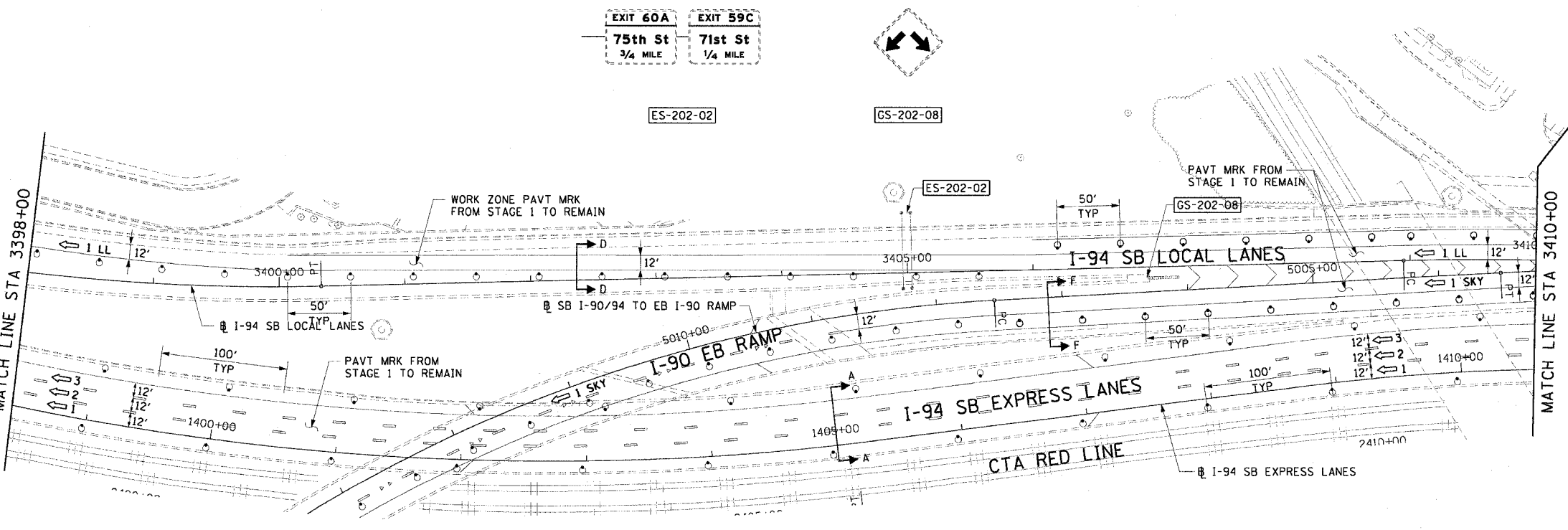

- NOTES:**
- SEE SHEET MOTTS-01 FOR TYPICAL SECTIONS.
  - SEE TEMPORARY SIGN PANEL SHEETS FOR DETAILS.
  - PROVIDE TRAFFIC CONTROL ON THE EB SKYWAY RAMP ENDING AT STA. 5020+10.00 (EAST ABUTMENT OF THE STATE STREET BRIDGE).

CTE | AECOM

REVISIONS	
NAME	DATE

MOT-202

ILLINOIS DEPARTMENT OF TRANSPORTATION  
 F.A.I. 90/94 (DAN RYAN EXPRESSWAY)  
 63RD STREET TO GARFIELD BLVD (SB LOCAL LANES)

SUGGESTED STAGES OF CONSTRUCTION AND TRAFFIC CONTROL  
 STAGE 2

SCALE: 1"=50'  
 DATE: June 9, 2006

DRAWN BY: PHP  
 CHECKED BY: RMG

6/2/2006 3:40:34 PM  
 I:\projects\9094\9094-190\9094-190-01\9094-190-01-01.dwg