

F.A.I. RTE.	SECTION	COUNTY	TOTAL SHEETS	SHEET NO.
90/94	*	COOK	247	161
STA.	TO STA.			
FED. ROAD DIST. NO. 1 ILLINOIS FED. AID PROJECT				
60A63 * (1919.15, 2021-922 PT1 & PT2) R-2				

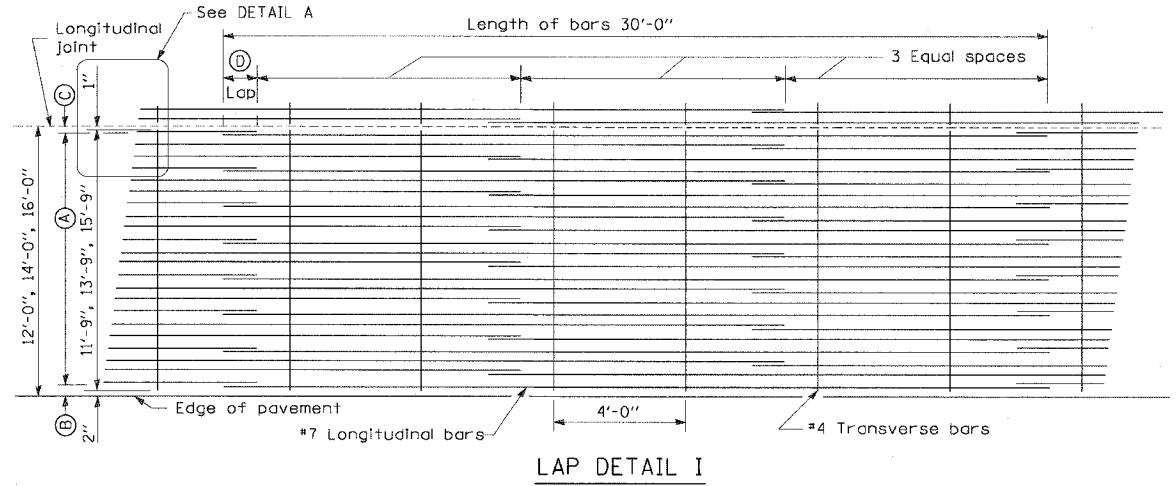

Pavement Width	Bar Size	Pavement Thickness	Ⓐ (Approx. Spacing)	Ⓑ	Ⓒ	Ⓓ
12 feet	#7	14"	26 spaces (27 bars) @ 5 1/4"	3 1/2"	3"	26"
14 feet	#7	14"	30 spaces (31 bars) @ 5 3/8"	3 1/2"	3"	26"
16 feet	#7	14"	35 spaces (36 bars) @ 5 1/4"	3 1/2"	3"	26"

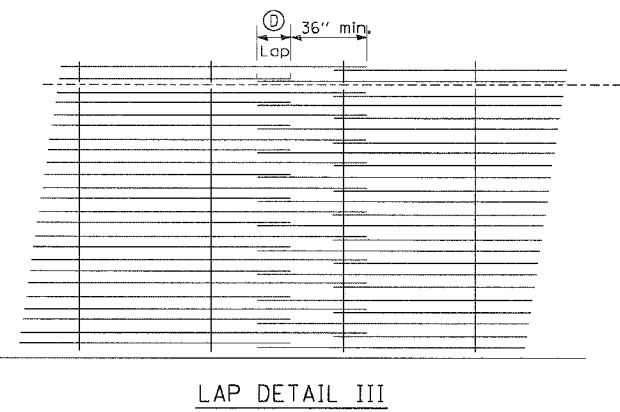
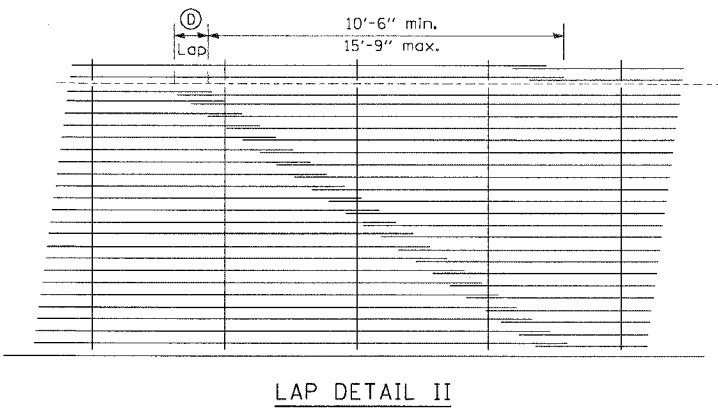
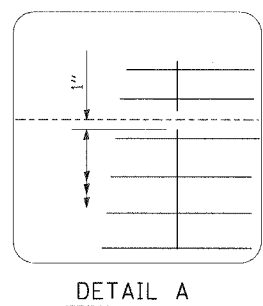

- GENERAL NOTES
1. THE PAVEMENT REINFORCEMENT SHALL BE 4.5" FROM THE TOP OF PAVEMENT.
 2. EXCEPT AS NOTED OR SHOWN, THE DIMENSIONS AND NOTES SPECIFIED FOR LAP DETAIL I ARE TYPICAL FOR LAP DETAIL II AND III.
 3. THE Ⓑ DIMENSION AND THE DISTANCE FROM THE END OF THE TRANSVERSE BAR TO THE EDGE OF PAVEMENT MAY BE INCREASED BY 1" FOR SLIP FORM PAVING.

REVISIONS		ILLINOIS DEPARTMENT OF TRANSPORTATION F.A.I. 90/94 (DAN RYAN EXPRESSWAY) 63RD STREET TO GARFIELD BLVD (SB LOCAL LANES) ROADWAY DETAILS EXTENDED LANE REINFORCEMENT FOR CONTINUOUSLY REINFORCED PCC PAVEMENT
NAME	DATE	
		SCALE: NONE
		DATE: June 9, 2006
		DRAWN BY: NJH
		CHECKED BY: RMG

CTE | AECOM

RDT-1
107:29 PM
6/5/2006