

CONTRACT NO. 60857				
F.A.M. RTE.	SECTION	COUNTY	TOTAL SHEETS	SHEET NO.
123B	125_SB-1-I-1	LAKE	13	6
STA. _____		TO STA. _____		
FED. ROAD DIST. NO. _____ ILLINOIS FED. AID PROJECT				

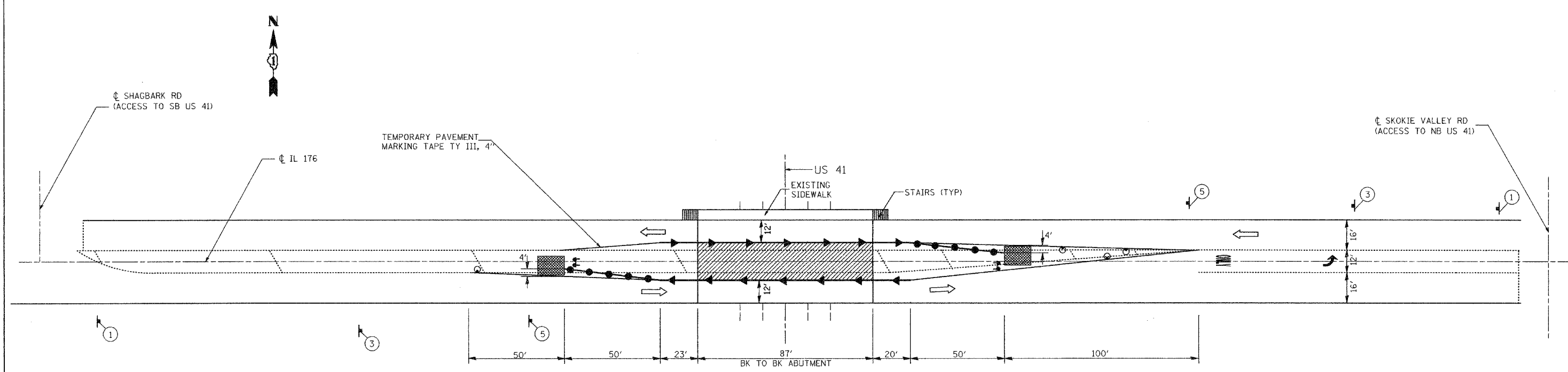

STAGE III

- TYPE II BARRICADE, DRUM OR VERTICAL BARRICADE WITH STEADY BURNING MONODIRECTIONAL LIGHT @ 25' CTS
- † SIGN ON PORTABLE OR PERMANENT SUPPORT
- ⊞ TYPE III BARRICADE WITH 2 STEADY BURNING LIGHTS
- WORK ZONE
- IMPACT ATTENUATORS
- ← TEMP. CONCRETE BARRIER WITH TYPE C MONODIRECTIONAL REFLECTOR ON TANGENT PORTION AT BARRIER AT 50' CENTERS (SEE DETAIL A)
- TEMP. CONCRETE BARRIER WITH VERTICAL PANELS AT 25' CENTERS WITH STEADY BURN MONODIRECTIONAL LIGHT
- DIRECTION OF TRAFFIC

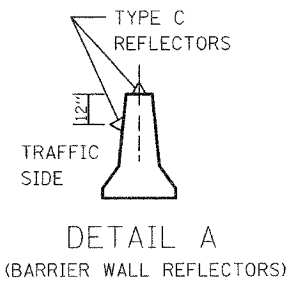

NOTES: LANE CLOSURE AND ADDITIONAL TRAFFIC CONTROL ITEMS SHOWN ON THESE SHEETS ARE INCLUDED IN THE COST OF "TRAFFIC CONTROL & PROTECTION (SPECIAL)"

THE TYPE III TAPE SHOWN SHALL MEET THE REQUIREMENTS OF THE SPECIAL PROVISION "TYPE III TEMPORARY TAPE FOR WET CONDITIONS". COVER CONFLICTING EXISTING PAVEMENT MARKINGS WITH BLACK TYPE III TAPE TAPE. THE COST OF THE TYPE III TAPE AND ITS REMOVAL IS INCLUDED IN THE COST OF "TRAFFIC CONTROL & PROTECTION (SPECIAL)"

ADVANCED WARNING SIGNAGE FOR IL 176 SHALL BE ACCORDING TO THE SPECIAL PROVISION "TEMP. INFO. SIGNING FOR LANE CLOSURES"

ADVANCED WARNING FOR LANE CLOSURES & TEMP. DETOUR ON US 41 SHALL USE "PORTABLE CHANGEABLE MESSAGE SIGNS."

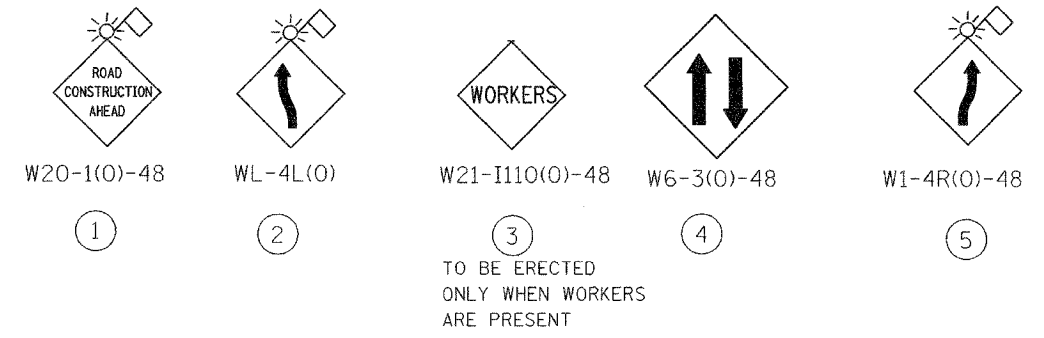

REVISIONS	
NAME	DATE

ILLINOIS DEPARTMENT OF TRANSPORTATION

STAGING LAYOUT FOR
TEMPORARY CONCRETE BARRIER
AND TEMPORARY PAVEMENT MARKINGS
SN 049-0131
3 of 3

SCALE: VERT. _____
HORIZ. _____

DATE _____ DRAWN BY _____
CHECKED BY _____

PLOT DATE = 6/16/2006
 PLOT SCALE = 1/8" = 1'-0"
 USER NAME = gullhaimefp