

F.A.I.	SECTION	COUNTY	TOTAL SHEETS	SHEET NO.
94/90	*	COOK	588	74
STA.		TO STA.		
FED. ROAD DIST. NO.	ILLINOIS	FED. AID PROJECT		

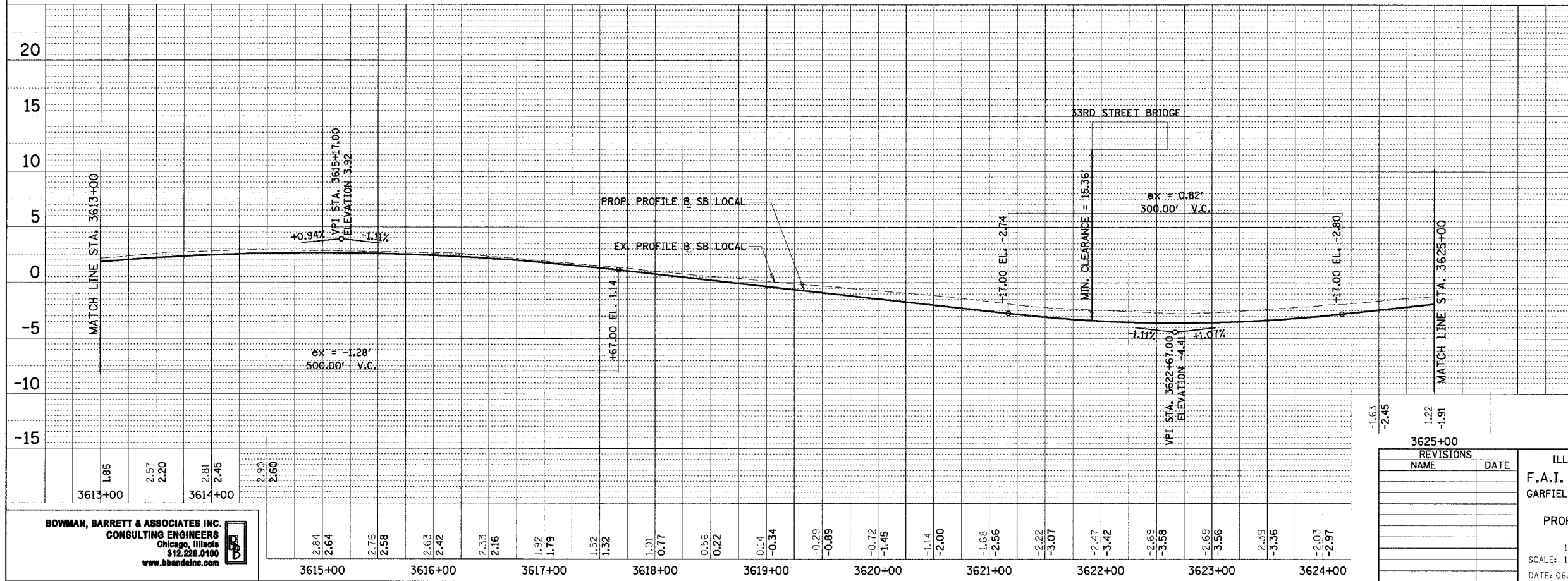
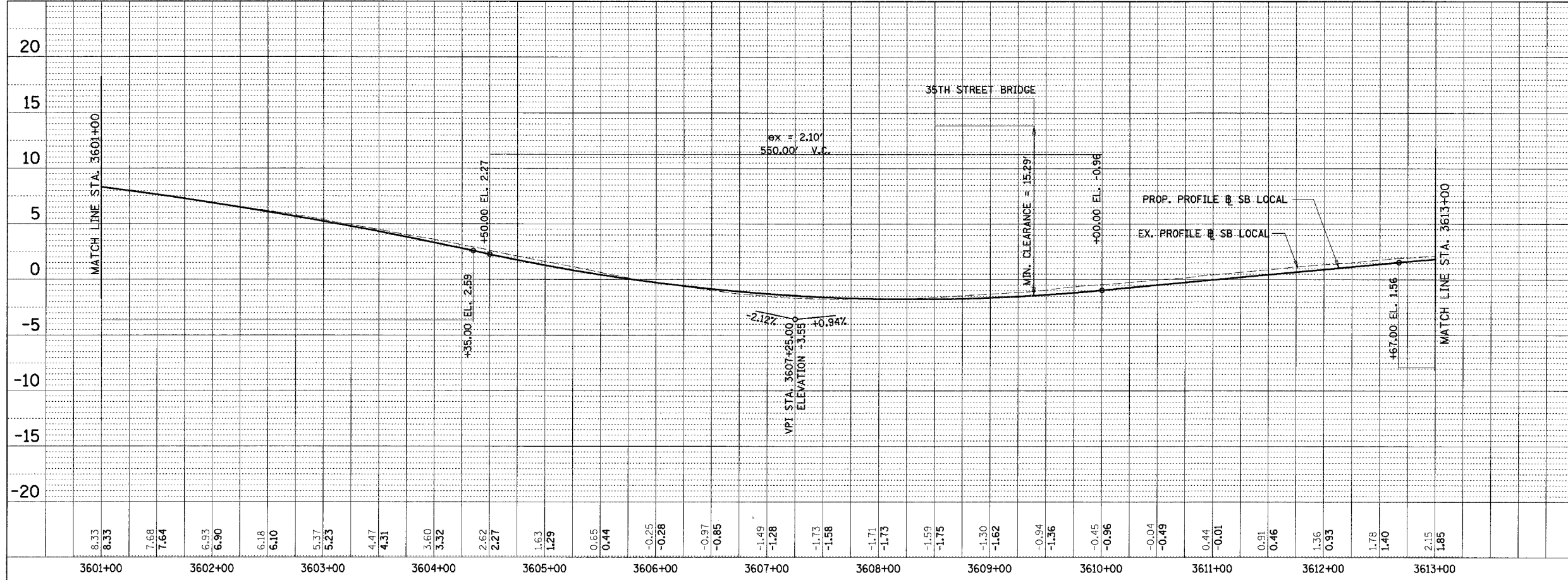

PLAN	REVIEWED	DATE
NO.	BY	

PLAN	REVIEWED	DATE
NO.	BY	

**BOWMAN, BARRETT & ASSOCIATES INC.**  
 CONSULTING ENGINEERS  
 Chicago, Illinois  
 312.228.0100  
 www.bbainc.com

2.84	2.76	1.92	0.14	-0.29	-1.14	-1.68	-2.22	-2.69	-2.69	-2.39	-2.03
2.64	2.58	1.79	-0.34	-0.89	-2.00	-2.56	-3.07	-3.58	-3.56	-3.36	-2.97
2.81	2.81	2.33	0.77	0.56	-1.14	-1.68	-2.22	-2.69	-3.56	-3.36	-2.97
2.45	2.50	2.16	0.22	0.22	-2.00	-2.56	-3.07	-3.58	-3.56	-3.36	-2.97
2.50	2.50	2.16	0.77	0.22	-2.00	-2.56	-3.07	-3.58	-3.56	-3.36	-2.97
2.60	2.50	2.16	0.77	0.22	-2.00	-2.56	-3.07	-3.58	-3.56	-3.36	-2.97

REVISIONS	
NAME	DATE

ILLINOIS DEPARTMENT OF TRANSPORTATION  
 F.A.I. 94/90 (DAN RYAN EXPRESSWAY)  
 GARFIELD BLVD TO 31ST STREET (SB LOCAL LANES)  
 PROFILES - SOUTHBOUND LOCAL LANES  
 1" = 5' VERTICAL  
 SCALE: 1" = 50' HORIZ  
 DATE: 06/09/06  
 DRAWN BY: JDC  
 CHECKED BY: RS

6/8/2006 11:02:48 AM