

F.A.I.	SECTION	COUNTY	TOTAL SHEETS	SHEET NO.
94/90		COOK	588	104
STA. TO STA.				
FED. ROAD DIST. NO. ILLINOIS FED. AID PROJECT				
62303 • (2021-922 PT2 ETC 2324.6-IP) R-11				

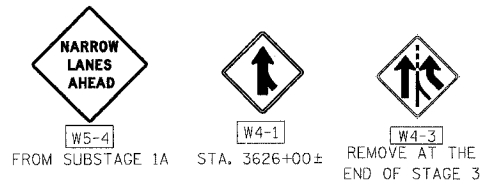

**35th St RAMP CLOSED**

**Pershing Rd**

W2-1115(O)-3618, R2-1, W13-3, R5-1, W4-1, W5-4, W4-3 AND R2-1106-3618 INCLUDED IN "TRAFFIC CONTROL AND PROTECTION "EXPRESSWAYS"

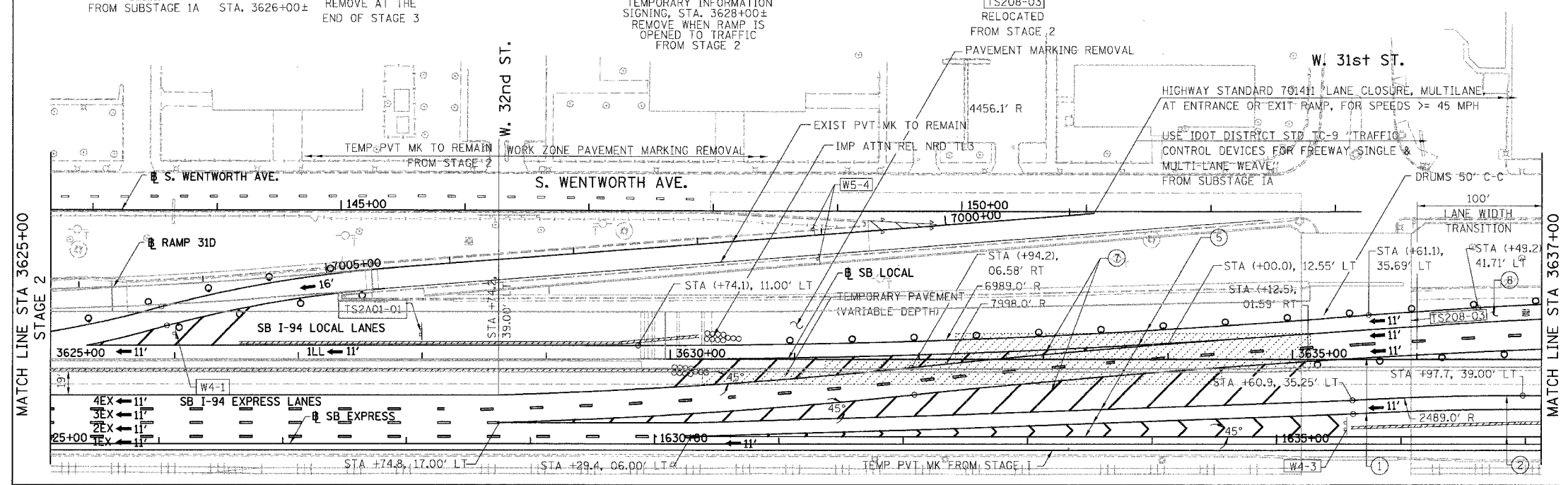

- LEGEND:**
- 1 → LANE NUMBER AND DIRECTION OF TRAFFIC
  - ▨ WORK AREA
  - ▨ TEMPORARY PAVEMENT
  - IMPACT ATTENUATORS, TEMPORARY (NON-REDIRECTIVE), TEST LEVEL 3
  - DRUM OR BARRICADE TYPE II WITH STEADY BURNING LIGHT
  - ▬ BARRICADE TYPE III
  - ▬ TEMPORARY CONCRETE BARRIER
  - ① LINE 4" (YELLOW EDGE)
  - ② LINE 4" (WHITE EDGE)
  - ③ LINE 4" (SKIP DASH, 6' SKIP - 2' DASH, WHITE)
  - ④ LINE 5" (SKIP DASH, 30' SKIP - 10' DASH, WHITE)
  - ⑤ LINE 8" (WHITE GORE LINE)
  - ⑥ LINE 8" (SKIP DASH, 12' SKIP - 3' DASH, WHITE)
  - ⑦ LINE 12" (DIAGONAL, 30' C-C, WHITE)
  - ⑧ LETTERS AND SYMBOLS
  - [ES-XXX-XX] EXISTING OVERHEAD OR CANTILEVER SIGNS
  - [GS-XXX-XX] EXISTING POST MOUNTED SIGNS
  - [TS-XXX-XX] TEMPORARY SIGNS
  - +XX.XX STATION PROVIDED FROM THE ± SB I-90/94 EXPRESS LANES
  - (+XX.XX) STATION PROVIDED FROM THE ± SB I-90/94 LOCAL LANES

**TS2A01-02**  
EAST RYAN EXPY THRU TRAFFIC LEFT 2 LANES

W2-1115(O)-3618, R2-1, W13-3, R5-1, W4-1, W5-4, W4-3 AND R2-1106-3618 INCLUDED IN "TRAFFIC CONTROL AND PROTECTION "EXPRESSWAYS"

**RIGHT LANE MUST EXIT**

**LOCAL EXITS**  
Pershing Rd 1/4 MILE

CONTRACTS 62303 AND 62581 SHOULD COORDINATE MAINTENANCE OF TRAFFIC ISSUES AND TEMPORARY SIGNING DURING DIFFERENT MOT STAGES.

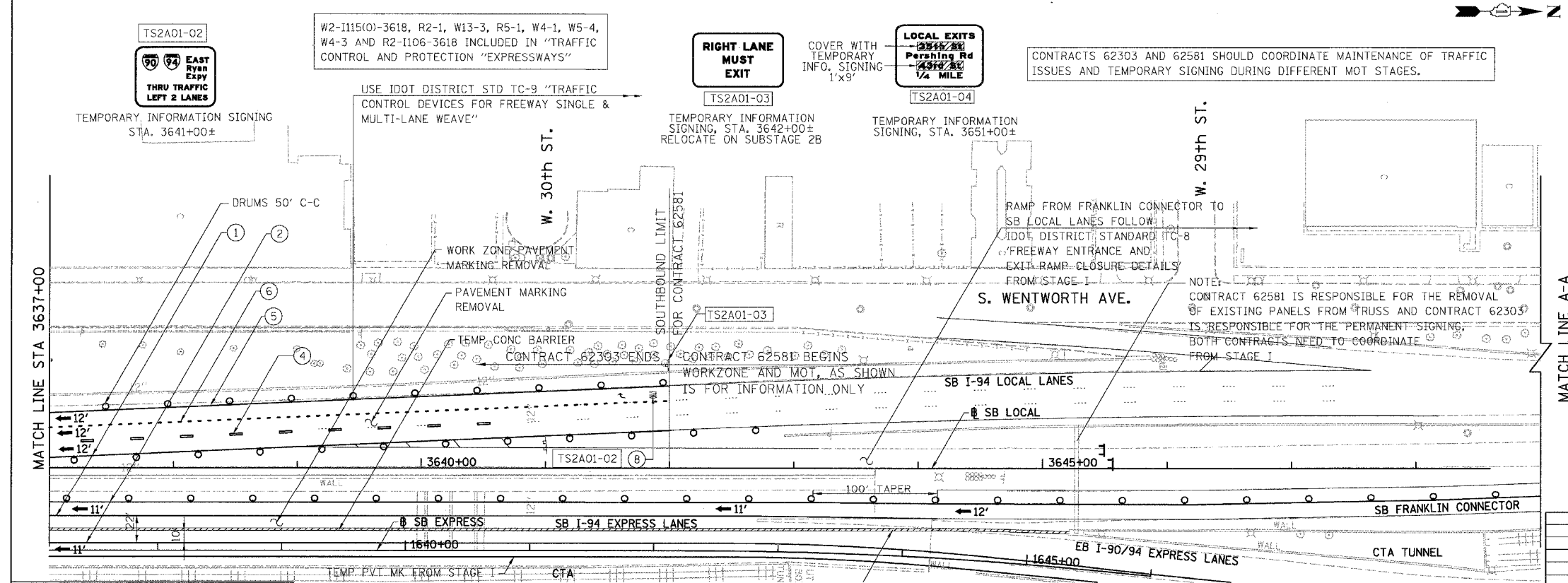

BOWMAN, BARRETT & ASSOCIATES INC.  
CONSULTING ENGINEERS  
Chicago, Illinois  
312.228.0100  
www.bbainc.com

SB I-94/90 EXPRESS LANES TEMPORARY PAVEMENT MARKINGS WERE INSTALLED IN STAGE I TO STAGE 2, UNLESS OTHERWISE SPECIFIED IN SUBSTAGE 2A. CROSS OVER RAMP'S TEMPORARY PAVEMENT MARKINGS INSTALLED IN PREVIOUS STAGE TO REMAIN TO NEXT STAGE, UNLESS OTHERWISE SPECIFIED.

REVISIONS	NAME	DATE

MOT-2A01  
ILLINOIS DEPARTMENT OF TRANSPORTATION  
F.A.I. 94/90 (DAN RYAN EXPRESSWAY)  
GARFIELD BLVD TO 31ST STREET (SB LOCAL LANES)  
SUGGESTED STAGES OF CONSTRUCTION AND TRAFFIC CONTROL  
SUBSTAGE 2A  
SCALE: 1"=50'  
DATE: 06/09/06  
DRAWN BY: RA  
CHECKED BY: RS

12/01/05 PM 6/8/2006