

F.A.I. RTE.	SECTION	COUNTY	TOTAL SHEETS	SHEET NO.
90/94	*	COOK	588	155
STA. 3473+50		TO STA. 3478+25		
FED. ROAD DIST. NO. 1 ILLINOIS FED. AID PROJECT				
62303 • (2021-922 PT2 ETC 2324.6-1P) R-11				

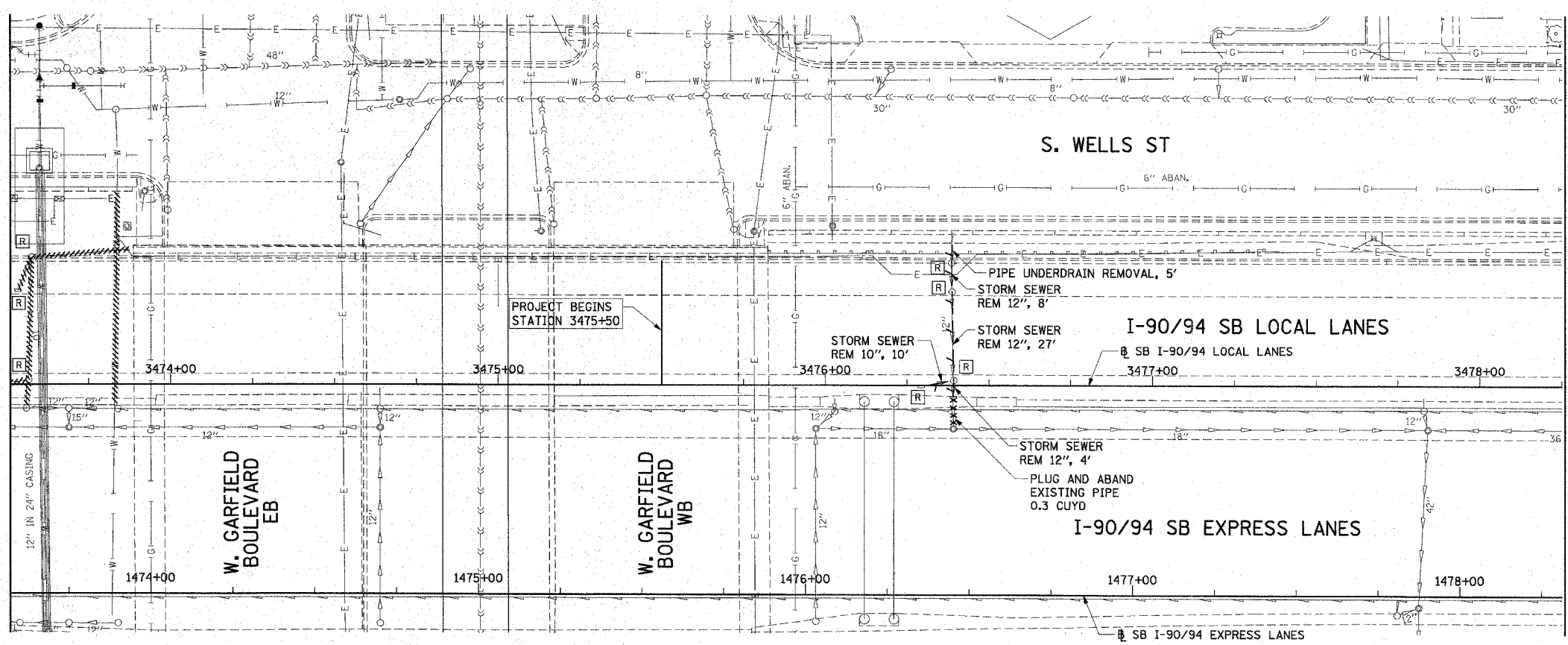

MATCH LINE STA 3478+25

EXISTING CONDITIONS AND REMOVAL
PROPOSED IMPROVEMENTS

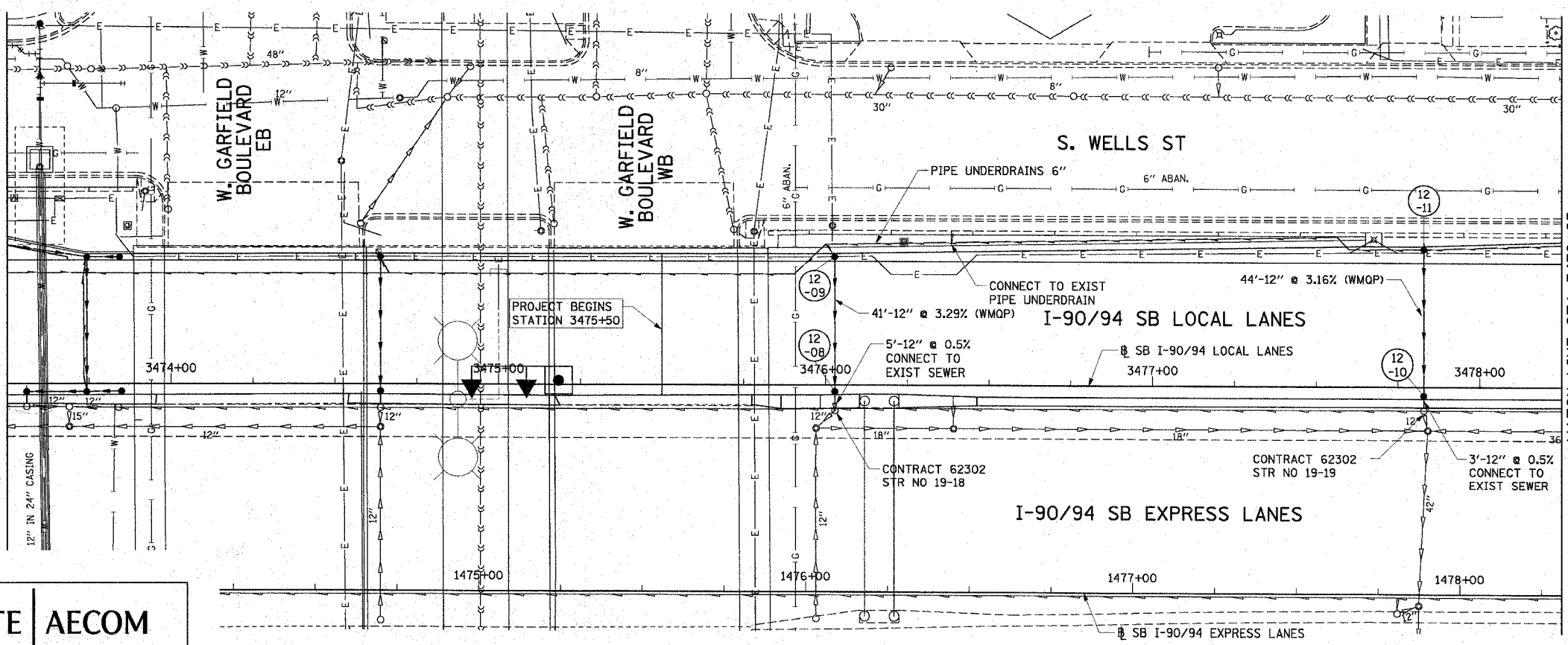

MATCH LINE STA 3478+25

- NOTES:
- SEE DRAINAGE SCHEDULES FOR STRUCTURE, PIPE AND UNDERDRAIN INFORMATION.
 - THE LOCATION OF DRAINAGE STRUCTURES AND PIPES CONSTRUCTED IN PREVIOUS CONTRACTS IS BASED OFF OF CONTRACT PLAN DRAWINGS. THE CONTRACTOR MUST VERIFY LIMITS OF PREVIOUS CONSTRUCTION IN THE FIELD.

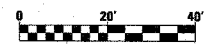

DU-12

REVISIONS	
NAME	DATE

ILLINOIS DEPARTMENT OF TRANSPORTATION
F.A.I. 90/94 (DAN RYAN EXPRESSWAY)
GARFIELD BLVD TO 31ST STREET (SB LOCAL LANES)

DRAINAGE AND UTILITY PLANS

SCALE: 1"=20'
DATE: June 9, 2006

DRAWN BY: MDD
CHECKED BY: MS

CTE | AECOM

P:\A0468\civil\1108-entrs\18 & 19\18\ventr\18\drainage and utility plan\du12.dwg

06/07/2006 04:40:04 PM