

F.A.I. RTE.	SECTION	COUNTY	TOTAL SHEETS	SHEET NO.
90/94		COOK	588	311
STA. 3506+00		TO STA. 3529+00		
FED. ROAD DIST. NO. 1 ILLINOIS FED. AID PROJECT				
62303 • (2021-922 PT2 ETC 2324.6-1P) R-11				

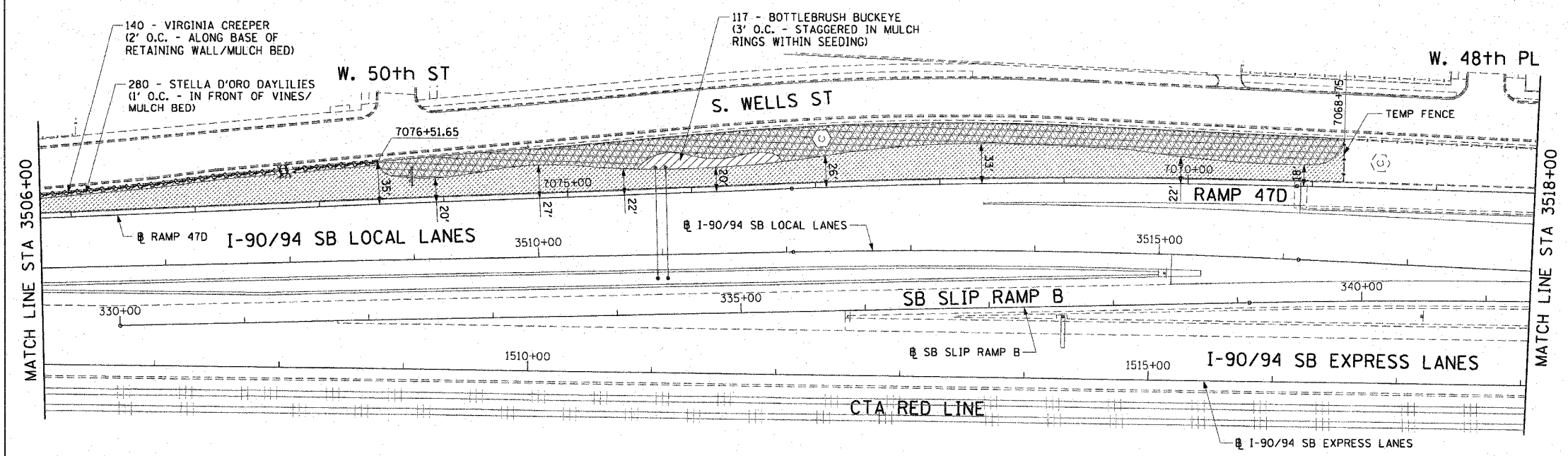

- LEGEND:**
- TOPSOIL FURNISH AND PLACE, 4" SEEDING, CLASS 2A EROSION CONTROL BLANKET
 - TOPSOIL FURNISH AND PLACE, 12" COMPOST FURNISH AND PLACE, 6" SEEDING, CLASS 2A EROSION CONTROL BLANKET
 - TOPSOIL FURNISH AND PLACE, 12" COMPOST FURNISH AND PLACE, 6" SEEDING, CLASS 4 (MODIFIED) SEEDING, CLASS 5A (MODIFIED) EROSION CONTROL BLANKET
 - TOPSOIL FURNISH AND PLACE, 12" COMPOST FURNISH AND PLACE, 12" SEEDING, CLASS 4 (MODIFIED) SEEDING, CLASS 5 (MODIFIED) EROSION CONTROL BLANKET
 - PERENNIAL PLANTS, IVY OR SHRUBS TOPSOIL FURNISH AND PLACE, 12" COMPOST FURNISH AND PLACE, 6" EROSION CONTROL BLANKET
 - VINE

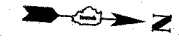
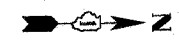
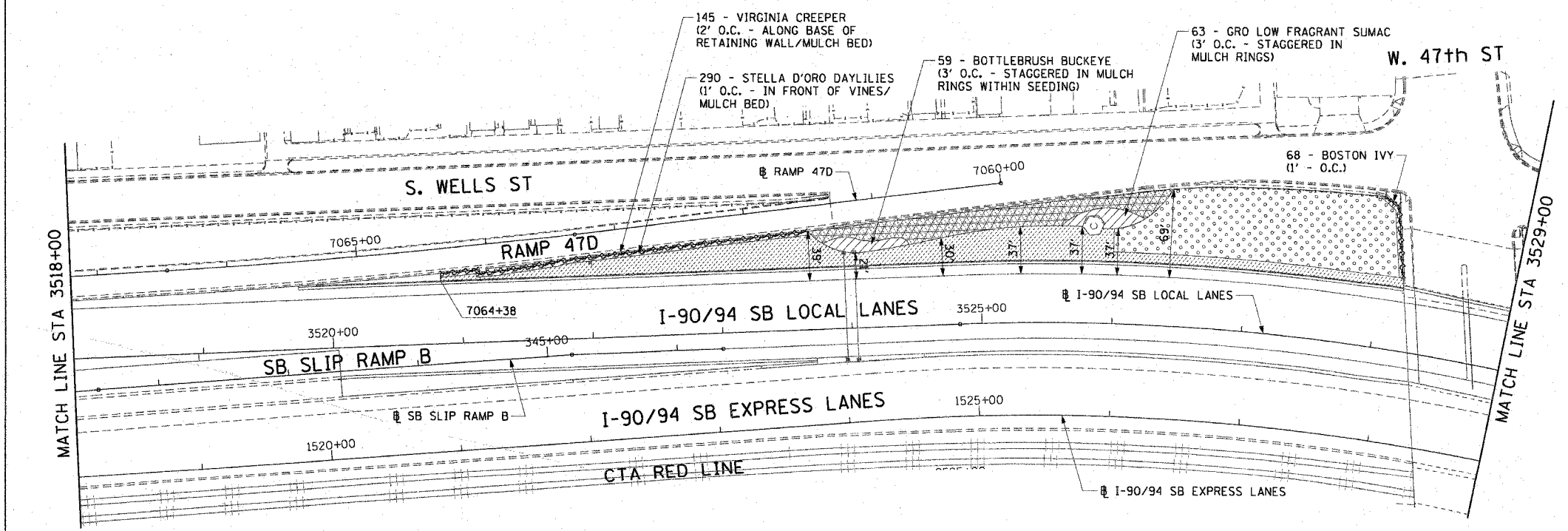

- NOTES:**
1. THE DIMENSIONS SHOWN ON THE PLANS SHALL BE USED AS A GUIDE TO LAY OUT THE SPECIFIED RESTORATION AREAS.
 2. IN THE AREA OF BUSHES TYPE 4 (MOD) AND 5A (MOD) SEEDING SHOULD BE USED.

CTE | AECOM

REVISIONS	
NAME	DATE

LA-03

ILLINOIS DEPARTMENT OF TRANSPORTATION
F.A.I. 90/94 (DAN RYAN EXPRESSWAY)
GARFIELD BLVD TO 31ST STREET (SB LOCAL LANES)

**LANDSCAPING PLANS
AND DETAILS**

SCALE: 1"=50'
DATE: June 9, 2006

DRAWN BY: PHP
CHECKED BY: RMG

F:\P\0468\CIVIL\CONTR 16 & 19\Site\19_Landscaping\LA90032A.dwg 6/7/2006 12:44:17 PM