

F.A.I. RTE.	SECTION	COUNTY	TOTAL SHEETS	SHEET NO.
90/94		COOK	588	318
STA. 1471+00.00 TO STA. 1482+50.00				
FED. ROAD DIST. NO. 1		ILLINOIS FED. AID PROJECT		
62303		• (2021-922 PT2 ETC 2324.6-1P) R-11		

**NOTES:**

- SEE DRAWINGS EI-100 AND EI-101 FOR ELECTRICAL SYMBOLS AND ABBREVIATIONS.
- SEE DRAWING EI-104 FOR TYPICAL HANDHOLE INSTALLATION DETAILS.
- THE CONTRACTOR SHALL INSTALL HH3309 IN THE APPROXIMATE LOCATION SHOWN AND EXTEND EXISTING CONDUIT ENCASED DUCTS INSTALLED IN CONTRACT NO. 62586 TO THE NEW HH. SEE DRAWINGS IN EI-108 AND EI-109 FOR THE INSTALLATION DETAILS.
- SEE DRAWING EI-110 FOR AN ENLARGED PLAN FOR THE WORK ASSOCIATED WITH DMS-31L AND DMS-31E.
- UNLESS NOTED OTHERWISE, ALL ITEMS AND WORK SHOWN IN HEAVY LINE WEIGHT ON THIS DRAWING ARE PROPOSED NEW ITEMS AND WORK.

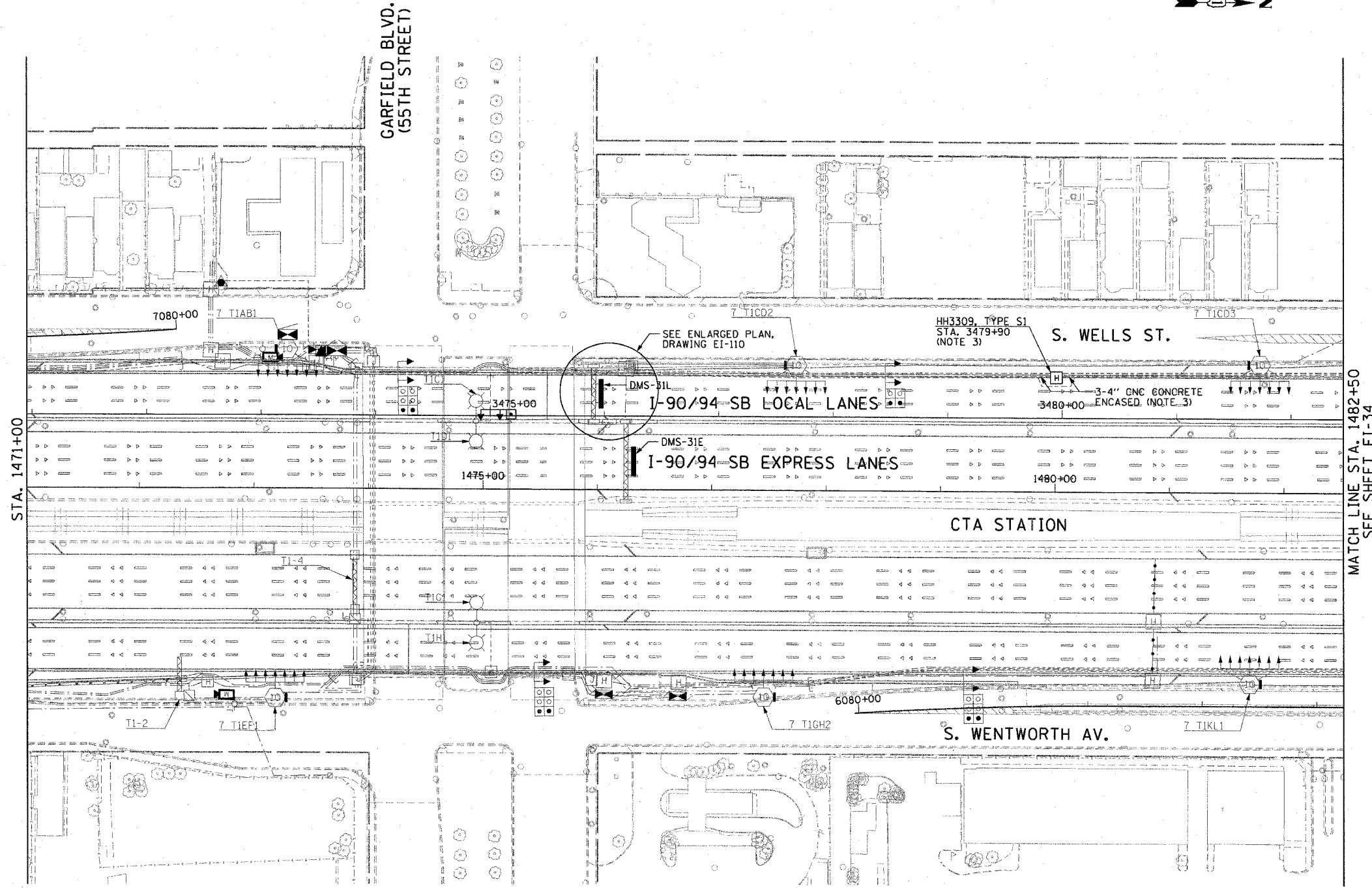
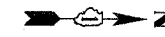

MATCH LINE STA. 1482+50  
SEE SHEET EI-34

CTE | AECOM

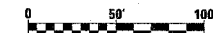

EI-33

REVISIONS	
NAME	DATE

ILLINOIS DEPARTMENT OF TRANSPORTATION  
 F.A.I. 90/94 (DAN RYAN EXPRESSWAY)  
 GARFIELD BLVD TO 31ST STREET (SB LOCAL LANES)  
**ELECTRICAL INFRASTRUCTURE PLAN**

SCALE: 1"=50'  
 DATE: June 9, 2006

DRAWN BY: HAR  
 CHECKED BY: JPC

06/07/2006 09:59:07 AM