

F.A.I.	SECTION	COUNTY	TOTAL SHEETS	SHEET NO.
94/90	*	COOK	344	98
STA.		TO STA.		
62301		*12021-922 PT2 ETC 2324.6-1P) R-10		

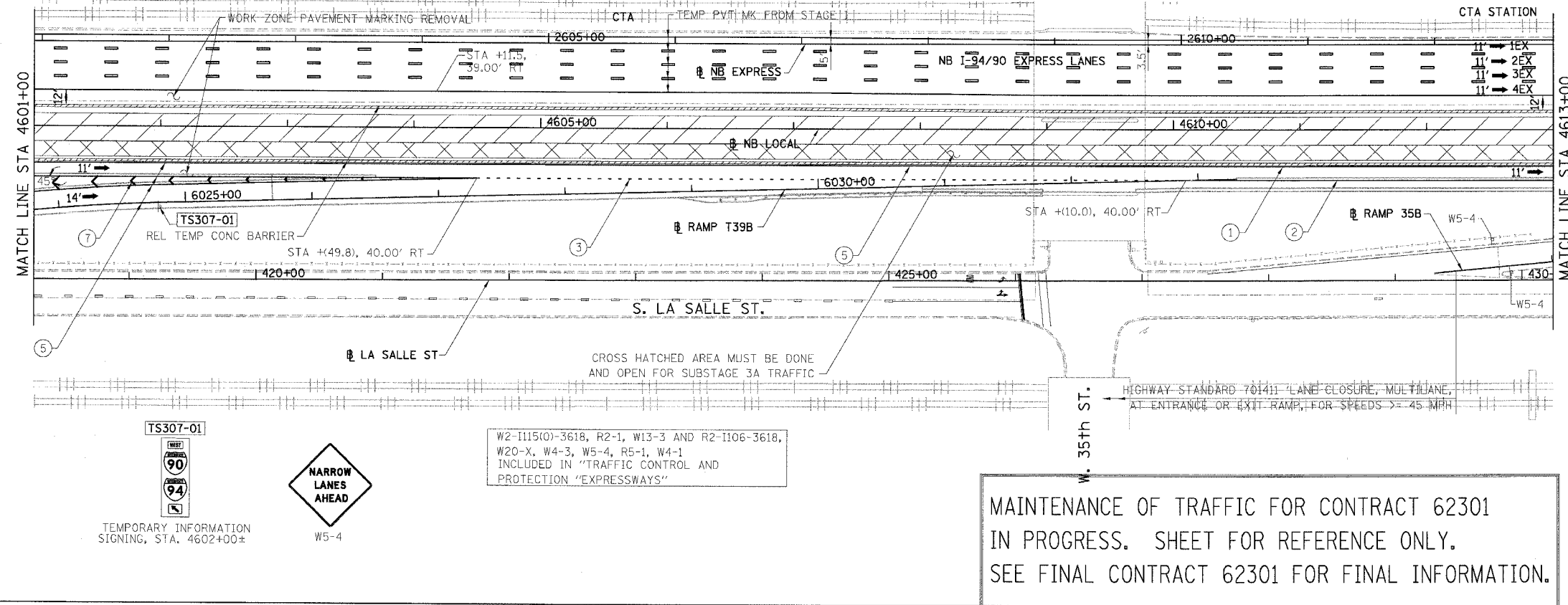

**MAINTENANCE OF TRAFFIC FOR CONTRACT 62301  
 IN PROGRESS. SHEET FOR REFERENCE ONLY.  
 SEE FINAL CONTRACT 62301 FOR FINAL INFORMATION.**

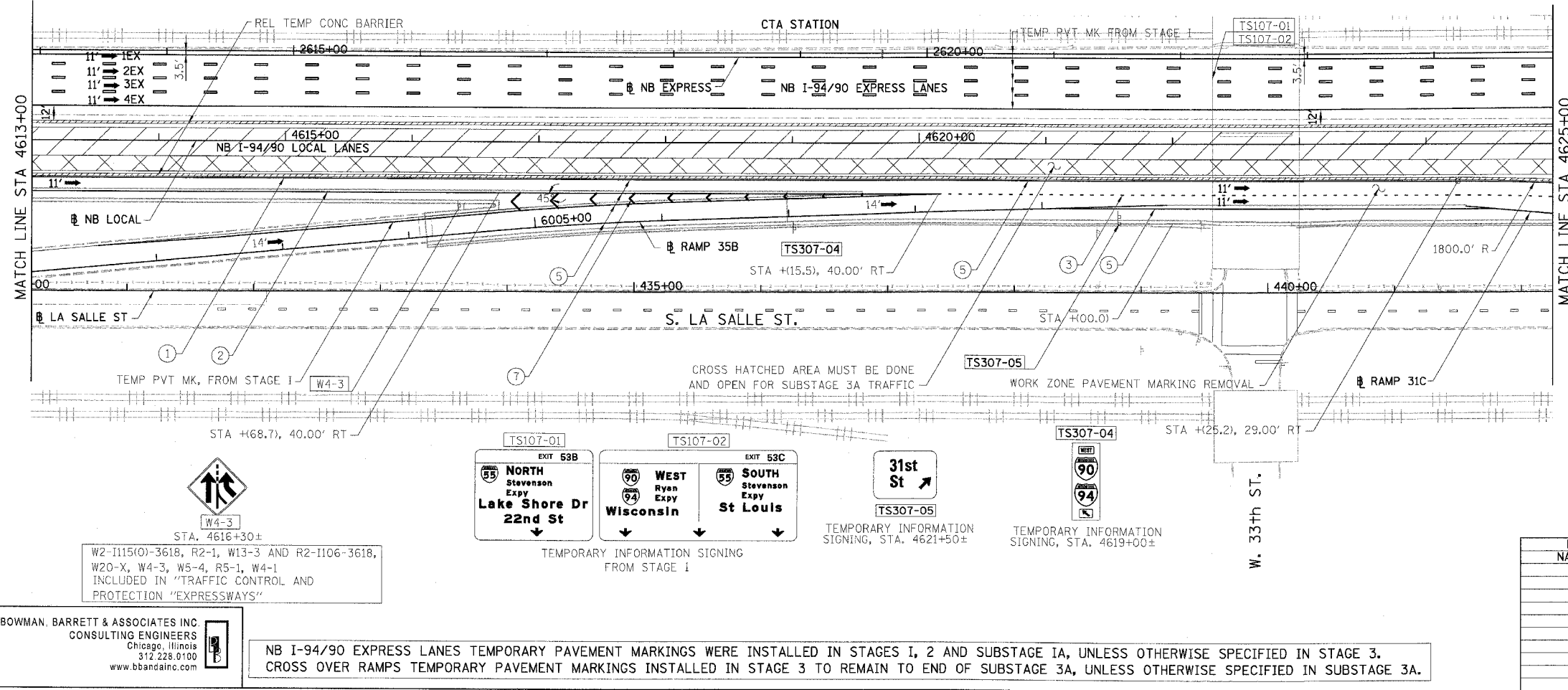

**BOWMAN, BARRETT & ASSOCIATES INC  
 CONSULTING ENGINEERS**  
 Chicago, Illinois  
 312.228.0100  
 www.bbainc.com

NB I-94/90 EXPRESS LANES TEMPORARY PAVEMENT MARKINGS WERE INSTALLED IN STAGES 1, 2 AND SUBSTAGE 1A, UNLESS OTHERWISE SPECIFIED IN STAGE 3.  
 CROSS OVER RAMPS TEMPORARY PAVEMENT MARKINGS INSTALLED IN STAGE 3 TO REMAIN TO END OF SUBSTAGE 3A, UNLESS OTHERWISE SPECIFIED IN SUBSTAGE 3A.

REVISIONS	
NAME	DATE

ILLINOIS DEPARTMENT OF TRANSPORTATION  
**F.A.I. 94/90 (DAN RYAN EXPRESSWAY)**  
 GARFIELD BLVD TO 31ST STREET (NB LOCAL LANES)  
 SUGGESTED STAGES OF CONSTRUCTION  
 AND TRAFFIC CONTROL  
 STAGE 3

SCALE: 1"=50'  
 DATE: 5/12/2006  
 DRAWN BY: RA  
 CHECKED BY: RS