

# S. CANALPORT AVE. ENTRANCE RAMP TO EB I-94/90 CLOSED

F.A.I.	SECTION	COUNTY	TOTAL SHEETS	SHEET NO.
94/90	2003-029	COOK	344	120
STA.		TO STA.		
FED. ROAD DIST. NO.		ILLINOIS FED. AID PROJECT		

62581

M6-2 (24x12)		Canalport Entrance To I-90/94 CLOSED FOLLOW DETOUR
M6-3 (24x12)		
M6-1 (24x12)		Canalport Ave
M5-1 (24x12)		
M4-5 (24x12)		
M3-2 (24x12)		
M4-8 (30x15)		
M4-8a (24x18)		
M3-3 (24x12)		
M1-1 (24x24)		
(36x12)		
M4-4 (24x12)		M3-1 (24x12) NORTH

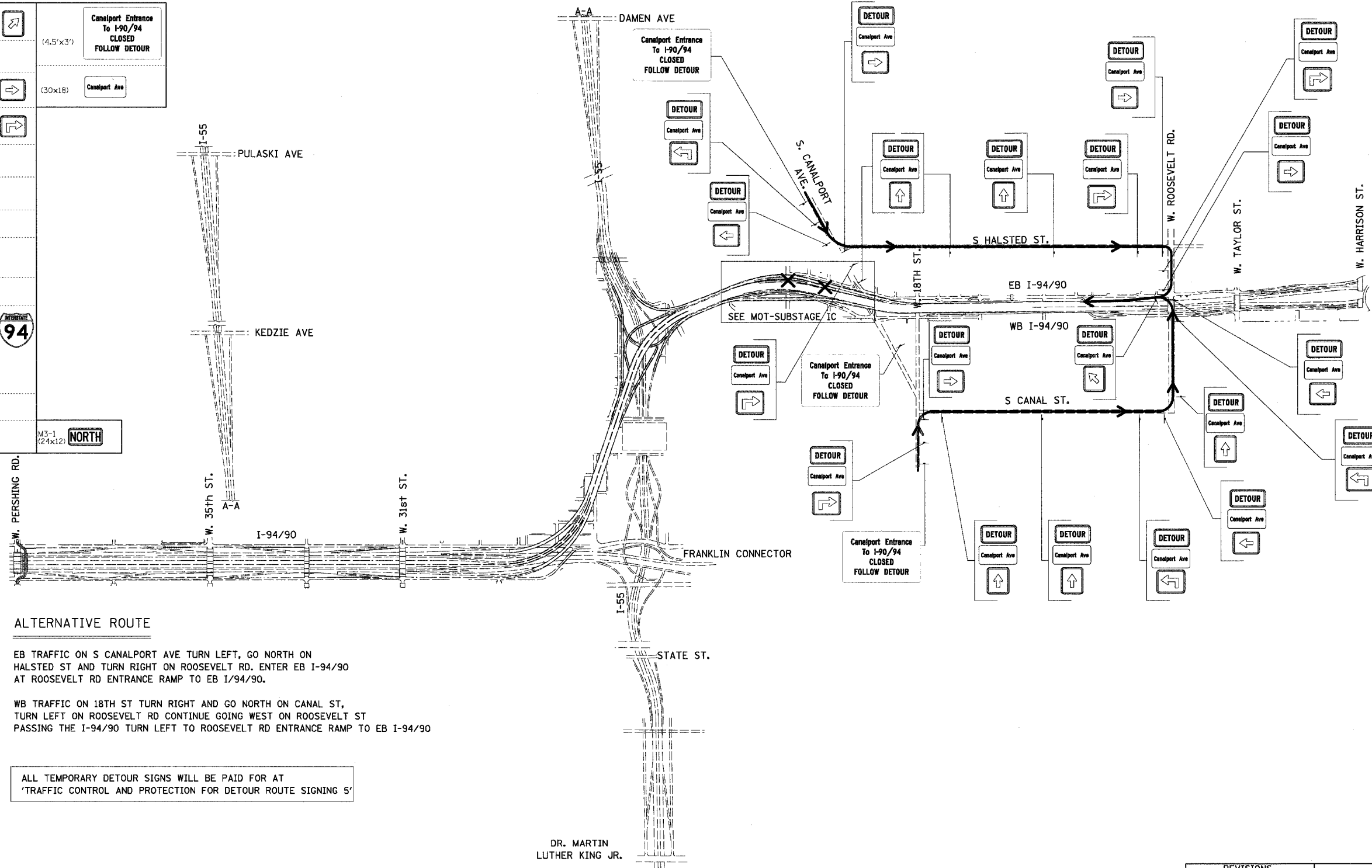

## ALTERNATIVE ROUTE

EB TRAFFIC ON S CANALPORT AVE TURN LEFT, GO NORTH ON HALSTED ST AND TURN RIGHT ON ROOSEVELT RD. ENTER EB I-94/90 AT ROOSEVELT RD ENTRANCE RAMP TO EB I-94/90.

WB TRAFFIC ON 18TH ST TURN RIGHT AND GO NORTH ON CANAL ST, TURN LEFT ON ROOSEVELT RD CONTINUE GOING WEST ON ROOSEVELT ST PASSING THE I-94/90 TURN LEFT TO ROOSEVELT RD ENTRANCE RAMP TO EB I-94/90

ALL TEMPORARY DETOUR SIGNS WILL BE PAID FOR AT 'TRAFFIC CONTROL AND PROTECTION FOR DETOUR ROUTE SIGNING 5'

DR. MARTIN LUTHER KING JR.

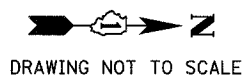

BOWMAN, BARRETT & ASSOCIATES INC.  
CONSULTING ENGINEERS  
Chicago, Illinois  
312.228.0100  
www.bbainc.com

REVISIONS	
NAME	DATE

ILLINOIS DEPARTMENT OF TRANSPORTATION  
F.A.I. 94/90 (DAN RYAN EXPRESSWAY)  
SB DAN RYAN ELEVATED BRIDGE  
REPAIR FROM 15TH TO 28TH STREETS  
DETOUR ROUTE FOR CANALPORT AVE  
TO EB I-94/90

SCALE: = NTS  
DATE: 4/14/2006

DRAWN BY: RA  
CHECKED BY: RS

DTR-05

4/14/2006 9:23:28 AM