

F.A.I.	SECTION	COUNTY	TOTAL SHEETS	SHEET NO.
94/90	2003-0291	COOK	344	167
STA.	TO STA.			
FED. ROAD DIST. NO.	ILLINOIS	FED. AID PROJECT		
62581				

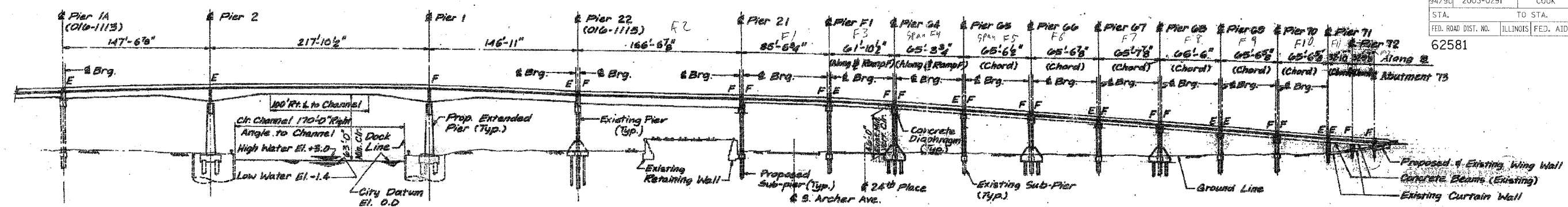

**ELEVATION - WEST RAMP & RAMP F**

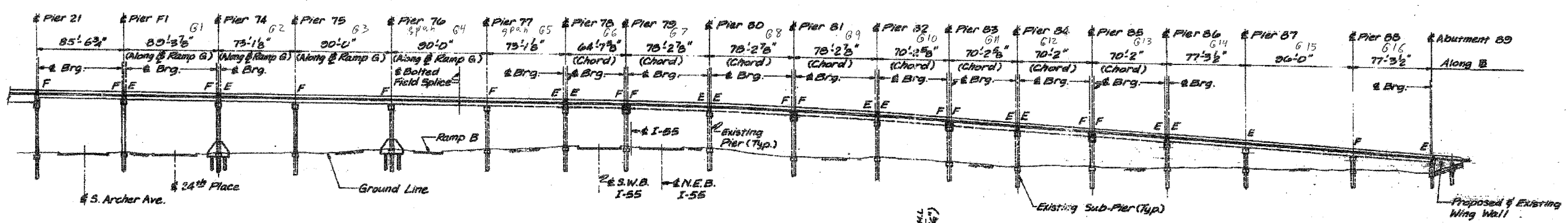

**ELEVATION - RAMP G**

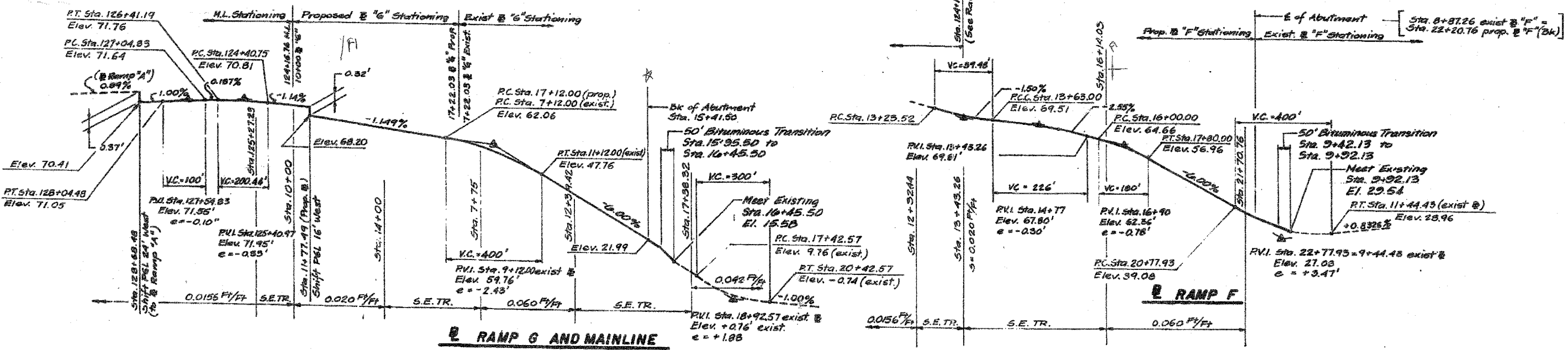

REVISIONS		ILLINOIS DEPARTMENT OF TRANSPORTATION	
NAME	DATE	F.A.I. 94/90 (DAN RYAN EXPRESSWAY)	
		SB DAN RYAN ELEVATED BRIDGE	
		REPAIR FROM 15TH TO 28TH STREETS	
		ELEVATION & PROFILE	
		SN 016-1050, 1062 & 1066	
		SCALE: NTS	DRAWN BY: MTR
		DATE: 5/25/2006	CHECKED BY: BLU

BOWMAN, BARRETT & ASSOCIATES INC.  
CONSULTING ENGINEERS  
Chicago, Illinois  
312.228.0100  
www.bbainsc.com

For Notes and Legend See Sheet 161

M:\9400\9400\BRIDGE\9400\9400-21\9400-21.dwg 5/23/2006 2:40:00 PM