

F.A.P. RTE.	SECTION	COUNTY	TOTAL SHEETS	SHEET NO.
541	2004-121 TS	LAKE	19	7
STA.		TO STA.		
FED. ROAD DIST. NO.		ILLINOIS	FED. AID PROJECT	
CONTRACT NO. 62887				

RESTORATION OF WORK AREA. RESTORATION OF THE TRAFFIC SIGNAL WORK AREA SHALL BE INCLUDED IN THE RELATED PAY ITEMS SUCH AS FOUNDATION, CONDUIT, HANDHOLE, TRENCH AND BACKFILL, ETC. ALL ROADWAY SURFACES SUCH AS SHOULDERS, MEDIANS, SIDEWALKS, PAVEMENT, ETC. SHALL BE REPLACED IN KIND. ALL DAMAGE TO MOWED LAWNS SHALL BE REPLACED WITH AN APPROVED SOD AND ALL DAMAGE TO UNMOWED FIELDS SHALL BE SEEDED. RESTORATION OF THE WORK AREA SHALL BE INCIDENTAL TO THE CONTRACT WITHOUT ANY EXTRA COMPENSATION ALLOWED TO THE CONTRACTOR.

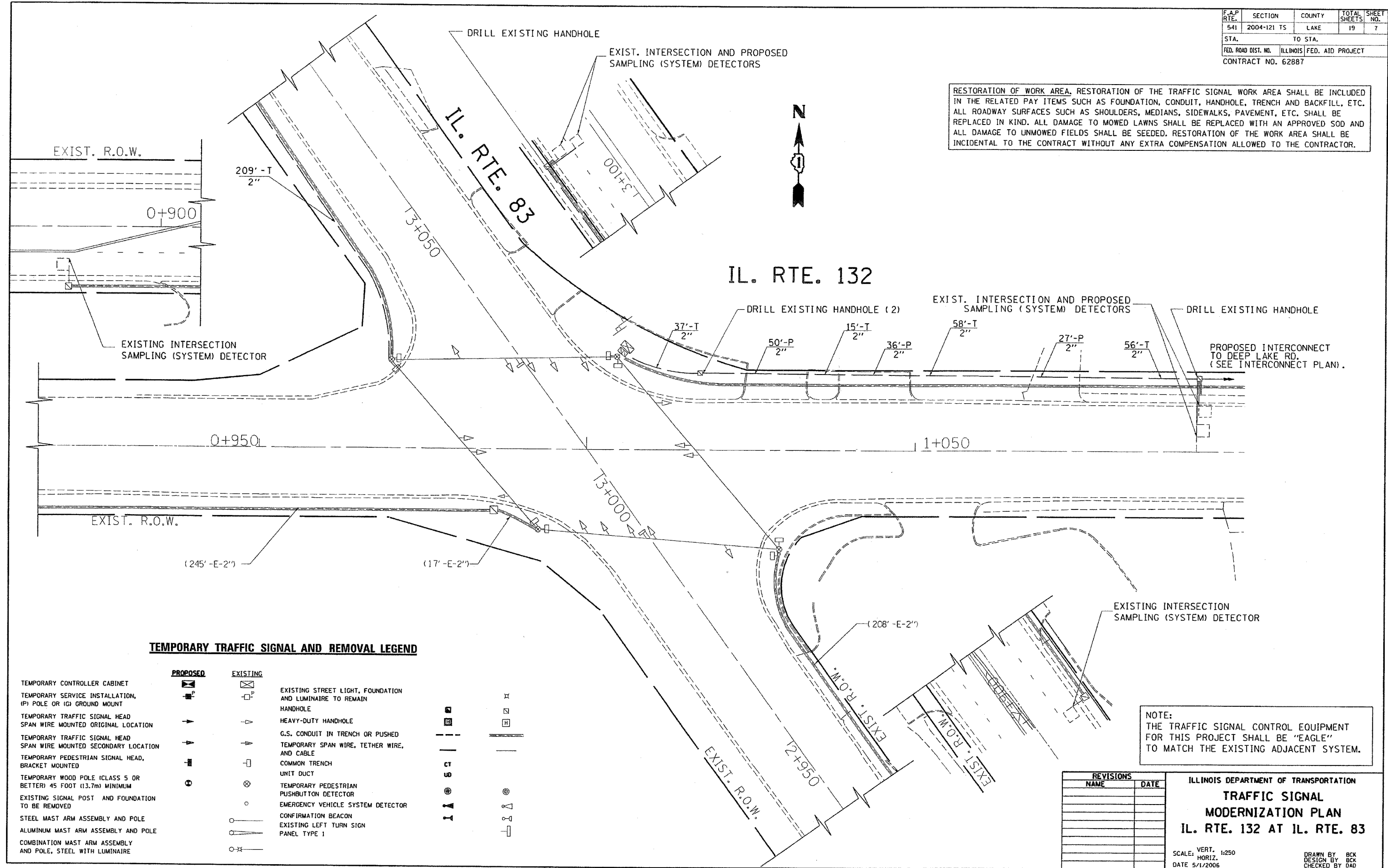

TEMPORARY TRAFFIC SIGNAL AND REMOVAL LEGEND

PROPOSED	EXISTING	DESCRIPTION
[Symbol]	[Symbol]	EXISTING STREET LIGHT, FOUNDATION AND LUMINAIRE TO REMAIN
[Symbol]	[Symbol]	EXISTING INTERSECTION SAMPLING (SYSTEM) DETECTOR
[Symbol]	[Symbol]	EXISTING SIGNAL POST AND FOUNDATION TO BE REMOVED
[Symbol]	[Symbol]	EXISTING LEFT TURN SIGN PANEL TYPE 1
[Symbol]	[Symbol]	EXISTING HEAVY-DUTY HANDHOLE
[Symbol]	[Symbol]	EXISTING G.S. CONDUIT IN TRENCH OR PUSHED
[Symbol]	[Symbol]	EXISTING COMMON TRENCH
[Symbol]	[Symbol]	EXISTING UNIT DUCT
[Symbol]	[Symbol]	EXISTING TEMPORARY PEDESTRIAN PUSHBUTTON DETECTOR
[Symbol]	[Symbol]	EXISTING EMERGENCY VEHICLE SYSTEM DETECTOR
[Symbol]	[Symbol]	EXISTING CONFIRMATION BEACON
[Symbol]	[Symbol]	EXISTING TEMPORARY SERVICE INSTALLATION, (P) POLE OR (G) GROUND MOUNT
[Symbol]	[Symbol]	EXISTING TEMPORARY TRAFFIC SIGNAL HEAD SPAN WIRE MOUNTED ORIGINAL LOCATION
[Symbol]	[Symbol]	EXISTING TEMPORARY TRAFFIC SIGNAL HEAD SPAN WIRE MOUNTED SECONDARY LOCATION
[Symbol]	[Symbol]	EXISTING TEMPORARY PEDESTRIAN SIGNAL HEAD, BRACKET MOUNTED
[Symbol]	[Symbol]	EXISTING TEMPORARY WOOD POLE (CLASS 5 OR BETTER) 45 FOOT (13.7m) MINIMUM
[Symbol]	[Symbol]	EXISTING STEEL MAST ARM ASSEMBLY AND POLE
[Symbol]	[Symbol]	EXISTING ALUMINUM MAST ARM ASSEMBLY AND POLE
[Symbol]	[Symbol]	EXISTING COMBINATION MAST ARM ASSEMBLY AND POLE, STEEL WITH LUMINAIRE

REVISIONS	
NAME	DATE

NOTE: THE TRAFFIC SIGNAL CONTROL EQUIPMENT FOR THIS PROJECT SHALL BE "EAGLE" TO MATCH THE EXISTING ADJACENT SYSTEM.

ILLINOIS DEPARTMENT OF TRANSPORTATION
**TRAFFIC SIGNAL
 MODERNIZATION PLAN**
 IL. RTE. 132 AT IL. RTE. 83

SCALE: VERT. 1/250
 HORIZ. 1/250
 DATE 5/1/2006
 DRAWN BY BCK
 DESIGN BY BCK
 CHECKED BY DAD