

PLAN	DATE	BY
SUBMITTED	11/11/06	AMN
DESIGNED	11/11/06	AMN
CHECKED	11/11/06	AMN
IN CHARGE	11/11/06	AMN
NO.	11/11/06	AMN

PROFILE	DATE	BY
SUBMITTED	11/11/06	AMN
DESIGNED	11/11/06	AMN
CHECKED	11/11/06	AMN
IN CHARGE	11/11/06	AMN
NO.	11/11/06	AMN

3/30/2006
c:\pro\ectrs\ep02804\consul\pp-126-60-66.dwg

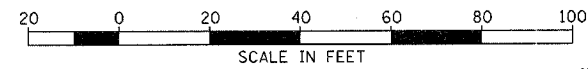

F.A.P. SECTION COUNTY TOTAL SHEETS SHEET NO.
311 1 N & TS KENDALL 174 38
STA. 76+00 TO STA. 82+00
FED. ROAD DIST. NO. 7 ILLINOIS FED. AID PROJECT

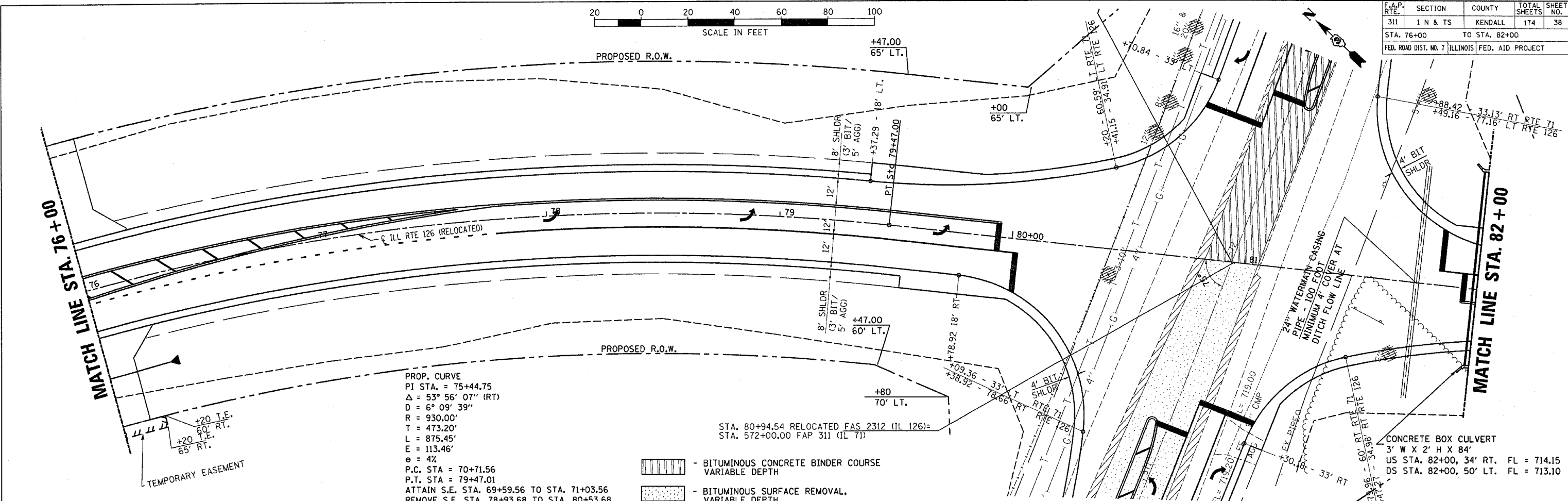

PROP. CURVE
 PI STA. = 75+44.75
 $\Delta = 53^\circ 56' 07''$ (RT)
 $D = 6^\circ 09' 39''$
 $R = 930.00'$
 $T = 473.20'$
 $L = 875.45'$
 $E = 113.46'$
 $e = 4\%$
 P.C. STA = 70+71.56
 P.T. STA = 79+47.01
 ATTAIN S.E. STA. 69+59.56 TO STA. 71+03.56
 REMOVE S.E. STA. 78+93.68 TO STA. 80+53.68

- BITUMINOUS CONCRETE BINDER COURSE VARIABLE DEPTH
- BITUMINOUS SURFACE REMOVAL, VARIABLE DEPTH

STA. 80+94.54 RELOCATED FAS 2312 (IL 126) =
 STA. 572+00.00 FAP 311 (IL 71)

BENCHMARK #400 "x" ON N.E. BOLT OF TRAFFIC SIGNAL BASE AT S.W. CORNER OF RTE 71 AND RTE 126. STA. 566+31.59.6' RT. ELEV. = 727.99

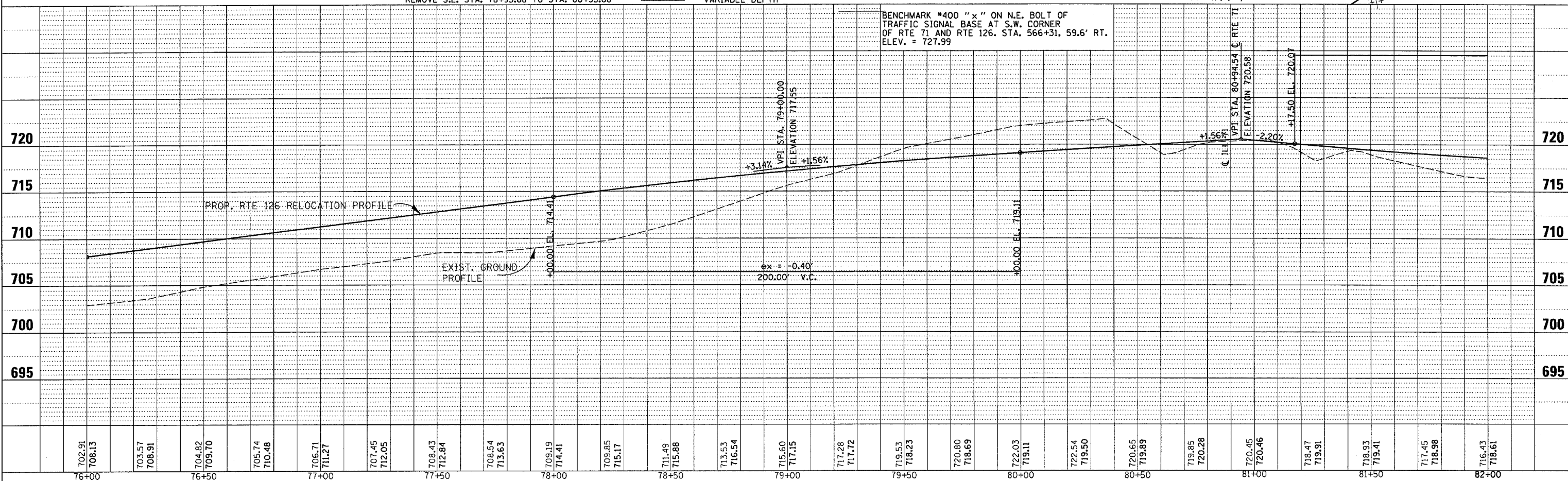

**FAS 2312 (IL 126) RELOCATED
 STA. 76+00 to STA. 82+00**