

| F.A.I. RTE.                  | SECTION    | COUNTY  | TOTAL SHEETS         | SHEET NO. |
|------------------------------|------------|---------|----------------------|-----------|
| 39                           | (50-4B)1-4 | LASALLE | 17                   | 10        |
| FED. ROAD DIST. NO. ILLINOIS |            |         | NON-FED. AID PROJECT |           |

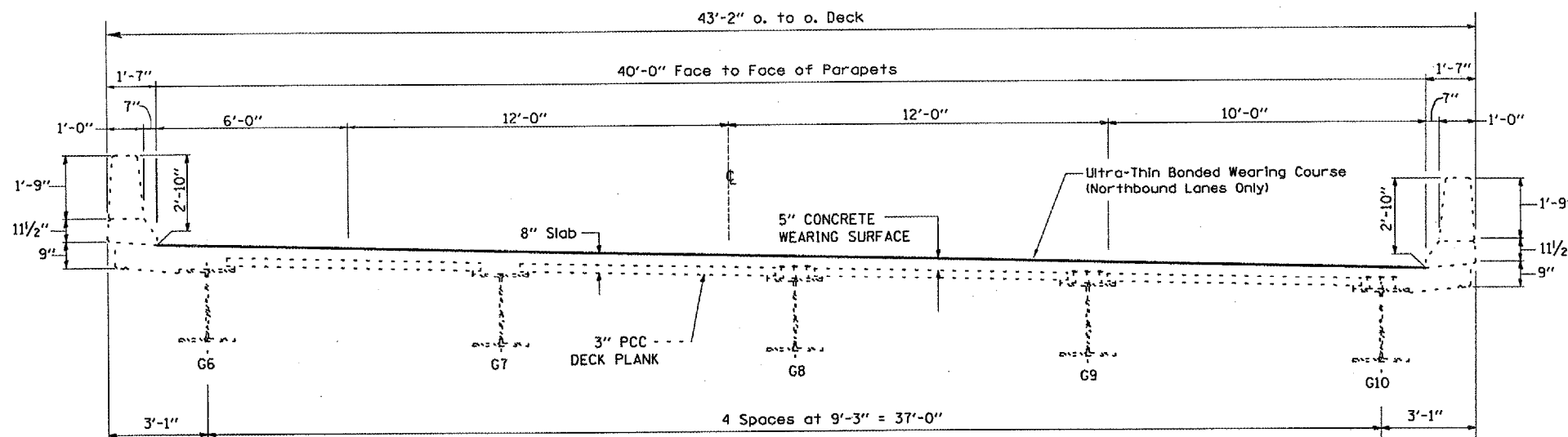

NEAR PIER

NEAR MIDSPAN

**CROSS SECTION**

SPANS 1 THRU 10 (NB & SB)  
 SPANS 15 THRU 17 (NB)  
 SPANS 42 THRU 43 (NB)  
 SPAN 44 (NB)

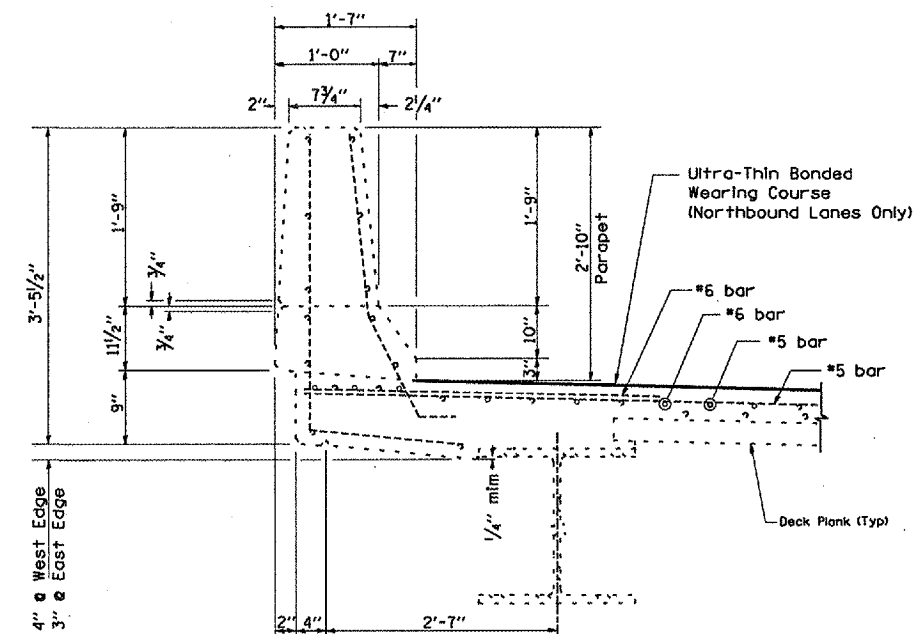

**SECTION THRU PARAPET**

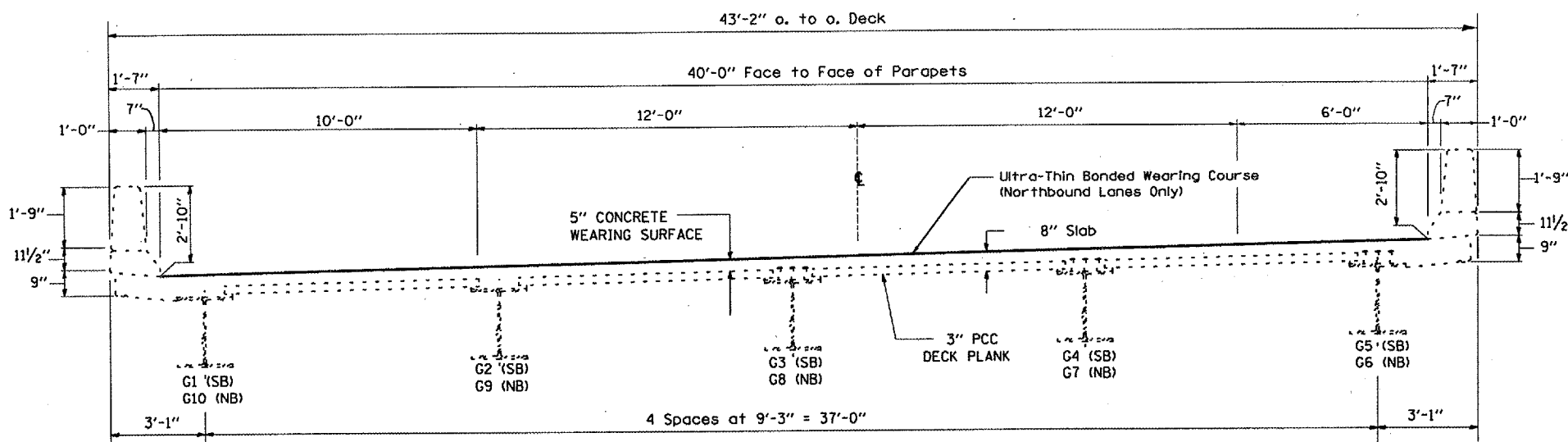

NEAR PIER

NEAR MIDSPAN

**CROSS SECTION**

SPANS 11 THRU 14 (NB & SB)  
 SPANS 15 THRU 17 (SB)  
 SPANS 18 THRU 34 (NB & SB)  
 SPANS 36 THRU 41 (NB & SB)  
 SPANS 42 THRU 43 (SB)  
 SPAN 44 (SB)

NOTE: LIMITS OF ULTRA-THIN BONDED WEARING COURSE SHALL BE AS FOLLOWS  
 WIDTH: FACE OF CURB TO FACE OF CURB  
 LENGTH: SOUTH ABUTMENT TO NORTH ABUTMENT ON THE NORTHBOUND LANES ONLY  
 EXCLUDING SPAN 35 (ARCH SPAN)

| REVISIONS |      |
|-----------|------|
| NAME      | DATE |
|           |      |
|           |      |
|           |      |
|           |      |
|           |      |
|           |      |
|           |      |
|           |      |
|           |      |
|           |      |

ILLINOIS DEPARTMENT OF TRANSPORTATION

**EXISTING TYPICAL SECTIONS**

I-39 OVER THE ILLINOIS RIVER  
 F.A.I. ROUTE 39  
 SECTION: (50-4B)1-4  
 LASALLE COUNTY  
 S.N. 050-0191

DATE: 05/01/2006 C:\PROJECTS\DESIGN\AN\ABE.LINCOLN\66678\DETAILS.DGN