

B.M.: BRASS PLATE IN S.E. WINGWALL; ELEV. = 100.00'

EXISTING STRUCTURE: SN 090-0061 IS A 33' WIDE x 63'-0" P.C.C. DECK BEAM SUPERSTRUCTURE WITH R.C. CLOSED ABUTMENTS.

ROUTE NO.	SECTION	COUNTY	TOTAL SHEETS	SHEET NO.
F.A.P. 693	*	TAZEWELL	34	24
FED. ROAD DIST. NO. 4		ILLINOIS	FED. AID PROJECT	

*(119B-3)I

INDEX OF SHEETS

SHEET NUMBER	DESCRIPTION
1	GENERAL PLAN AND ELEVATION, SUMMARY OF QUANTITIES, LOCATION MAP
2	R.O.W. PLAN
3	SITE GRADING PLAN
4	SITE DIMENSION PLAN
5	SITE PROFILE
6-8	CROSS SECTIONS

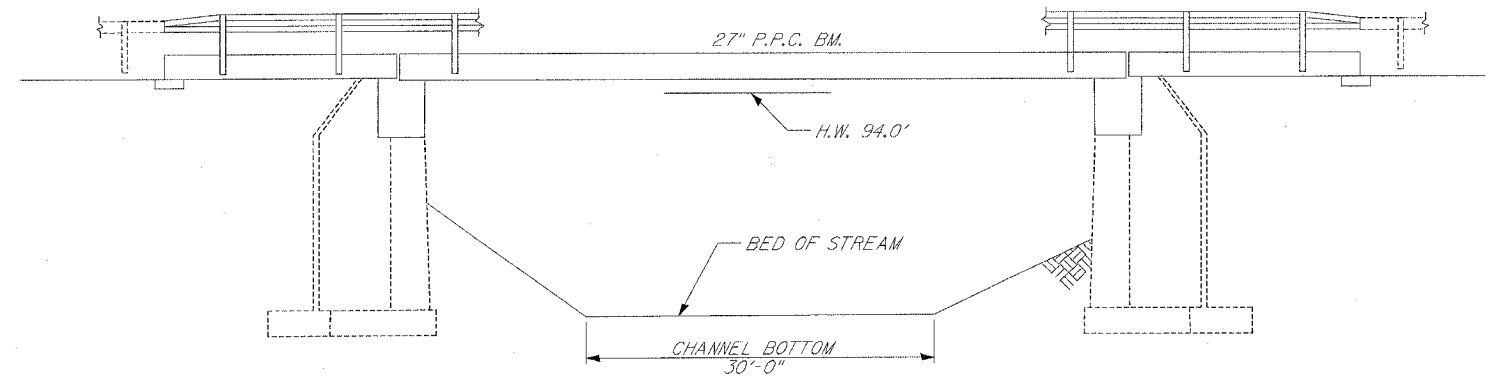

ELEVATION

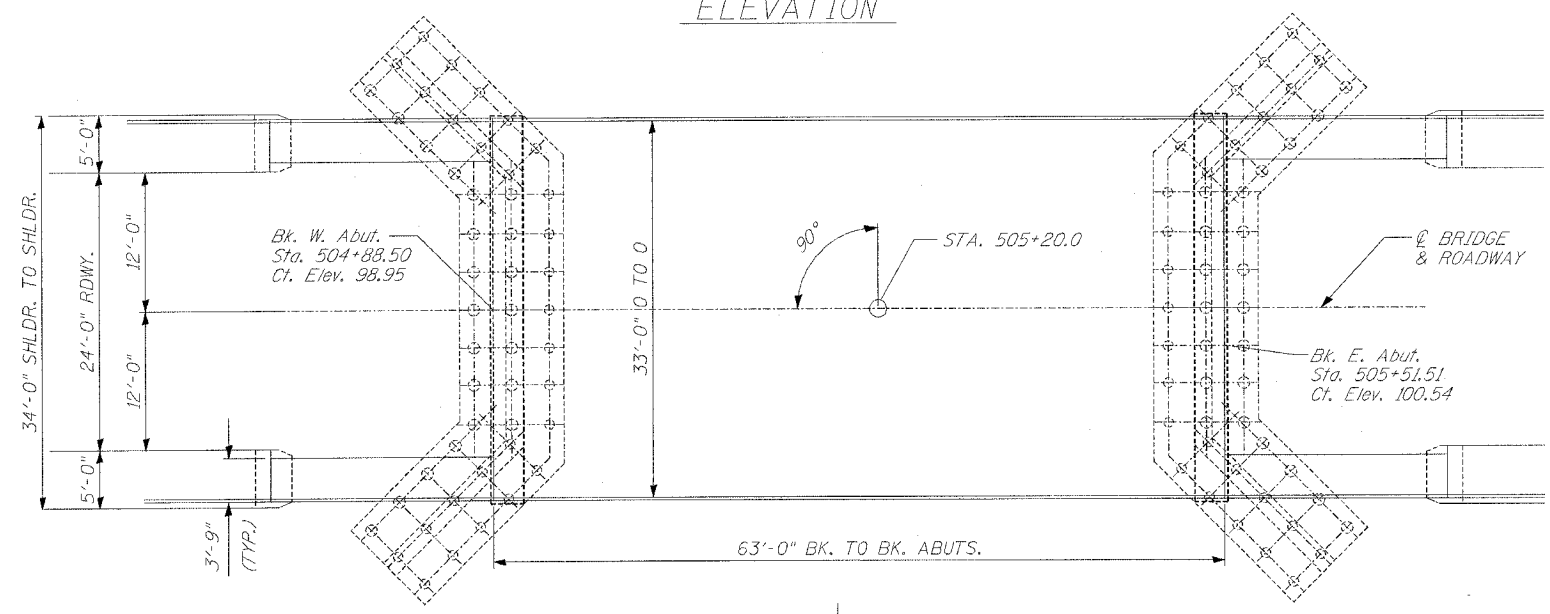

PLAN EXISTING BRIDGE

BILL OF MATERIALS

ITEM	UNIT	TOTAL
CHANNEL EXCAVATION	CU YD	416
STONE RIP-RAP, CLASS A5	TONS	1342
FILTER FABRIC FOR RIPRAP	SQ YD	712
GABIONS	CU YD	167
SUB-BASE GRANULAR MATERIAL, TYPE C	TONS	100
GABION ANCHOR STAKES	EACH	56
REM. AND REIN. STEEL PLATE BEAM GUARD RAIL, TY. A	FOOT	50
CONSTRUCTION ACCESS	L SUM	1
DEWATERING STRUCTURE NO. 1	EACH	1

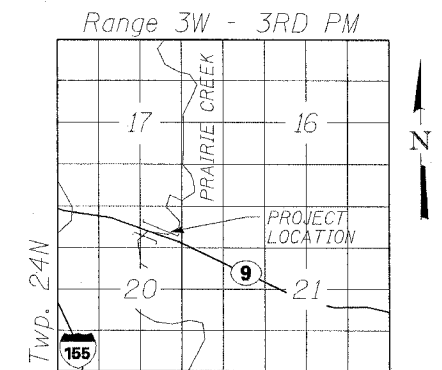

LOCATION SKETCH

WATERWAY/SCOUR INFORMATION

DESIGN FLOOD	100 YRS
DRAINAGE AREA	18.2 SQ MI
FLOW	3,426 CFS
FLOW DEPTH	8.0 FT
REQUIRED OPENING	555 SQ FT
PROVIDED OPENING	658 SQ FT
CONTRACTION SCOUR DEPTH	4 FT

REVISED
7-25-06
SHEET

ILLINOIS DEPARTMENT OF TRANSPORTATION
GENERAL PLAN & ELEVATION
S.N. 090-0061
F.A.P. 693 (IL 9)
OVER PRAIRIE CREEK
TAZEWELL COUNTY