

DESIGNER: CLARK JONES  
PHONE NO: (309) 671-3452

**INDEX OF SHEETS:**

1. COVER SHEET
- 2-3. COMMITMENTS & GENERAL NOTES
- 4-6. SUMMARY OF QUANTITIES
7. TYPICAL SECTIONS
8. QUANTITIES NOT OTHERWISE SHOWN
9. GENERAL SITE PLAN
10. BUTT JOINT DETAIL
11. TRAFFIC STAGING & CONTROL
12. PLAN AND ELEVATION
13. STAGE CONSTRUCTION DETAIL
- 14-22. BRIDGE REPAIR DETAILS
- 23-30B SCOUR MITIGATION PLAN

**STANDARDS REQUIRED:**

- 420401-05 701101-01 702001-06  
 515001-02 701106-01 704001-02  
 630001-06 701201-02 780001-01  
 631031-05 701306-01 781001-02  
 631032-02 701321-08

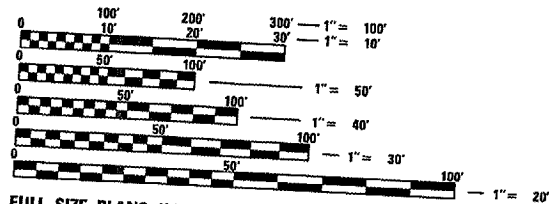

FULL SIZE PLANS HAVE BEEN PREPARED USING STANDARD ENGINEERING SCALES. REDUCED SIZED PLANS WILL NOT CONFORM TO STANDARD SCALES. IN MAKING MEASUREMENTS ON REDUCED PLANS, THE ABOVE SCALES MAY BE USED.

J.U.L.I.E.  
 JOINT UTILITY LOCATION INFORMATION FOR EXCAVATION  
 1-800-892-0123

CONTRACT NO. 68484 CAT. NO. 033065-00D

STATE OF ILLINOIS  
 DEPARTMENT OF TRANSPORTATION  
 DIVISION OF HIGHWAYS

**PROPOSED  
 HIGHWAY PLANS**

FAP ROUTE 701 (IL 122)  
 SECTION (128 BR)I-1  
 TAZEWELL COUNTY  
 C-94-075-05

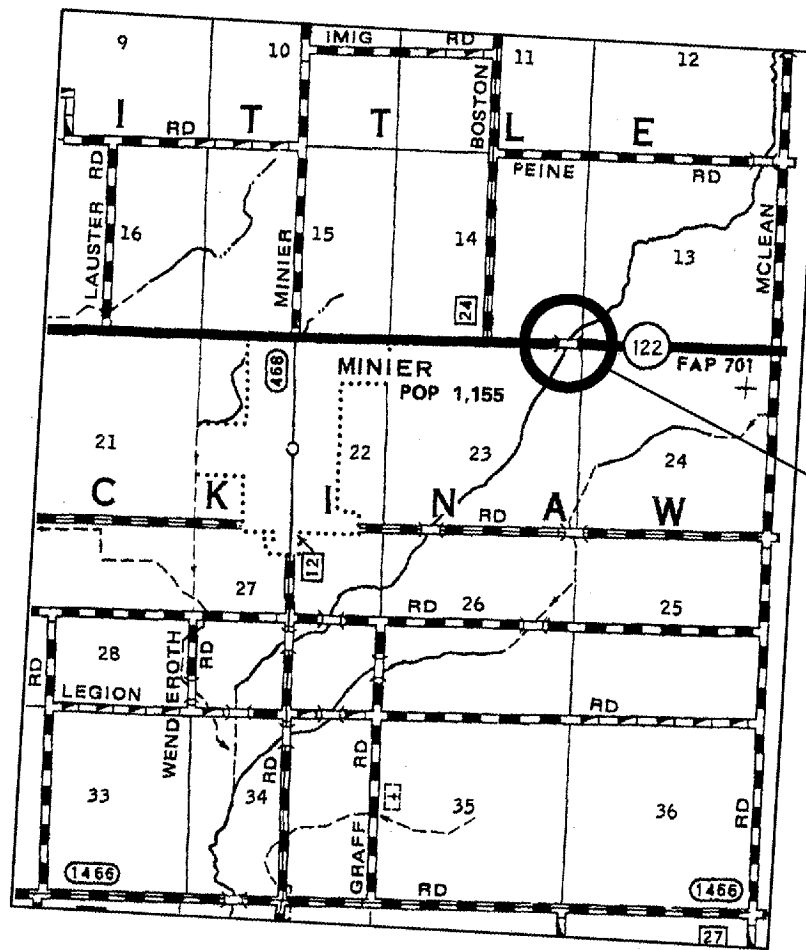

LOCATION MAP

F.A.P. RY.	SECTION	COUNTY	TOTAL SHEETS	SHEET NO.
701	(128BR)I-1	TAZEWELL	30	1

CONTRACT NO. 68484

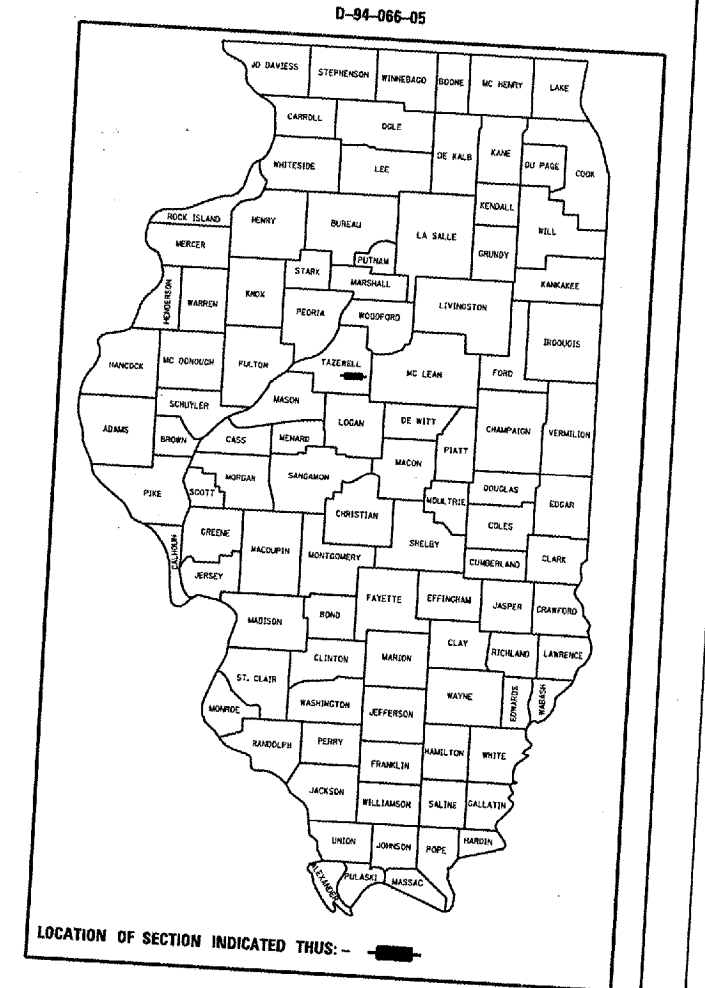

SCOUR MITIGATION AND DECK BEAM REPLACEMENT ON STRUCTURE CARRYING IL. 122 OVER SUGAR CREEK (SN. 090-0058), 1 MILE EAST OF MINIER

STATE OF ILLINOIS  
 DEPARTMENT OF TRANSPORTATION  
 DIVISION OF HIGHWAYS

SUBMITTED 3/31/06

*Joseph E. Crowe*  
 DEPUTY DIRECTOR OF HIGHWAYS, REGION ENGINEER  
 May 12, 2006

*Mike Jene*  
 ENGINEER OF DESIGN AND ENVIRONMENT  
 May 12, 2006

*Milton R. Sees, P.E.*  
 DIRECTOR OF HIGHWAYS, CHIEF ENGINEER

PRINTED BY THE AUTHORITY  
 OF THE STATE OF ILLINOIS

REVISI 7-21-06

PROJECT ENGINEER: JIM MILLER  
 PHONE NO: (309) 671-3451