

F.A.P. RTE.	SECTION	COUNTY	TOTAL SHEETS	SHEET NO.
332	48B	VERMILION	27	6

70462

SUMMARY OF QUANTITIES

CONTRACT NO. 70462

LOCATION OF WORK:

VERMILION COUNTY
RURAL
ROADWAY / STRUCTURE
IMPROVEMENTS
FAP 332
STA. 824+60
STA. 824+94
100% STATE
X028-2A

CONSTRUCTION TYPE CODE:

CODE NO	ITEM	UNIT	TOTAL QUANTITY	
* A2015990	TREE, FAGUS SYLVATICA, EUROPEAN BEECH, 1-1/2" BALLED AND BURLAPPED	EACH	2.0	2.0
20100110	TREE REMOVAL (6 TO 15 UNITS DIAMETER)	UNIT	100.0	100.0
20100310	TREE REMOVAL, SPECIAL (0 TO 15 UNITS DIAMETER)	UNIT	100.0	100.0
20100210	TREE REMOVAL (OVER 15 UNITS DIAMETER)	UNIT	50.0	50.0
20300100	CHANNEL EXCAVATION	CU YD	571	571
20900110	POROUS GRANULAR BACKFILL	CU YD	238.0	238.0
21301052	EXPLORATION TRENCH 52" DEPTH	FOOT	100.0	100.0
* 25000314	SEEDING, CLASS 4B	ACRE	0.5	0.5
* 25000400	NITROGEN FERTILIZER NUTRIENT	POUND	45.0	45.0
* 25000500	PHOSPHORUS FERTILIZER NUTRIENT	POUND	45.0	45.0
* 25000600	POTASSIUM FERTILIZER NUTRIENT	POUND	45.0	45.0
* 25100115	MULCH, METHOD 2	ACRE	0.5	0.5
28000250	TEMPORARY EROSION CONTROL SEEDING	POUND	50.0	50.0
28000300	TEMPORARY DITCH CHECKS	EACH	4.0	4.0
28000500	INLET AND PIPE PROTECTION	EACH	1.0	1.0
42400100	PORTLAND CEMENT CONCRETE SIDEWALK 4 INCH	SQ FT	170.0	170.0
44000500	COMBINATION CURB AND GUTTER REMOVAL	FOOT	68.0	68.0
44000600	SIDEWALK REMOVAL	SQ FT	170.0	170.0
44201759	CLASS D PATCHES, TYPE IV, 9 INCH	SQ YD	159.0	159.0
50100100	REMOVAL OF EXISTING STRUCTURES	EACH	1.0	1.0
51500100	NAME PLATES	EACH	1.0	1.0
54001000	BOX CULVERT END SECTIONS	EACH	2.0	2.0
54021204	PRECAST CONCRETE BOX CULVERT 12' X 4' (M273)	FOOT	66.0	66.0

* SPECIALITY ITEM

△ REVISED 6/5/06

△ REVISED 7/13/06

SCHEDULE OF QUANTITIES

F.A.P. RTE.	SECTION	COUNTY	TOTAL SHEETS	SHEET NO.
332	48B	VERMILION	27	11

CONTRACT NO. 70462

TEMPORARY DITCH CHECKS

CHANNEL LOCATION	EACH
12+50	1
14+00	1
15+50	1
17+00	1
TOTAL	4

INLET & PIPE PROTECTION

ILL 1 LOCATION	OFFSET	EACH
824+77	34.0' RT	1

REMOVAL OF EXISTING STRUCTURE

ILL 1 LOCATION	EACH
824+77	1

NAME PLATES

ILL 1 LOCATION	EACH
824+77	1

BOX CULVERT END SECTION

ILL 1 LOCATION	OFFSET	EACH
824+77	34.0' RT	1
824+77	32.0' LT	1
TOTAL		2

POROUS GRANULAR BACKFILL

ILL 1	STATION TO STATION	VOLUME (CU. YD.)
	824+61 824+66	53.88
	824+66 824+70	64.92
	824+84 824+88	64.92
	824+88 824+93	53.88
	TOTAL	237.6
	USE	238

PRECAST CONCRETE BOX CULVERT 12' X 4' (M273)

ILL 1 LOCATION	ILL 1 LOCATION	SIZE (FOOT)	LENGTH (FOOT)
824+77 32.0' LT	824+77 34.0' RT	12' X 4'	66.0

CHANNEL EXCAVATION

CHANNEL	STATION TO STATION	VOLUME (CU. YD.)
	10+50 16+50	571

EXPLORATION TRENCH 52" DEPTH

ILL 1	STATION TO STATION	OFFSET	LENGTH (FEET)
	824+52 825+02	34.0' RT	50.0
	824+52 825+02	32.0' LT	50.0
	TOTAL		100.0

COMBINATION CURB AND GUTTER REMOVAL

ILL 1	STATION TO STATION	OFFSET	LENGTH (FEET)
	824+60 824+94	21' RT	34.0
	824+60 824+94	21' LT	34.0
	TOTAL		68.0

SIDEWALK REMOVAL

ILL 1	STATION TO STATION	OFFSET	AREA (SQ. FT.)
	824+60 824+94	27' LT	170

REVISED 7/13/06

CONTRACT NO. 70462				
F.A.P. RTE.	SECTION	COUNTY	TOTAL SHEETS	SHEET NO.
332	488	VERMILION	27	23
STA. 9+32.00		TO STA. 11+00.00		
FED. ROAD DIST. NO.		ILLINOIS FED. AID PROJECT		

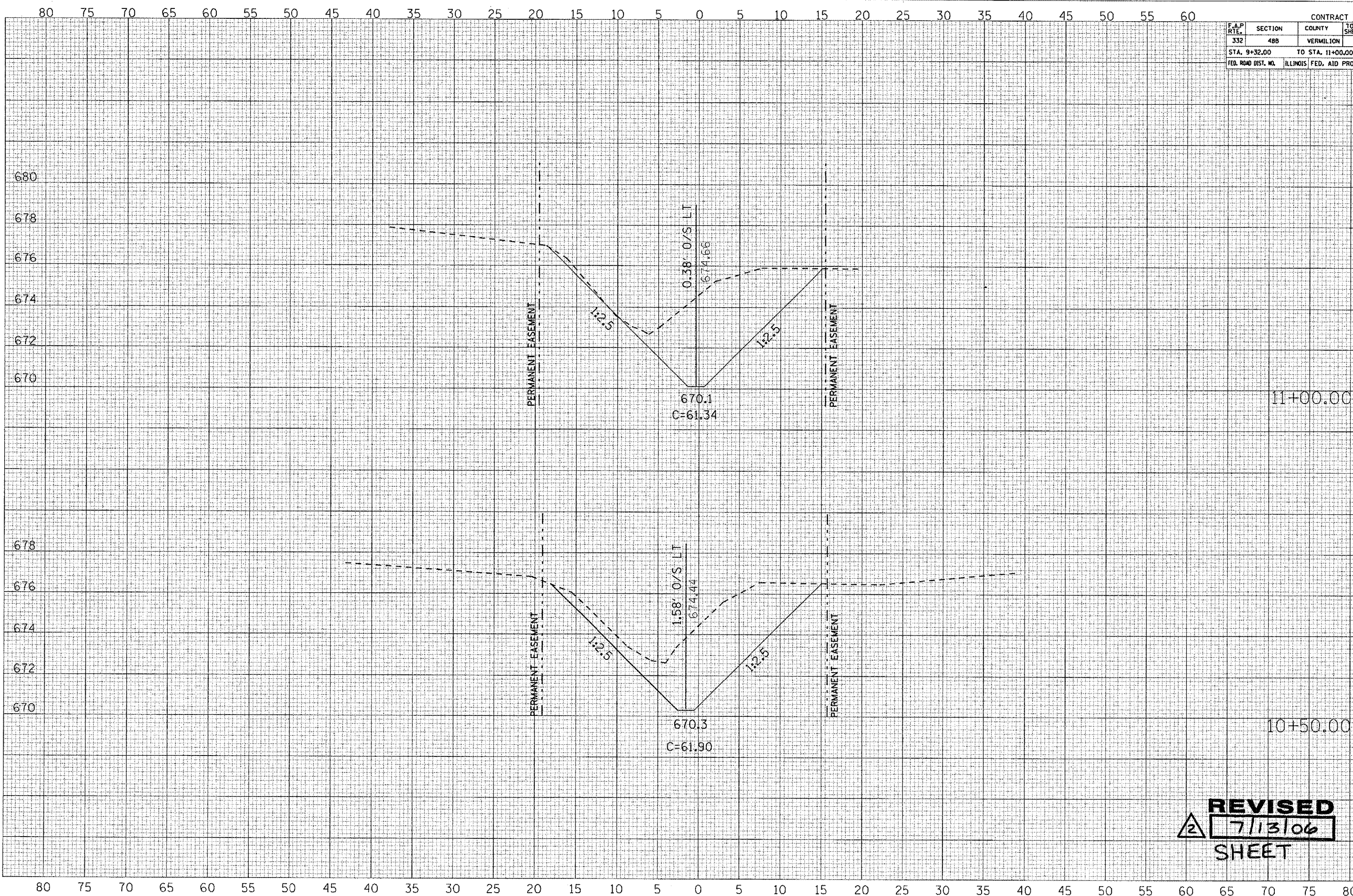

DATE	
BY	
REVISIONS	
NO.	
NO.	

DATE	
BY	
REVISIONS	
NO.	
NO.	

PLOT DATE: 6/25/2008
 PLOT SCALE: 1"=40'
 REFERENCE: SHEETS

REVISED
 7/13/06
SHEET

CONTRACT NO. 70462				
F.A.P. RTE.	SECTION	COUNTY	TOTAL SHEETS	SHEET NO.
332	48B	VERMILION	27	24
STA. 11+50.00 TO STA. 12+50.00				
FED. ROAD DIST. NO.		ILLINOIS		FED. AID PROJECT

DATE	
BY	
CHECKED	
PLOTTED	
TEMPLATE	
AREAS CHECKED	
FINAL SURVEY	
NOTE BOOK	
NO.	

DATE	
BY	
CHECKED	
PLOTTED	
TEMPLATE	
AREAS CHECKED	
ORIGINAL SURVEY	
NOTE BOOK	
NO.	

PLOT DATE 6/29/2006
 PLOT SCALE 1/4" = 10' (VERTICAL)
 PLOT SCALE 1/8" = 10' (HORIZONTAL)
 REFERENCE SHEET

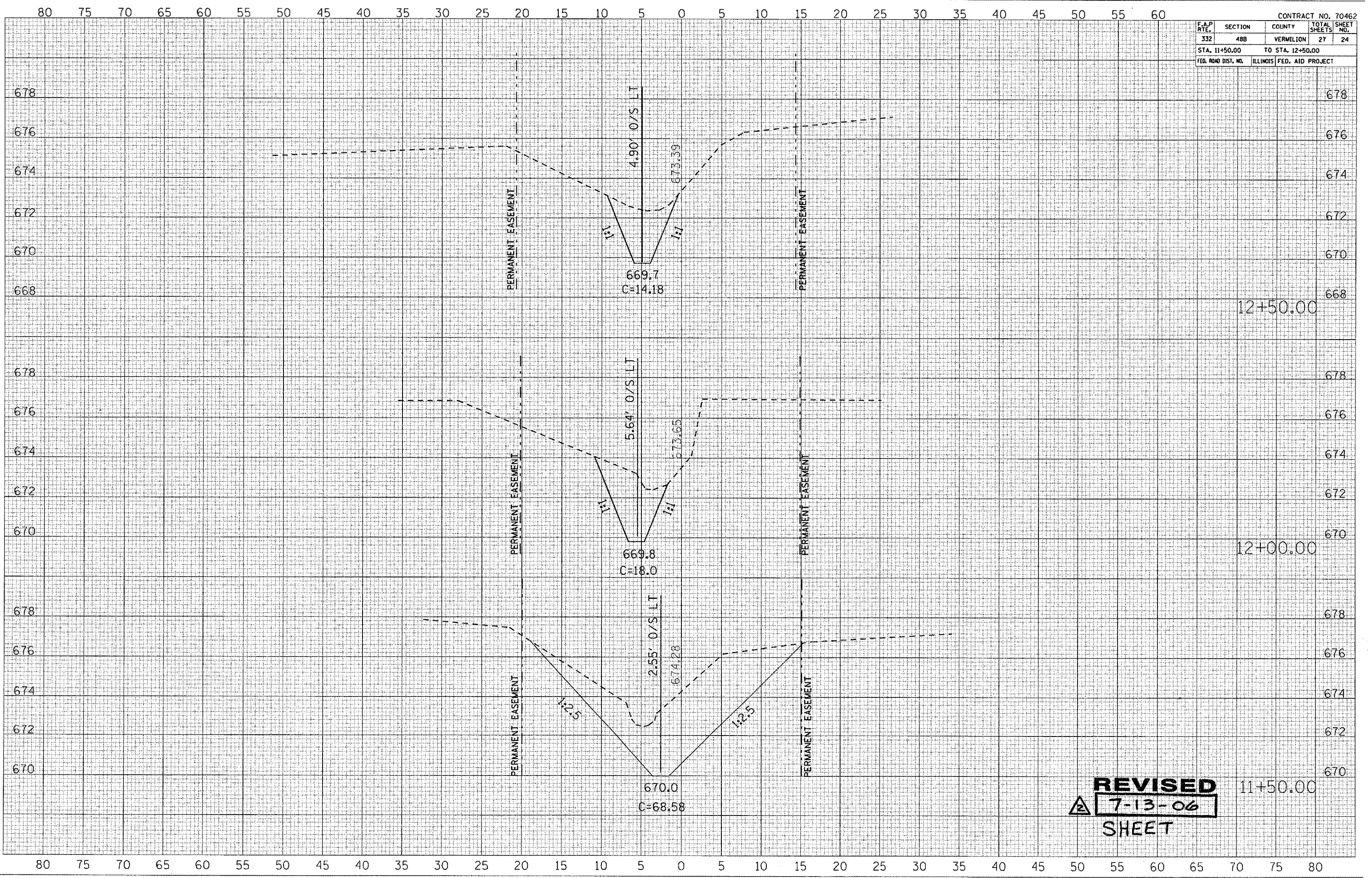

REVISED
7-13-06
 SHEET

CONTRACT NO. 70462				
F.A.P. RTE.	SECTION	COUNTY	TOTAL SHEETS	SHEET NO.
332	48B	VERMILION	27	25
STA. 13+00.00		TO STA. 14+50.00		
FED. ROAD DIST. NO.		ILLINOIS FED. AID PROJECT		

NO.	DATE	BY
NO.		
NO.		

NO.	DATE	BY
NO.		
NO.		

PLOT DATE : 6/21/2006
 FILE NAME : c:\projects\70462\70462.dwg
 REFERENCE : N/A

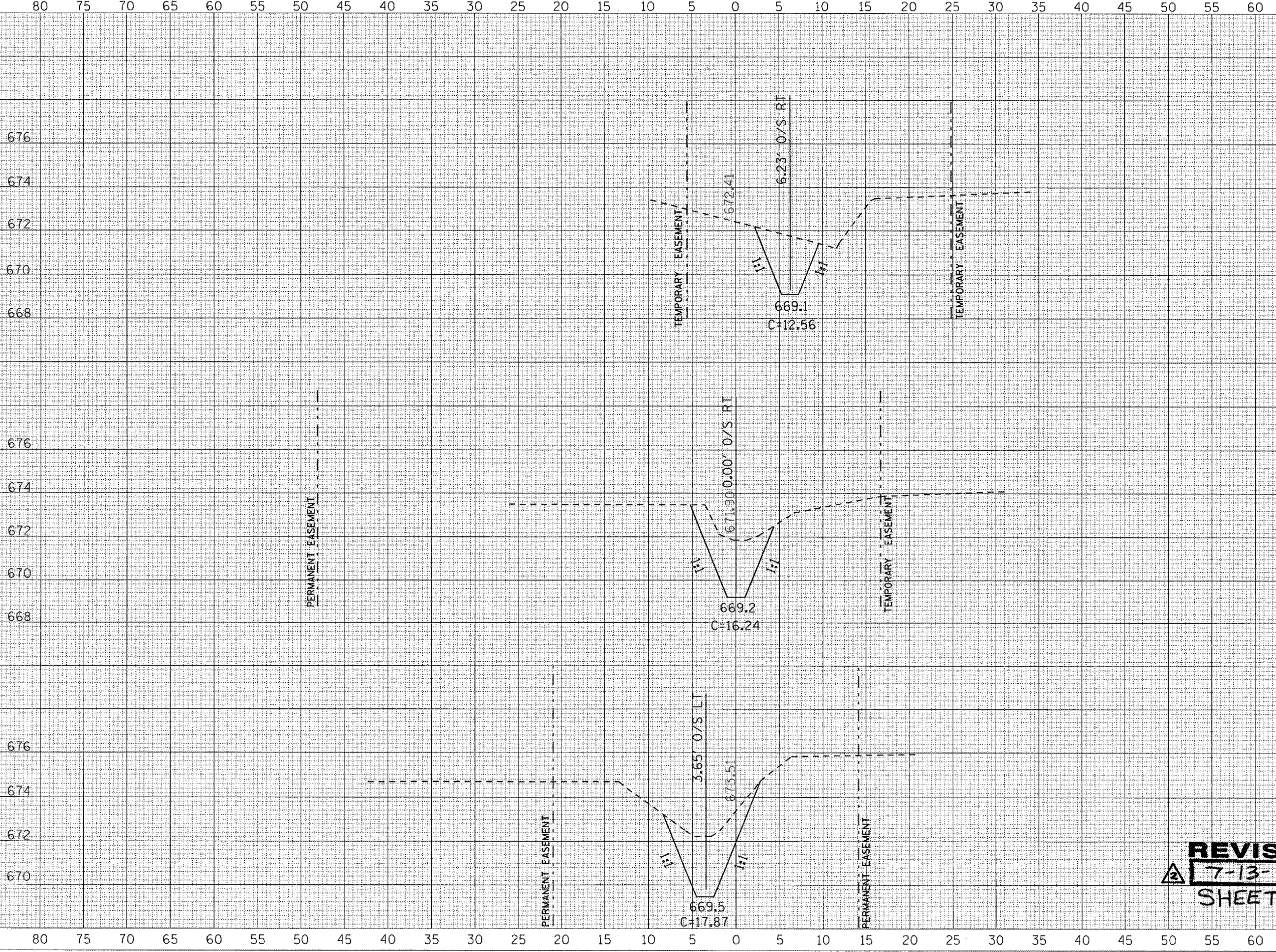

REVISED
7-13-06
SHEET

14+50.00

14+00.00

13+00.00

CONTRACT NO. 70462				
F.A.P. R.T.E.	SECTION	COUNTY	TOTAL SHEETS	SHEET NO.
332	48B	VERMILION	27	26
STA. 15+00.00		TO STA. 16+00.00		
FED. ROAD DIST. NO.	ILLINOIS	FED. AID PROJECT		

FINAL SURVEY PLOTTED FROM NOTE BOOK NO. _____ DATE _____ BY _____

DESIGNED BY _____

PLANNED BY _____

TEMPERATURE _____

AREAS CHECKED _____

PLANS CHECKED _____

ORIGINAL SURVEY PLOTTED FROM NOTE BOOK NO. _____ DATE _____ BY _____

DESIGNED BY _____

PLANNED BY _____

TEMPERATURE _____

AREAS CHECKED _____

PLANS CHECKED _____

PLOT DATE : 6/29/2006
 FILE NAME : c:\p\projects\989189\15+00\15+00.dwg
 PLOTTER : HPGLA2 / IN
 PREFERENCE : WSP2

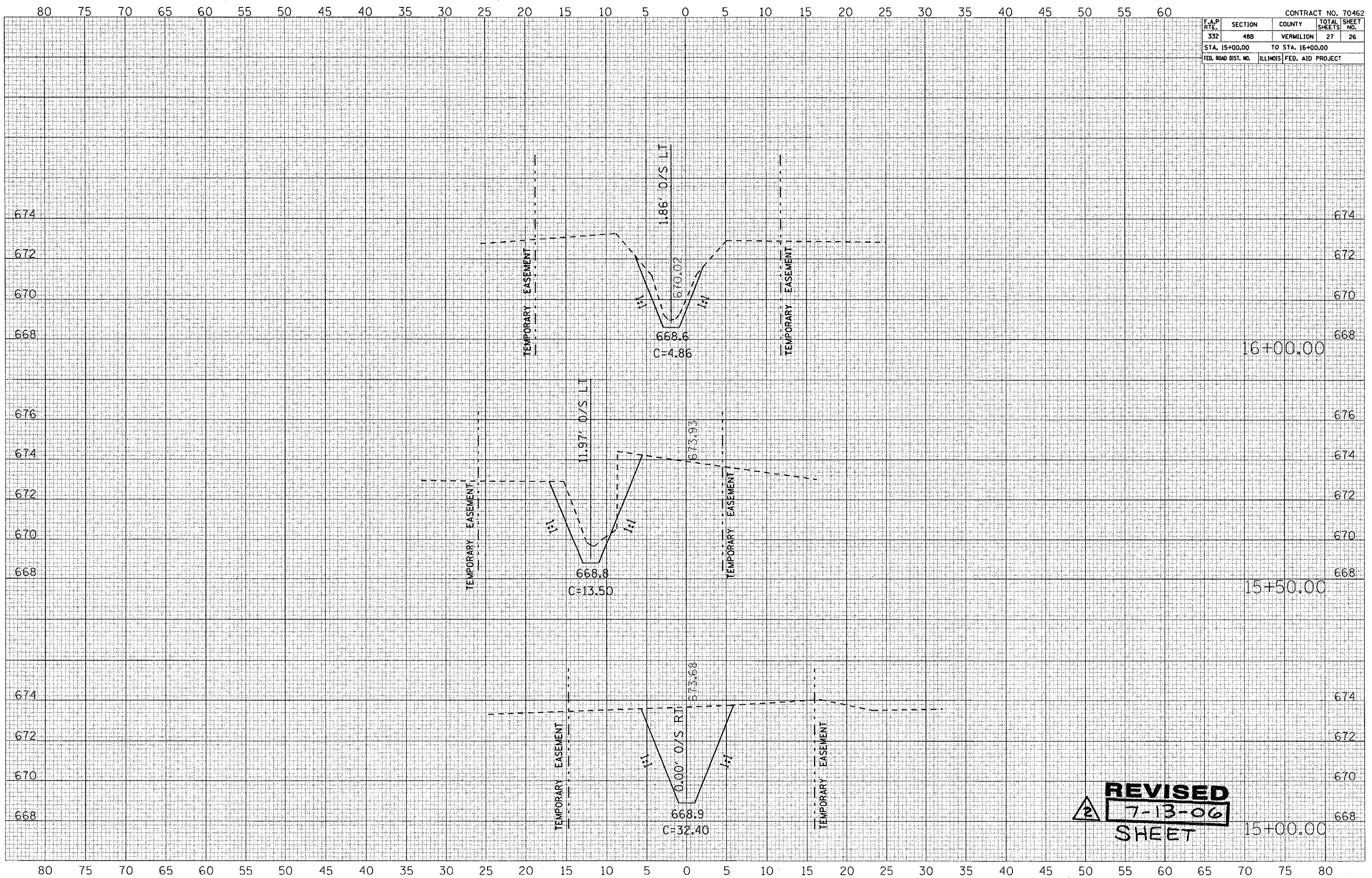

REVIS
2 **7-13-06**
SHEET 15+00.00

80 75 70 65 60 55 50 45 40 35 30 25 20 15 10 5 0 5 10 15 20 25 30 35 40 45 50 55 60

CONTRACT NO. 70462

F.A.P. RTE.	SECTION	COUNTY	TOTAL SHEETS	SHEET NO.
332	48B	VERMILION	27	27
STA. 16+50.00		TO STA. 17+00.00		
FED. ROAD DIST. NO.		ILLINOIS	FED. AID PROJECT	

FINAL SURVEY	DATE
NOTE BOOK	BY
NO.	
REVISIONS	
PLOTTED	
TEMPERATURE	
AREAS CHECKED	

ORIGINAL SURVEY	DATE
NOTE BOOK	BY
NO.	
REVISIONS	
PLOTTED	
TEMPERATURE	
AREAS CHECKED	

PLOT DATE : 6/29/2006
 PLOT SCALE : 1" = 40' / IN
 REFERENCE : WSPS

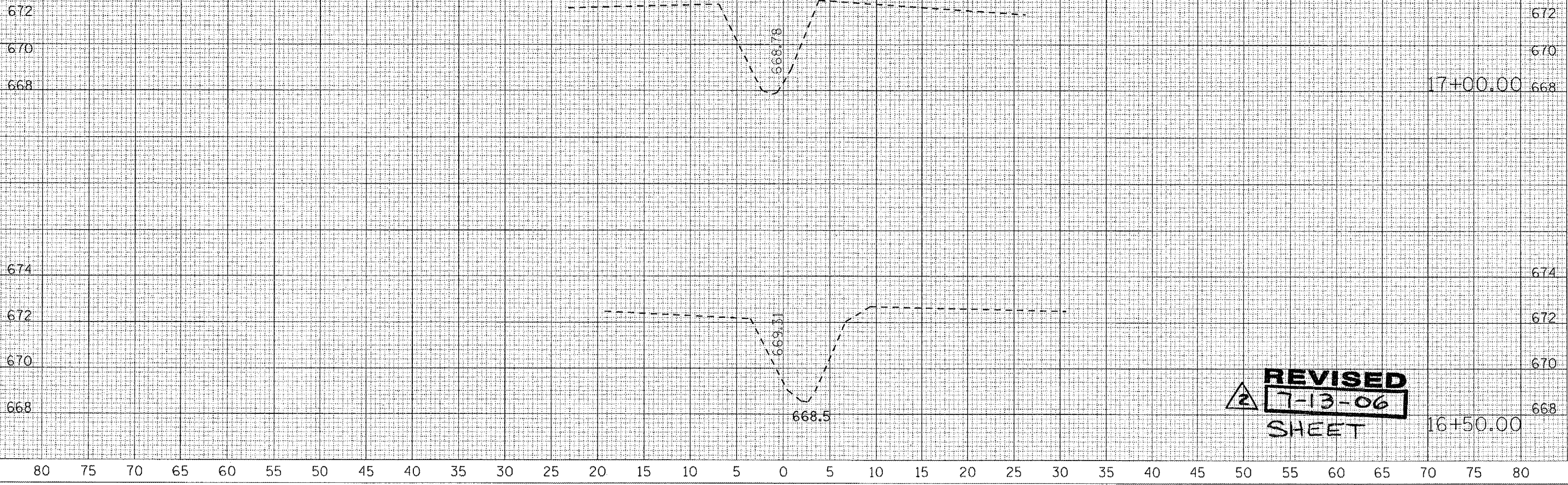

REVISED
 7-13-06
 SHEET 16+50.00