

F.A. RTE.	SECTION	COUNTY	TOTAL SHEETS	SHEET NO.
*	**	***	310	52
STA. TO STA.			CONTRACT NO. 74155	
			* PARK ROADS ** SFWA PARK ROADS 2003-1 *** MOULTRIE AND SHELBY	

EXIST. CURVE PL13C1  
 PI STA. = 21+81.18  
 $\Delta = 1^\circ 17' 28''$  (LT)  
 $D = 1^\circ 31' 40''$   
 $R = 3,750.00'$   
 $T = 42.26'$   
 $L = 84.51'$   
 $E = 0.24'$   
 P.C. STA. = 21+38.93  
 P.T. STA. = 22+23.44

EXIST. CURVE PL13C2  
 PI STA. = 24+85.42  
 $\Delta = 1^\circ 48' 07''$  (LT)  
 $D = 1^\circ 25' 57''$   
 $R = 4,000.00'$   
 $T = 62.90'$   
 $L = 125.79'$   
 $E = 0.49'$   
 P.C. STA. = 24+22.52  
 P.T. STA. = 25+48.31

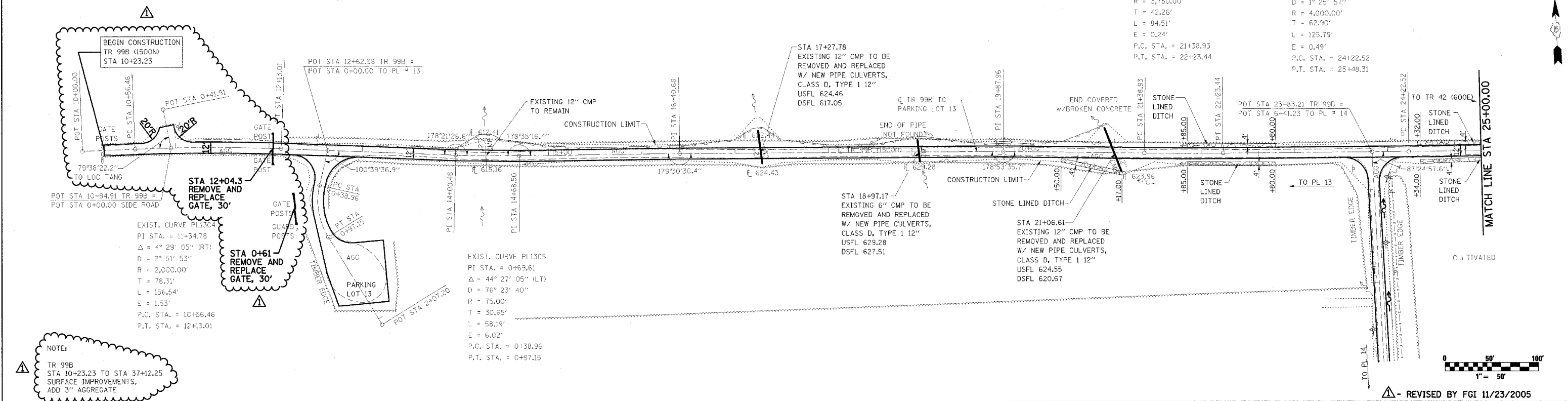

NOTE:  
 TR 99B  
 STA 10+23.23 TO STA 37+12.25  
 SURFACE IMPROVEMENTS,  
 ADD 3\"/>

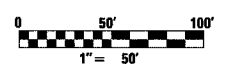

△ - REVISED BY FGI 11/23/2005

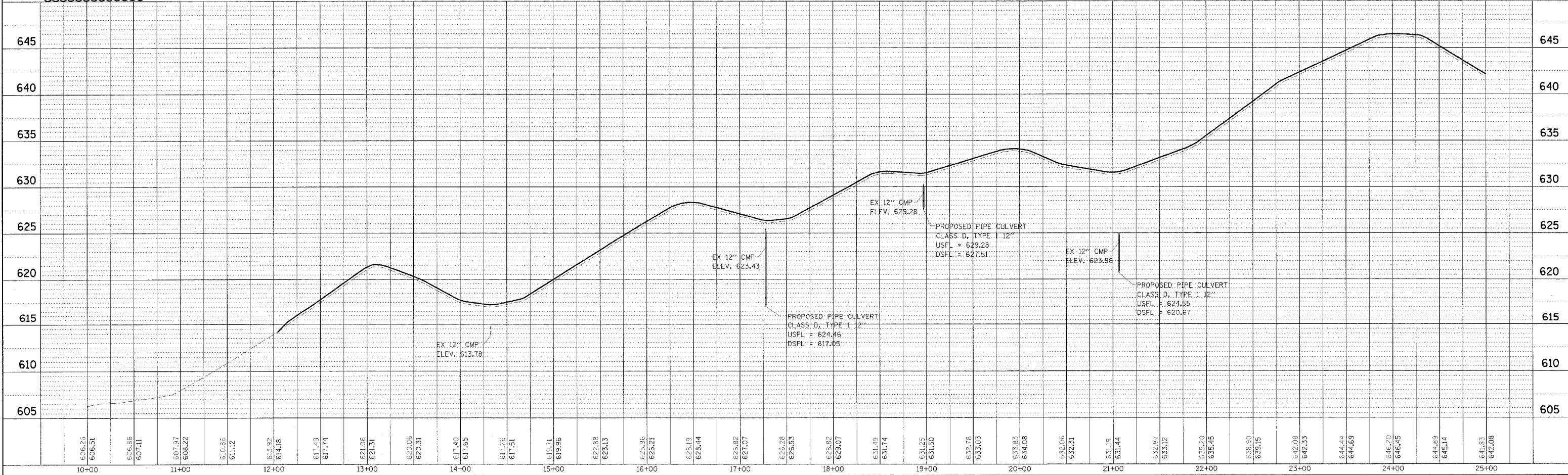

DATE	BY

DATE	BY

WEST OKAW FISH & WILDLIFE UNIT PLAN AND PROFILE, TR 99B TO PARKING LOT 13