

F.A. RTE.	SECTION	COUNTY	TOTAL SHEETS	SHEET NO.
*	**	***	310	56
STA.		TO STA.		
CONTRACT NO. 74155				
<ul style="list-style-type: none"> * PARK ROADS ** SFWA PARK ROADS 2003-1 *** MOULTRIE AND SHELBY 				



MATCH LINE STA 12+00.00
 TO PL 18
 MAC MCGEE
 WATERFOWL AREA

EXIST. CURVE PL18-9	EXIST. CURVE PL18-10	EXIST. CURVE PL18-11	EXIST. CURVE PL18-12
PI STA. = 14+27.68	PI STA. = 15+08.88	PI STA. = 16+96.64	PI STA. = 18+48.17
$\Delta = 16^\circ 38' 41''$ (LT)	$\Delta = 55^\circ 36' 03''$ (LT)	$\Delta = 19^\circ 12' 57''$ (RT)	$\Delta = 25^\circ 42' 56''$ (LT)
D = 38' 11" 50"	D = 76' 23" 40"	D = 11' 27" 33"	D = 19' 05" 55"
R = 150.00'	R = 75.00'	R = 500.00'	R = 300.00'
T = 21.94'	T = 39.54'	T = 84.64'	T = 68.48'
L = 43.58'	L = 72.78'	L = 167.69'	L = 134.65'
E = 1.60'	E = 9.79'	E = 7.11'	E = 7.72'
P.C. STA. = 14+05.74	P.C. STA. = 14+46.34	P.C. STA. = 16+12.00	P.C. STA. = 17+79.69
P.T. STA. = 14+49.31	P.T. STA. = 15+42.12	P.T. STA. = 17+79.69	P.T. STA. = 19+14.34

EXIST. CURVE PL18-8
 PI STA. = 13+04.98
 $\Delta = 6^\circ 31' 21''$ (LT)
 D = 4' 35" 01"
 R = 1,250.00'
 T = 71.23'
 L = 142.30'
 E = 2.03'
 P.C. STA. = 12+33.75
 P.T. STA. = 13+76.05

NOTE:
 PARK ROAD
 STA 2+11.60 TO STA 21+78.68
 SURFACE IMPROVEMENTS,
 ADD 3" AGGREGATE

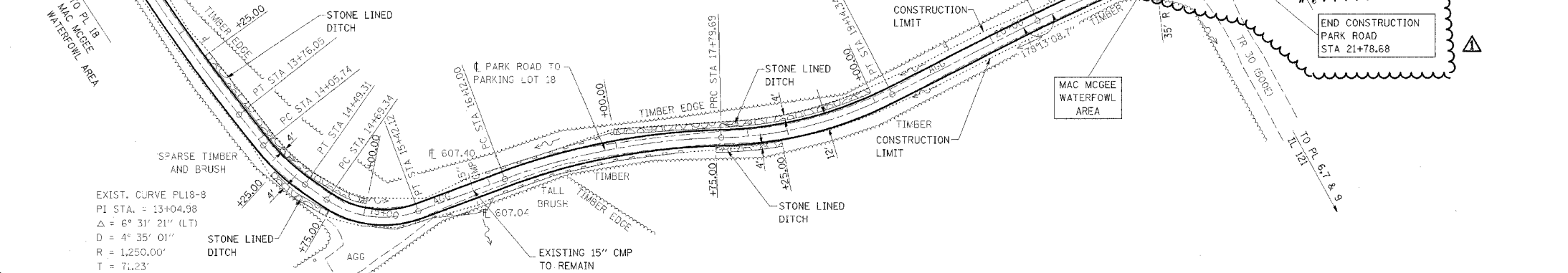

REVISOR'S MARK - REVISED BY FGI 11/23/2005

DATE	BY

DATE	BY

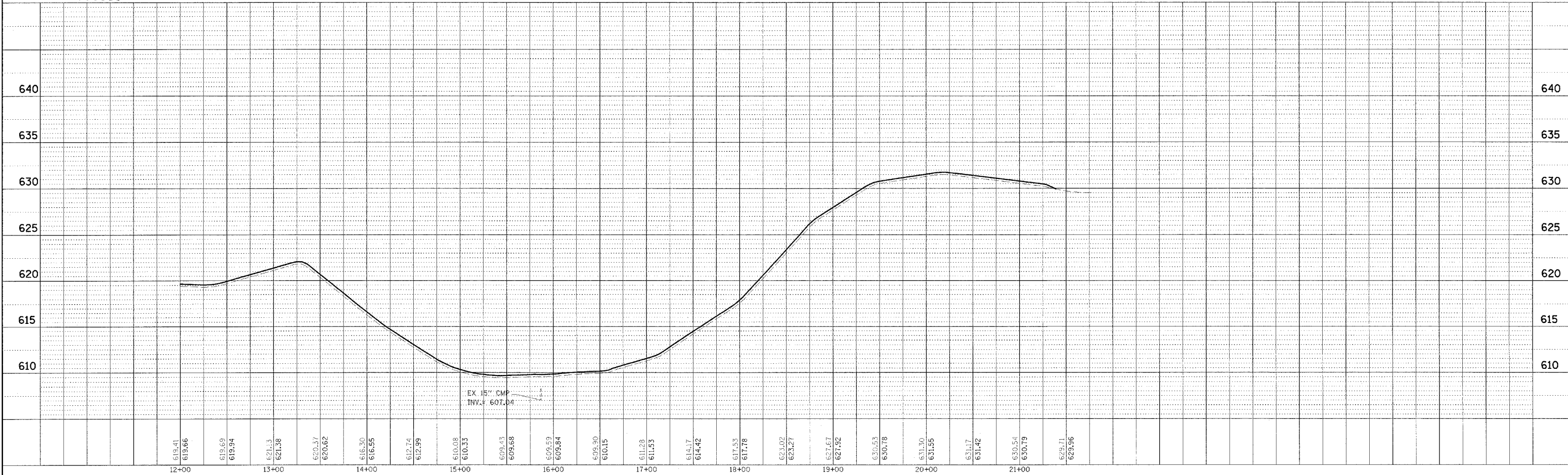

WEST OKAW FISH & WILDLIFE UNIT PLAN AND PROFILE, PARK ROAD TO PARKING LOT 18