

F.A. RTE.	SECTION	COUNTY	TOTAL SHEETS	SHEET NO.
*	**	***	310	67

CONTRACT NO. 74155

STA. TO STA.

* PARK ROADS
 ** SFWA PARK ROADS 2003-1
 *** MOULTRIE AND SHELBY

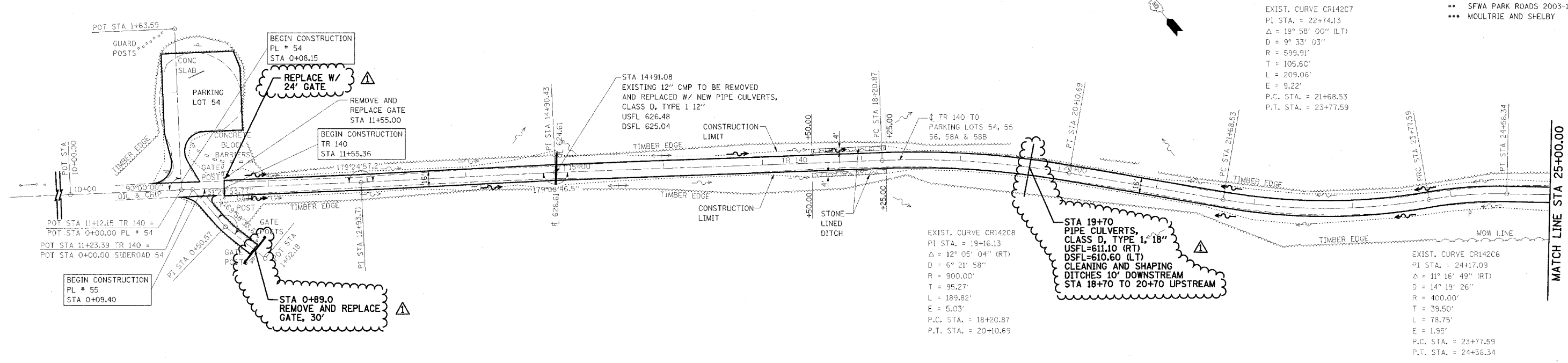

NOTE:
 PARD ROAD
 STA 11+55.36 TO STA 40+22.34
 SURFACE IMPROVEMENTS,
 ADD 3" AGGREGATE

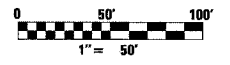

REVISD BY FGI 11/23/2005

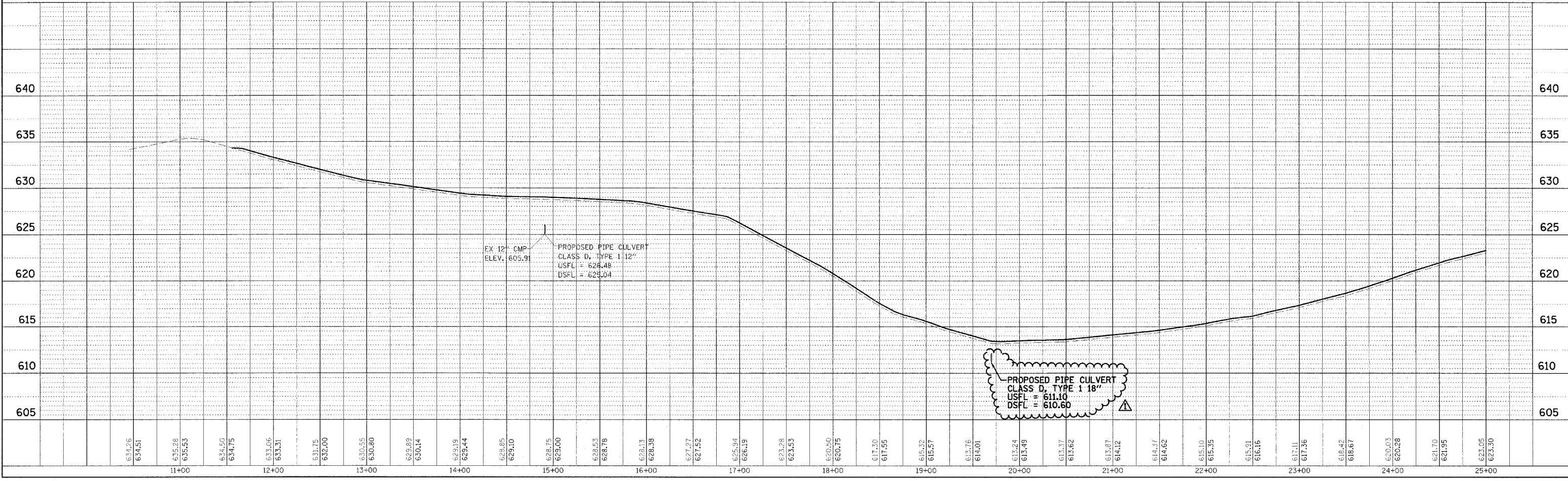

KASKASKIA FISH & WILDLIFE UNIT PLAN AND PROFILE, TR 140 TO PARKING LOTS 54, 55, 56, 58, 58A & 58B