

F.A. RTE.	SECTION	COUNTY	TOTAL SHEETS	SHEET NO.
*	**	***	310	72

STA. TO STA.

CONTRACT NO. 74155

- \* PARK ROADS
- \*\* SFWA PARK ROADS 2003-1
- \*\*\* MOULTRIE AND SHELBY

EXIST. CURVE PL63C3  
 PI STA. = 2+63.49  
 $\Delta = 59^\circ 52' 02''$  (LT)  
 $D = 47^\circ 44' 47''$   
 $R = 120.00'$   
 $T = 69.10'$   
 $L = 125.39'$   
 $E = 18.47'$   
 P.C. STA. = 1+94.39  
 P.T. STA. = 3+19.78

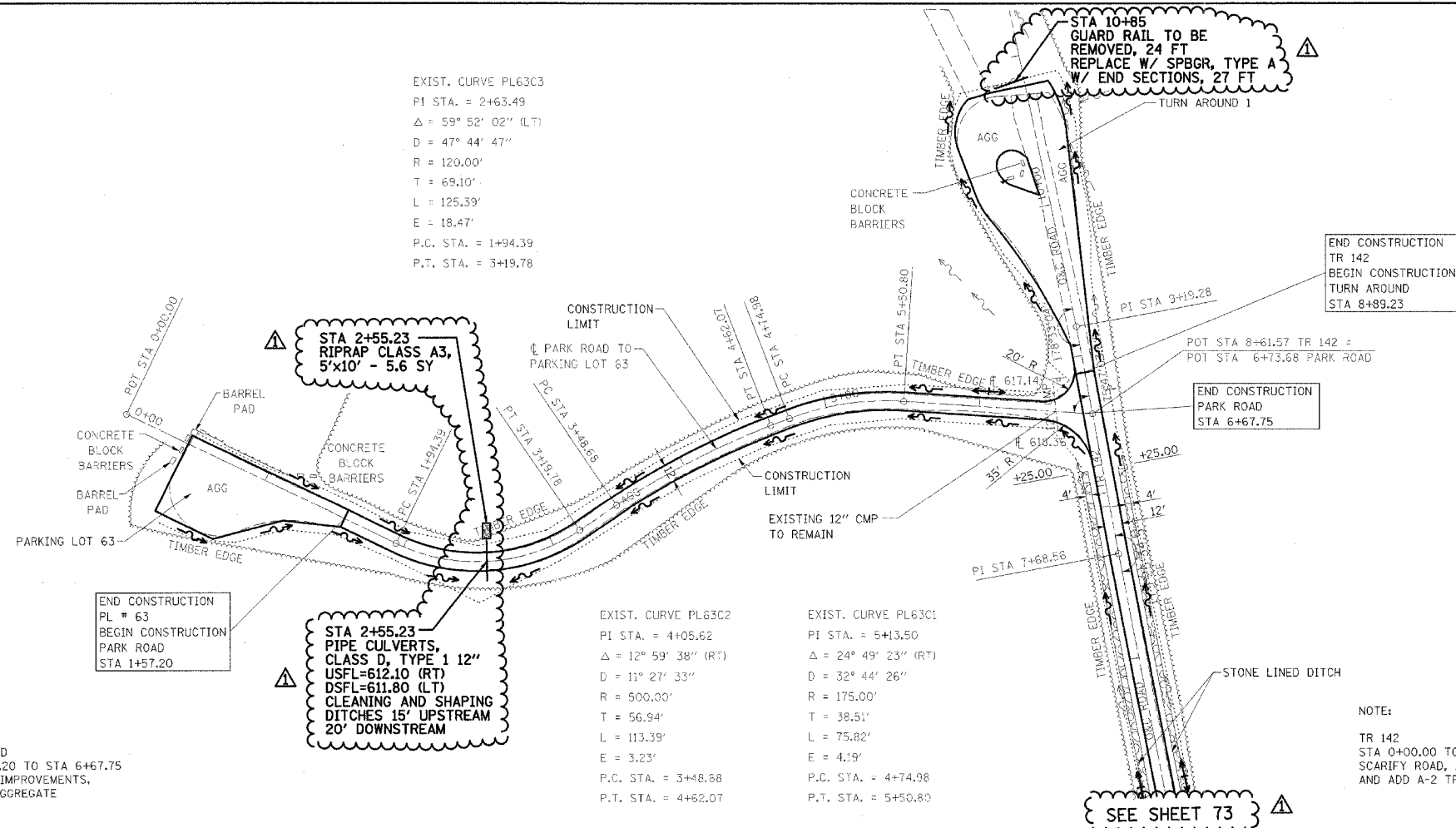

NOTE:  
 PARK ROAD  
 STA 1+57.20 TO STA 6+67.75  
 SURFACE IMPROVEMENTS,  
 ADD 3" AGGREGATE

NOTE:  
 TR 142  
 STA 0+00.00 TO STA 8+89.23  
 SCARIFY ROAD, ADD 3" AGGREGATE  
 AND ADD A-2 TREATMENT

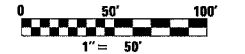

▲ - REVISED BY FGI 11/23/2005

DATE	
BY	
REVISION	
PROF. ILL.	
NOTE BOOK	
NO.	

DATE	
BY	
REVISION	
PROF. ILL.	
NOTE BOOK	
NO.	

