

F.A. RTE.	SECTION	COUNTY	TOTAL SHEETS	SHEET NO.
*	**	***	310	128

STA. TO STA.  
CONTRACT NO. 74155

- \* PARK ROADS
- \*\* SFWA PARK ROADS 2003-1
- \*\*\* MOULTRIE AND SHELBY

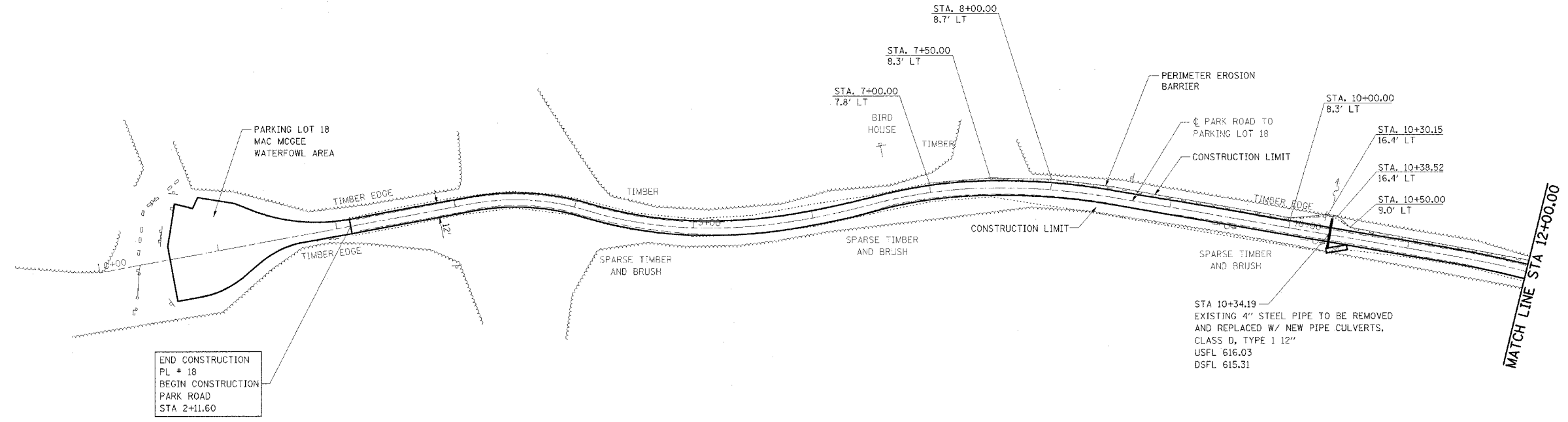

END CONSTRUCTION  
PL # 18  
BEGIN CONSTRUCTION  
PARK ROAD  
STA 2+11.60

STA 10+34.19  
EXISTING 4" STEEL PIPE TO BE REMOVED  
AND REPLACED W/ NEW PIPE CULVERTS.  
CLASS D, TYPE 1 12"  
USFL 616.03  
DSFL 615.31

NOTE:  
PARK ROAD  
STA 2+11.60 TO STA 21+39.00  
SURFACE IMPROVEMENTS,  
ADD 3" AGGREGATE

REVISIONS TO PARK ROADS AND PARKING LOTS  
SHOWN ON PREVIOUS PLAN SHEETS THAT DO NOT  
IMPACT EROSION CONTROL ARE NOT BALLOONED  
OR NOTED AS REVISIONS TO ELIMINATE CLUTTER  
AND CROWDING ON THE EROSION CONTROL SHEETS

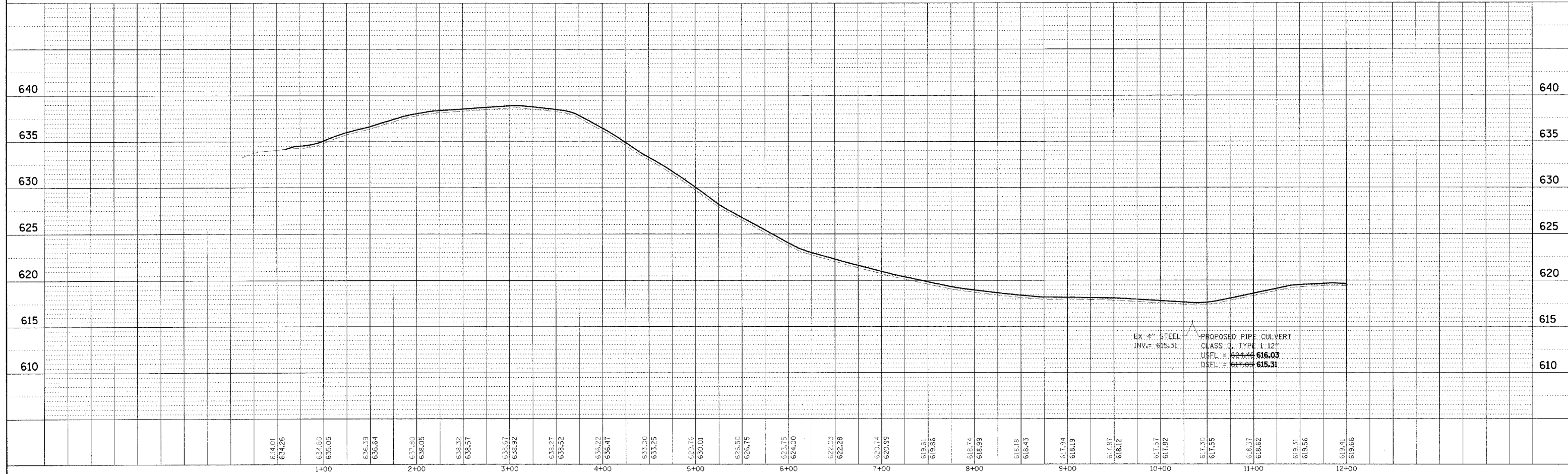

EX 4" STEEL PIPE CULVERT  
INV. = 615.31  
PROPOSED PIPE CULVERT  
CLASS D, TYPE 1 12"  
USFL = 616.03  
DSFL = 615.31

WEST OKAW FISH & WILDLIFE UNIT EROSION CONTROL PLAN AND PROFILE, PARK ROAD TO PARKING LOT 18

PLAN	REVISIONS	DATE
NO.		

PROFILE	REVISIONS	DATE
NO.		