

F.A. RTE.	SECTION	COUNTY	TOTAL SHEETS	SHEET NO.
*	**	***	310	132
STA.		TO STA.		
CONTRACT NO. 74155				
<ul style="list-style-type: none"> * PARK ROADS ** SFWA PARK ROADS 2003-1 *** MOULTRIE AND SHELBY 				

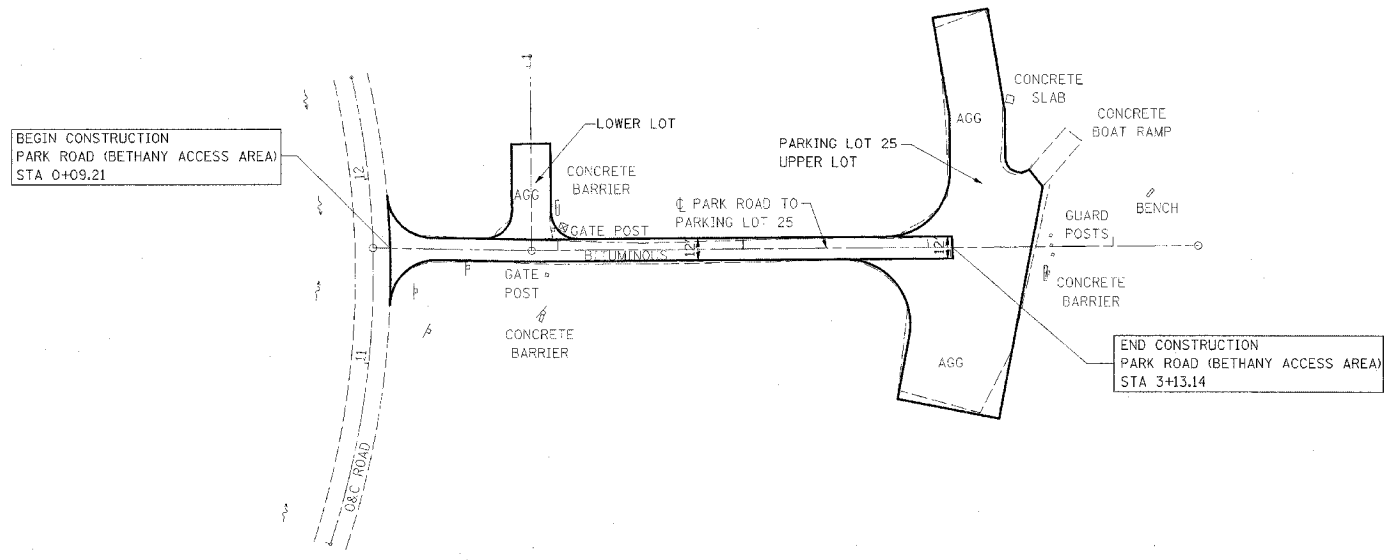

PLAN
 SURVEYED BY
 DATE
 NOTE BOOK NO.
 ALIGNMENT CHECKED BY
 GRADES CHECKED BY
 STRUCTURE ADJUSTMENTS CHECKED BY

BEGIN CONSTRUCTION
 PARK ROAD (BETHANY ACCESS AREA)
 STA 0+09.21

END CONSTRUCTION
 PARK ROAD (BETHANY ACCESS AREA)
 STA 3+13.14

NOTE:
 PARK ROAD (BETHANY ACCESS AREA)
 STA 0+09.21 TO STA 3+13.14
 PLACE A-1 TREATMENT OVER
 EXISTING BITUMINOUS PAVEMENT

REVISIONS TO PARK ROADS AND PARKING LOTS
 SHOWN ON PREVIOUS PLAN SHEETS THAT DO NOT
 IMPACT EROSION CONTROL ARE NOT BALLOONED
 OR NOTED AS REVISIONS TO ELIMINATE CLUTTER
 AND CROWDING ON THE EROSION CONTROL SHEETS

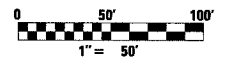

PROFILE
 SURVEYED BY
 DATE
 NOTE BOOK NO.
 GRADES CHECKED BY
 STRUCTURE ADJUSTMENTS CHECKED BY

