

F.A. RTE.	SECTION	COUNTY	TOTAL SHEETS	SHEET NO.
*	**	***	310	140
STA. TO STA.				
CONTRACT NO. T4155				
* PARK ROADS				
** SFWA PARK ROADS 2003-1				
*** MOULTRIE AND SHELBY				

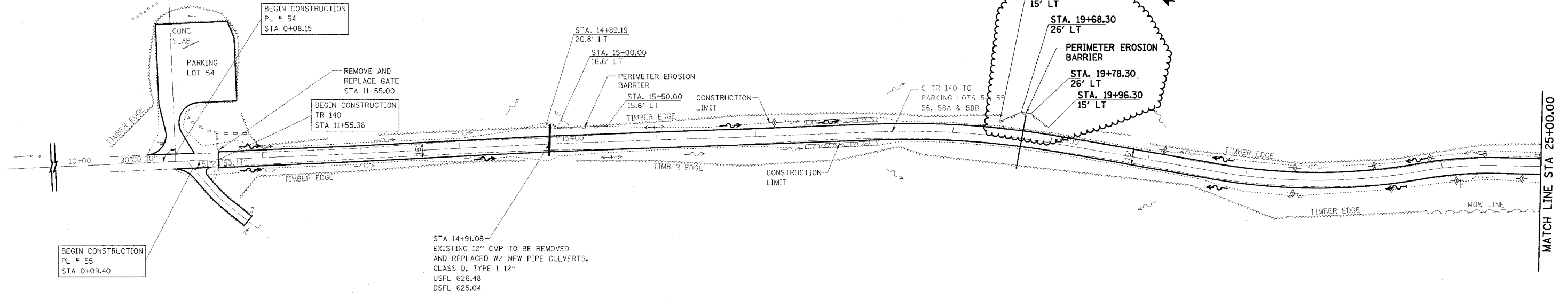

NOTE:
 PARD ROAD
 STA 11+55.36 TO STA 40+22.34
 SURFACE IMPROVEMENTS,
 ADD 3" AGGREGATE

REVISIONS TO PARK ROADS AND PARKING LOTS SHOWN ON PREVIOUS PLAN SHEETS THAT DO NOT IMPACT EROSION CONTROL ARE NOT BALLOONED OR NOTED AS REVISIONS TO ELIMINATE CLUTTER AND CROWDING ON THE EROSION CONTROL SHEETS



▲ - REVISED BY FGI 11/23/2005

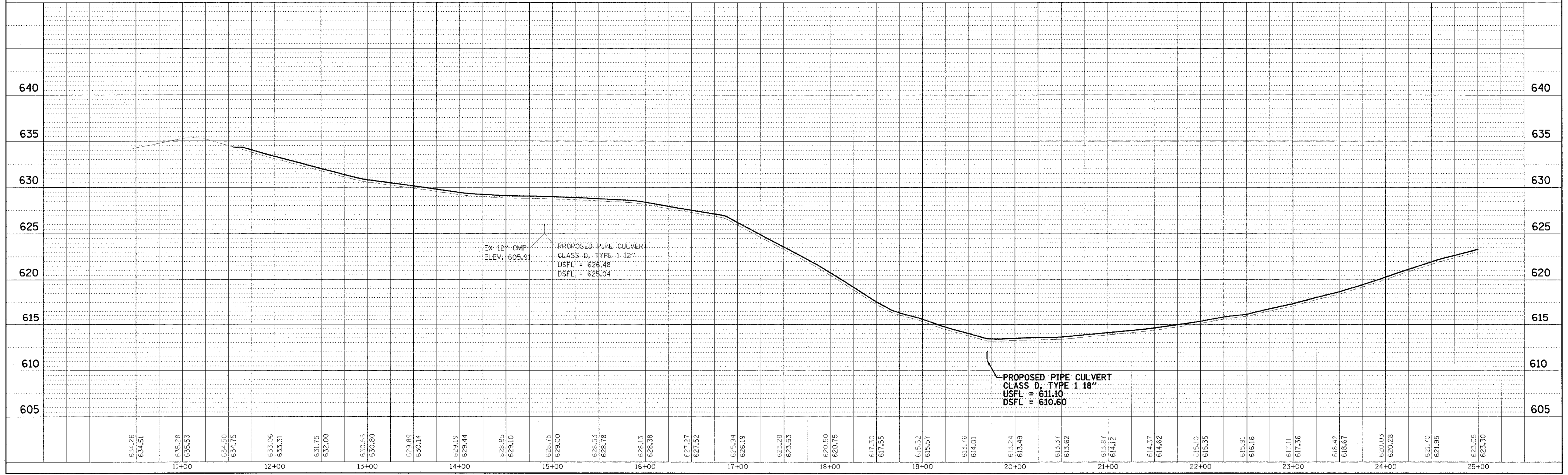

KASKASKIA FISH & WILDLIFE UNIT EROSION CONTROL PLAN AND PROFILE, TR 140 TO PARKING LOTS 54, 55, 56, 58, 58A & 58B

PLAN	REVISION	DATE

PROFILE	REVISION	DATE